

646.602 TEMPORARY 4" WHITE LINE, PAINT
 646.402 DURABLE 4" WHITE LINE, THERMOPLASTIC OR
 646.403 DURABLE 4" WHITE LINE, EPOXY PAINT OR
 646.404 DURABLE 4" WHITE LINE, POLYUREA,
 307+00 TO 317+00 SOLID LT & RT

646.612 TEMPORARY 4" YELLOW LINE, PAINT
 646.412 DURABLE 4" YELLOW LINE, THERMOPLASTIC OR
 646.413 DURABLE 4" YELLOW LINE, EPOXY PAINT OR
 646.414 DURABLE 4" YELLOW LINE, POLYUREA,
 307+00 TO 311+25 SOLID LT & RT
 311+25 TO 317+00 SOLID LT, DASHED RT

621.205 STEEL BEAM GUARDRAIL,
 GALVANIZED W/8' POSTS
 307+00 TO 315+93 RT

621.50 MANUFACTURED
 TERMINAL SECTION, FLARED
 315+93 TO 316+30.5 RT

621.80 REMOVAL AND DISPOSAL OF GUARDRAIL
 307+00 TO 316+21 RT

900.620 SPECIAL PROVISION
 (DELINEATOR WITH STEEL POST)
 316+30.5 RT

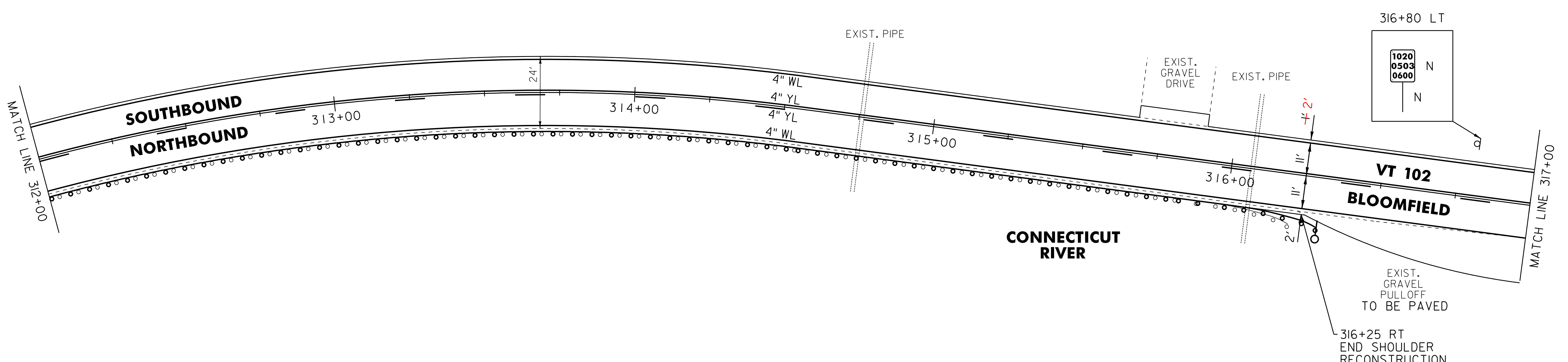
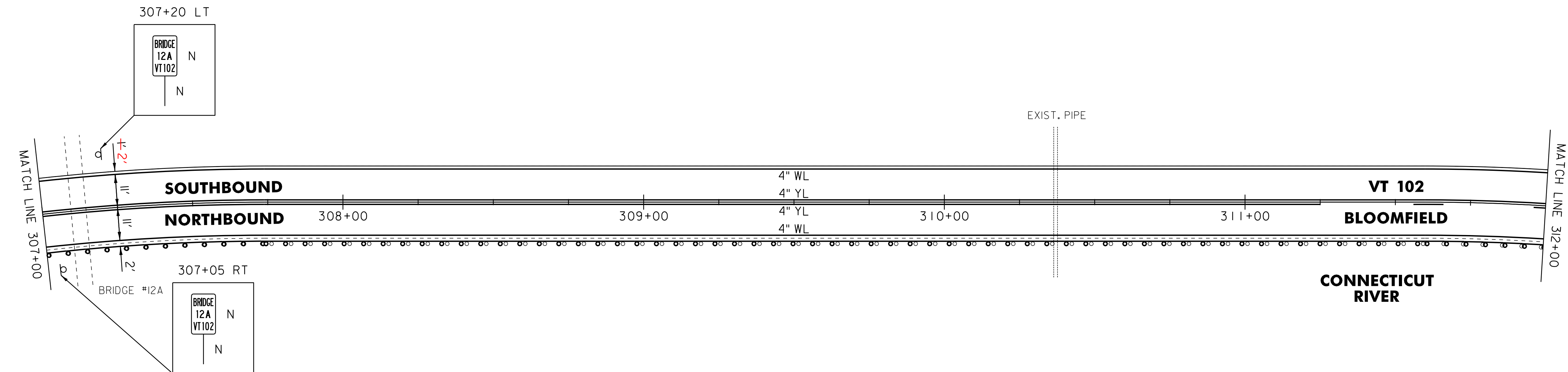

LEGEND

R	=	REMOVE EXISTING
S	=	SALVAGE
R&S	=	REMOVE AND SALVAGE
N	=	NEW
RET	=	RETAIN
B-B	=	BACK TO BACK
—○—	=	EXISTING GUARDRAIL
—○—	=	PROPOSED GUARDRAIL
—○—	=	YELLOW LINE
—○—	=	WHITE LINE
—○—	=	DELINEATOR

ROADWAY LAYOUT 30

PROJECT NAME:	BLOOMFIELD-LEMINGTON
PROJECT NUMBER:	STP 2610(I)
FILE NAME:	/pave/06c052/pc052
PROJECT LEADER:	PTS
DESIGNED BY:	NLL
IPARM FILE NAME:	06C052.44
PLOT DATE:	19-JUN-2013 16:59
DRAWN BY:	SNG
CHECKED BY:	PTS
SHEET	44 OF 82

NOT TO SCALE