

646.602 TEMPORARY 4" WHITE LINE, PAINT
 646.402 DURABLE 4" WHITE LINE, THERMOPLASTIC OR
 646.403 DURABLE 4" WHITE LINE, EPOXY PAINT OR
 646.404 DURABLE 4" WHITE LINE, POLYUREA,
 92+00 TO 103+00 SOLID LT & RT

646.612 TEMPORARY 4" YELLOW LINE, PAINT
 646.412 DURABLE 4" YELLOW LINE, THERMOPLASTIC OR
 646.413 DURABLE 4" YELLOW LINE, EPOXY PAINT OR
 646.414 DURABLE 4" YELLOW LINE, POLYUREA,
 92+00 TO 101+38 SOLID LT & RT
 101+38 TO 103+00 SOLID LT, DASHED RT

621.50 MANUFACTURED
 TERMINAL SECTION, FLARED
 92+36.5 TO 92+74 RT
 96+17 TO 96+54.5 RT

621.80 REMOVAL AND DISPOSAL OF GUARDRAIL
 92+36.5 TO 92+74 RT
 96+17 TO 96+54.5 RT
 900.620 SPECIAL PROVISION
 (DELINEATOR WITH STEEL POST)
 92+74 RT
 96+17 RT

613.10 STONE FILL, TYPE I
 92+25 RT
 675.50 REMOVING SIGNS
 AS SHOWN - 1

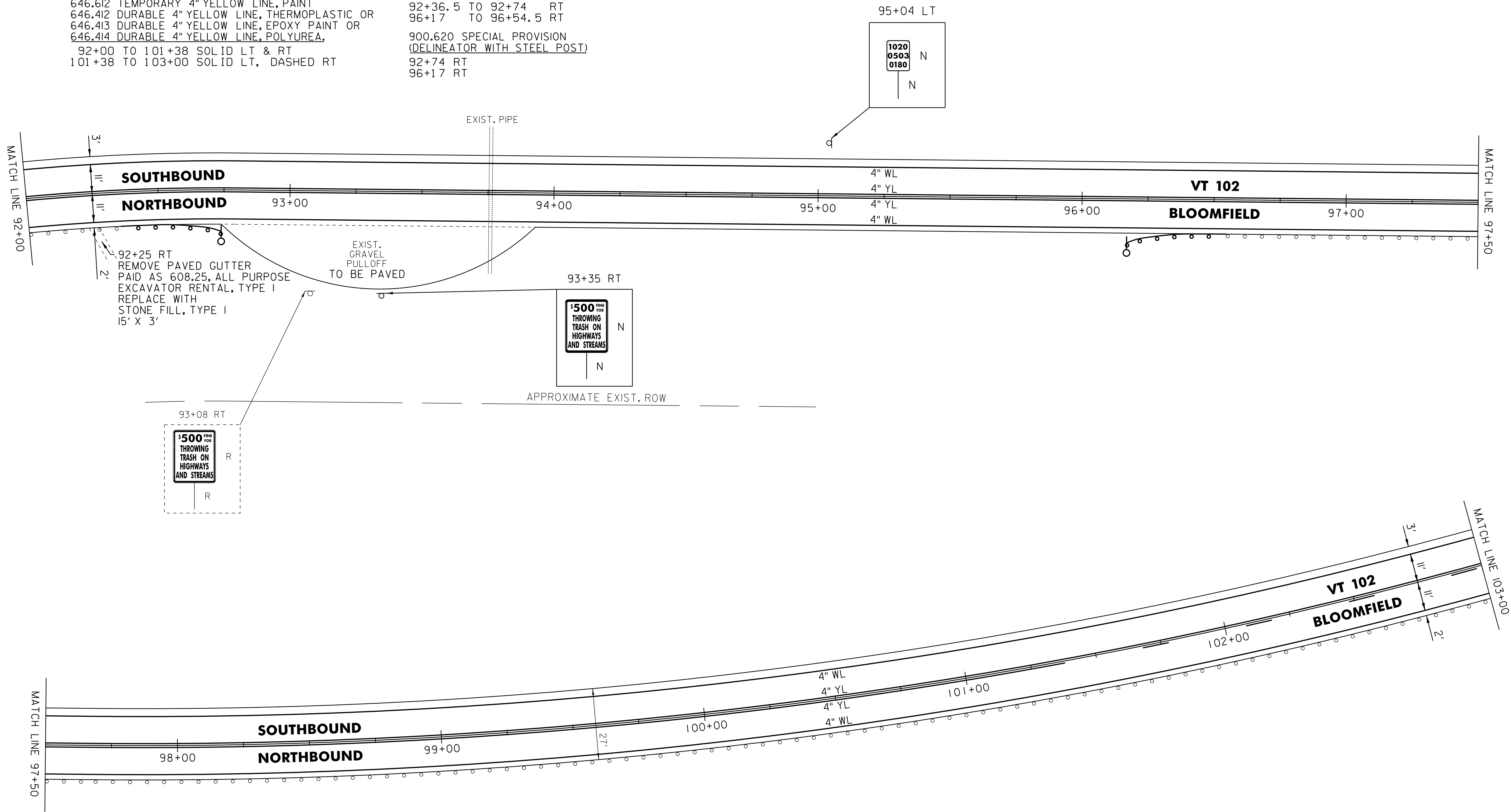

LEGEND

R	=	REMOVE EXISTING
S	=	SALVAGE
R&S	=	REMOVE AND SALVAGE
N	=	NEW
RET	=	RETAIN
B-B	=	BACK TO BACK
	=	EXISTING GUARDRAIL
	=	PROPOSED GUARDRAIL
YL	=	YELLOW LINE
WL	=	WHITE LINE
	=	DELINEATOR

ROADWAY LAYOUT 8

PROJECT NAME: BLOOMFIELD-LEMINGTON

PROJECT NUMBER: STP 2610(I)

FILE NAME: /pave/06c052/pc052

PROJECT LEADER: PTS

DESIGNED BY: NULL

IPARM FILE NAME: 06C052.22

PLOT DATE: 19-JUN-2013 16:59

DRAWN BY: SNG

CHECKED BY: PTS

SHEET 22 OF 82

NOT TO SCALE