

646.602 TEMPORARY 4" WHITE LINE, PAINT
 646.402 DURABLE 4" WHITE LINE, THERMOPLASTIC OR
 646.403 DURABLE 4" WHITE LINE, EPOXY PAINT OR
 646.404 DURABLE 4" WHITE LINE, POLYUREA,
 30+50 TO 41+50 SOLID LT & RT

646.612 TEMPORARY 4" YELLOW LINE, PAINT
 646.412 DURABLE 4" YELLOW LINE, THERMOPLASTIC OR
 646.413 DURABLE 4" YELLOW LINE, EPOXY PAINT OR
 646.414 DURABLE 4" YELLOW LINE, POLYUREA,
 30+50 TO 40+12 SOLID LT & RT
 40+12 TO 41+50 SOLID LT, DASHED RT

621.20 STEEL BEAM GUARDRAIL, GALVANIZED
 31+49.5 TO 40+24.5 RT
 621.50 MANUFACTURED
 TERMINAL SECTION, FLARED
 31+12 TO 31+49.5 RT
 40+24.5 TO 40+62 RT
 621.80 REMOVAL AND DISPOSAL OF GUARDRAIL
 31+15 TO 40+59 RT

900.620 SPECIAL PROVISION
 (DELINEATOR WITH STEEL POST)
 31+12 RT
 40+62 RT

675.50 REMOVING SIGNS
 AS SHOWN - 4

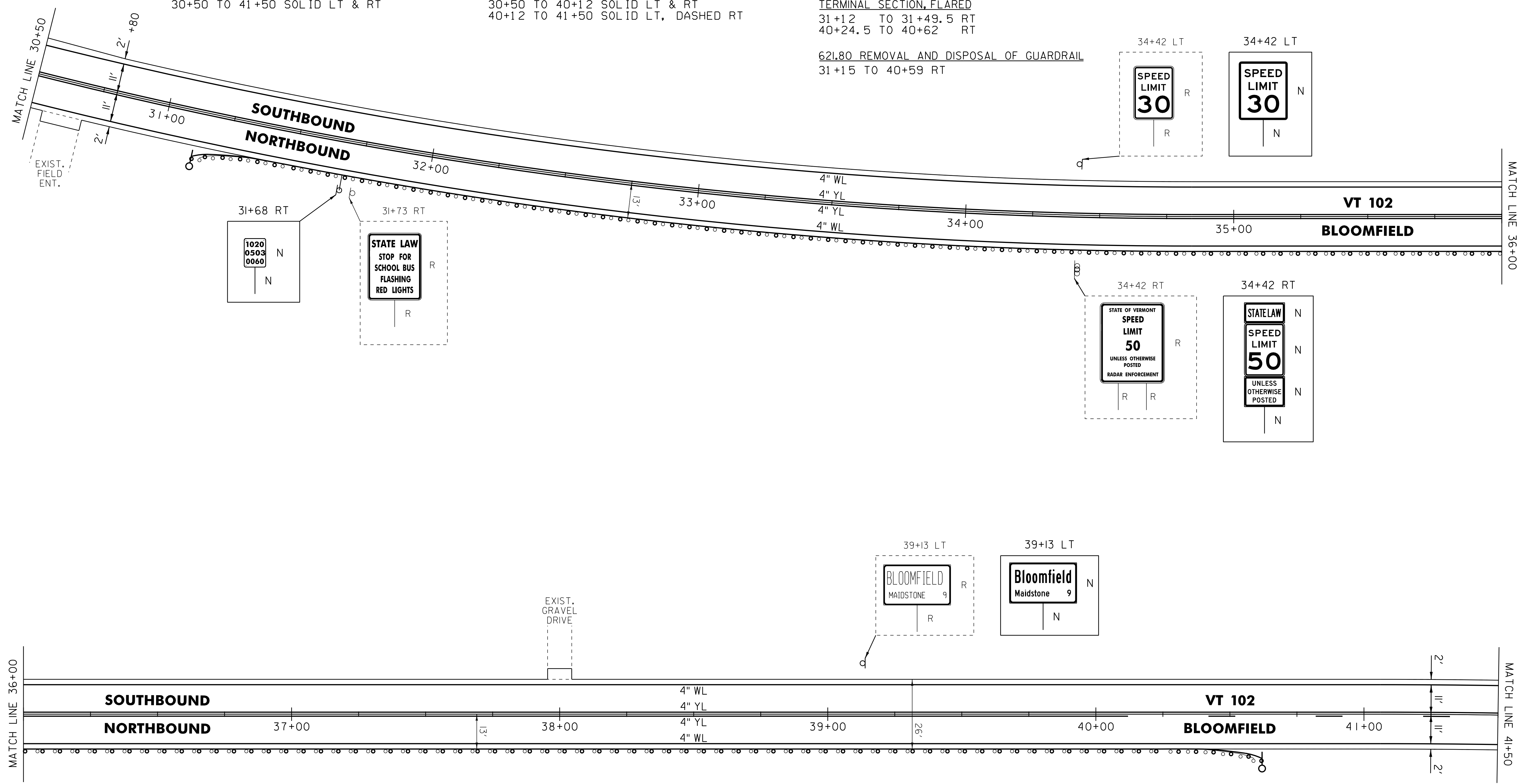

NOT TO SCALE

LEGEND

R	=	REMOVE EXISTING
S	=	SALVAGE
R&S	=	REMOVE AND SALVAGE
N	=	NEW
RET	=	RETAIN
B-B	=	BACK TO BACK
—○—	=	EXISTING GUARDRAIL
—○—	=	PROPOSED GUARDRAIL
YL	=	YELLOW LINE
WL	=	WHITE LINE
—○—	=	DELINEATOR

ROADWAY LAYOUT 2

PROJECT NAME: BLOOMFIELD-LEMINGTON
 PROJECT NUMBER: STP 2610(I)
 FILE NAME: /pave/06c052/pc052
 PROJECT LEADER: PTS
 DESIGNED BY: NLL
 IPARM FILE NAME: 06C052_16

PLOT DATE: 19-JUN-2013 16:59
 DRAWN BY: SNG
 CHECKED BY: PTS
 SHEET 16 OF 82