

641.10 - TRAFFIC CONTROL
 LONGITUDINAL PEDESTRIAN CHANNELIZING DEVICES
 42+08.30 LT - 42+75.03 LT
 TEMPORARY SIDEWALK
 42+06.42 LT - 42+77.68 LT

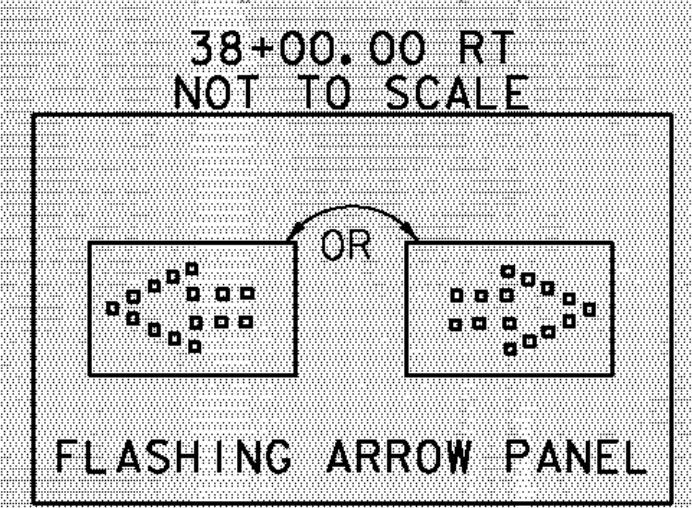
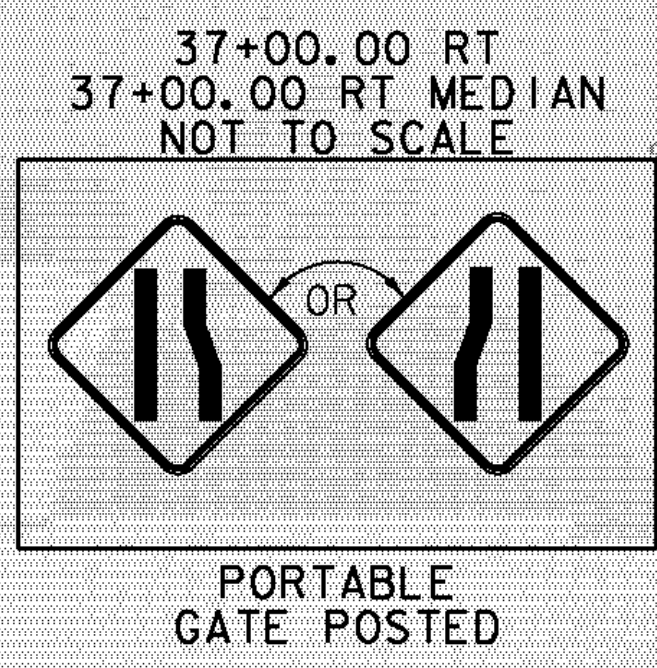
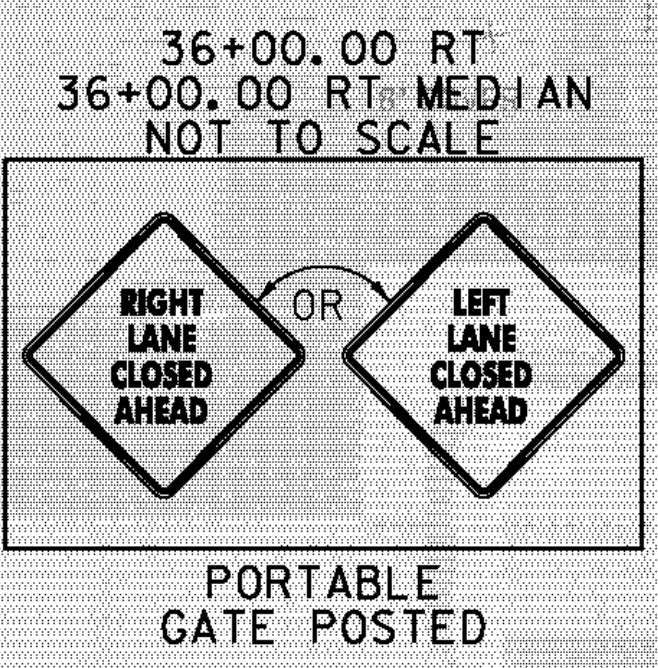
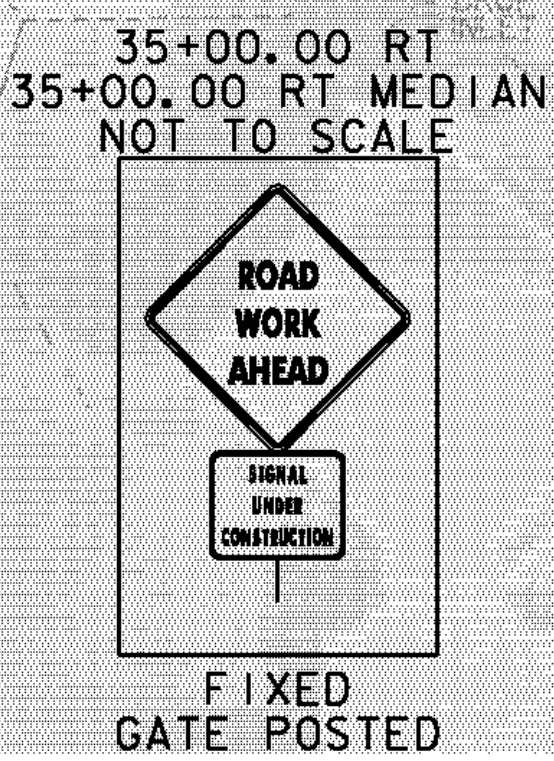
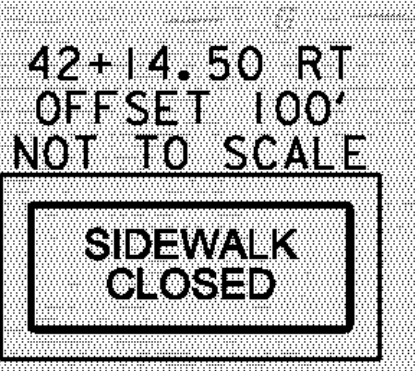
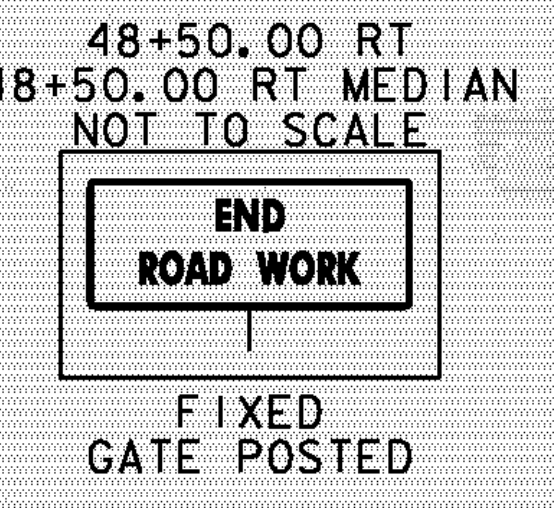
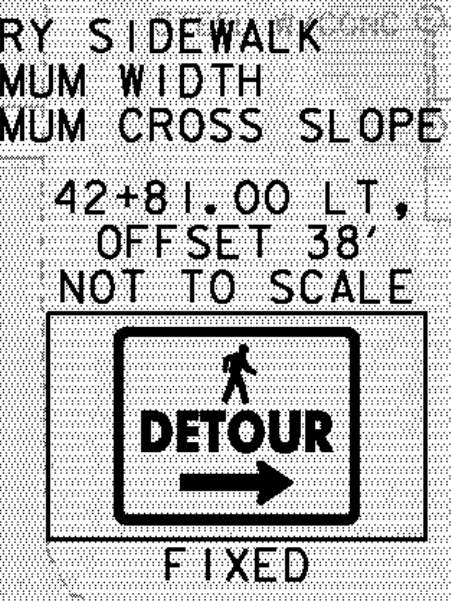
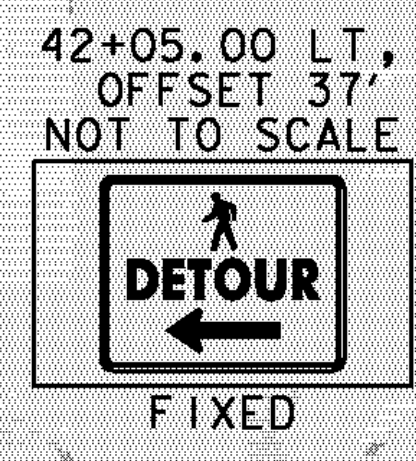
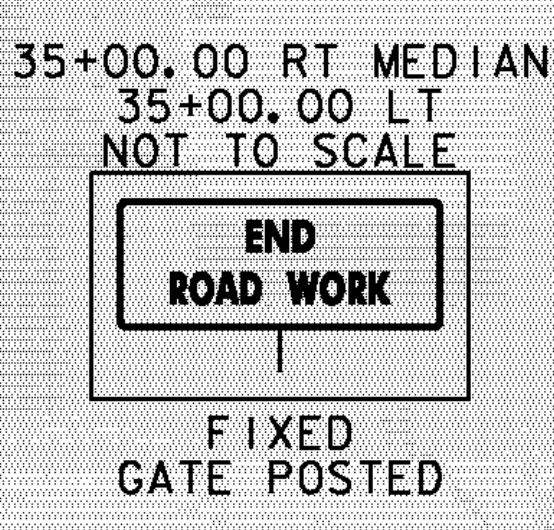
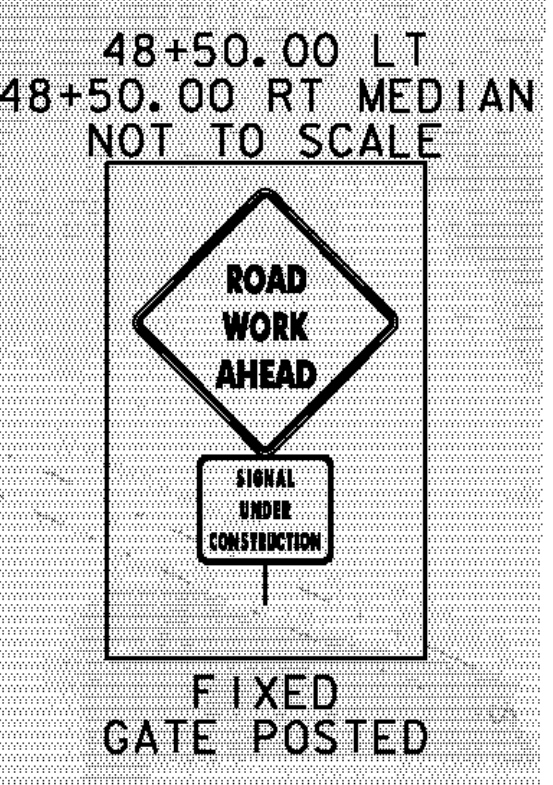
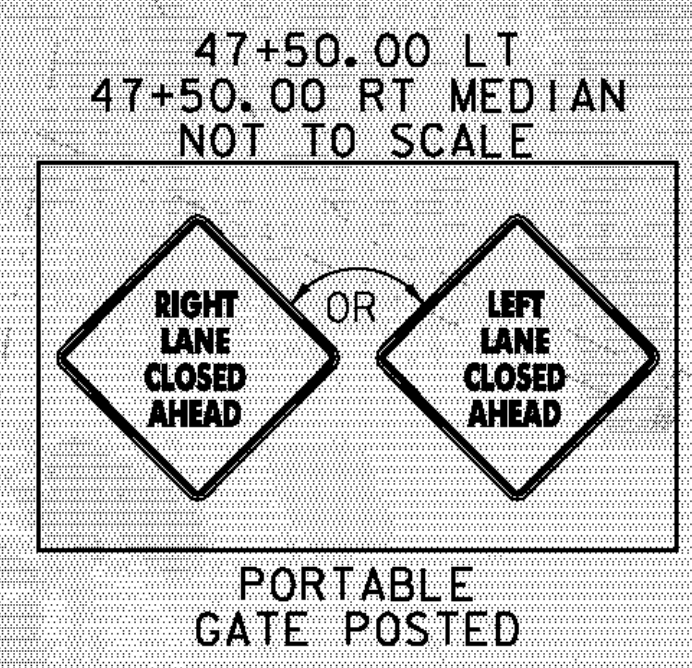
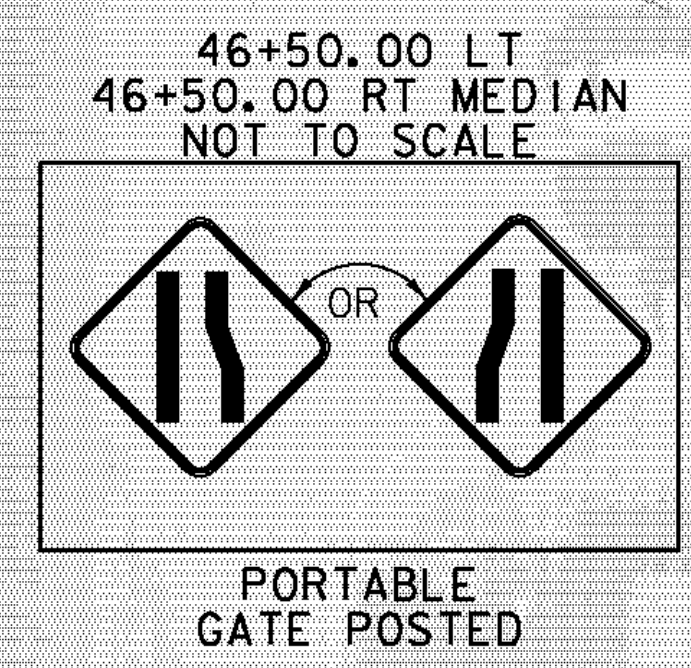
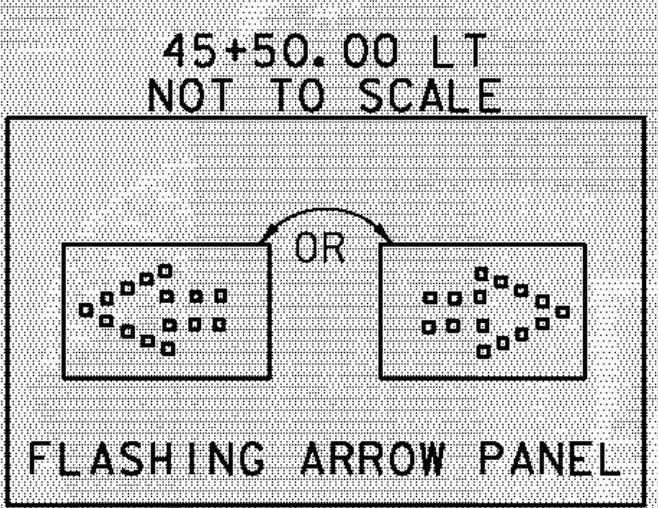

TEMPORARY TRAFFIC CONTROL NOTES:

1. NO CONSTRUCTION SIGNS SHALL BE INSTALLED AS TO INTERFERE OR OBSTRUCT THE VIEW OF EXISTING TRAFFIC DEVICES AND STOPPING SIGHT DISTANCES
2. TEMPORARY LANE AND/OR SHOULDER CLOSURES SHALL BE ALLOWED ONLY UNDER THE FOLLOWING CONDITIONS:
 WESTBOUND LANE CLOSURES SHALL NOT OCCUR BEFORE 9:00 AM AND EASTBOUND LANE CLOSURES SHALL NOT OCCUR AFTER 3:00 PM. WHEN A LANE IS CLOSED, A UTO WITH A BLUE LIGHT SHALL BE PRESENT. REFER TO MUTCD FIGURE 6H-33 STATIONARY LANE CLOSURE ON A DIVIDED HIGHWAY (TYPICAL APPLICATION 33) FOR DETAILS NOT SHOWN ON THIS SHEET. VT ROUTE 15 SHALL BE RESTORED TO FULL CAPACITY AT THE CLOSE OF DAILY CONSTRUCTION ACTIVITIES.
3. TEMPORARY SIDEWALK AND LONGITUDINAL PEDESTRIAN CHANNELIZING DEVICES SHALL MEET ALL REQUIREMENTS AS DESCRIBED IN MUTCD PART 6 TEMPORARY TRAFFIC CONTROL SECTION 6D PEDESTRIAN AND WORKER SAFETY. TAPE, ROPE OR PLASTIC CHAIN SHALL NOT BE STRUNG BETWEEN CHANNELIZING DEVICES PER MUTCD REGULATIONS.
4. ADDITIONAL TRAFFIC CONTROL WARNING DEVICES MAY BE REQUIRED AND SHALL BE INSTALLED AS REQUESTED BY THE RESIDENT ENGINEER PER THE MUTCD. PAYMENT FOR TRAFFIC CONTROL WARNING DEVICES WILL BE MADE UNDER CONTRACT ITEM 641.10.
5. ACCESS TO RESIDENTIAL DRIVES, COMMERCIAL DRIVES, AND TOWN HIGHWAYS SHALL BE MAINTAINED THROUGHOUT THE PROJECT'S DURATION.

PROJECT NAME: COLCHESTER
 PROJECT NUMBER: TCSP TCSE (9)

FILE NAME: t06b242+cbdr.dgn
 PROJECT LEADER: J. SCHULTZ
 DESIGNED BY: D. LYMAN
 TRAFFIC CONTROL PLAN

PLOT DATE: 23-FEB-2012
 DRAWN BY: D. LYMAN
 CHECKED BY: J. SCHULTZ
 SHEET 22 OF 22

