

EQUIPMENT ITEM 678.I5	QUANTITY
ECONOLITE ASC/3-2100 TRAFFIC SIGNAL CONTROLLER	1
ECONOLITE *P44* BASE MOUNTED CONTROLLER CABINET WITH 15-INCH EXTENDED BASE ON A CONCRETE FOUNDATION, PAINTED FLAT BLACK WITH ANCILLARY CONTROL EQUIPMENT	1
FLAT BLACK PAINTED STEEL MAST ARM SIGNAL POLE WITH 33 FOOT MAST ARM AND 36 FOOT MAST ARM (MAPI)	1
FLAT BLACK PAINTED PEDESTAL POST (8')	4
ONE WAY, 3-SECTION, HAWK, 12-INCH POLYCARBONATE MAST ARM MOUNTED LED TRAFFIC SIGNAL HEAD WITH TUNNEL VISORS AND 5* LOUVERED BACKPLATES WITH ALL PIECES PAINTED FLAT BLACK (BACKPLATES SHALL HAVE A 2* YELLOW RETROREFLECTIVE STRIP AROUND PERIMETER)	5
POST MOUNTED 16-INCH LED COUNTDOWN PEDESTRIAN SIGNAL HEAD WITH AUDIBLE INDICATORS	4
VTRANS SPEC ACCESSIBLE PEDESTRIAN PUSH BUTTONS WITH R10-3e TYPE SIGN ASSEMBLY	4
ASTRO-BRACKETS	5
ENCOM MODEL EP-5200, RS-232, SHELF MOUNT RADIO	1
YAGI ANTENNA, 8.5 DB, 900 MHZ	1
LIGHTNING PROTECTION	1
6' RF JUMPER CABLE	1
ENCOM DATA CABLE, CB-81	1
LMR COAXIAL CABLE, CB-1055	1

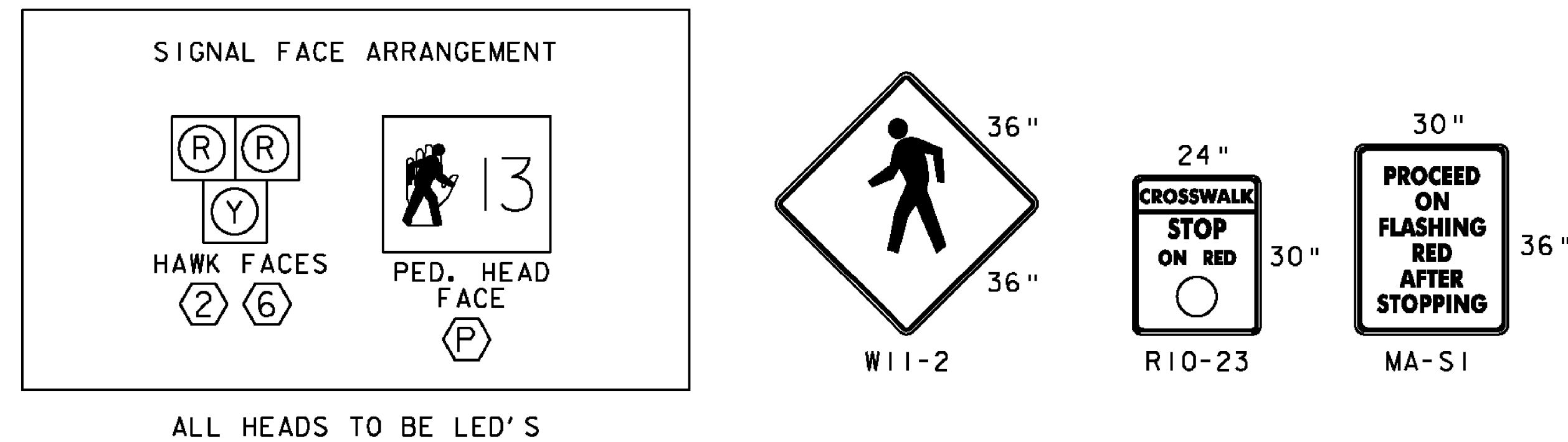

678.23 - WIRED CONDUIT (PVC) (SCH 80)	CONDUIT SIZE			DESCRIPTION
	2"	3"	4"	
POWER TO HDD			57'	*POWER SERVICE
HDD TO STANCHION			21'	*POWER SERVICE
STANCHION TO CONTROLLER		23'		POWER
PB1 TO CONTROLLER		45' (3X15)		POWER AND SPARE
PB1 TO P1	17'			POWER
PB3 TO P4	16'			POWER
PB2 TO P3	28'			POWER
PB2 TO MAPI		16'		POWER
PB2 TO P2	27'			POWER
SUBTOTALS	88'	84'	78'	
ROUNDING	7'	6'	7'	
TOTALS	95'	90'	85'	

\*-CONDUIT QUANTITY INCLUDES PVC RUN ON UTILITY POLE #33/33. ELECTRICAL SERVICE CONDUIT SHALL REMAIN AS ONE CONTINUOUS RUN FROM POLE TO STANCHION AND SHALL NOT ENTER ANY PULL BOXES. HORIZONTAL DIRECTIONAL DRILLING (HDD) SHALL BE PAID FOR AS SPECIAL PROVISION 900.640 ITEM AND NOT AS 678.23 WIRED CONDUIT.

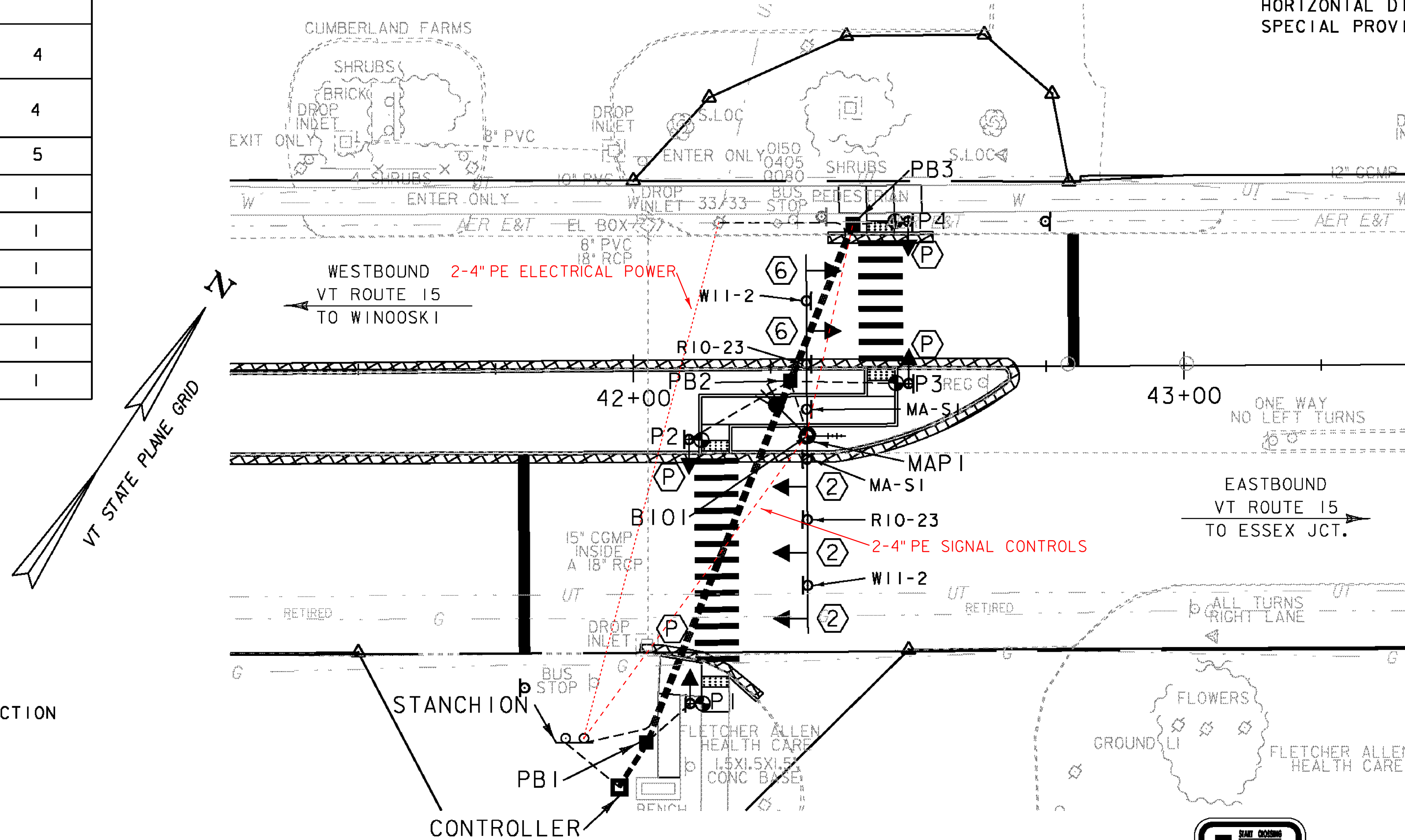

SIGNAL PHASING NOTES:

- SIGNAL HEADS SHALL REMAIN IN THE DARK MODE IF THERE IS NO PEDESTRIAN ACTIVATION.
- WHEN PUSH BUTTON IS ACTIVATED THE SIGNAL HEADS SHALL GO TO FLASHING YELLOW FOR 5 SECONDS. THE SIGNAL HEADS SHALL THEN GO TO SOLID YELLOW FOR 4 SECONDS.
- THE SIGNAL HEADS SHALL GO TO SOLID RED FOR 5 SECONDS (BOTH RED SECTIONS) AND PEDESTRIAN SIGNAL HEADS SHALL SHOW WALK AND COUNT DOWN SHALL BEGIN.
- THE SIGNAL HEADS SHALL SHOW FLASHING ALTERNATING RED FOR 11 SECONDS FOR WEST BOUND VT ROUTE 15 AND 15 SECONDS FOR EAST BOUND VT ROUTE 15 AND THE PEDESTRIAN SIGNAL HEADS SHALL SHOW FLASHING "DON'T WALK" WITH THE CORRESPONDING COUNT DOWN DISPLAY. THE PEDESTRIAN SIGNAL HEADS SHALL SHOW SOLID "DON'T WALK" FOR THE FINAL 4 SECONDS OF EACH PHASE AS A BUFFER INTERVAL.
- THE SIGNAL HEADS SHALL RETURN TO DARK MODE UNTIL ANOTHER PEDESTRIAN ACTIVATION. THE PEDESTRIAN SIGNAL SHALL SHOW THE SOLID "DON'T WALK".
- THE CONTRACTOR SHALL BE RESPONSIBLE FOR PROGRAMMING THE CONTROLLER SUCH THAT IT WILL RUN IN COORDINATION WITH THE ADJACENT COORDINATED SIGNAL SYSTEM. THE CONTRACTOR SHALL CONTACT THE ENGINEER FOR ANY EXISTING TIMING INFORMATION AS NEEDED.

678.15 TRAFFIC CONTROL SIGNAL SYSTEM, INTERSECTION

MAST ARM POLE  
STA 42+31.50 RT (12.40' RT) MAPI

CABINET/CONTROLLER  
STA 41+97 RT (76.00' RT)

POWER STANCHION  
STA 41+89.00 RT (68.00' RT)

PEDESTRIAN SIGNAL POLES  
STA 42+10.00 RT (61.00' RT) P1  
STA 42+10.00 RT (13.00' RT) P2  
STA 42+50.00 RT ( 3.00' RT) P3  
STA 42+50.00 LT (26.50' LT) P4

678.25 PULL BOX, STANDARD  
STA 42+02.00 RT (68.00' RT) PB1  
STA 42+28.50 RT ( 2.45' RT) PB2  
STA 42+40.00 LT (26.00' LT) PB3

679.47 BRACKET ARM  
STA 42+31.50 RT - 250W - HPS FULL-CUTOFF (MAPI)

679.50 LUMINAIRE  
STA 42+31.50 RT - 250W - HPS FULL-CUTOFF (MAPI)

SPECIAL PROVISION 900.640  
(HORIZONTAL DIRECTIONAL DRILLING) (4 X 4" SCH. 80 HDPE CASING PIPES)  
STA 42+02.00 RT - 42+40.00 LT JBI - JB3

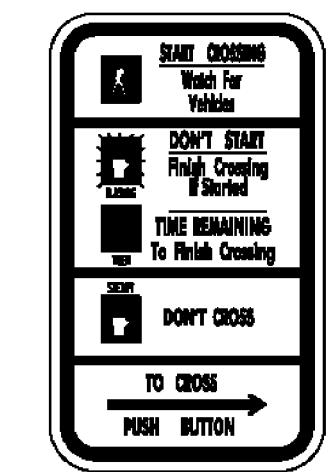
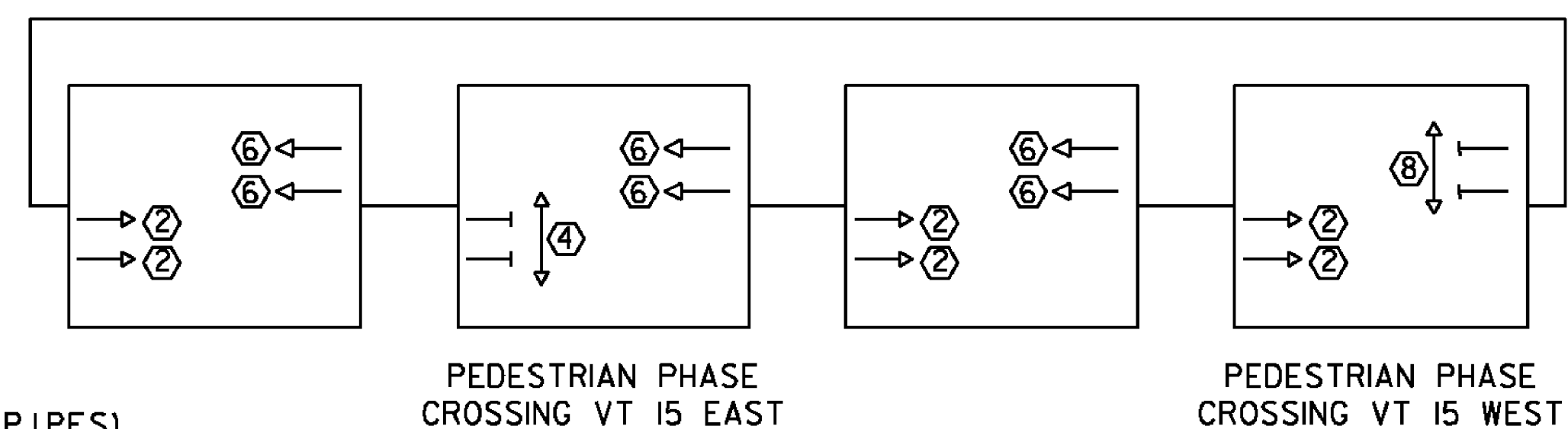

PEDESTRIAN PUSHBUTTON SIGN

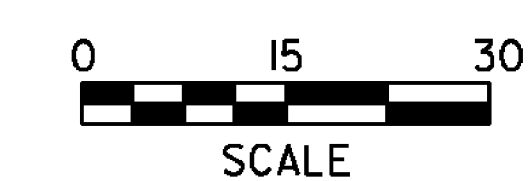

EXISTING	NEW	LEGEND
		UTILITY POLE
		LUMINAIRE
		STRAIN POLE
		CONTROLLER CABINET
		PULLBOX/JUNCTION BOX
		SIGNAL HEAD
		CONDUIT
		PEDESTAL POST
		STANCHION
		RADIO ANTENNA
		PEDESTRIAN PUSH BUTTON

PROJECT NAME: COLCHESTER	PROJECT NUMBER: TCSP TCSE (9)
FILE NAME: +06b242+.dgn	PLOT DATE: 23-FEB-2012
PROJECT LEADER: J. SCHULTZ	DRAWN BY: D. LYMAN
DESIGNED BY: D. LYMAN	CHECKED BY: J. SCHULTZ
TRAFFIC SIGNAL PLAN	SHEET 11 OF 22