

616.21 - VERTICAL GRANITE CURB
 STA 38+86.67 RT - 39+05.72 RT
 STA 41+00.00 RT - 42+11.87 RT (MEDIAN WITH SLOPE TO VERTICAL TRANSITION SECTION)
 STA 41+00.00 RT - 42+42.00 RT (MEDIAN WITH SLOPE TO VERTICAL TRANSITION SECTION)
 STA 42+00.97 RT - 42+12.20 RT
 STA 42+12.37 RT - 42+42.50 LT (MEDIAN)
 STA 42+17.16 RT - 42+22.34 RT
 STA 42+17.37 RT - 42+47.50 LT (MEDIAN)
 STA 42+17.87 RT - 42+36.63 RT (MEDIAN)
 STA 42+35.50 LT - 42+42.50 LT
 STA 42+36.63 RT - 42+68.37 RT (MEDIAN) (70' RAD)
 STA 42+47.50 LT - 42+54.50 LT
 STA 42+48.00 RT - 42+67.73 RT (MEDIAN)
 STA 42+67.73 RT - 42+68.37 RT (MEDIAN) (2' RAD)

616.28 - CAST-IN-PLACE CONCRETE CURB, TYPE B
 STA 39+16.28 RT - 39+35.93 RT (DRIVE)
616.40 - REMOVING AND RESETTNG CURB
 *AS NEEDED TO INSTALL NEW VERTICAL GRANITE CURB
616.41 - REMOVAL OF EXISTING CURB
 STA 38+86.66 RT - 38+93.89 RT
 STA 38+98.72 RT - 39+05.72 RT
 STA 39+16.27 RT - 39+23.28 RT (DRIVE)
 STA 39+28.70 RT - 39+35.93 RT (DRIVE)
 STA 42+00.97 RT - 42+22.35 RT
 STA 41+00.00 RT - 41+00.00 RT (MEDIAN)
 STA 42+35.50 LT - 42+54.50 LT

618.10 - PORTLAND CEMENT CONCRETE SIDEWALK, 5 INCH
 STA 42+04.17 RT - 42+08.24 RT (4' WIDTH)
 STA 42+04.24 RT - 42+12.17 RT (SLOPED PAD)
 STA 42+12.39 RT - 42+17.12 RT (RAMP)
 STA 42+12.39 RT - 42+47.50 RT (MEDIAN ISLAND)
 STA 42+37.49 LT - 42+52.49 LT (RAMP)
CONSTRUCT SIDEWALK RAMP
 STA 42+14.65 RT - RAMP TYPE 1
 STA 42+14.87 RT - MEDIAN ISLAND CUT THROUGH
 STA 42+45.00 RT - MEDIAN ISLAND CUT THROUGH
 STA 42+45.00 LT - RAMP TYPE 2

618.30 - DETECTABLE WARNING SURFACE
 STA 42+14.65 RT
 STA 42+14.87 RT (MEDIAN)
 STA 42+45.00 RT (MEDIAN)
 STA 42+45.00 LT
 NOTE: DETECTABLE WARNING SURFACES SHALL BE CAST IRON FROM ONE OF MANUFACTURERS ON THE AGENCY'S APPROVED PRODUCTS LIST
653.40 - INLET PROTECTION, TYPE I
 STA 42+39.68 LT

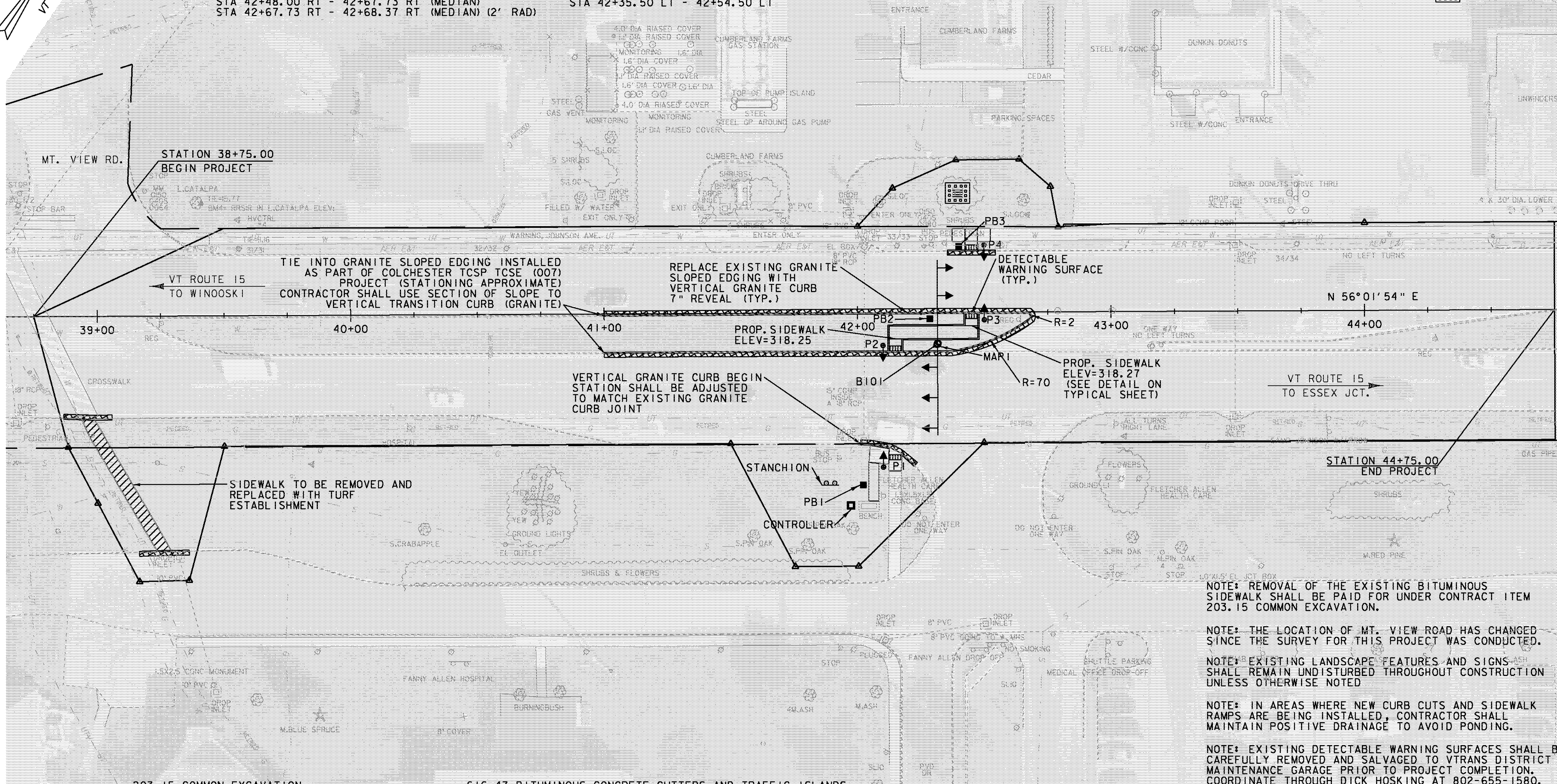

203.15 COMMON EXCAVATION
 STA 38+93.64 RT - 39+28.81 RT (SIDEWALK REMOVAL)

616.47 BITUMINOUS CONCRETE GUTTERS AND TRAFFIC ISLANDS
 STA 38+86.67 RT - 39+05.72 RT
 STA 39+16.28 RT - 39+35.95 RT
 STA 41+00.00 LT - 41+00.00 RT (MEDIAN)
 STA 42+00.97 RT - 42+23.35 RT
 STA 42+35.50 LT - 42+54.50 LT

NOTE: REMOVAL OF THE EXISTING BITUMINOUS SIDEWALK SHALL BE PAID FOR UNDER CONTRACT ITEM 203.15 COMMON EXCAVATION.
 NOTE: THE LOCATION OF MT. VIEW ROAD HAS CHANGED SINCE THE SURVEY FOR THIS PROJECT WAS CONDUCTED.
 NOTE: EXISTING LANDSCAPE FEATURES AND SIGNS SHALL REMAIN UNDISTURBED THROUGHOUT CONSTRUCTION UNLESS OTHERWISE NOTED
 NOTE: IN AREAS WHERE NEW CURB CUTS AND SIDEWALK RAMPS ARE BEING INSTALLED, CONTRACTOR SHALL MAINTAIN POSITIVE DRAINAGE TO AVOID PONDING.
 NOTE: EXISTING DETECTABLE WARNING SURFACES SHALL BE CAREFULLY REMOVED AND SALVAGED TO VTRANS DISTRICT 5 MAINTENANCE GARAGE PRIOR TO PROJECT COMPLETION. COORDINATE THROUGH DICK HOSKING AT 802-655-1580.

PROJECT NAME: COLCHESTER
 PROJECT NUMBER: TCSP TCSE (9)

FILE NAME: t06b242bdr.dgn
 PROJECT LEADER: J. SCHULTZ
 DESIGNED BY: D. LYMAN
 CONSTRUCTION PLAN
 PLOT DATE: 23-FEB-2012
 DRAWN BY: D. LYMAN
 CHECKED BY: J. SCHULTZ
 SHEET 10 OF 22

