

616.21 - VERTICAL GRANITE CURB
 STA 38+86.67 RT - 39+05.72 RT
 STA 41+00.00 RT - 42+17.87 RT (MEDIAN WITH SLOPE TO VERTICAL TRANSITION SECTION)
 STA 41+00.00 RT - 42+42.00 RT (MEDIAN WITH SLOPE TO VERTICAL TRANSITION SECTION)
 STA 42+00.97 RT - 42+12.20 RT
 STA 42+12.37 RT - 42+42.50 LT (MEDIAN)
 STA 42+17.16 RT - 42+22.34 RT (MEDIAN)
 STA 42+17.87 RT - 42+47.50 LT (MEDIAN)
 STA 42+17.87 RT - 42+36.63 RT (MEDIAN)
 STA 42+35.50 LT - 42+42.50 LT
 STA 42+36.63 RT - 42+68.37 RT (MEDIAN) (70' RAD)
 STA 42+47.80 LT - 42+54.50 LT
 STA 42+48.00 RT - 42+67.73 RT (MEDIAN)
 STA 42+67.73 RT - 42+68.37 RT (MEDIAN) (2' RAD)

616.28 - CAST-IN-PLACE CONCRETE CURB, TYPE B
 STA 39+16.28 RT - 39+35.93 RT (DRIVE)
 616.40 - REMOVING AND RESETTING CURB
 *AS NEEDED TO INSTALL NEW VERTICAL GRANITE CURB
 616.41 - REMOVAL OF EXISTING CURB
 STA 38+86.66 RT - 38+93.89 RT
 STA 38+98.72 RT - 39+05.72 RT
 STA 39+16.27 RT - 39+23.28 RT (DRIVE)
 STA 39+28.70 RT - 39+35.93 RT (DRIVE)
 STA 42+00.97 RT - 42+22.35 RT
 STA 41+00.00 RT - 41+00.00 RT (MEDIAN)
 STA 42+35.50 LT - 42+54.50 LT

618.10 - PORTLAND CEMENT CONCRETE SIDEWALK, .5 INCH
 STA 42+04.17 RT - 42+08.24 RT (4' WIDTH)
 STA 42+04.24 RT - 42+12.17 RT (SLOPED PAD)
 STA 42+12.39 RT - 42+17.12 RT (RAMP)
 STA 42+12.39 RT - 42+47.50 RT (MEDIAN ISLAND)
 STA 42+37.49 LT - 42+52.49 LT (RAMP)
 CONSTRUCT SIDEWALK RAMP
 STA 42+14.65 RT - RAMP TYPE 1
 STA 42+14.87 RT - MEDIAN ISLAND CUT THROUGH
 STA 42+45.00 RT - MEDIAN ISLAND CUT THROUGH
 STA 42+45.00 LT - RAMP TYPE 2

618.30 - DETECTABLE WARNING SURFACE
 STA 42+14.65 RT
 STA 42+14.87 RT (MEDIAN)
 STA 42+45.00 RT (MEDIAN)
 STA 42+45.00 LT
 NOTE: DETECTABLE WARNING SURFACES SHALL BE CAST IRON FROM ONE OF MANUFACTURERS ON THE AGENCY'S APPROVED PRODUCTS LIST
 653.40 - INLET PROTECTION, TYPE 1
 STA 42+39.68 LT

NIF ST. MICHAELS COLLEGE

CUMBERLAND FARMS, INC.

NIF ZAHARIADIS

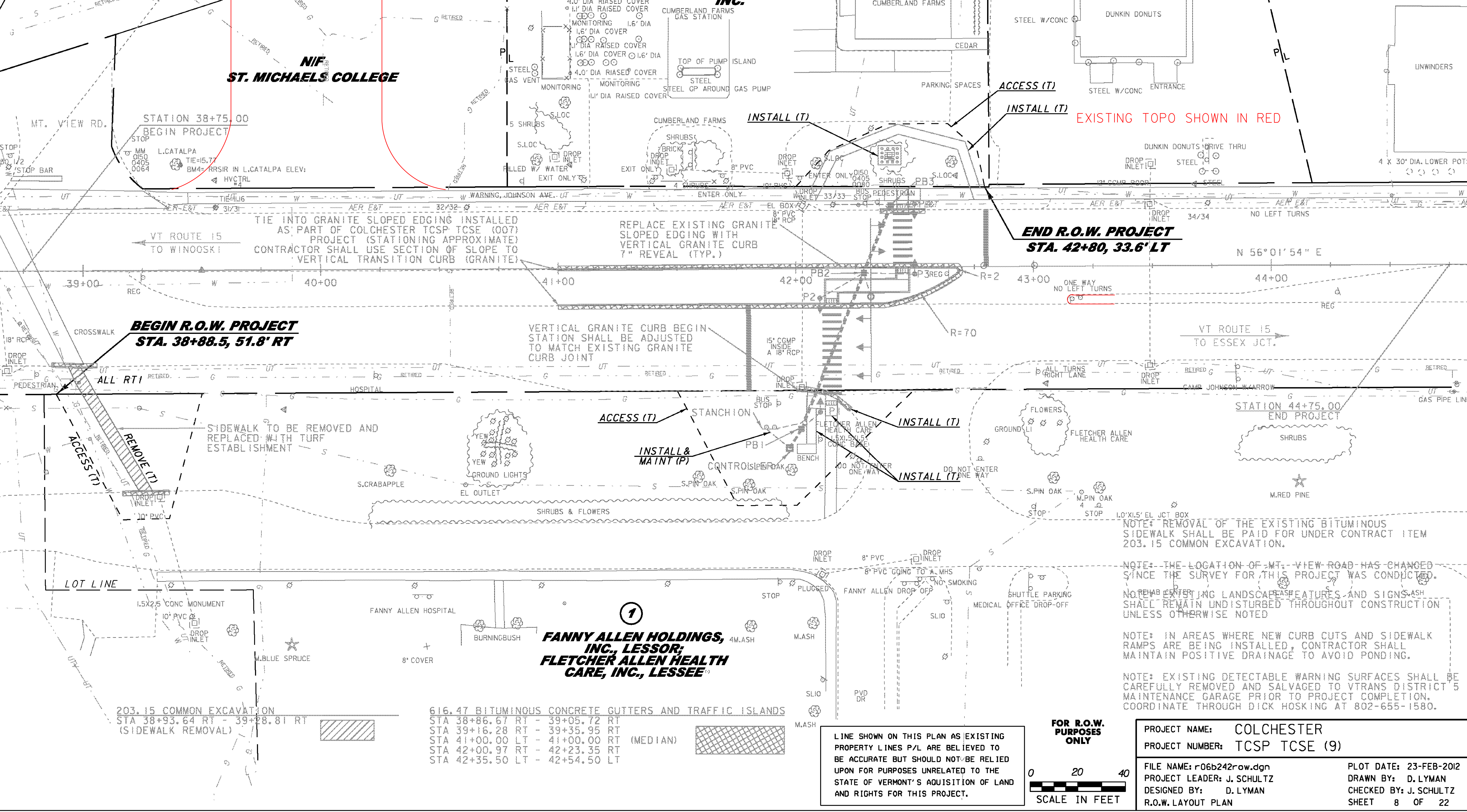

BEGIN R.O.W. PROJECT STA. 38+88.5, 51.8' RT

END R.O.W. PROJECT STA. 42+80, 33.6' LT

BEGIN R.O.W. PROJECT STA. 38+88.5, 51.8' RT

STATION 44+75.00 END PROJECT

FANNY ALLEN HOLDINGS, INC., LESSOR; FLETCHER ALLEN HEALTH CARE, INC., LESSEE

203.15 COMMON EXCAVATION
 STA 38+93.64 RT - 39+28.81 RT (SIDEWALK REMOVAL)

616.47 BITUMINOUS CONCRETE GUTTERS AND TRAFFIC ISLANDS
 STA 38+86.67 RT - 39+05.72 RT
 STA 39+16.28 RT - 39+35.95 RT
 STA 41+00.00 LT - 41+00.00 RT (MEDIAN)
 STA 42+00.97 RT - 42+23.35 RT
 STA 42+35.50 LT - 42+54.50 LT

LINE SHOWN ON THIS PLAN AS EXISTING PROPERTY LINES P/L ARE BELIEVED TO BE ACCURATE BUT SHOULD NOT BE RELIED UPON FOR PURPOSES UNRELATED TO THE STATE OF VERMONT'S ACQUISITION OF LAND AND RIGHTS FOR THIS PROJECT.

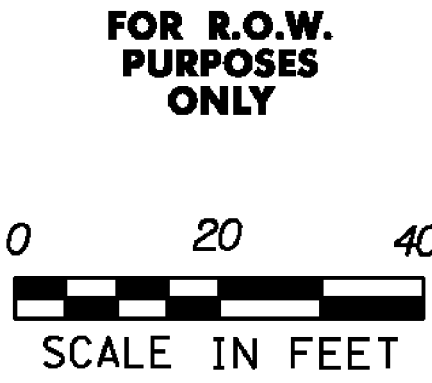

PROJECT NAME:	COLCHESTER	PLOT DATE:	23-FEB-2012
PROJECT NUMBER:	TCSP TCSE (9)	DRAWN BY:	D. LYMAN
FILE NAME:	r06b242row.dgn	CHECKED BY:	J. SCHULTZ
PROJECT LEADER:	J. SCHULTZ	R.O.W. LAYOUT PLAN	SHEET 8 OF 22
DESIGNED BY:	D. LYMAN		

NOTE: REMOVAL OF THE EXISTING BITUMINOUS SIDEWALK SHALL BE PAID FOR UNDER CONTRACT ITEM 203.15 COMMON EXCAVATION.

NOTE: THE LOCATION OF MT. VIEW ROAD HAS CHANGED SINCE THE SURVEY FOR THIS PROJECT WAS CONDUCTED. NO NEW EXISTING LANDSCAPE FEATURES AND SIGNS SHALL REMAIN UNDISTURBED THROUGHOUT CONSTRUCTION UNLESS OTHERWISE NOTED

NOTE: IN AREAS WHERE NEW CURB CUTS AND SIDEWALK RAMPS ARE BEING INSTALLED, CONTRACTOR SHALL MAINTAIN POSITIVE DRAINAGE TO AVOID PONDING.

NOTE: EXISTING DETECTABLE WARNING SURFACES SHALL BE CAREFULLY REMOVED AND SALVAGED TO VTRANS DISTRICT 5 MAINTENANCE GARAGE PRIOR TO PROJECT COMPLETION. COORDINATE THROUGH DICK HOSKING AT 802-655-1580.