

646.402 DURABLE 4 INCH WHITE LINE, THERMOPLASTIC
 (ALL LINES WILL INCLUDE EDGE LINE BREAKS AND RADIUS FOR TOWN HIGHWAYS)
 VT. ROUTE 67:
 STA 12+00.00 - STA 16+00.00 EDGE LINE LT/RT
 STA 12+90.00 - STA 15+00.00 DASHED LINE LT

646.412 DURABLE 4 INCH YELLOW LINE, THERMOPLASTIC
 (ALL LINES WILL INCLUDE C/L BREAKS FOR TOWN HIGHWAYS) S=SOLID, D=DASHED
 VT. ROUTE 67:
 STA 12+00.00 - STA 16+00.00 LT C RT S - S
 STA 14+78.40 DOUBLE SOLID LT, BANK STREET
 STA 15+57.60 DOUBLE SOLID RT, CHURCH STREET

646.482 DURABLE 24 INCH STOP BAR, THERMOPLASTIC
 VT. ROUTE 67:
 STA 14+78.40 LT, BANK STREET
 STA 15+57.60 RT, CHURCH STREET

646.682 TEMPORARY 24 INCH STOP BAR, PAINT
 VT. ROUTE 67:
 STA 14+78.40 LT, BANK STREET
 STA 15+57.60 RT, CHURCH STREET

646.512 DURABLE RAILROAD CROSSING SYMBOL, THERMOPLASTIC
 VT. ROUTE 67:
 STA 13+12.0 LT (1EA)

646.712 TEMPORARY RAILROAD CROSSING SYMBOL, PAINT
 VT. ROUTE 67:
 STA 13+12.0 LT (2 EA)

646.602 TEMPORARY 4 INCH WHITE LINE, PAINT
 (ALL LINES WILL INCLUDE EDGE LINE BREAKS AND RADIUS FOR TOWN HIGHWAYS)
 VT. ROUTE 67:
 STA 12+00.00 - STA 16+00.00 EDGE LINE LT/RT
 STA 12+90.00 - STA 15+00.00 DASHED LINE LT

646.612 TEMPORARY 4 INCH YELLOW LINE, PAINT
 (ALL LINES WILL INCLUDE C/L BREAKS FOR TOWN HIGHWAYS) S=SOLID, D=DASHED
 VT. ROUTE 67:
 STA 12+00.00 - STA 16+00.00 LT C RT S - S
 STA 14+78.40 DOUBLE SOLID LT, BANK STREET
 STA 15+57.60 DOUBLE SOLID RT, CHURCH STREET

646.492 DURABLE LETTER OR SYMBOL, THERMOPLASTIC
 VT. ROUTE 67:
 STA 14+78.40 LT, BANK STREET "S,T,O,P" (4 EA)
 STA 15+57.60 RT, CHURCH STREET "S,T,O,P" (4 EA)

646.692 TEMPORARY LETTER OR SYMBOL, PAINT
 VT. ROUTE 67:
 STA 14+78.40 LT, BANK STREET "S,T,O,P" (8 EA)
 STA 15+57.60 RT, CHURCH STREET "S,T,O,P" (8 EA)

646.502 DURABLE CROSSWALK MARKING, THERMOPLASTIC
 VT. ROUTE 67:
 STA 15+57.60 RT, CHURCH STREET

646.702 TEMPORARY CROSSWALK MARKING, PAINT
 VT. ROUTE 67:
 STA 15+57.60 RT, CHURCH STREET

646.442 DURABLE 8 INCH WHITE LINE, THERMOPLASTIC
 VT. ROUTE 67:
 STA 15+60.00 - STA 15+70.00 FIRE HYDRANT, NO PARKING, LT

675.50 REMOVING SIGNS
 AS SHOWN - 6

675.60 ERECTING SALVAGED SIGNS
 AS SHOWN - 2

629.20 ADJUST ELEV. OF VALVE BOX
 STA 13+22, LT
 STA 14+51, LT
 STA 15+75, LT

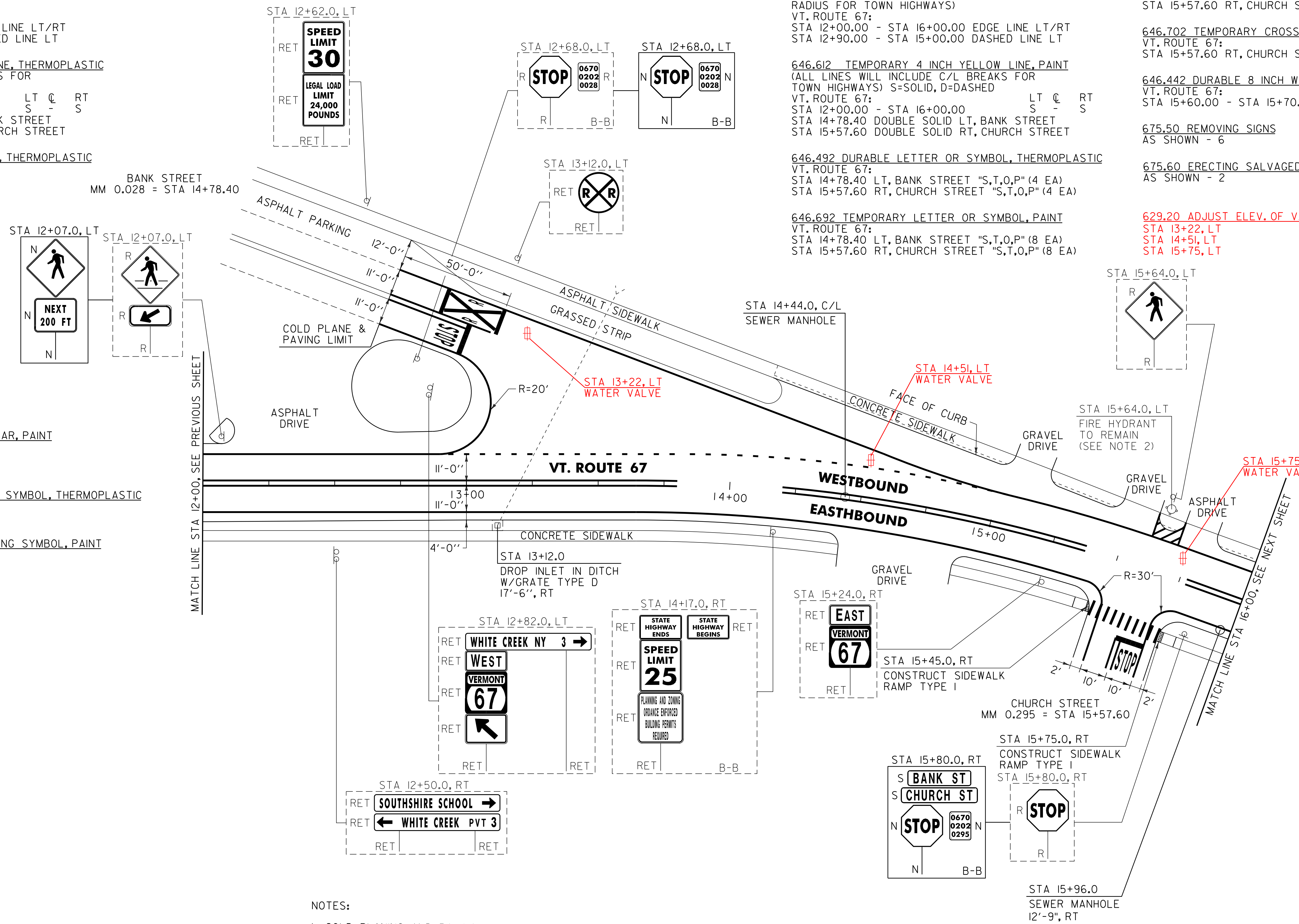

NOTES:

1. COLD PLANING AND PAVING LIMIT ON ALL TOWN HIGHWAYS SHALL BE MEASURED 25 FT BACK FROM VT. ROUTE 67 EDGE OF SHOULDER UNLESS DENOTED OTHERWISE ON THE PLANS OR AS DIRECTED BY THE RESIDENT ENGINEER.

2. SEE SHEET 8 FOR FIRE HYDRANT PAVEMENT MARKINGS DETAIL.

3. THE CONTRACTOR SHALL REHAB. THE EXISTING DROP INLETS, CATCH BASINS OR MANHOLES TO A DEPTH AS DIRECTED BY THE RESIDENT ENGINEER. ALL REHAB. WORK WILL BE PAID FOR UNDER THE APPLICABLE REHAB. ITEM AS DIRECTED BY THE RESIDENT ENGINEER. ALL EXISTING UTILITIES MARKED "TO REMAIN" SHALL NOT BE ALTERED OR REHABILITATED UNLESS DIRECTED OTHERWISE BY THE RESIDENT ENGINEER.

SIGN LEGEND

R	= REMOVE
S	= SALVAGE
N	= NEW
RET	= RETAIN
B-B	= BACK TO BACK
EXISTING	= - - - - -
NEW	= _____

NOT TO SCALE

PROJECT LAYOUT SHEET #2	PROJECT NAME: BENNINGTON (NORTH BENNINGTON) CLASS 1	FILE NAME: p06b212.dgn	PLOT DATE: 07-MAY-2012 14:2
	PROJECT NUMBER: STP 2622(1)	PROJECT LEADER: D.E.G.	DRAWN BY: C.A.K.
	DESIGNED BY: M.J.M.	CHECKED BY: R.A.B.	DWG. NO. p06b212.i

~~604.412, 604.415 OR 604.418 REHAB. DROP INLETS, CATCH BASINS OR MANHOLES (SEE NOTE 3)~~
 VT. ROUTE 67:
 STA 13+12.0 RT NO WORK

~~604.42 CHANGING ELEVATION OF SEWER MANHOLES~~
 VT. ROUTE 67:
 STA 14+44.0 C/L * SEE NOTE, SHEET 19
 STA 15+96.0 RT