

646.402 DURABLE 4 INCH WHITE LINE, THERMOPLASTIC
 (ALL LINES WILL INCLUDE EDGE LINE BREAKS AND
 RADIUS FOR TOWN HIGHWAYS)
 VT. ROUTE 67A:
 STA 20+00.00 - STA 25+00.00 EDGE LINE LT/RT
 STA 20+00.00 - STA 20+85.00 DOTTED LANE LINE LT
 STA 20+00.00 - STA 20+85.00 DOTTED LANE LINE RT
 STA 20+00.00 - STA 25+00.00 DASHED LANE LINE LT
 STA 20+00.00 - STA 25+00.00 DASHED LANE LINE RT
 STA 23+15.00 - STA 24+95.00 DOTTED LANE LINE RT
 STA 23+15.00 - STA 25+00.00 DOTTED LANE LINE RT
 STA 24+95.00 - STA 25+00.00 SOLID LANE LINE RT

646.602 TEMPORARY 4 INCH WHITE LINE, PAINT
 (ALL LINES WILL INCLUDE EDGE LINE BREAKS AND
 RADIUS FOR TOWN HIGHWAYS)
 VT. ROUTE 67A:
 STA 20+00.00 - STA 25+00.00 EDGE LINE LT/RT
 STA 20+00.00 - STA 20+85.00 DOTTED LANE LINE LT
 STA 20+00.00 - STA 20+85.00 DOTTED LANE LINE RT
 STA 20+00.00 - STA 25+00.00 DASHED LANE LINE LT
 STA 20+00.00 - STA 25+00.00 DASHED LANE LINE RT
 STA 23+15.00 - STA 24+95.00 DOTTED LANE LINE RT
 STA 23+15.00 - STA 25+00.00 DOTTED LANE LINE RT
 STA 24+95.00 - STA 25+00.00 SOLID LANE LINE RT

646.492 DURABLE 4 INCH WHITE LINE, THERMOPLASTIC
 VT. ROUTE 67A:
 STA 25+00.00 C/L ARROW (1EA)
 646.692 TEMPORARY LETTER OR SYMBOL, PAINT
 VT. ROUTE 67A:
 STA 25+00.00 C/L ARROW (2 EA)

646.412 DURABLE 4 INCH YELLOW LINE, THERMOPLASTIC
 (ALL LINES WILL INCLUDE C/L BREAKS FOR
 TOWN HIGHWAYS) S=SOLID, D=DASHED
 VT. ROUTE 67A:
 STA 20+00.00 - STA 25+00.00 MEDIAN EDGE LINE LT/RT

646.612 TEMPORARY 4 INCH YELLOW LINE, PAINT
 (ALL LINES WILL INCLUDE C/L BREAKS FOR
 TOWN HIGHWAYS) S=SOLID, D=DASHED
 VT. ROUTE 67A:
 STA 20+00.00 - STA 25+00.00 MEDIAN EDGE LINE LT/RT

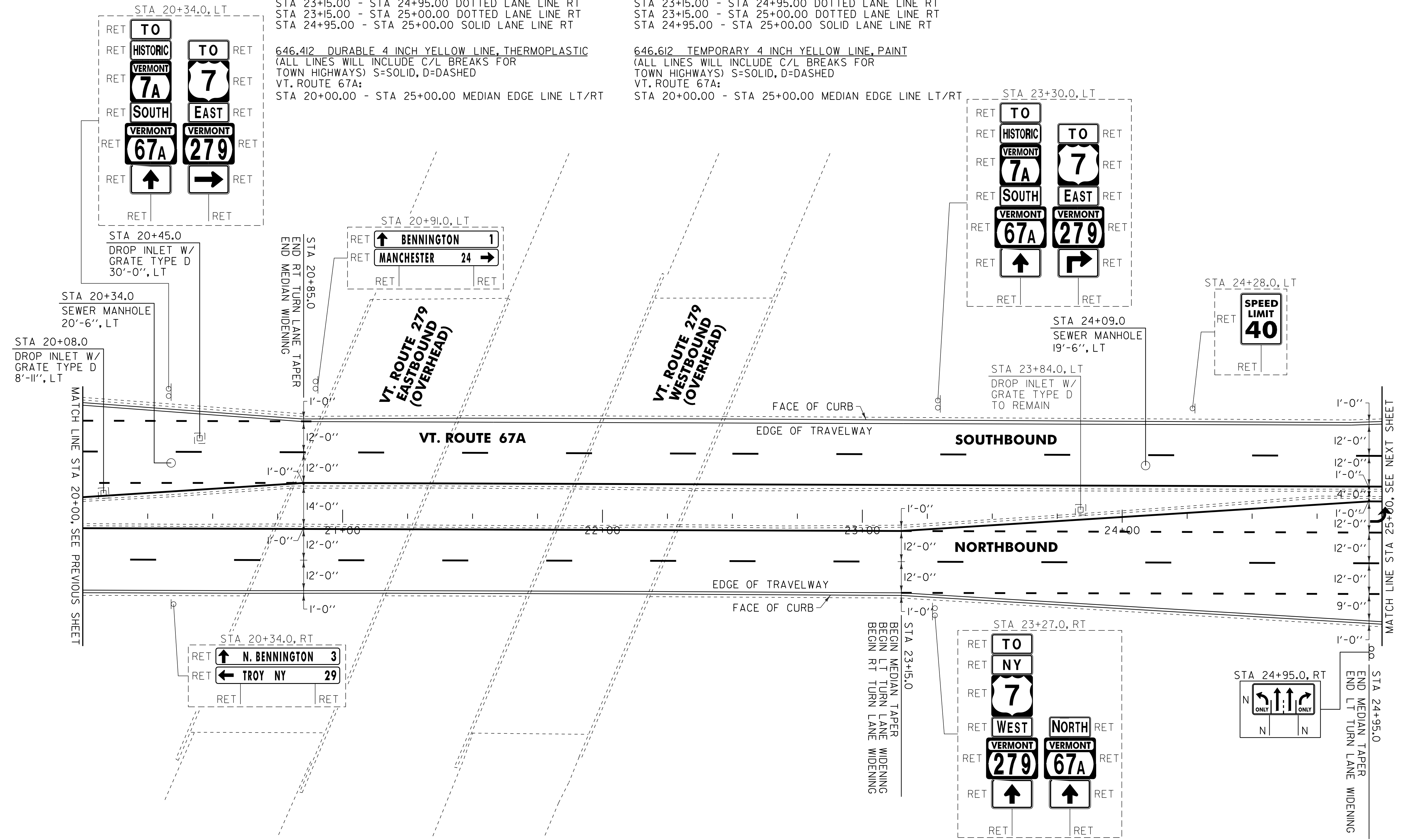

604.412, 604.415, 604.418 REHAB. DROP INLETS, CATCH
 BASINS, OR MANHOLES CLASS I, II, OR III (SEE NOTE D)
 VT. ROUTE 67A:
 STA 20+08.0 LT
 STA 20+45.0 LT NO WORK

604.42 CHANGING ELEVATION OF SEWER MANHOLES
 VT. ROUTE 67A:
 STA 20+34.0 LT
 STA 24+09.0 LT

646.81 PAINTED CURB
 VT. ROUTE 67A:
 STA 20+55.0 - STA 21+15.0 LT (60.0 LF)
 STA 22+85.0 - STA 23+45.0 RT (60.0 LF)
 STA 24+45.0 - STA 25+00.0 LT (110.0 LF)

NOTE:
 1. THE CONTRACTOR SHALL REHAB. THE EXISTING DROP INLETS,
 CATCH BASINS OR MANHOLES TO A DEPTH AS DIRECTED BY
 THE RESIDENT ENGINEER. ALL REHAB. WORK WILL BE PAID FOR
 UNDER THE APPLICABLE REHAB. ITEM AS DIRECTED BY THE
 RESIDENT ENGINEER. ALL EXISTING UTILITIES MARKED "TO
 REMAIN" SHALL NOT BE ALTERED OR REHABILITATED UNLESS
 DIRECTED OTHERWISE BY THE RESIDENT ENGINEER.

SIGN LEGEND
 R = REMOVE
 S = SALVAGE
 N = NEW
 RET = RETAIN
 B-B = BACK TO BACK
 EXISTING = - - - - -
 NEW = _____

NOT TO SCALE

PROJECT LAYOUT SHEET #5	PROJECT NAME: BENNINGTON	PLOT DATE: 07-MAY-2012 14:2
	PROJECT NUMBER: STP 2626(1)	DRAWN BY: C.A.K.
	FILE NAME: p06b220.dgn	CHECKED BY: D.E.G.
	DESIGNED BY: M.J.L.	DWG. NO. p06b220105.i
		SHEET 23 OF 69