

GEOTEXTILE FOR SILT FENCE	SEED	HAY MULCH	VEHICLE TRACKING PAD
STA. BL 1+999, 11.7m LT. - STA. BL 2+010, 20.7m LT.	STA. BL 2+000.027 - STA. BL 2+099.095, LT. & RT.	STA. BL 2+000.027 - STA. BL 2+099.095, LT. & RT.	STA. NB 6+164 - STA. NB 6+179
STA. BL 2+008, 14.9m LT. - STA. BL 2+018, 21.5m LT.			
STA. BL 2+016, 15.9m LT. - STA. BL 2+029, 21.0m LT.			
STA. BL 2+026, 15.8m LT. - STA. BL 2+057, 15.6m LT.			
STA. BL 2+054, 14.0m LT. - STA. BL 2+076, 15.4m LT.			
STA. BL 2+075, 14.8m LT. - STA. BL 2+094, 12.0m LT.			
STA. BL 2+094, 14.5m LT. - STA. BL 2+098, 9.6m LT.			
STA. BL 2+098, 13.6m LT. - STA. BL 2+103, 11.9m LT.			
STA. BL 2+101, 8.8m LT. - STA. BL 2+111, 14.0m LT.			

**STA. BL 2+000
BEGIN PROJECT**

**2+115.6
STA. BL 2+100
END PROJECT**

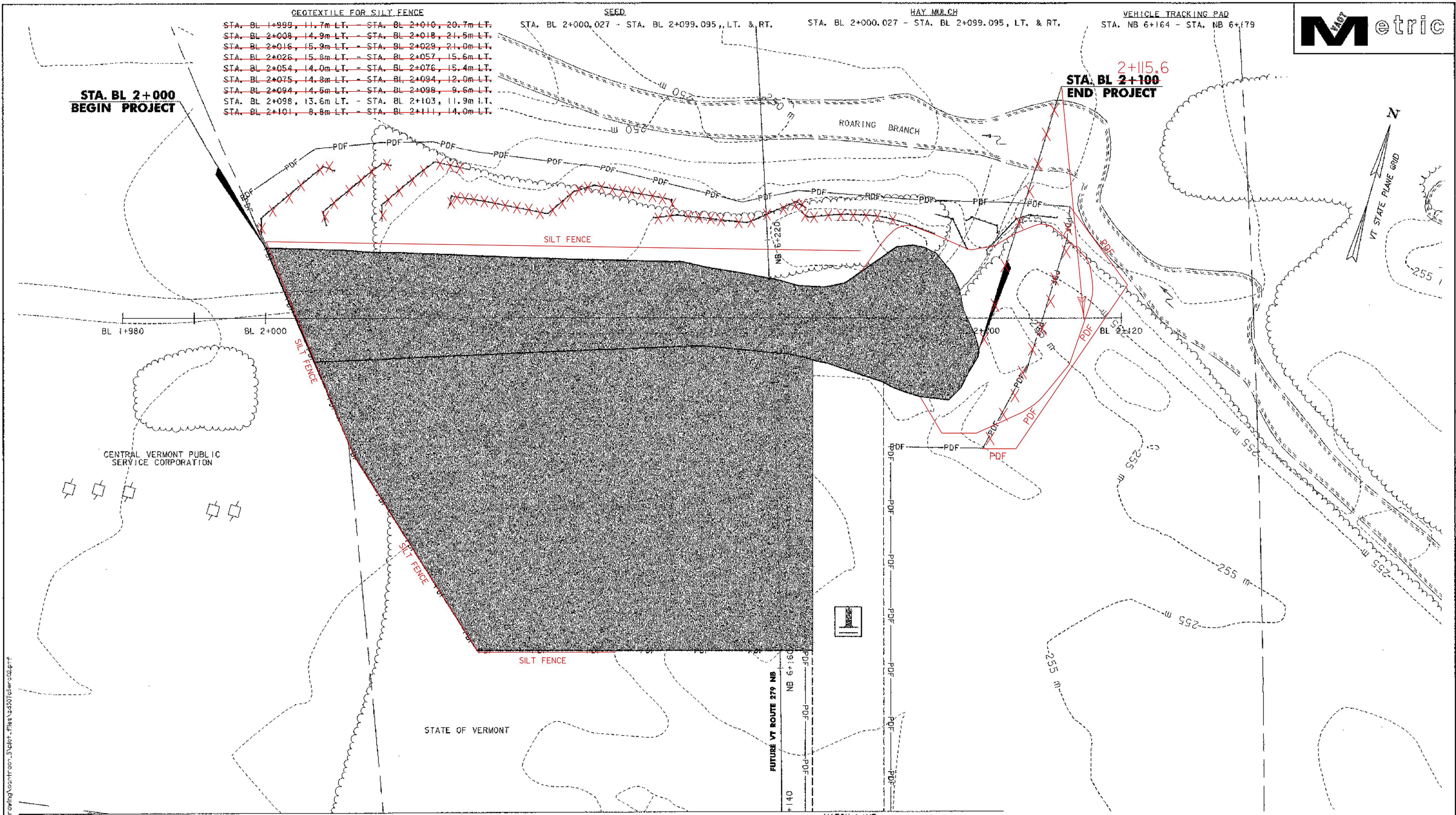

CENTRAL VERMONT PUBLIC SERVICE CORPORATION

STATE OF VERMONT

FUTURE VT ROUTE 279 NB

MATCH LINE
STA. NB 6+140,
SEE SHEET EC-01

LEGEND

- VEHICLE TRACKING PAD
- TEMPORARY EROSION MATTING
- SEED AND HAY MULCHING
- SILT FENCE

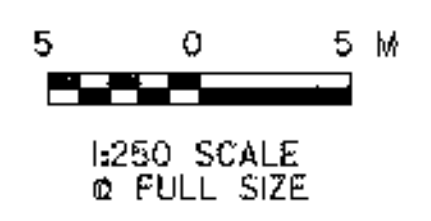

VERMONT AGENCY OF TRANSPORTATION



PROJECT NAME: BENNINGTON	PLOT DATE: 3/28/2008
PROJECT NUMBER: NH 019-1(55)	DRAWN BY: STANTEC
FILE NAME: ...\\pof_files\zd307c5era02.ptf	CHECKED BY: GARY SANTY
DESIGN SUPERVISOR: GREG EDWARDS	SHEET 13 OF 19
DESIGNED BY: MARC FOISY	
EROSION CONTROL PLAN EC-02	

V:\1853\active\18530002\transportation\ec\ec-02\ec-02.dwg