

INDEX OF SHEETS

1	-	TITLE SHEET
2	TS-01	TYPICAL SECTIONS
3	-	QUANTITY SHEET
4-9	-	ROW DETAILS
10-11	P-01 - P-02	GENERAL PLAN SHEETS / FINAL STABILIZATION PLAN
12-13	EC-01 - EC-02	EROSION CONTROL PLAN SHEETS
14-15	ECD-01 - ECD-02	EROSION CONTROL DETAIL SHEETS
16	CAS-01	CONSTRUCTION APPROACH SIGNING
17-19	BL-01 - BL-03	BASELINE CROSS SECTIONS

INDEX OF STANDARDS

E-100	CONSTRUCTION APPROACH SIGNS	01/02/04
E-100A	SIDE ROAD CONSTRUCTION APPROACH SIGNS	01/02/04
E-101	CONSTRUCTION SIGN DETAILS	05/30/03
E-102	CONSTRUCTION SIGN DETAILS	06/30/03
E-121	STANDARD SIGN PLACEMENT	08/08/95
E-141	REGULATORY SIGN DETAILS	09/20/95
E-160	FLANGED CHANNEL STEEL SIGN POST	05/20/99
F-2	CHAIN LINK FENCE, TYPE I	06/01/94
F-4	CHAIN LINK FENCE, TYPE II	06/01/94

STATE OF VERMONT
AGENCY OF TRANSPORTATION

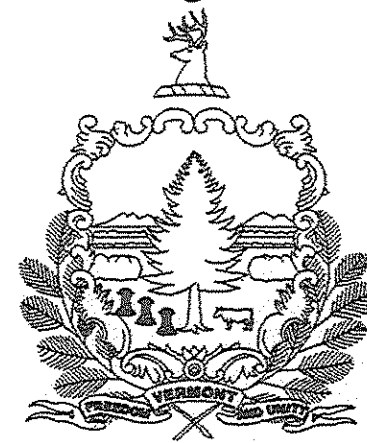

PROPOSED IMPROVEMENT
TOWN OF BENNINGTON
COUNTY OF BENNINGTON
WWII VETERANS MEMORIAL HIGHWAY
VT ROUTE 279, PRINCIPAL ARTERIAL
BENNINGTON NH 019-1(55)

BEGINNING AT STA. NB 6+210, AT A POINT APPROXIMATELY 190 METERS NORTH OF VT ROUTE 9 EXTENDING PARALLEL TO VT ROUTE 9, 71 METERS LEFT OF STA. NB 6+210 TO 29 METERS RIGHT OF STA. NB 6+210. WORK TO BE PERFORMED UNDER THIS PROJECT INCLUDES REMOVAL, TREATMENT AND DISPOSAL OF CONTAMINATED SOILS. THIS CONTRACT ALSO INCLUDES CONSTRUCTION OF A TEMPORARY ROAD TO ACCESS THE CONTAMINATED SOILS SITE.

LENGTH OF PROJECT:
100 METERS = 0.100 KILOMETERS

STA. BL 2+000
BEGIN PROJECT

STA. BL 2+100
END PROJECT

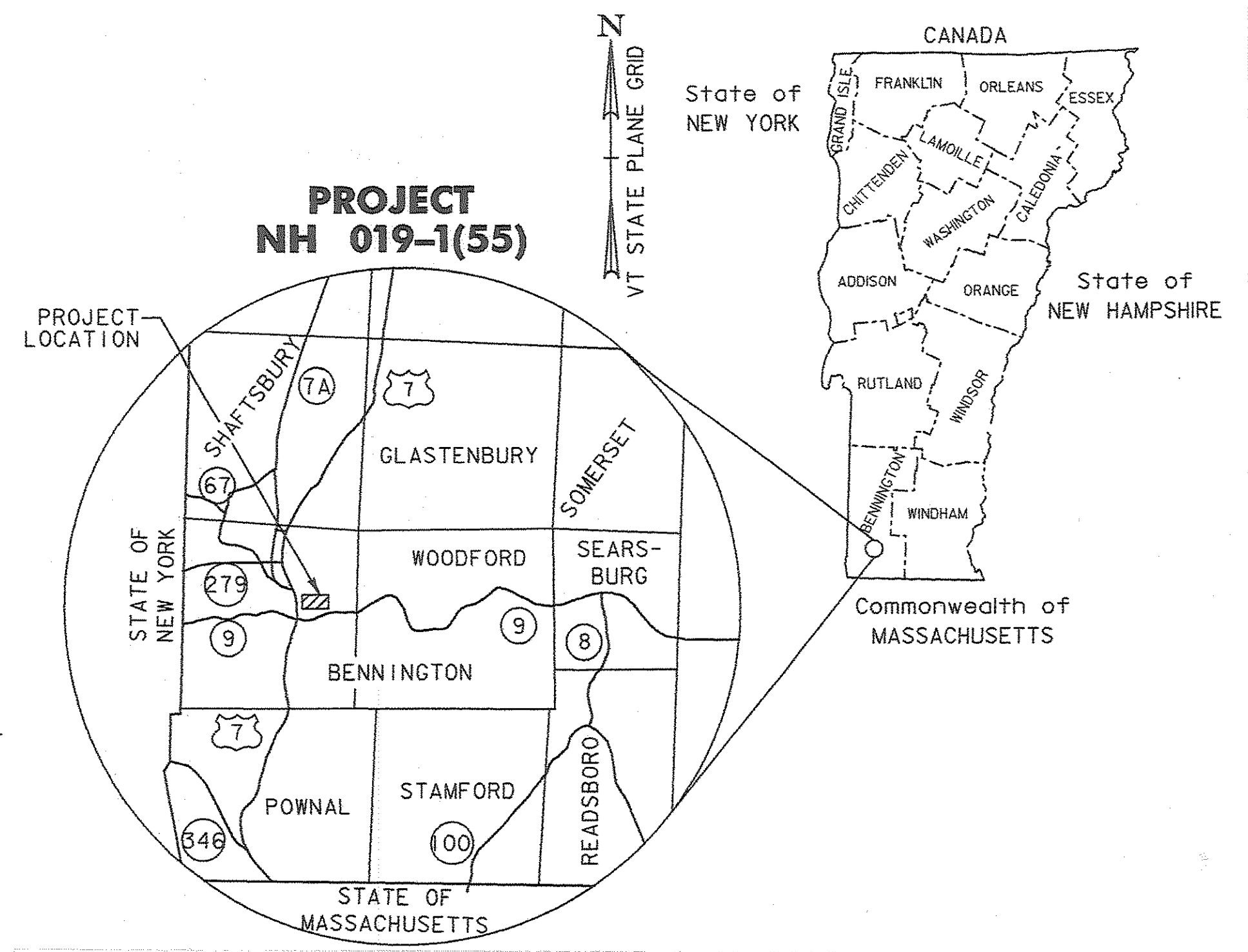
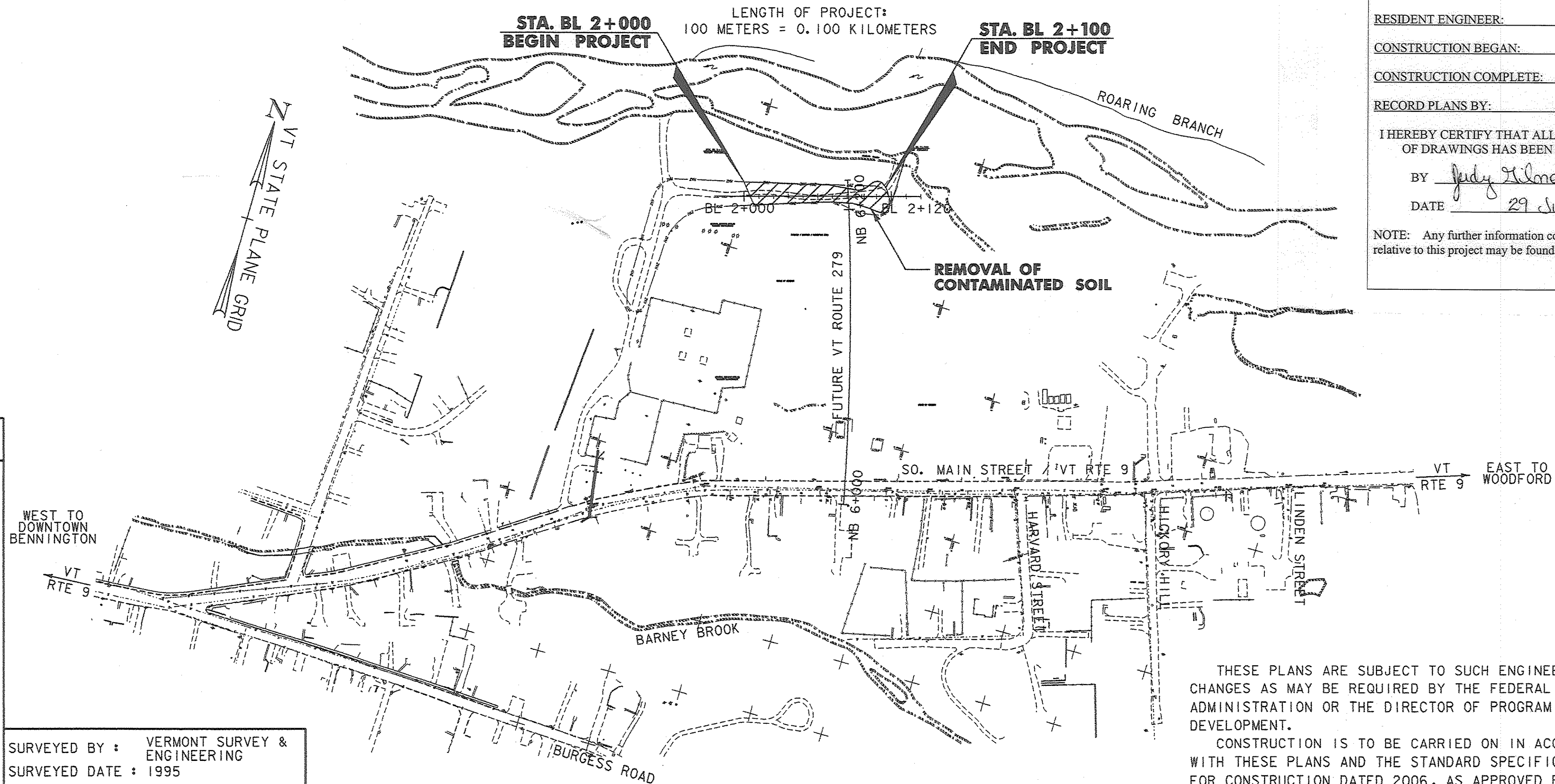

RECORD PLANS

CONTRACTOR: PIKE INDUSTRIES, INC. - BERLIN, VT

RESIDENT ENGINEER: JUDY GILMORE

CONSTRUCTION BEGAN: JULY 15, 2008

CONSTRUCTION COMPLETE: SEPTEMBER 12, 2008

RECORD PLANS BY: JUDY GILMORE, N. GARBACK

I HEREBY CERTIFY THAT ALL THE CONSTRUCTION REQUIRED BY THIS SET OF DRAWINGS HAS BEEN ACCOMPLISHED AS INDICATED HEREIN.

BY Judy Gilmore RESIDENT ENGINEER

DATE 29 July 2009

NOTE: Any further information concerning final quantities, amounts or other details relative to this project may be found at Central Files in the electronic archives.

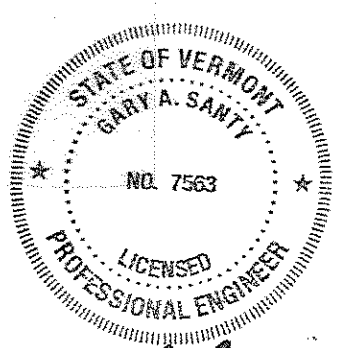

Handwritten signature and date: May 6/03/2008

CONVENTIONAL SYMBOLS

COUNTY LINE	— — — — —
TOWN LINE	— — — — —
LIMITS OF ACCESS	— — — — —
POINT OF ACCESS	X
FENCE LINE	X — X — X — X —
STONE WALL	— — — — —
TRAVELED WAY	— — — — —
RAILROAD	— — — — —
SURVEY LINE	— — — — —
CULVERT	— — — — —
POWER POLE	— — — — —
TELEPHONE POLE	— — — — —
TREES	— — — — —
CONTROL OF ACCESS	— — — — —
PROPERTY LINE	— — — — —
R.O.W. TAKING LINE	— — — — —
SLOPE RIGHTS	— — — — —
TOP OF CUT	— — — — —
TOE OF SLOPE	— — — — —
ARCHEOLOGICAL	— — — — —
CLEAR ZONE	— — — — —
WETLAND DELINEATION	— — — — —

SURVEYED BY: VERMONT SURVEY & ENGINEERING

SURVEYED DATE: 1995

DATUM

VERTICAL	NAVD88
HORIZONTAL	NAD83 (1992)

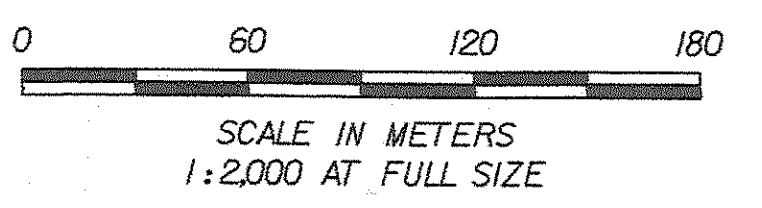

THESE PLANS ARE SUBJECT TO SUCH ENGINEERING CHANGES AS MAY BE REQUIRED BY THE FEDERAL HIGHWAY ADMINISTRATION OR THE DIRECTOR OF PROGRAM DEVELOPMENT.

CONSTRUCTION IS TO BE CARRIED ON IN ACCORDANCE WITH THESE PLANS AND THE STANDARD SPECIFICATIONS FOR CONSTRUCTION DATED 2006, AS APPROVED BY THE FEDERAL HIGHWAY ADMINISTRATION ON JUNE 15, 2006 FOR USE ON THIS PROJECT, INCLUDING ALL SUBSEQUENT REVISIONS AND SUCH REVISED SPECIFICATIONS AND SPECIAL PROVISIONS AS ARE INCORPORATED IN THESE PLANS.

Metric

UNLESS NOTED OTHERWISE

STATIONS ARE IN KILOMETERS
ELEVATIONS ARE IN METERS
DIMENSIONS ARE IN MILLIMETERS

DEPARTMENT OF TRANSPORTATION
FEDERAL HIGHWAY ADMINISTRATION
APPROVED Maed D. Keltner DATE 4-22-08
DIVISION ADMINISTRATOR

DIRECTOR OF PROGRAM DEVELOPMENT
APPROVED Paul J. Schmitt DATE 4-2-08

PROJECT MANAGER: JAMES HARRIS

PROJECT NAME: BENNINGTON
PROJECT NUMBER: NH 019-1(55)

SHEET 1 OF 19 SHEETS