

STREET LIGHTING LOCATIONS

POLE NO.	LOCATION	BREAK-AWAY BASE	LUMINAIRE			LUMINAIRE MOUNTING HT. TO ROADWAY (M)	TRANSFORMER BASE HT. (M)	ARM RISE (M)	ARM LENGTH (M)	CONCRETE BASE DIAM / DEPTH (mm) / (mm)
			WATTS	DIST. TYPE	VOLTAGE					
SL-1	SB 10+180.0, 4.2m LT.	YES	200	III	240	10.600	0.500	0.762	0.610	610/1828
SL-7	SB 10+060.0, 3.6m LT.	NO	200	III	240	10.600	0.500	0.762	0.610	610/1828
SL-8	SB 10+000.0, 3.6m LT.	NO	200	III	240	10.600	0.500	0.762	0.610	610/1828
SL-24	NB 9+792.0, 2.7m LT.	YES	200	III	240	10.600	0.500	0.762	2.440	610/1828
SL-25	NB 9+853.0, 2.7m LT.	YES	200	III	240	10.600	0.500	0.762	2.440	610/1828
SL-26	SB 10+120.0, 3.6m LT.	NO	200	III	240	10.600	0.500	0.762	0.610	610/1828
SL-27	EB 10+120.0, 5.2m LT.	YES	200	III	240	10.600	0.500	0.762	0.610	610/1828
SL-28	EB 10+060.0, 3.7m LT.	YES	200	III	240	10.600	0.500	0.762	0.610	610/1828
SL-29	EB 10+000.0, 3.0m LT.	YES	200	III	240	10.600	0.500	0.762	0.610	610/1828
SL-30	F 1+225.2, 14.4m LT.	NO	200	III	240	10.600	0.500	0.762	2.440	610/1828
SL-31	F 1+285.3, 13.5m LT.	YES	200	III	240	10.600	0.500	0.762	2.440	610/1828
SL-32	F 1+345.5, 12.9m LT.	YES	200	III	240	10.600	0.500	0.762	2.440	610/1828
SL-33	F 1+405.0, 13.1m LT.	YES	200	III	240	10.600	0.500	0.762	2.440	610/1828
SL-36	F 1+460.0, 3.6m RT.	NO	200	III	240	10.600	0.500	0.762	0.610	610/1828
SL-44	EB 9+882.3, 16.1m RT.	YES	200	III	240	10.600	0.500	0.762	2.440	610/1828
SL-45	EB 9+822.5, 16.0m RT.	YES	200	III	240	10.600	0.500	0.762	2.440	610/1828
SL-50	NB 9+940.0, 12.9m LT.	NO	200	III	240	10.600	0.500	0.762	0.610	610/1828

HAND HOLE LOCATIONS

HAND HOLE NO.	LOCATION	TYPE
HH-1	SB 10+190.0, 3.4m LT.	JUNCTION BOX
HH-1A	SB 10+120.8, 47.2m LT.	JUNCTION BOX
HH-1B	SB 10+162.4, 4.3m LT.	JUNCTION BOX
HH-26	SB 10+117.9, 2.8m RT.	JUNCTION BOX
HH-27	EB 10+115.8, 4.4m LT.	JUNCTION BOX
HH-29	EB 9+927.3, 2.5m LT.	JUNCTION BOX
HH-30	U 1+349.6, 6.7m LT.	JUNCTION BOX
HH-33	U 1+162.3, 7.0m LT.	JUNCTION BOX
HH-33A	U 1+163.4, 8.4m RT.	JUNCTION BOX
HH-33B	F 1+402.2, 4.1m RT.	JUNCTION BOX
HH-50	F 1+220.0, 5.2m RT.	JUNCTION BOX

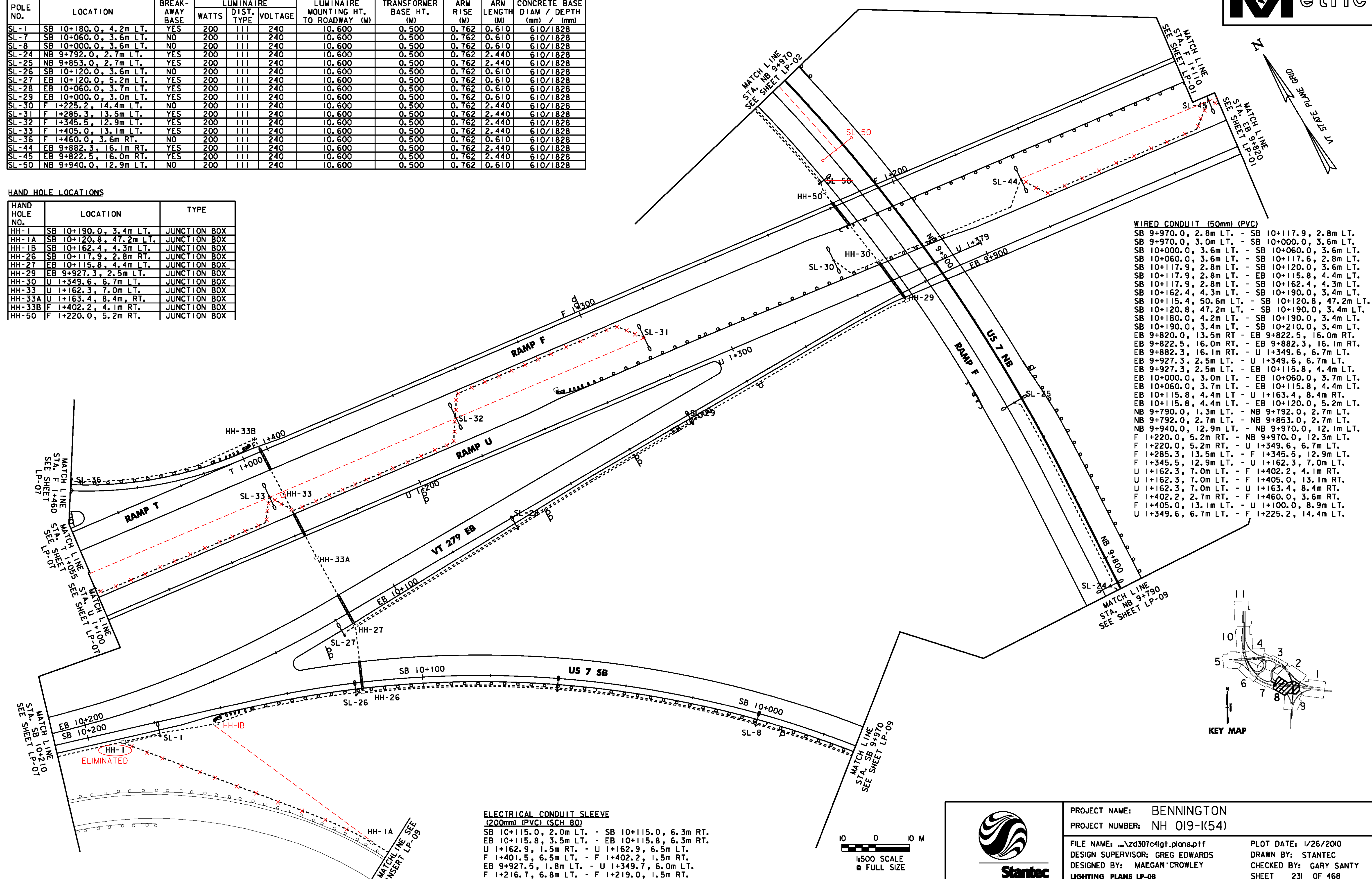

- WIRED CONDUIT (50mm) (PVC)**
- SB 9+970.0, 2.8m LT. - SB 10+117.9, 2.8m LT.
 - SB 9+970.0, 3.0m LT. - SB 10+000.0, 3.6m LT.
 - SB 10+000.0, 3.6m LT. - SB 10+060.0, 3.6m LT.
 - SB 10+060.0, 3.6m LT. - SB 10+117.6, 2.8m LT.
 - SB 10+117.9, 2.8m LT. - SB 10+120.0, 3.6m LT.
 - SB 10+117.9, 2.8m LT. - EB 10+115.8, 4.4m LT.
 - SB 10+117.9, 2.8m LT. - SB 10+162.4, 4.3m LT.
 - SB 10+162.4, 4.3m LT. - SB 10+190.0, 3.4m LT.
 - SB 10+115.4, 50.6m LT. - SB 10+120.8, 47.2m LT.
 - SB 10+120.8, 47.2m LT. - SB 10+190.0, 3.4m LT.
 - SB 10+180.0, 4.2m LT. - SB 10+190.0, 3.4m LT.
 - SB 10+190.0, 3.4m LT. - SB 10+210.0, 3.4m LT.
 - EB 9+820.0, 13.5m RT. - EB 9+822.5, 16.0m RT.
 - EB 9+822.5, 16.0m RT. - EB 9+882.3, 16.1m RT.
 - EB 9+882.3, 16.1m RT. - U 1+349.6, 6.7m LT.
 - EB 9+927.3, 2.5m LT. - U 1+349.6, 6.7m LT.
 - EB 9+927.3, 2.5m LT. - EB 10+115.8, 4.4m LT.
 - EB 10+000.0, 3.0m LT. - EB 10+060.0, 3.7m LT.
 - EB 10+060.0, 3.7m LT. - EB 10+115.8, 4.4m LT.
 - EB 10+115.8, 4.4m LT. - U 1+163.4, 8.4m RT.
 - EB 10+115.8, 4.4m LT. - EB 10+120.0, 5.2m LT.
 - NB 9+790.0, 1.3m LT. - NB 9+792.0, 2.7m LT.
 - NB 9+792.0, 2.7m LT. - NB 9+853.0, 2.7m LT.
 - NB 9+940.0, 12.9m LT. - NB 9+970.0, 12.1m LT.
 - F 1+220.0, 5.2m RT. - NB 9+970.0, 12.3m LT.
 - F 1+220.0, 5.2m RT. - U 1+349.6, 6.7m LT.
 - F 1+285.3, 13.5m LT. - F 1+345.5, 12.9m LT.
 - F 1+345.5, 12.9m LT. - U 1+162.3, 7.0m LT.
 - U 1+162.3, 7.0m LT. - F 1+402.2, 4.1m RT.
 - U 1+162.3, 7.0m LT. - F 1+405.0, 13.1m RT.
 - U 1+162.3, 7.0m LT. - U 1+163.4, 8.4m RT.
 - F 1+402.2, 2.7m RT. - F 1+460.0, 3.6m RT.
 - F 1+405.0, 13.1m LT. - U 1+100.0, 8.9m LT.
 - U 1+349.6, 6.7m LT. - F 1+225.2, 14.4m LT.

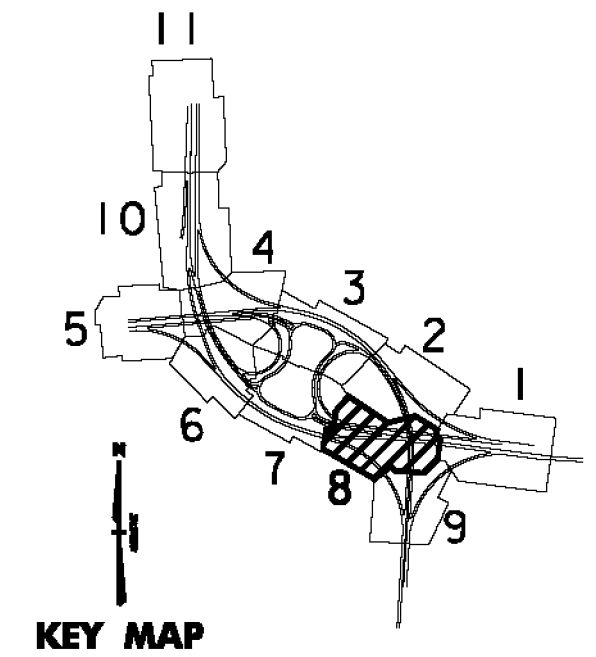

ELECTRICAL CONDUIT SLEEVE (200mm) (PVC) (SCH 80)

- SB 10+115.0, 2.0m LT. - SB 10+115.0, 6.3m RT.
- EB 10+115.8, 3.5m LT. - EB 10+115.8, 6.3m RT.
- U 1+162.9, 1.5m RT. - U 1+162.9, 6.5m LT.
- F 1+401.5, 6.5m LT. - F 1+402.2, 1.5m RT.
- EB 9+927.5, 1.8m LT. - U 1+349.7, 6.0m LT.
- F 1+216.7, 6.8m LT. - F 1+219.0, 1.5m RT.

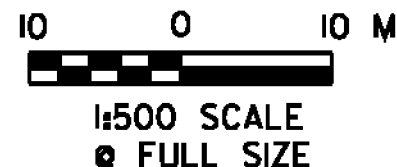

PROJECT NAME: BENNINGTON
 PROJECT NUMBER: NH 019-(154)
 FILE NAME: ...z\307c4\gt.plans.ptf
 DESIGN SUPERVISOR: GREG EDWARDS
 DESIGNED BY: MAEGAN CROWLEY
 LIGHTING PLANS LP-08

PLOT DATE: 1/26/2010
 DRAWN BY: STANTEC
 CHECKED BY: GARY SANTY
 SHEET 231 OF 468

1/26/2010 4:52:33 PM v:\1853\get\live\18530002\tr\anspor\ref\10\dr\aw\ng\com\tr\cop_4\p\ot_...files\z\307c4\gt.plans.ptf