

STREET LIGHTING LOCATIONS

POLE NO.	LOCATION	BREAK-AWAY BASE	LUMINAIRE			LUMINAIRE MOUNTING HT. TO ROADWAY (M)	TRANSFORMER BASE HT. (M)	ARM RISE (M)	ARM LENGTH (M)	CONCRETE BASE DIAM / DEPTH (mm) / (mm)
			WATTS	DIST. TYPE	VOLTAGE					
SL-78	G 1+995.0, 21.7m LT.	NO	200	III	240	10.600	0.500	0.762	2.440	610/1828
SL-79	G 2+046.9, 21.4m LT.	YES	200	III	240	10.600	0.500	0.762	2.440	610/1828
SL-94	NB 10+580.0, 7.8m RT.	YES	200	III	240	10.600	0.500	0.762	0.610	610/1828
SL-95	NB 10+634.8, 8.2m RT.	YES	200	III	240	10.600	0.500	0.762	0.610	610/1828
SL-96	NB 10+700.0, 8.4m RT.	NO	200	III	240	10.600	0.500	0.762	0.610	610/1828
SL-97	NB 10+760.0, 7.8m RT.	YES	200	III	240	10.600	0.500	0.762	0.610	610/1828
SL-105	WB 10+576.3, 3.0m RT.	YES	200	III	240	10.600	0.500	0.762	0.610	610/1828
SL-106	WB 10+643.9, 9.7m LT.	YES	200	III	240	10.600	0.500	0.762	2.440	610/1828
SL-107	WB 10+708.2, 9.2m LT.	YES	200	III	240	10.600	0.500	0.762	2.440	610/1828
SL-108	G 1+294.0, 11.4m LT.	YES	200	III	240	10.600	0.500	0.762	2.440	610/1828
SL-109	G 1+384.7, 3.0m RT.	YES	200	III	240	10.600	0.500	0.762	0.610	610/1828
SL-110	G 1+439.4, 3.0m RT.	YES	200	III	240	10.600	0.500	0.762	0.610	610/1828
SL-111	G 1+480.0, 3.0m RT.	YES	200	III	240	10.600	0.500	0.762	0.610	610/1828
SL-112A	WB 10+829.5, 16.4m LT.	NO	200	III	240	10.600	0.500	0.762	2.440	610/1828
SL-125	SB 10+777.4, 3.6m LT.	NO	200	III	240	10.600	0.500	0.762	0.610	610/1828

HAND HOLE LOCATIONS

HAND HOLE NO.	LOCATION	TYPE
HH-77	G 1+270.6, 2.2m RT.	JUNCTION BOX
HH-78	SB 10+840.0, 4.3m LT.	JUNCTION BOX
HH-94	NB 10+582.0, 7.0m RT.	JUNCTION BOX
HH-94A	NB 10+639, 9.4m RT.	JUNCTION BOX
HH-104	P 1+130.6, 6.7m LT.	JUNCTION BOX
HH-105	WB 10+581.0, 2.2m RT.	JUNCTION BOX
HH-106	WB 10+625.9, 11.8m LT.	JUNCTION BOX
HH-106A	WB 10+626.4, 2.2m RT.	JUNCTION BOX
HH-107	WB 10+711.6, 10.2m LT.	JUNCTION BOX
HH-108	G 1+358.7, 7.0m LT.	JUNCTION BOX
HH-109	G 1+358.7, 2.2m RT.	JUNCTION BOX
HH-112	WB 10+855.2, 10.5m LT.	JUNCTION BOX
HH-123	G 1+220.4, 2.2m RT.	JUNCTION BOX

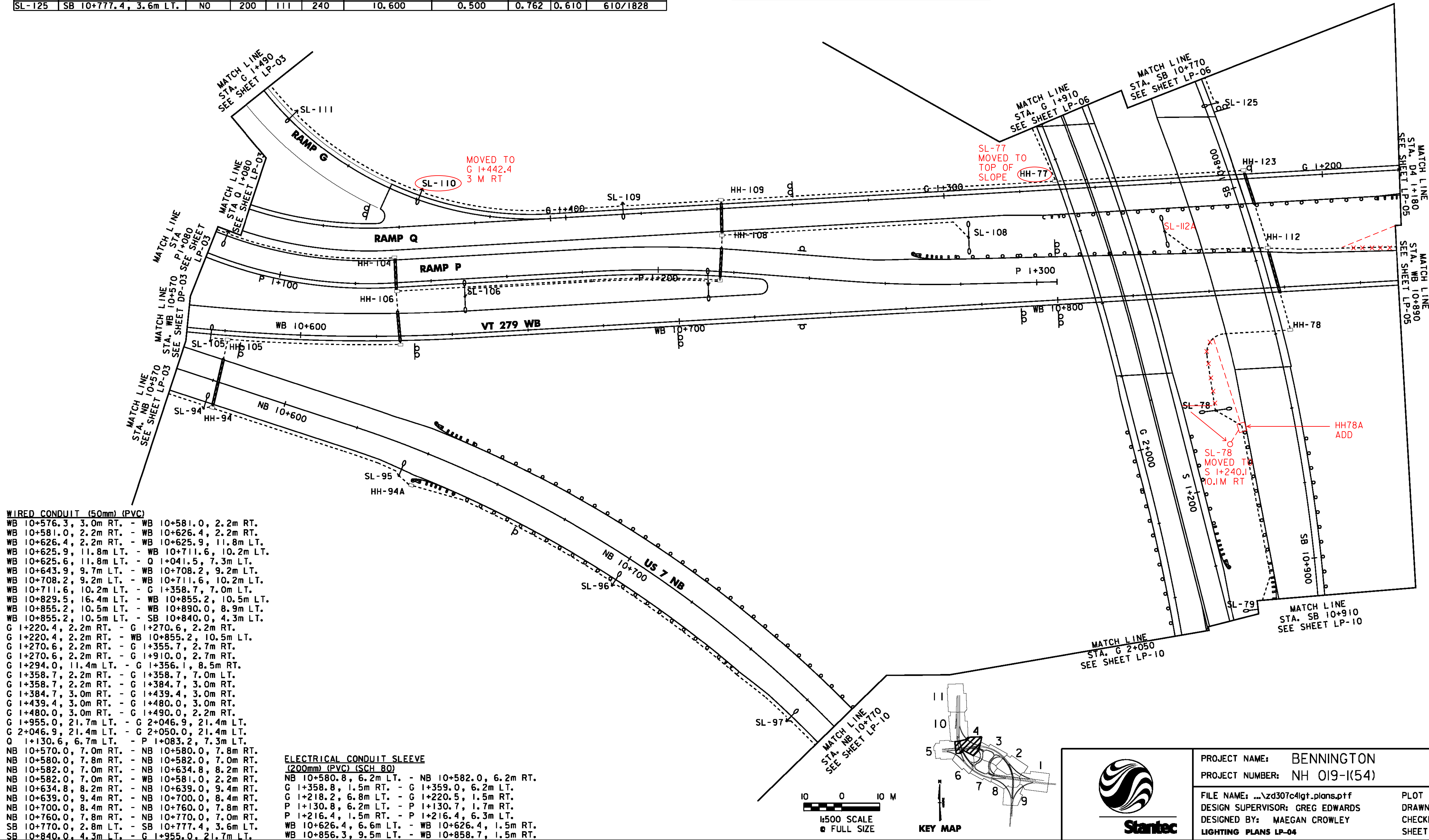

- WIRED CONDUIT (50mm) (PVC)**
- WB 10+576.3, 3.0m RT. - WB 10+581.0, 2.2m RT.
  - WB 10+581.0, 2.2m RT. - WB 10+626.4, 2.2m RT.
  - WB 10+626.4, 2.2m RT. - WB 10+625.9, 11.8m LT.
  - WB 10+625.9, 11.8m LT. - WB 10+711.6, 10.2m LT.
  - WB 10+625.6, 11.8m LT. - G 1+041.5, 7.3m LT.
  - WB 10+643.9, 9.7m LT. - WB 10+708.2, 9.2m LT.
  - WB 10+708.2, 9.2m LT. - WB 10+711.6, 10.2m LT.
  - WB 10+711.6, 10.2m LT. - G 1+358.7, 7.0m LT.
  - WB 10+829.5, 16.4m LT. - WB 10+855.2, 10.5m LT.
  - WB 10+855.2, 10.5m LT. - WB 10+890.0, 8.9m LT.
  - WB 10+855.2, 10.5m LT. - SB 10+840.0, 4.3m LT.
  - G 1+220.4, 2.2m RT. - G 1+270.6, 2.2m RT.
  - G 1+220.4, 2.2m RT. - WB 10+855.2, 10.5m LT.
  - G 1+270.6, 2.2m RT. - G 1+355.7, 2.7m RT.
  - G 1+270.6, 2.2m RT. - G 1+910.0, 2.7m RT.
  - G 1+294.0, 11.4m LT. - G 1+356.1, 8.5m RT.
  - G 1+358.7, 2.2m RT. - G 1+358.7, 7.0m LT.
  - G 1+358.7, 2.2m RT. - G 1+384.7, 3.0m RT.
  - G 1+384.7, 3.0m RT. - G 1+439.4, 3.0m RT.
  - G 1+439.4, 3.0m RT. - G 1+480.0, 3.0m RT.
  - G 1+480.0, 3.0m RT. - G 1+490.0, 2.2m RT.
  - G 1+955.0, 21.7m LT. - G 2+046.9, 21.4m LT.
  - G 2+046.9, 21.4m LT. - G 2+050.0, 21.4m LT.
  - Q 1+130.6, 6.7m LT. - P 1+083.2, 7.3m LT.
  - NB 10+570.0, 7.0m RT. - NB 10+580.0, 7.8m RT.
  - NB 10+580.0, 7.8m RT. - NB 10+582.0, 7.0m RT.
  - NB 10+582.0, 7.0m RT. - NB 10+634.8, 8.2m RT.
  - NB 10+582.0, 7.0m RT. - WB 10+581.0, 2.2m RT.
  - NB 10+634.8, 8.2m RT. - NB 10+639.0, 9.4m RT.
  - NB 10+639.0, 9.4m RT. - NB 10+700.0, 8.4m RT.
  - NB 10+700.0, 8.4m RT. - NB 10+760.0, 7.8m RT.
  - NB 10+760.0, 7.8m RT. - NB 10+770.0, 7.0m RT.
  - SB 10+770.0, 2.8m LT. - SB 10+777.4, 3.6m LT.
  - SB 10+840.0, 4.3m LT. - G 1+955.0, 21.7m LT.

- ELECTRICAL CONDUIT SLEEVE (200mm) (PVC) (SCH 80)**
- NB 10+580.8, 6.2m LT. - NB 10+582.0, 6.2m RT.
  - G 1+358.8, 1.5m RT. - G 1+359.0, 6.2m LT.
  - G 1+218.2, 6.8m LT. - G 1+220.5, 1.5m RT.
  - P 1+130.8, 6.2m LT. - P 1+130.7, 1.7m RT.
  - P 1+216.4, 1.5m RT. - P 1+216.4, 6.3m LT.
  - WB 10+626.4, 6.6m LT. - WB 10+626.4, 1.5m RT.
  - WB 10+856.3, 9.5m LT. - WB 10+858.7, 1.5m RT.

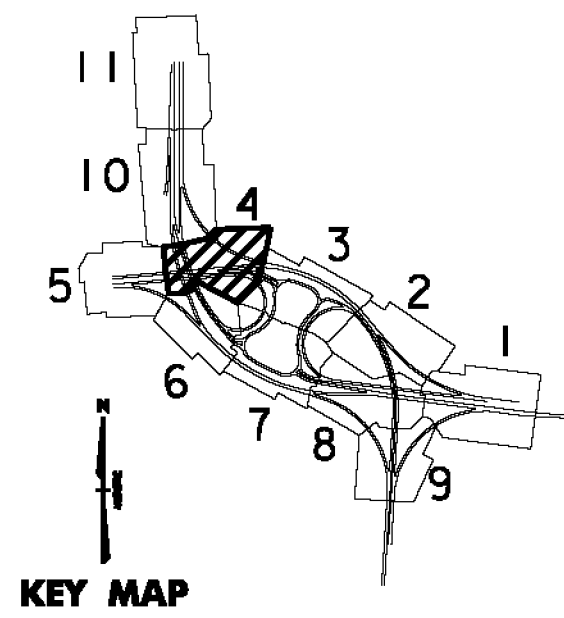
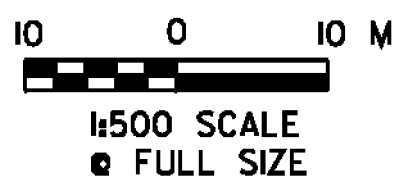

PROJECT NAME: BENNINGTON  
 PROJECT NUMBER: NH 019-(K54)  
 FILE NAME: ...z307c4lgt.plans.ptf  
 DESIGN SUPERVISOR: GREG EDWARDS  
 DESIGNED BY: MAEGAN CROWLEY  
 LIGHTING PLANS LP-04

PLOT DATE: 1/26/2010  
 DRAWN BY: STANTEC  
 CHECKED BY: GARY SANTY  
 SHEET 227 OF 468

1/26/2010 4:52:27 PM v:\1953\active\1953\0002\tr\compport\ref\img\comtr\ref\4\p101 - Files\26507\ref\ref\p101.mxd