

POLE NO.	LOCATION	BREAK-AWAY BASE	LUMINAIRE			LUMINAIRE MOUNTING HT. TO ROADWAY (M)	TRANSFORMER BASE HT. (M)	ARM RISE (M)	ARM LENGTH (M)	CONCRETE BASE DIAM / DEPTH (mm) / (mm)
			WATTS	DIST. TYPE	VOLTAGE					
SL-39	F 1+640.0, 3.0m RT.	YES	200	III	240	10.600	0.500	0.762	0.610	610/1828
SL-40	F 1+700.0, 3.0m RT.	YES	200	III	240	10.600	0.500	0.762	0.610	610/1828
SL-41	F 1+760.0, 3.6m RT.	NO	200	III	240	10.600	0.500	0.762	0.610	610/1828
SL-42	N 1+050.0, 3.0m RT.	YES	200	III	240	10.600	0.500	0.762	0.610	610/1828
SL-43	N 1+000.0, 3.0m RT.	YES	200	III	240	10.600	0.500	0.762	0.610	610/1828
SL-55	F 1+820.0, 3.6m RT.	NO	200	III	240	10.600	0.500	0.762	0.610	610/1828
SL-68	WB 10+220.0, 8.4m RT.	NO	200	III	240	10.600	0.500	0.762	0.610	610/1828
SL-69	WB 10+280.0, 8.4m RT.	NO	200	III	240	10.600	0.500	0.762	0.610	610/1828
SL-90	WB 10+340.0, 7.8m RT.	YES	200	III	240	10.600	0.500	0.762	0.610	610/1828
SL-91	WB 10+400.0, 7.8m RT.	YES	200	III	240	10.600	0.500	0.762	0.610	610/1828
SL-92	WB 10+460.0, 7.8m RT.	YES	200	III	240	10.600	0.500	0.762	0.610	610/1828
SL-93	NB 10+520.0, 7.8m RT.	YES	200	III	240	10.600	0.500	0.762	0.610	610/1828
SL-103	Q 1+136.6, 10.0m LT.	YES	200	III	240	10.600	0.500	0.762	2.440	610/1828
SL-104	Q 1+083.2, 7.3m LT.	YES	200	III	240	10.600	0.500	0.762	3.000	610/1828
SL-135	G 1+540.0, 3.0m RT.	YES	200	III	240	10.600	0.500	0.762	0.610	610/1828

**HAND HOLE LOCATIONS**

HAND HOLE NO.	LOCATION	TYPE
HH-40	F 1+744.2, 2.8m RT.	JUNCTION BOX
HH-42	F 1+744.7, 12.1m LT.	JUNCTION BOX

**ELECTRICAL CONDUIT SLEEVE**  
(200mm) (PVC) (SCH 80)  
F 1+744.7, 7.2m LT. - F 1+744.2, 2.2m RT.

**STREET LIGHTING LOCATIONS**

- WIRED CONDUIT (50mm) (PVC)**
- WB 10+210.0, 7.6m RT. - WB 10+220.0, 8.4m RT.
  - WB 10+220.0, 8.4m RT. - WB 10+280.0, 8.4m RT.
  - WB 10+340.0, 7.8m RT. - WB 10+400.0, 7.8m RT.
  - WB 10+400.0, 7.8m RT. - WB 10+460.0, 7.8m RT.
  - WB 10+460.0, 7.8m RT. - NB 10+520.0, 7.8m RT.
  - NB 10+520.0, 7.8m RT. - NB 10+570.0, 7.0m RT.
  - F 1+630.0, 2.2m RT. - F 1+640.0, 3.0m RT.
  - F 1+640.0, 3.0m RT. - F 1+700.0, 3.0m RT.
  - F 1+700.0, 3.0m RT. - F 1+744.2, 2.8m RT.
  - F 1+744.2, 2.8m RT. - F 1+760.0, 3.6m RT.
  - F 1+744.2, 2.8m RT. - F 1+744.7, 12.1m LT.
  - F 1+744.7, 12.1m LT. - N 1+050.0, 3.0m RT.
  - F 1+820.0, 3.6m RT. - F 1+830.0, 2.8m RT.
  - G 1+490.0, 2.2m RT. - G 1+540.0, 3.0m RT.
  - G 1+540.0, 3.0m RT. - G 1+590.0, 2.2m RT.
  - N 1+000.0, 3.0m RT. - N 1+050.0, 3.0m RT.
  - Q 1+080.0, 3.2m LT. - Q 1+083.2, 7.3m LT.
  - Q 1+083.2, 7.3m LT. - Q 1+136.6, 10.0m LT.

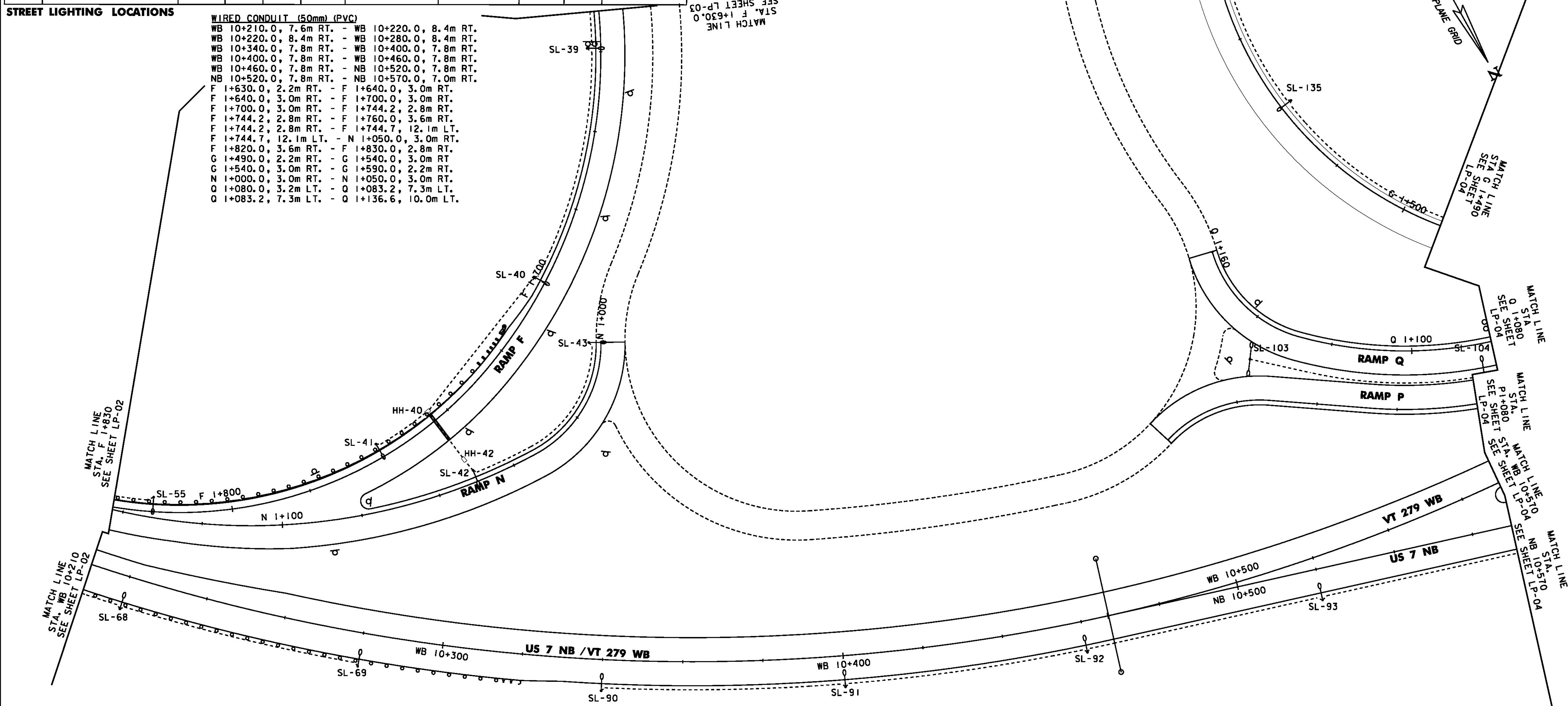

I:\25\2010 - 455225 - PM - V:\953\active\9531002\transportation\groming\comtracet\_4\pilot\_files\25307cd\gt-plans.ppt

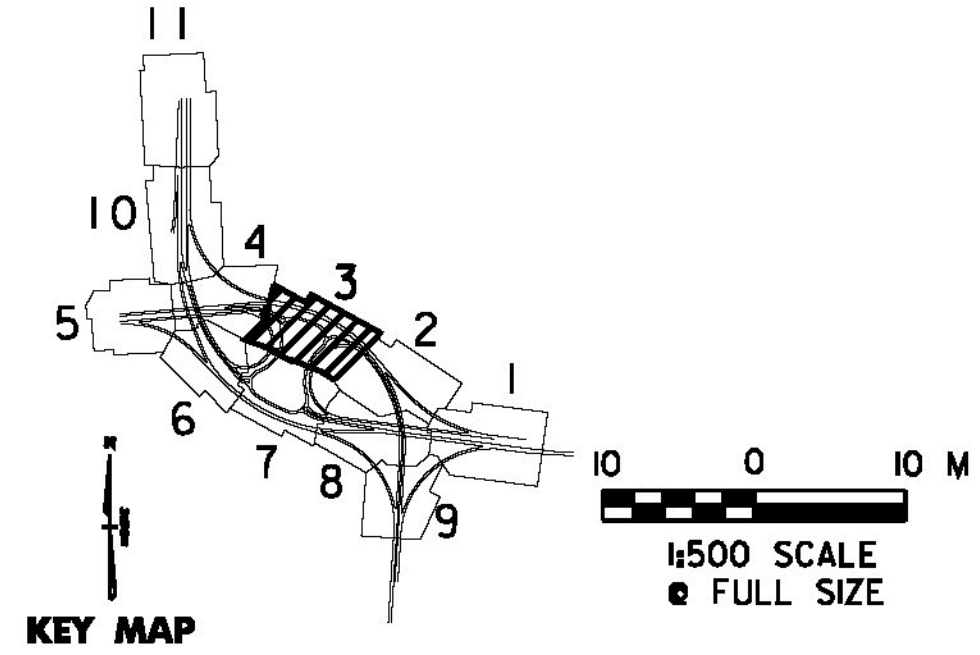

PROJECT NAME:	BENNINGTON	PLOT DATE:	1/26/2010
PROJECT NUMBER:	NH 019-1(54)	DRAWN BY:	STANTEC
FILE NAME:	...zd307c4gt.plans.ppt	CHECKED BY:	GARY SANTY
DESIGN SUPERVISOR:	GREG EDWARDS	SHEET	226 OF 468
DESIGNED BY:	MAEGAN CROWLEY		
LIGHTING PLANS LP-03			