

ROADWAY	LENGTH (m)	SPACING (m)	COLOR	TYPE
<b>RAMP G</b>				
G 2+045.0, LT - /G 2+153.0, LT	109	30.5	YELLOW	I
G 2+153.7, RT - G 2+236.8, RT	83	30.5	WHITE	I
G 2+236.8, LT - SB 11+140.0, RT	185	30.5	YELLOW	II
<b>RAMP I</b>				
I 1+200.0, RT - I 1+207.7, RT	8	30.5	WHITE	II
I 1+207.7, RT - I 1+299.5, RT	92	30.5	WHITE	I
I 1+299.5, LT - I 1+400.3, LT	101	30.5	YELLOW	I
<b>RAMP S</b>				
SB 11+217.7, LT - S 1+104.9, LT	240	30.5	YELLOW	II
S 1+104.9, RT - S 1+140.0, RT	35	25.9	WHITE	I
S 1+140.0, RT - S 1+165.0, RT	15	30.5	WHITE	I
<b>US 7 NB</b>				
NB 10+770.0, RT - SB 11+140.0, RT	370	80.5	WHITE	I
NB 10+770.0, LT - NB 10+956.8, LT	187	80.5	YELLOW	I
<b>US 7 SB</b>				
SB 10+910.0, RT - SB 10+975.2, RT	65	80.5	YELLOW	I
SB 10+910.0, LT - SB 11+275.5, LT	366	80.5	WHITE	I
SB 11+217.7, RT - SB 11+290.0, RT	72	80.5	YELLOW	I

**DURABLE 150 WHITE LINE, RECESSED POLYUREA**  
 STA. G 2+045.0 TO STA. G 2+236.8, SOLID C  
 STA. I 1+200.0 TO STA. I 1+433.3, SOLID C  
 STA. S 1+104.9 TO STA. S 1+167.3, SOLID C  
 STA. NB 10+770.0 TO STA. NB 11+140.0, SOLID RT.  
 STA. NB 10+770.0 TO STA. NB 11+125.0, DASHED C  
 STA. SB 10+910.0 TO STA. SB 11+275.8, SOLID C

**DURABLE 150 YELLOW LINE, RECESSED POLYUREA**  
 STA. G 2+045.0 LT. TO STA. G 2+303.1, SOLID LT.  
 STA. I 1+207.7 TO STA. I 1+433.3, SOLID LT.  
 STA. S 1+000.0 TO STA. S 1+167.3, SOLID LT.  
 STA. NB 10+770.0 TO STA. NB 10+956.8, SOLID LT.  
 STA. NB 11+025.3 TO STA. NB 11+140.0, SOLID LT.  
 STA. SB 10+910.0 TO STA. SB 10+975.3, SOLID RT.  
 STA. SB 11+080.5 TO STA. SB 11+290.0, SOLID RT.

**DURABLE 300 WHITE LINE, RECESSED POLYUREA**  
 STA. NB 10+956.8 TO STA. NB 11+025.3, LT. (GORE)  
 STA. SB 10+975.3 TO STA. SB 11+080.5, RT. (GORE)  
 STA. SB 11+275.1 TO STA. SB 11+290.0, C & LT. (GORE)

**DURABLE 300 WHITE LINE, THERMOPLASTIC**  
 STA. SB 10+975.3 TO STA. SB 11+080.5, RT. (CHEVRONS)  
 STA. SB 11+275.3 TO STA. SB 11+290.0, LT. (CHEVRONS)

**DURABLE LETTER OR SYMBOL, THERMOPLASTIC**  
 STA. NB 11+122.0, RT - " "

**REMOVING SIGNS**  
 AS SHOWN - 17

**DELINATOR WITH STEEL POST**  
 FOR MORE INFORMATION, SEE SHEET MD-02

**SPECIAL PROVISION (REMOVE EXISTING OVERHEAD SIGN ASSEMBLY - MULTI-SUPPORT)**  
 STA. SB 11+185.5

**MILLED RUMBLE STRIPS**  
 STA. NB 10+770.0, RT. - STA. NB 11+140.0, RT.  
 STA. NB 10+770.0, LT. - STA. NB 10+956.8, LT.  
 STA. NB 11+025.0, LT. - STA. NB 11+140.0, LT.  
 STA. SB 10+910.0, RT. - STA. SB 10+975.0, RT.  
 STA. SB 10+910.0, LT. - STA. SB 11+275.0, LT.  
 STA. SB 11+080.0, RT. - STA. SB 11+290.0, RT.

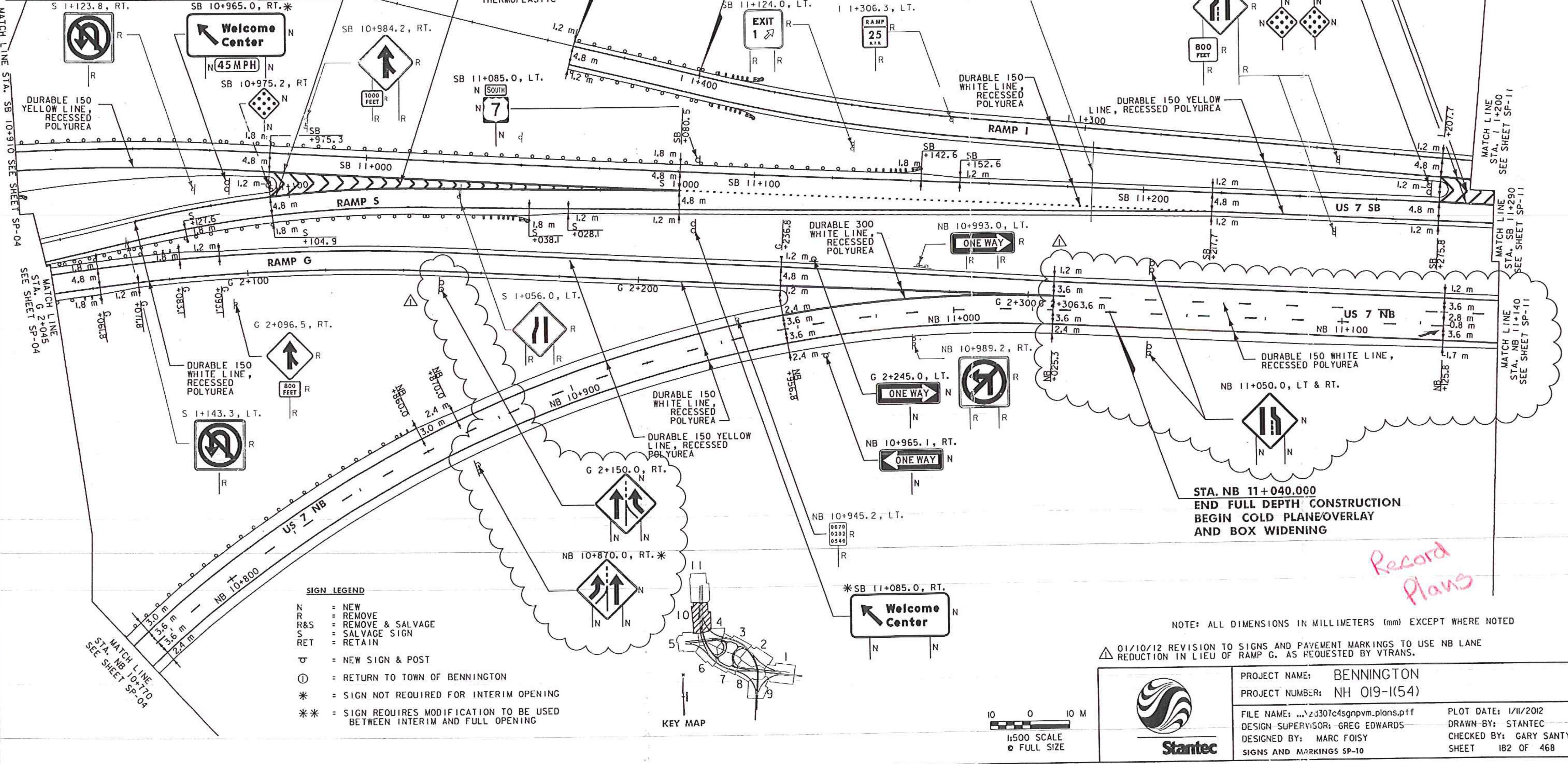

**SIGN LEGEND**

- N = NEW
- R = REMOVE
- R&S = REMOVE & SALVAGE
- S = SALVAGE SIGN
- RET = RETAIN
- ⊕ = NEW SIGN & POST
- ⓪ = RETURN TO TOWN OF BENNINGTON
- \* = SIGN NOT REQUIRED FOR INTERIM OPENING
- \*\* = SIGN REQUIRES MODIFICATION TO BE USED BETWEEN INTERIM AND FULL OPENING

NOTE: ALL DIMENSIONS IN MILLIMETERS (mm) EXCEPT WHERE NOTED

⚠ 01/10/12 REVISION TO SIGNS AND PAVEMENT MARKINGS TO USE NB LANE REDUCTION IN LIEU OF RAMP G, AS REQUESTED BY VTRANS.

*Record Plans*



PROJECT NAME: BENNINGTON  
 PROJECT NUMBER: NH 019-1(54)

FILE NAME: ...z3307c4sgnvm-plans.ptf  
 DESIGN SUPERVISOR: GREG EDWARDS  
 DESIGNED BY: MARC FOISY  
 SIGNS AND MARKINGS SP-10

PLOT DATE: 1/11/2012  
 DRAWN BY: STANTEC  
 CHECKED BY: GARY SANTY  
 SHEET 182 OF 468

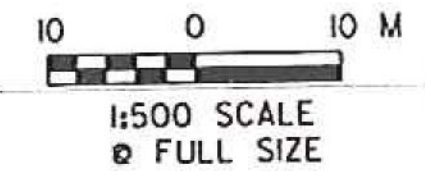

KEY MAP

MATCH LINE STA. SB 10+910 TO SEE SHEET SP-04

MATCH LINE STA. I 1+200 TO SEE SHEET SP-11

MATCH LINE STA. SB 11+290 TO SEE SHEET SP-11

MATCH LINE STA. NB 10+770 TO SEE SHEET SP-04