

DELINEATOR WITH STEEL POST

ROADWAY	LENGTH (m)	SPACING (m)	COLOR	TYPE
VT 279 EB				
EB 9+986.4, RT - SB 10+210.0, RT	224	80.5	YELLOW	I
EB 9+820.0, LT - EB 10+135.2, LT	315	80.5	WHITE	I
EB 9+820.0, RT - EB 9+870.0, RT	240	80.5	YELLOW	I
RAMP F				
NB 9+790.0, LT - NB 9+826.2, LT	36	30.5	WHITE	I
NB 9+826.2, LT - NB 9+970.0, LT	144	30.5	YELLOW	I
F 1+110.0, RT - F 1+404.3, RT	294	30.5	WHITE	I
RAMP U				
U 1+100.0, RT - U 1+292.9, RT	193	30.5	WHITE	I
U 1+292.9, LT - EB 9+870.0, RT	117	30.5	YELLOW	II
US 7 NB				
NB 9+790.0, RT - NB 9+970.0, RT	180	80.5	WHITE	I
NB 9+790.0, LT - NB 9+970.0, LT	180	80.5	YELLOW	I
US 7 SB				
SB 9+970.0, RT - SB 10+134.8, RT	165	80.5	YELLOW	I
SB 9+970.0, LT - SB 10+210.0, LT	240	80.5	WHITE	I

FOR FURTHER INFORMATION, SEE VTRANS STANDARD E-197

DURABLE 150 YELLOW LINE, RECESSED POLYUREA
 STA. EB 9+820.0 TO STA. EB 9+900.4, SOLID RT.
 STA. EB 9+986.4 TO STA. EB 10+210.0, SOLID RT.
 STA. F 1+110.0 TO STA. F 1+407.5, SOLID LT.
 STA. T 1+000.0 TO STA. T 1+050.0, SOLID LT.
 STA. U 1+100.0 TO STA. U 1+379.5, SOLID LT.
 STA. NB 9+790.0 TO STA. NB 9+970.0, SOLID LT. & RT.
 STA. SB 9+970.0 TO STA. SB 10+134.8, SOLID RT.

DURABLE 300 WHITE LINE, RECESSED POLYUREA
 STA. EB 9+870.4 TO STA. EB 9+986.4, RT. (GORE)
 STA. F 1+440.6 TO STA. F 1+457.6, LT. (GORE)
 STA. SB 10+134.8 TO STA. SB 10+210.0, RT. (GORE)

DURABLE 300 WHITE LINE, THERMOPLASTIC
 STA. F 1+440.6 TO STA. F 1+457.6, LT. (CHEVRONS)
 STA. SB 10+134.8 TO STA. SB 10+200.0, RT. (CHEVRONS)

REMOVING SIGNS
 AS SHOWN - 2

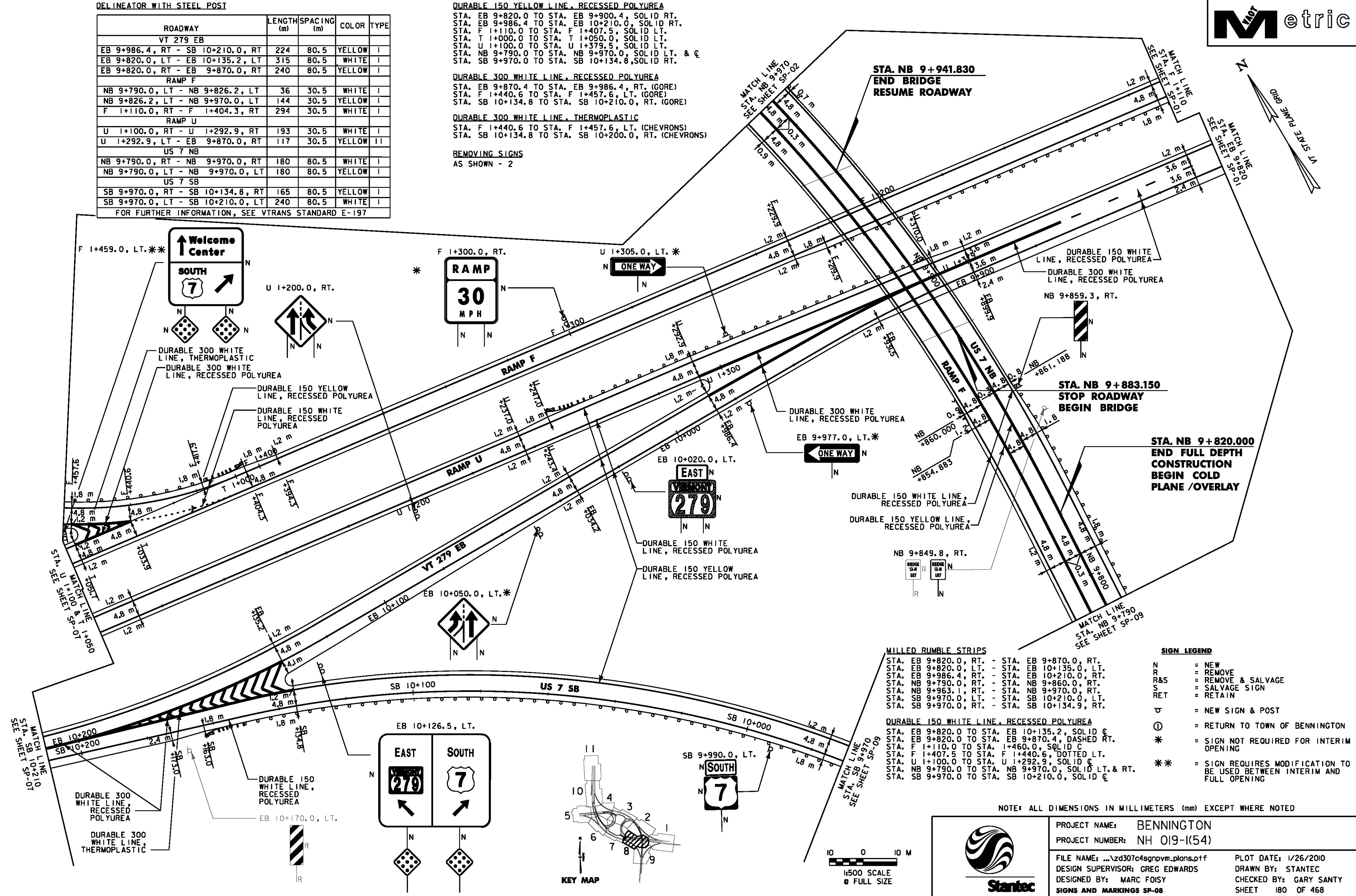

- MILLED RUMBLE STRIPS**
- STA. EB 9+820.0, RT. - STA. EB 9+870.0, RT.
 - STA. EB 9+820.0, LT. - STA. EB 10+135.0, LT.
 - STA. EB 9+986.4, RT. - STA. EB 10+210.0, RT.
 - STA. NB 9+790.0, RT. - STA. NB 9+860.0, RT.
 - STA. NB 9+963.1, RT. - STA. NB 9+970.0, RT.
 - STA. SB 9+970.0, LT. - STA. SB 10+210.0, LT.
 - STA. SB 9+970.0, RT. - STA. SB 10+134.9, RT.
- DURABLE 150 WHITE LINE, RECESSED POLYUREA**
- STA. EB 9+820.0 TO STA. EB 10+135.2, SOLID C
 - STA. EB 9+820.0 TO STA. EB 9+870.4, DASHED RT.
 - STA. F 1+110.0 TO STA. F 1+460.0, SOLID C
 - STA. F 1+407.5 TO STA. F 1+440.6, DOTTED LT.
 - STA. U 1+100.0 TO STA. U 1+292.9, SOLID C
 - STA. NB 9+790.0 TO STA. NB 9+970.0, SOLID LT. & RT.
 - STA. SB 9+970.0 TO STA. SB 10+210.0, SOLID C
- SIGN LEGEND**
- N = NEW
 - R = REMOVE
 - R&S = REMOVE & SALVAGE
 - S = SALVAGE SIGN
 - RET = RETAIN
 - ⊕ = NEW SIGN & POST
 - Ⓢ = RETURN TO TOWN OF BENNINGTON
 - * = SIGN NOT REQUIRED FOR INTERIM OPENING
 - ** = SIGN REQUIRES MODIFICATION TO BE USED BETWEEN INTERIM AND FULL OPENING

NOTE: ALL DIMENSIONS IN MILLIMETERS (mm) EXCEPT WHERE NOTED

PROJECT NAME: BENNINGTON
 PROJECT NUMBER: NH 019-1(54)
 FILE NAME: ...z307c4sgnvm.plans.prf
 DESIGN SUPERVISOR: GREG EDWARDS
 DESIGNED BY: MARC FOISY
 SIGNS AND MARKINGS SP-08

PLOT DATE: 1/26/2010
 DRAWN BY: STANTEC
 CHECKED BY: GARY SANTY
 SHEET 180 OF 468

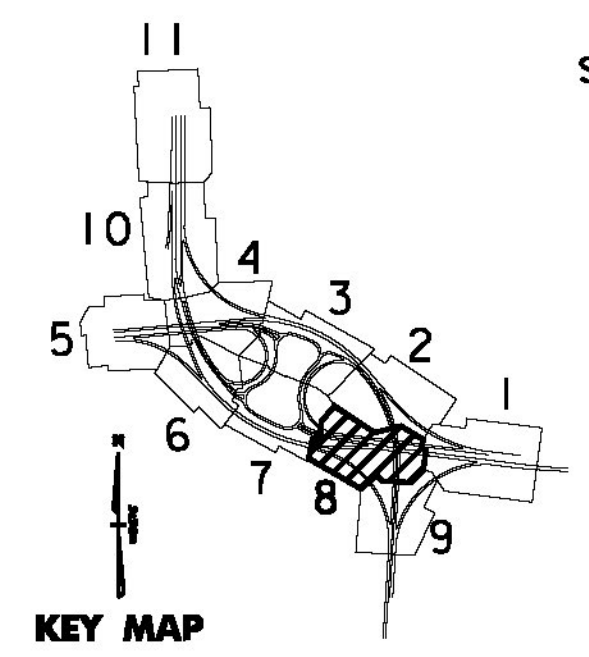
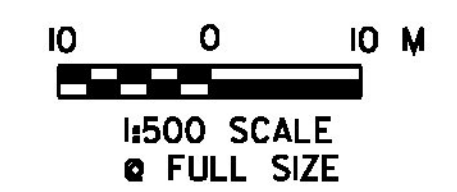

1/26/2010 4:50:40 PM v:\953\cvt\1ve\953\002\transportation\drawings\asmt\trac\4\blot_files\z307c4sgnvm.plans.prf