

CURVE CN2	
$\Delta = 91^\circ 06' 59.6''$ LT.	$R = 468.400\text{m}$
$T = 477.618\text{m}$	$L = 744.889\text{m}$
$E = 200.568\text{m}$	$\text{BANK} = 0.069$
$Ls = 61.177\text{m}$	$Os = 3^\circ 44' 29.9''$
$Ts = 575.534\text{m}$	$Lt = 40.793\text{m}$
$St = 20.400\text{m}$	

CURVE RI	
$\Delta = 84^\circ 46' 06.2''$ RT.	$R = 70.000\text{m}$
$T = 63.883\text{m}$	$L = 103.564\text{m}$
$E = 24.769\text{m}$	$\text{BANK} = 0.060$
PI STA. R1+528.649	$N = 45318.1042$
	$E = 442458.0418$
PC N = 45312.5036	$E = 442394.4044$
PT N = 45255.2425	$E = 442469.4216$

PI STA. CN 2+187.929	$N = 45346.7621$
	$E = 442872.3761$
TS N = 44808.0314	$E = 442871.3593$
SC N = 44848.7459	$E = 442873.8348$
CS N = 45335.9968	$E = 442394.8794$
ST N = 45335.5370	$E = 442374.4841$

$\Delta = 236^\circ 03' 34.7''$ RT.	$R = 90.000\text{m}$
$T = \text{N/A}$	$L = 370.802\text{m}$
$E = \text{N/A}$	$\text{BANK} = 0.060$
PI STA. G1+396.514	$N = 45179.3415$
	$E = 442268.2761$
PC N = 45305.8601	$E = 442346.1949$
PCC N = 45159.4245	$E = 442284.5381$
PT N = 45200.7744	$E = 442254.0714$

CURVE HI	
$\Delta = 93^\circ 31' 06.3''$ RT.	$R = 200.000\text{m}$
$T = 212.675\text{m}$	$L = 326.441\text{m}$
$E = 91.943\text{m}$	$\text{BANK} = 0.060$
PI STA. H 1+212.675	$N = 45330.8404$
	$E = 442166.8007$
PC N = 45342.5925	$E = 442379.1505$
PT N = 45543.5112	$E = 442168.1025$

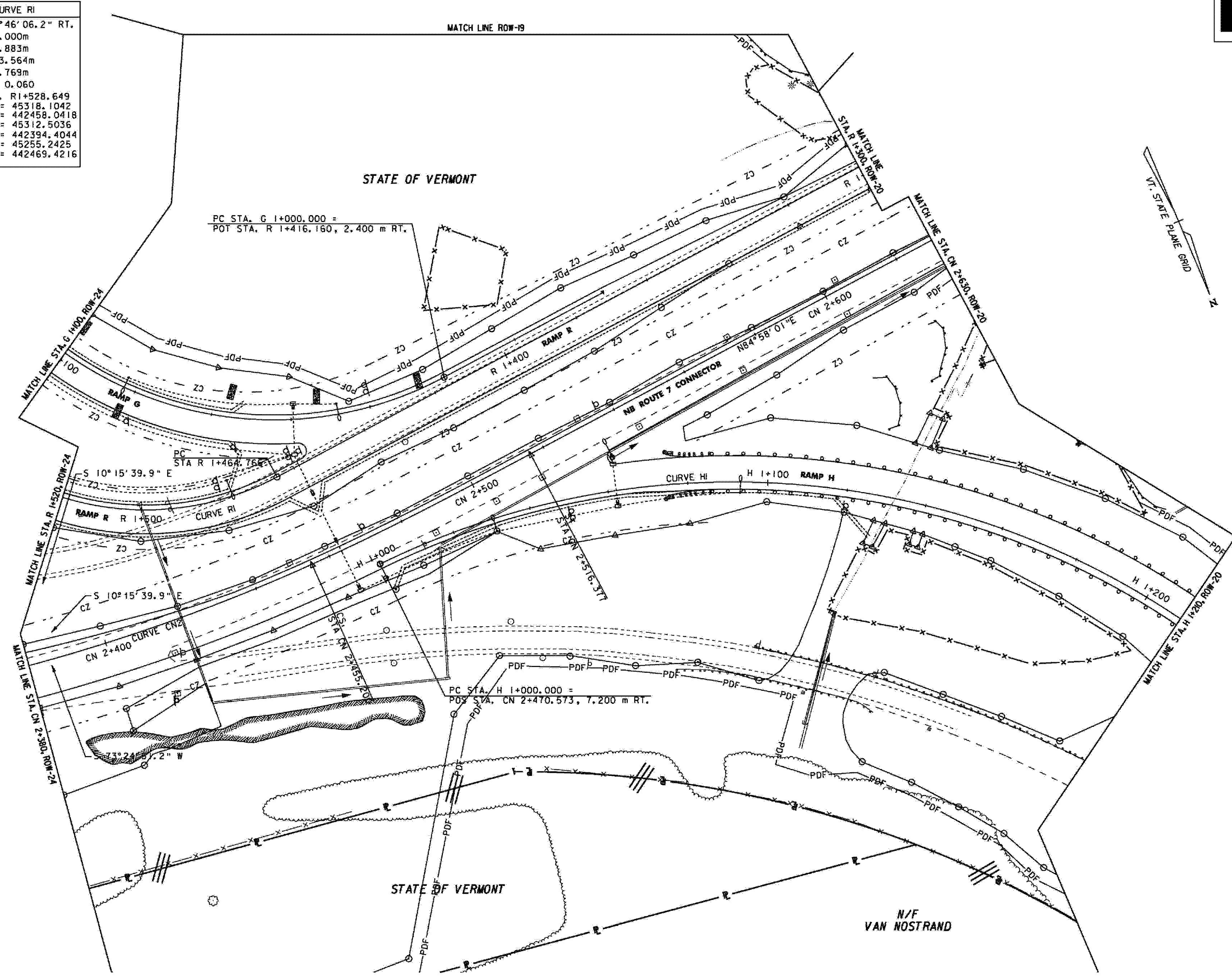

LINES SHOWN ON THIS PLAN AS EXISTING PROPERTY LINES P/L ARE BELIEVED TO BE ACCURATE BUT SHOULD NOT BE RELIED UPON FOR PURPOSES UNRELATED TO THE STATE OF VERMONT'S ACQUISITION OF LAND AND RIGHTS FOR THIS PROJECT.

THIS SHEET TO BE USED FOR RIGHT-OF-WAY INFORMATION ONLY

DATUM	
VERTICAL	NAVD 88
HORIZONTAL	NAD 83 (1992)

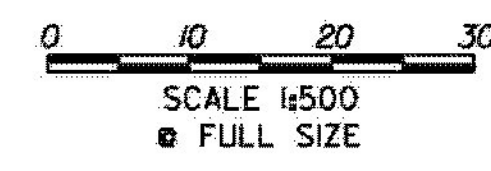

**R.O.W. PLAN ROW-25**

PROJECT NAME:	BENNINGTON
DESIGN FILE NAME:	c:\dh\bennington\row
PROJECT LEADER:	JDP

PROJECT NUMBER:	NH 019-1(54)
PLOT DATE:	1-25-10
DRAWN BY:	MBB
CHECKED BY:	GAK