

- ~~JUNCTION BOX NOT USED~~
- ~~STA. NB 6+569.772, 19.5m LT.~~
- ~~STA. NB 6+569.871, 4.7m LT.~~
- 6+502.42m RT WOVEN WIRE FENCE WITH STEEL POSTS 6m RT
- STA. NB 6+490.000, 75.7m RT. - STA. NB 6+640.306, 109.5m RT.
- STA. NB 6+490.000, 77.1m LT. - STA. NB 6+740.000, 63.7m LT.
- STA. VR 1+091.043, 17.4m RT. - STA. VR 1+120.000, 34.8m RT.
- PROJECT DEMARCATION FENCE**
- STA. NB 6+490.000, 41.9m RT. - STA. CV 5+135.123, 35.5m RT.
- STA. NB 6+639.617, 89.6m RT. - STA. NB 6+740.000, 69.2m RT.
- STA. NB 6+490.000, 75.6m LT. - STA. NB 6+630.526, 73.0m LT.
- STA. NB 6+628.718, 74.6m LT. - STA. NB 6+645.685, 60.0m LT.
- STA. NB 6+715.587, 30.5m LT. - STA. NB 6+740.000, 34.7m LT.
- BARRIER FENCE**
- STA. NB 6+645.685, 60.0m LT. - STA. NB 6+715.587, 30.5m LT.
- ~~NOT USED ADDED TO CONTRACT 51~~
- ~~ELECTRICAL CONDUIT SLEEVE (200 MM) (PVC) (SCH 80)~~
- ~~STA. NB 6+569.601, 4.2m LT.~~
- ~~STA. NB 6+570.291, 19.8m LT.~~
- ~~STA. NB 6+569.871, 4.7m LT.~~
- ~~STA. NB 6+576.443, 4.7m LT.~~
- REMOVAL OF EXISTING FENCE**
- STA. CV 5+148.457, LT. - STA. VR 1+074.788, LT.
- STA. CV 5+148.457, RT. - STA. VR 1+074.788, RT.
- STA. VB 1+125.694, 12.0 m LT. - STA. VR 1+077.331, 19.6 m LT.
- GATE FOR CHAIN-LINK FENCE, 1.8m**
- STA. VR 1+014.864, 2.5m RT. - STA. VR 1+015.124, 2.5m LT.
- CHAIN-LINK FENCE, 1.8m**
- STA. VB 1+120.447, 12.6m RT. - STA. VB 1+101.876, 19.8m RT.
- STA. VB 1+096.478, 19.2m RT. - STA. VR 1+015.124, 2.5m LT.
- STA. VR 1+014.864, 2.5m RT. - STA. VR 1+095.690, 11.2m RT.
- STA. VB 1+039.598, 38.4m LT. - STA. VR 1+127.560, 20.7m RT.
- STA. VB 1+127.560, 20.7m LT. - STA. VB 1+120.509, 12.8m RT.
- SPECIAL PROVISION (DECOMMISSION WATER WELL)**
- STA. NB 6+586.812, 5.6 m RT.
- SPECIAL PROVISION (GABION RETAINING WALL)**
- STA. VB 1+092.844, 14.9m RT. - STA. VB 1+100.366, 12.3m LT.
- STEEL BEAM GUARDRAIL**
- ~~CEGAR LOG RAIL NOT USED~~
- STA. CV 5+130.745, 2.000m LT. - STA. VR 1+120.000, 2.000m LT.
- SPECIAL PROVISION (DECOMMISSION OBSERVATION WELL)**
- STA. NB 6+649.000, 47.0 m RT. (B-25)
- STA. NB 6+672.000, 19.0 m RT. (B-26) NOT DONE

MATCH LINE  
STA. NB 6+490.1  
SEE SHEET P-01

MATCH LINE  
STA. NB 6+740.3  
SEE SHEET P-03

MATCH LINE  
STA. VR 1+201  
SEE SHEET P-01

TYPE II STONE COVERED BY GRUBBINGS

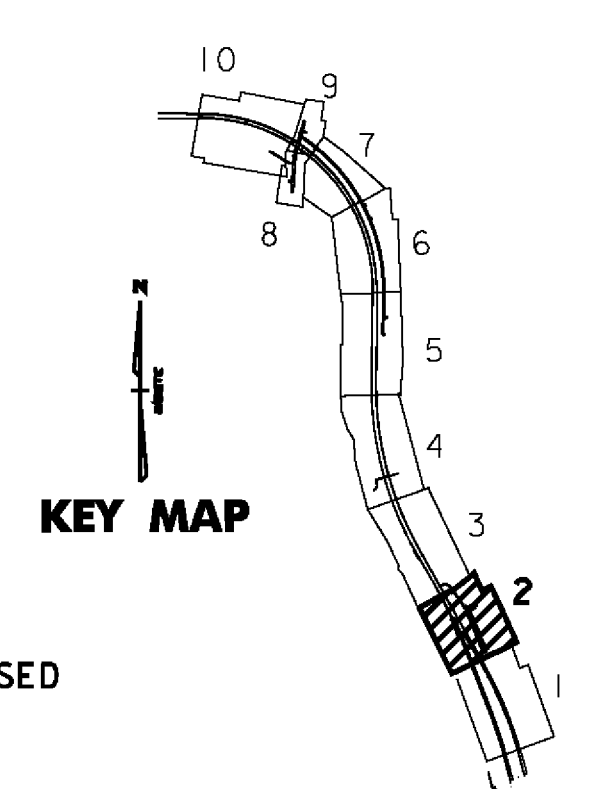

NOTE:  
TREE CLEARING SHALL BE KEPT TO A MINIMUM FOR WORK PROPOSED AT THE VETERANS RESERVOIR.

**VERMONT AGENCY OF TRANSPORTATION**



PROJECT NAME: BENNINGTON  
 PROJECT NUMBER: AC NH 019-1(52)  
 FILE NAME: ...plot.files\zd307c2p02.pff  
 DESIGN SUPERVISOR: GREG EDWARDS  
 DESIGNED BY: MARC FOISY  
 GENERAL PLAN P-02  
 PLOT DATE: 5/16/2011  
 DRAWN BY: STANTEC  
 CHECKED BY: GARY SANTY  
 SHEET 72 OF 267

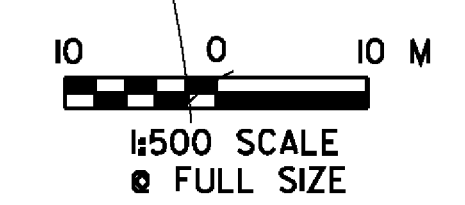

V:\953\active\95310002\transportation\drawing\contract\2\plot\_files\zd307c2p02.pff