

SECTION A-A

LOCATION	RAD	ARC	CHD	AA	AB	WL1	PL PA (M270M-345WT2)	PL PB (M270M-345WT2)
217G1E TOP FLG	1 368 925	33 104	33 103	16 238	2030	16 238	PL 25 x 460-ta (H2-3) (202/E)	PL 25 x 460-tb (H2-3) (202/C)
217G1E BTM FLG	1 368 925	32 995	32 994	16 129	2016	16 129	PL 42 x 460-ba (H2-3) (201/J)	PL 42 x 460-bb (H2-3) (201/G)
218G2E TOP FLG	1 371 375	33 098	33 097	16 233	2029	16 232	PL 25 x 460-ta (H2-3) (202/E)	PL 25 x 460-tb (H2-3) (202/C)
218G2E BTM FLG	1 371 375	32 988	32 987	16 123	2015	16 122	PL 42 x 460-ba (H2-3) (201/J)	PL 42 x 460-bb (H2-3) (201/G)
219G3E TOP FLG	1 373 825	33 093	33 092	16 227	2028	16 226	PL 25 x 460-ta (H2-3) (202/E)	PL 25 x 460-tb (H2-3) (202/C)
219G3E BTM FLG	1 373 825	32 983	32 982	16 118	2015	16 117	PL 42 x 460-ba (H2-3) (201/J)	PL 42 x 460-bb (H2-3) (201/G)
220G4E TOP FLG	1 376 275	33 087	33 086	16 222	2028	16 221	PL 25 x 460-ta (H2-3) (202/E)	PL 25 x 460-tb (H2-3) (202/C)
220G4E BTM FLG	1 376 275	32 977	32 976	16 112	2014	16 111	PL 42 x 460-ba (H2-3) (201/J)	PL 42 x 460-bb (H2-3) (201/G)

- NOTES:
1. ALL MATL M270M, GR345W UNLESS OTHERWISE NOTED
 2. FOR GENERAL NOTES SEE SHT GM1
 3. H2-3 DENOTES MATERIAL SUBJECT TO CHARPY V NOTCH TESTING
ZONE 2, H FREQ, 20 J @ 4 deg C (15 F/lbs @ 40 deg F)

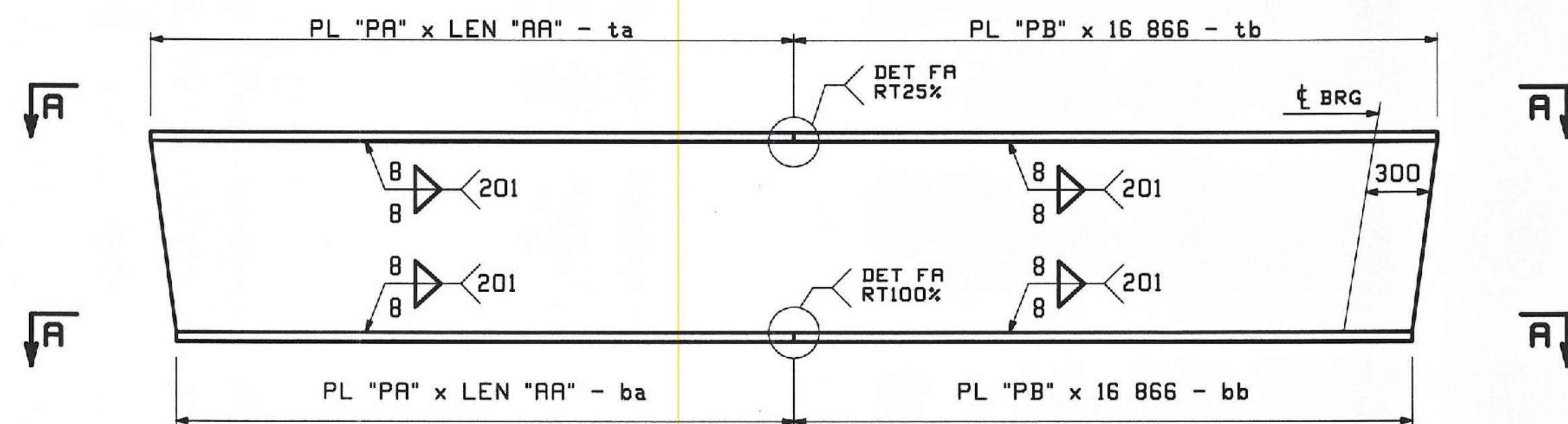

FLANGE DIAGRAM FOR 217G1E, 218G2E, 219G3E, 220G4E

FLG THK	'A'
25	6
42	12

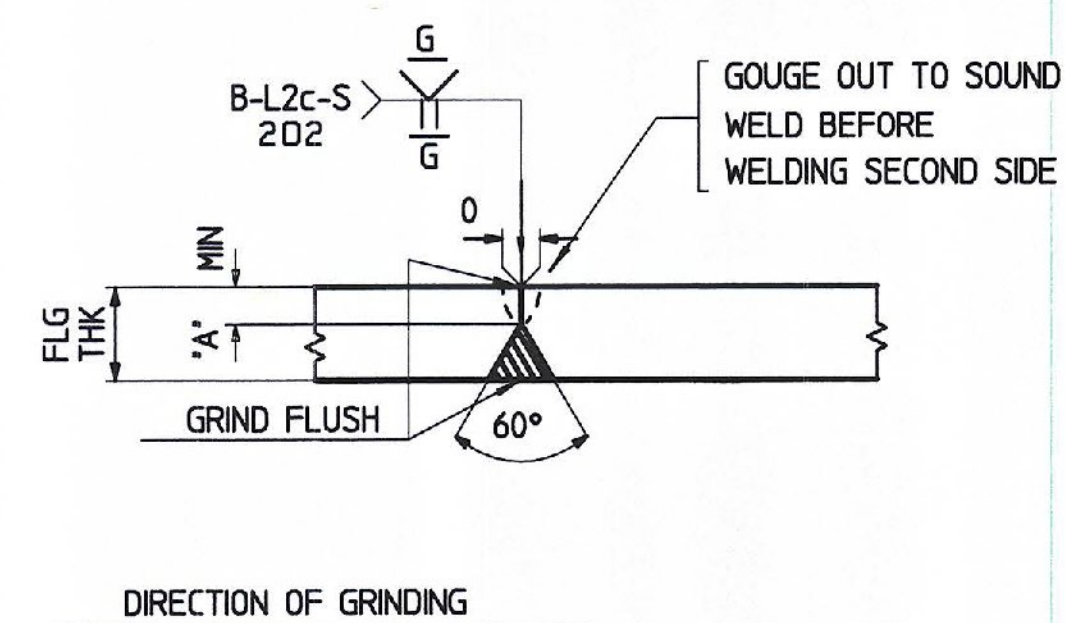

FLANGE PLATE SPLICE DETAIL 'FA'

TVGA CONSULTANTS

NO EXCEPTIONS TAKEN
 FURNISH AS CORRECTED
 REVISE AND RESUBMIT
 REJECTED
 ENGINEER has reviewed Shop Drawings and Samples and other data which Contractor is required to submit, only for conformance with the information given in the Contract Documents and compliance with the design concept of the completed Project as a functioning whole as indicated in the Contract Documents. Such review does not extend to means, methods, techniques, sequences or procedures of construction or to safety precautions and programs incident thereto. Such review does not extend to any LPED certification or accreditation. Contractor is responsible for dimensions to be confirmed and controlled at the job site; for information that pertains solely to the fabrication processes; or to techniques of construction and for coordination of the work of all trades.

BY: *JW*
 DATE: 11-05-09

REV.	DATE	REMARKS	DWN	CHK	APVL	SHOP
0						SEP 04 2009
MATERIAL:		SURFACE PREP. & PAINT:		HOLES:		SHOP BOLTS:
				AS NOTED		AS NOTED
DESCRIPTION: FLANGE DIAGRAM						
CASCO BAY STEEL STRUCTURES, INC. 75 SPRING HILL ROAD SACO, MAINE 04072 PHONE (207) 282-7360 FAX. (207) 282-1179						
STRUCTURE: RAMP D VT RTE 279 OVER HALLOOMSAC RIVER BRIDGE NO. B15N BENNINGTON COUNTY				DRAWN: KC	DATE: 06/30	
LOCATION: BENNINGTON, VERMONT				CHKD: WJL	DATE: 07/09	
PROJ NO. AC NH 019-1K51				JOB NO. 408-2		DWG NO. F205
CUSTOMER: KUBRICKY CONSTRUCTION						REV. Δ