

LV	PART NO.	QTY	UM	DESCRIPTION	MATERIAL	REVISION
U	STR12760AB	1	EA	WGA STR-600, RAMP D ABUT 2 PAY LENGTH = 9.875 m	UNCOATED SHIPPING LENGTH = 10 m± APPROX FINISHED WEIGHT = 4,100 lb	
1	STR12760SAB	1	PK	SEAL FOR ASSEMBLY		
2	93	10675	MM	SE STRIP SEAL 300 CA C1735-2	NEOPRENE	
1	5313	12.00	EA	BOLT 19# x 89 A325	ASTM A 325; HOLDING PLT	
1	7010	7.00	EA	THREADED STUD 16# x 38 A 108	ASTM A 108; SHIPPING CLP	
1	8070	6.00	EA	NUT 19# A 563	ASTM A 563; HOLDING PLT	
1	8084	8.00	EA	NUT 19# LAG	LEVELING DVC	
1	7958	7.00	EA	NUT 16# A 563	ASTM A 563; SHIPPING CLP	
1	4282	6	EA	MOD BOX HOLD PTA588 C16724*(X)	ASTM A 588	
1	STR12760AB01	1	PK	EXTRUSION ASSEMBLIES (X)		
2	4640	56	EA	CONCRETE ANCHOR STUD 16 DIA. x 203	ASTM A 108	
2	7050	24	EA	THREADED STUD 19# x 38 A 108	ASTM A 108	
2	STR12760AB02	1	PK	PROFILES (W)		
3	1887	10980	mm	MOD CB FMSS 2.5x5 A588C13824W	ASTM A 588	
3	1943	21960	mm	SS R FM 1.2 x3.2 A588 C15390(W)	ASTM A 588	
3	1917	3050	mm	SS A3 FM 1.250x2 A588 C11810(W)	ASTM A 588	
3	STR114609AB02A	1	PK	BULKHEAD PLATES (X)		
4	3550	285.00	KG	PLATE 3/8 A588	ASTM A 588	
2	STR12760AB03	6	EA	STR-600 SUPPORT BOX (X)	ASTM A 588	
2	STR12760AB04	4	EA	STR-600 SUPPRT BOX (X)	ASTM A 588	
2	STR12760AB05	4	EA	STR-600 LOW HEIGHT SUPPORT BOX (X)	ASTM A 588	
2	STR12760AB06	3	EA	STR-600 SUPPRT BAR (X)	ASTM A 588	
2	STR12760AB07	2	EA	STR-600 SUPPRT BAR (X)	ASTM A 588	
2	STR12760AB08	2	EA	STR-600 LOW HEIGHT SUPPORT BAR (X)	ASTM A 588	
2	STR12760005	1	PK	PARTS FOR ASSEMBLY (J)		
3	4290	10	EA	MOD FLAT BEARING LOWER A22870U	BEARING, URETHANE	
3	4267	10	EA	MOD FLAT BEARING UPPER A22869U	COMPRESSION SPRING, URETHANE	
3	4320	6	EA	CONTROL SPRING DOWEL 200 mm		
3	4338	6	EA	MOD CONTR SPRING (ETHER) C13751		
3	STR12760AB05A	8	EA	LOW HEIGHT BEARING	BEARING, URETHANE	
4	4280	1	EA	MOD FLAT BEARING LOWER A22870U	BEARING, URETHANE	
2	STR12760A306	5	EA	SHIPPING ANGLE (12A2)	TEMPORARY DEVICE	
3	3880	300	mm	ANGLE 76 x 76 x 10	ASTM A 36	
2	STR12760AB07	2	EA	LIFTING ANGLE (9A1)	TEMPORARY DEVICE	
3	4130	204	mm	ANGLE 178 x 102 x 13	ASTM A 36	
2	STR12760AB08	28	EA	STIFFNER PLATE (W)		
3	591C	38	mm	FLAT BAR 10 x 51	ASTM A 588	
2	STR12760AB10	2	EA	SIDEWALK BULKHEAD PLATE (4P3) (X)		
3	3550	58.50	KG	PLATE 10	ASTM A 588	
2	STR12760AB11	5.00	EA	PRESTRESS ASSEMBLY		
3	STR114590AB11A	1.00	EA	PRESTRESS ANGLE (6A1)		
4	3950	127.00	mm	ANGLE 76 x 102 x 51	ASTM A 588	
3	STR114590AB12	1.00	EA	PRESTRESS ANGLE (6A2)		
4	3950	102.00	mm	ANGLE 76 x 102 x 51	ASTM A 588	
3	STR114609AB13	1.00	EA	PRESTRESS ROD		
4	7152	559.00	mm	THREADED ROD 19#		
2	8084	1	EA	NUT 19# LAG		
2	8116	2.00	EA	NUT 22#	ASTM A 325	

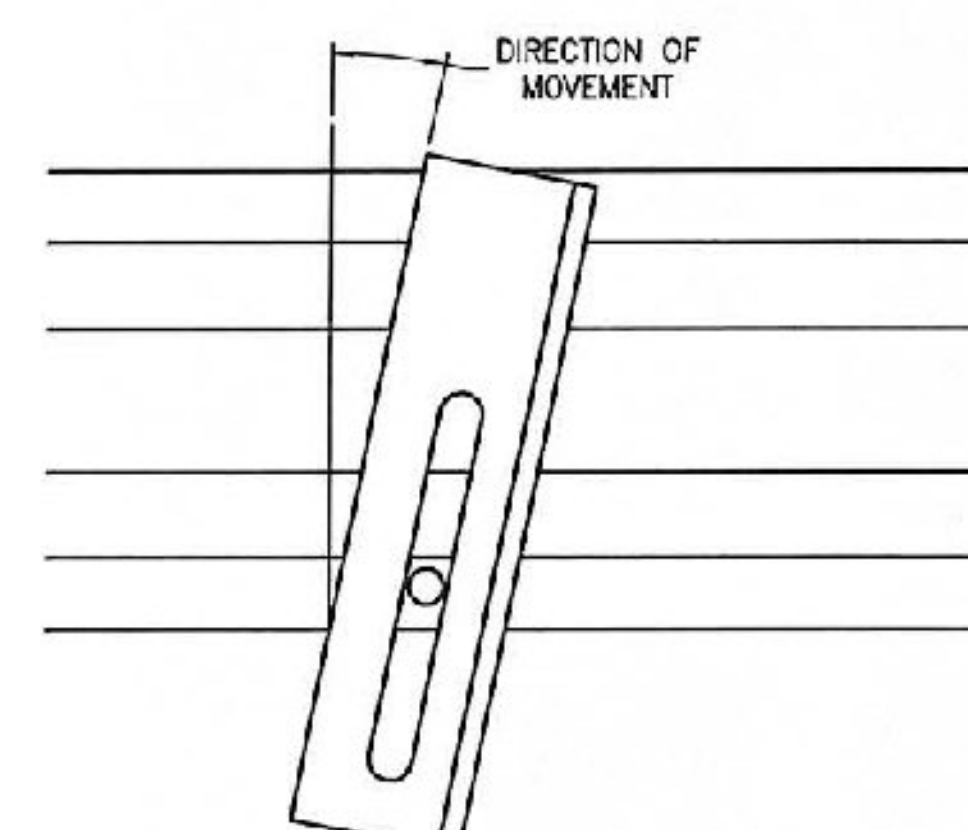

SHIPPING CLAMP ORIENTATION

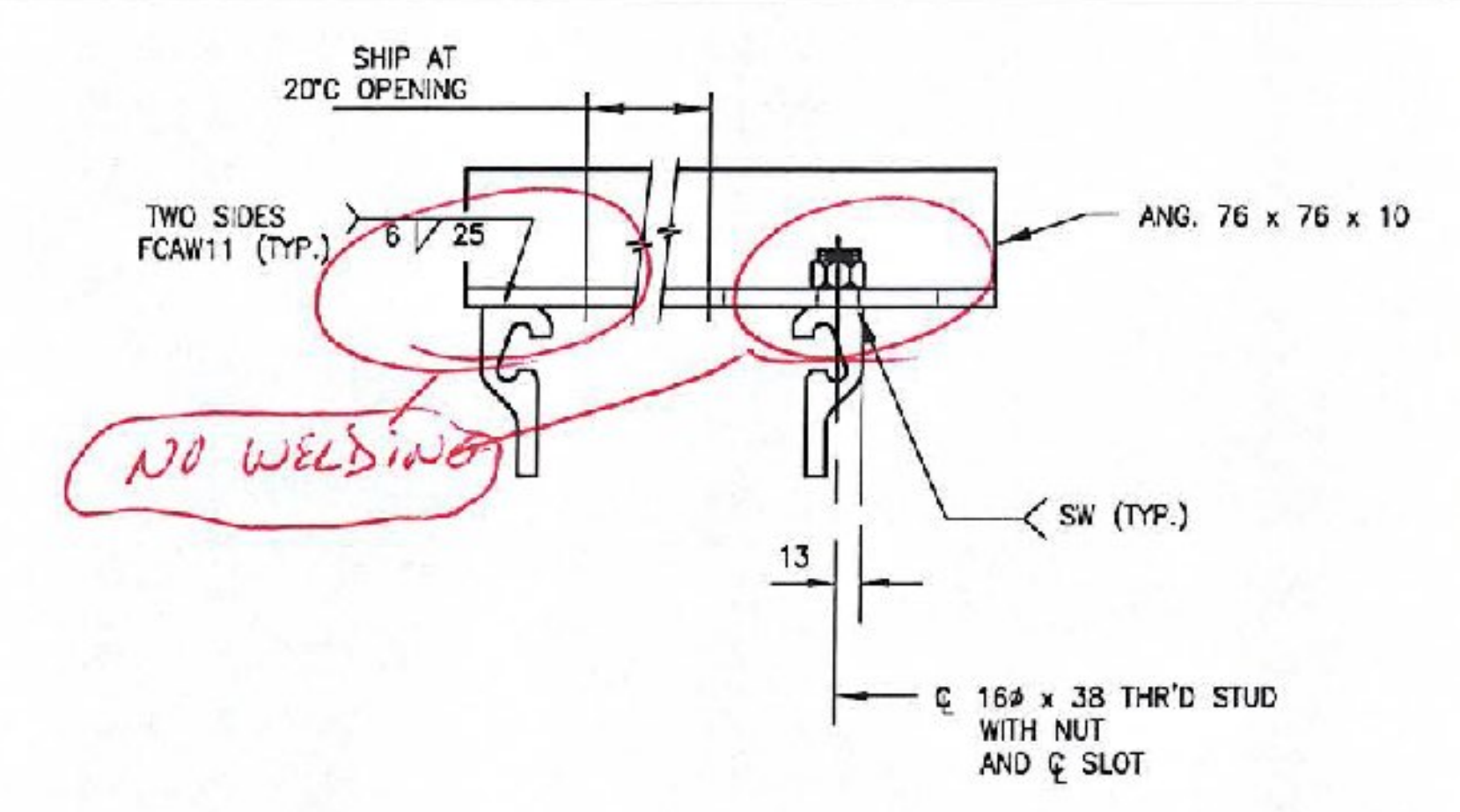

SHIPPING CLAMP ASSEMBLY
(THIS IS A TEMPORARY DEVICE)

NOTE:

- SHIPPING CLAMPS SHALL BE SPACED DIRECTLY BETWEEN SUPPORT BOXES, PARALLEL TO THE CENTERLINE OF THE SUPPORT BAR, AND BETWEEN ENDS OF JT. SEAL ASSEMBLY AND FIRST & LAST BOXES.
- EACH SHIPPING CLAMP ASSEMBLY SHALL INCLUDE:
 - (1) ANGLE - 12A2
 - (1) 16 DIA. X 38 THRD STUD
 - (1) 16 HEX NUT
 - (1) 16 STANDARD WASHER
- CONTRACTOR TO REMOVE SHIPPING CLAMPS WHEN JOINT IS SET AND GRIND WELDS SMOOTH AND REPAIR ANY DAMAGED GALVANIZED AREAS.

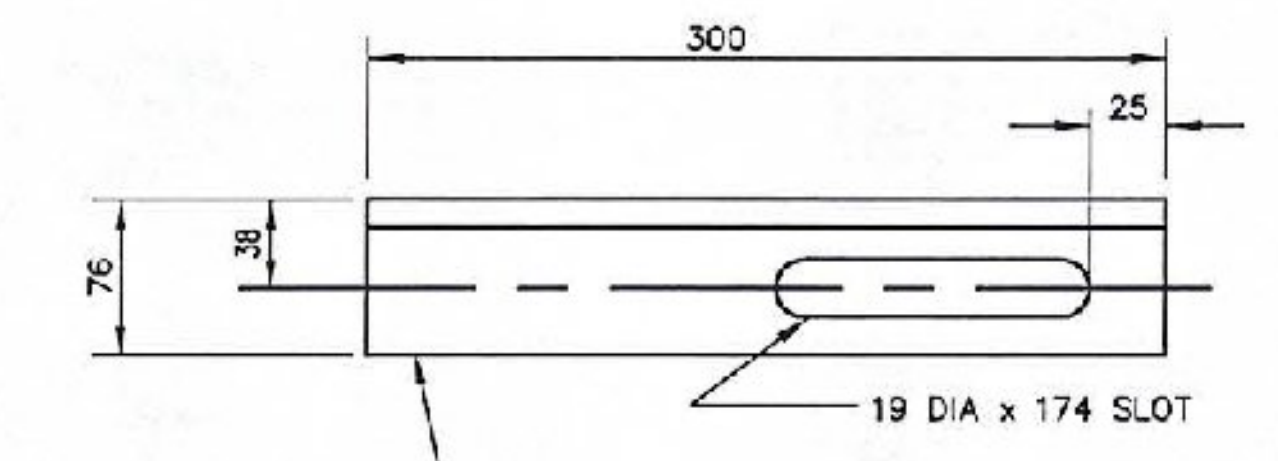

TVGA CONSULTANTS

- NO EXCEPTIONS TAKEN
- REJECTED
- FURNISH AS CORRECTED
- REVISE AND RESUBMIT

ENGINEER has reviewed Shop Drawings and Samples and confirms that the information given in the Contract Documents is compatible with the design concept of the completed Project as a functioning whole as indicated in the Contract Documents. Such reviews do not extend to means, methods, techniques, sequences or procedures of construction or to safety precautions and programs incident thereto. Such reviews do not extend to any LEED certification or accreditation. Contractor is responsible for dimensions to be confirmed and correlated at the job site; for information that pertains solely to the fabrication processes or to techniques of construction; and for coordination of the work of all trades.

BY: *[Signature]*
DATE: 6/17/10

VERMONT AGENCY OF TRANSPORTATION

COUNTY: BENNINGTON

PROJECT NO.: AC NH 019-1(51)

CAPITAL PROJECT ID NO.: -

BRIDGE NO.: B15, B15N, B15S

WBA PRODUCT DESCRIPTION: MODULAR

WBA PRODUCT NO.: STM126770AA

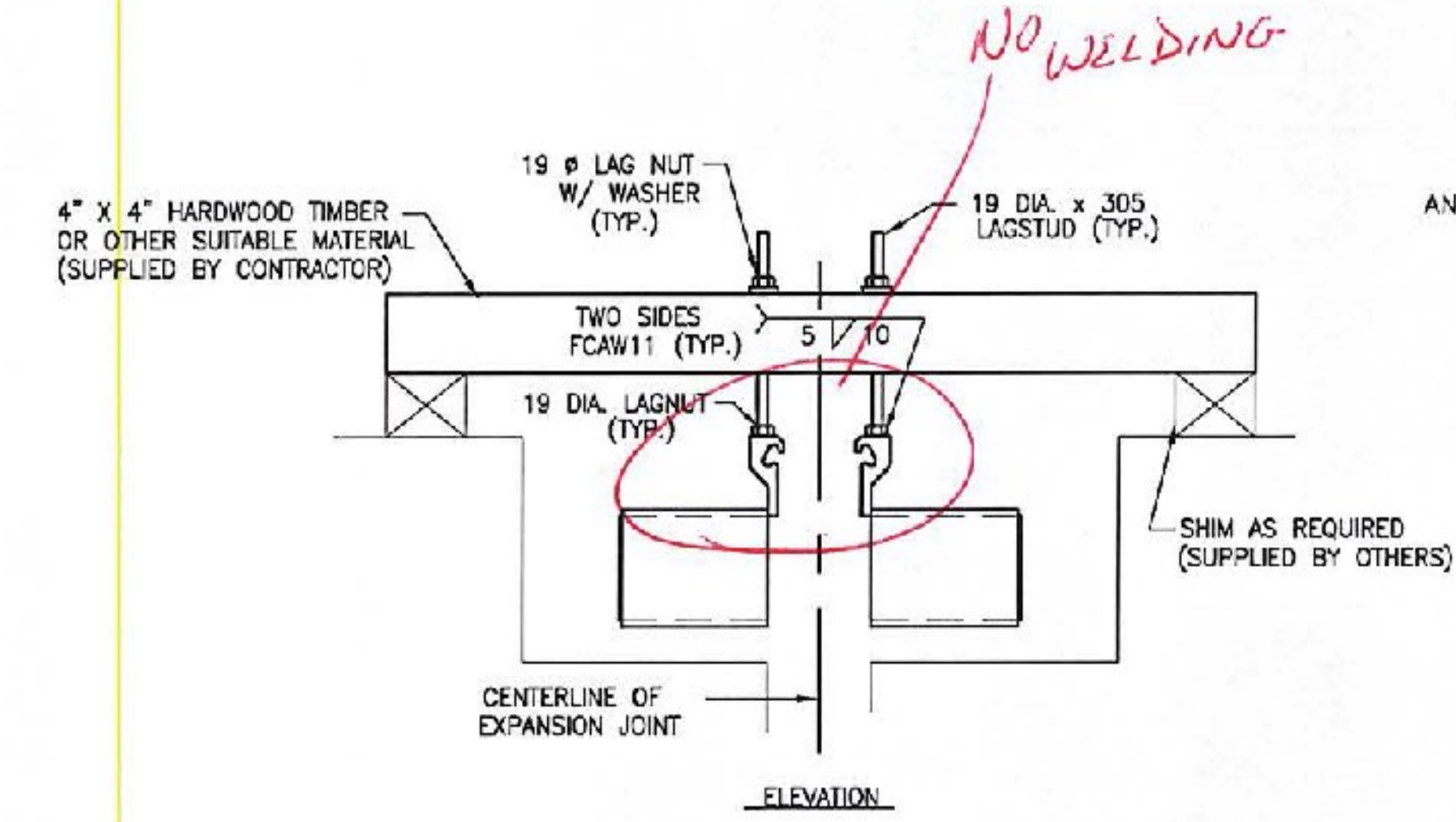

LEVELING ASSEMBLY
(THIS IS A TEMPORARY DEVICE)

NOTE:

- LEVELING LAG NUTS SHALL BE LOCATED AT EVERY OTHER SUPPORT BOX.
- LEVELING LAG NUTS SHALL BE SHOP INSTALLED PARALLEL TO THE EXPANSION JOINT SUPPORT BARS.
- CONTRACTOR SHALL REMOVE LEVELING LAG NUTS WHEN JOINT IS SET AND GRIND WELDS SMOOTH.
- CONTRACTOR SHALL MATCH DRILL THE TIMBER WITH THE 19mm LAG STUDS PRIOR TO SETTING THE JOINT SEAL ASSEMBLY IN ITS FINAL POSITION.
- CONTRACTOR SHALL REPAIR ANY DAMAGED GALVANIZED AREAS.

DRAWING ACTION:

SUBMITTED FOR APPROVAL

1/20/10

NO.	DESCRIPTION	DATE

MARK SYSTEM

Watson Bowman Acme
25 Phoenix Drive
Amherst, NY 14205
Phone: (716) 681-2500
Fax: (716) 681-6200
www.watsonacme.com

BASF
The Chemical Company

PROJECT: WWII VETERAN'S MEMORIAL HIGHWAY
VT ROUTE 279, PRINCIPAL ARTERIAL

WBA MODULAR STM-600 EXPANSION JOINT DETAILS

DATE: 12/23/09	DATE: 1/7/10
SCALE: NTS	WBA JOB NO.: 126770
SHEET NO.: 14 of 14	DRAWING NO.: B-27574