

LV	PART NO.	QTY	UM	DESCRIPTION	MATERIAL	REVISION
0	STR12760AA	1	EA	WBA STR-600, RAMP A ASUT 2 PAY LENGTH = 9.875 m	UNCOATED SHIPPING LENGTH = 10 m± APPROX FINISHED WEIGHT = 4,100 lb	
1	STR12760SAA	1	PK	SEAL FOR ASSEMBLY		
2	93	10675	MM	SE STRIP SEAL 300 CA C1735-2	NEOPRENE	
1	5313	12.00	EA	BOLT 19# x 89 A 325	ASTM A 325; HOLDING PLT	
1	7010	7.00	EA	THREADED STUD 16# x 38 A 108	ASTM A 108; SHIPPING CLP	
1	8070	6.00	EA	NUT 19# A 563	ASTM A 563; HOLDING PLT	
1	8084	8.00	EA	NUT 19# LAG	LEVELING DVC	
1	7959	7.00	EA	NUT 15# A 563	ASTM A 563; SHIPPING CLP	
1	4282	6	EA	MOD BOX HOLD PTA588 C16724-TX	ASTM A 588	
1	STR12760AA01	1	PK	EXTRUSION ASSEMBLIES (X)		
2	4640	56	EA	CONCRETE ANCHOR STUD 16 DIA. x 203	ASTM A 108	
2	7050	24	EA	THREADED STUD 19# x 38 A 108	ASTM A 108	
2	STR12760AA02	1	PK	PROFILES (W)		
3	1887	10980	mm	MCD CB FM SS 2.5x5 A588C13824W	ASTM A 588	
3	1943	21960	mm	SS R FM 1.2 x 3.2 A588 C15390(W)	ASTM A 588	
3	1917	3050	mm	SS A3 FM 1.250x2 A588 C11810(W)	ASTM A 588	
3	STR114609AA02A	1	PK	BULKHEAD PLATES (X)		
4	3550	289.00	KG	PLATE 3/8 A588	ASTM A 588	
2	STR12760AA03	6	EA	STR-600 SUPPORT BOX (X)	ASTM A 588	
2	STR12760AA04	4	EA	STR-600 SUPPORT BOX (X)	ASTM A 588	
2	STR12760AA05	4	EA	STR-600 LOW HEIGHT SUPPORT BOX (X)	ASTM A 588	
2	STR12760AA06	3	EA	STR-600 SUPPORT BAR (X)	ASTM A 588	
2	STR12760AA07	2	EA	STR-600 SUPPORT BAR (X)	ASTM A 588	
2	STR12760AA08	2	EA	STR-600 LOW HEIGHT SUPPORT BAR (X)	ASTM A 588	
2	STR12760005	1	PK	PARTS FOR ASSEMBLY (U)		
3	4290	10	EA	MCD FLAT BEARING LOWER A22870U	BEARING; URETHANE	
3	4267	10	EA	MCD FLAT BEARING UPPER A22869U	COMPRESSION SPRING; URETHANE	
3	4320	6	EA	CONTROL SPRING DOWEL 200 mm		
3	4338	6	EA	MOD CONTR SPRING (ETHER)C13751		
3	STR12760AA05A	8	EA	LOW HEIGHT BEARING	BEARING; URETHANE	
4	4290	1	EA	MCD FLAT BEARING LOWER A22870U	BEARING; URETHANE	
2	STR12760AA06	5	EA	SHIPPING ANGLE (12A2)	TEMPORARY DEVICE	
3	3580	300	mm	ANGLE 76 x 76 x 10	ASTM A 36	
2	STR12760AA07	2	EA	LIFTING ANGLE (9A1)	TEMPORARY DEVICE	
3	4130	204	mm	ANGLE 178 x 102 x 13	ASTM A 36	
2	STR12760AA08	28	EA	STIFFNER PLATE (W)		
3	5910	38	mm	FLAT BAR 10 x 51	ASTM A 588	
2	STR12760AA10	2	EA	SIDEWALK BULKHEAD PLATE (4P3) (X)		
3	3550	66.60	KG	PLATE 10	ASTM A 588	
2	STR12760AA11	5.00	EA	PRESTRESS ASSEMBLY		
3	STR114609AA11A	1.00	EA	PRESTRESS ANGLE (6A1)		
4	3950	127.00	mm	ANGLE 76 x 102 x 51	ASTM A 588	
3	STR114609AA12	1.00	EA	PRESTRESS ANGLE (6A2)		
4	3950	102.00	mm	ANGLE 76 x 102 x 51	ASTM A 588	
3	STR114609AA13	1.00	EA	PRESTRESS ROD		
4	7182	559.00	mm	THREADED ROD 19#		
2	8084	1	EA	NUT 19# LAG		
2	8116	2.00	EA	NUT 22#	ASTM A 325	

LV	PART NO.	QTY	UM	DESCRIPTION	MATERIAL	REVISION
0	STR12760PS	1	EA	PARTS FOR SHIPPING		
1	4293	28	EA	MODULAR LEVELING ROD (19# x 305)	LEVELING DEVICE	
1	8094	60	EA	NUT 19# LAG	ASTM F 436 LEVELING DVC	
1	8070	60	EA	NUT 19#	ASTM A 563; CLIP ANGLE	
1	7591	120	EA	WASHER 19#	ASTM F 436 LVL DVC CLIP ANGLE, FIELD SP	
1	8553	90	EA	THD ANC HILT HAS ROD 34-10	CLIP ANGLE	
1	8532	90	EA	THD ANC HILT HY150 LG 15.9 OZ	CLIP ANGLE	
1	3801	60	EA	ANGLE PREFB CLIP C20168 A38/W	ASTM A 36	
1	NTS127690A	16	EA	SCREW 19# x 25 (3/4" x 1") FHGD (A) ASTM F 835	BARRIER & SIDEWALK PLT	
1	5638	16	EA	THD ANC R/CHMOND LF INS 3/4 D	BARRIER & SIDEWALK PLT	

LV	PART NO.	QTY	UM	DESCRIPTION	MATERIAL	REVISION
0	SLI127660SP	1	EA	SIDEWALK PLATE- NORTH END	GALVANIZED	
1	SLI127660SP01	1	EA	BARRIER PLATE ASSEMBLY (11P11)		
2	3540	191.5	KG	PLATE 10	ASTM A 36	

LV	PART NO.	QTY	UM	DESCRIPTION	MATERIAL	REVISION
0	SLI127660SP	1	EA	SIDEWALK PLATE- SOUTH END	GALVANIZED	
1	SLI127660SP01	1	EA	BARRIER PLATE ASSEMBLY (11P11)		
2	3540	191.5	KG	PLATE 10	ASTM A 36	

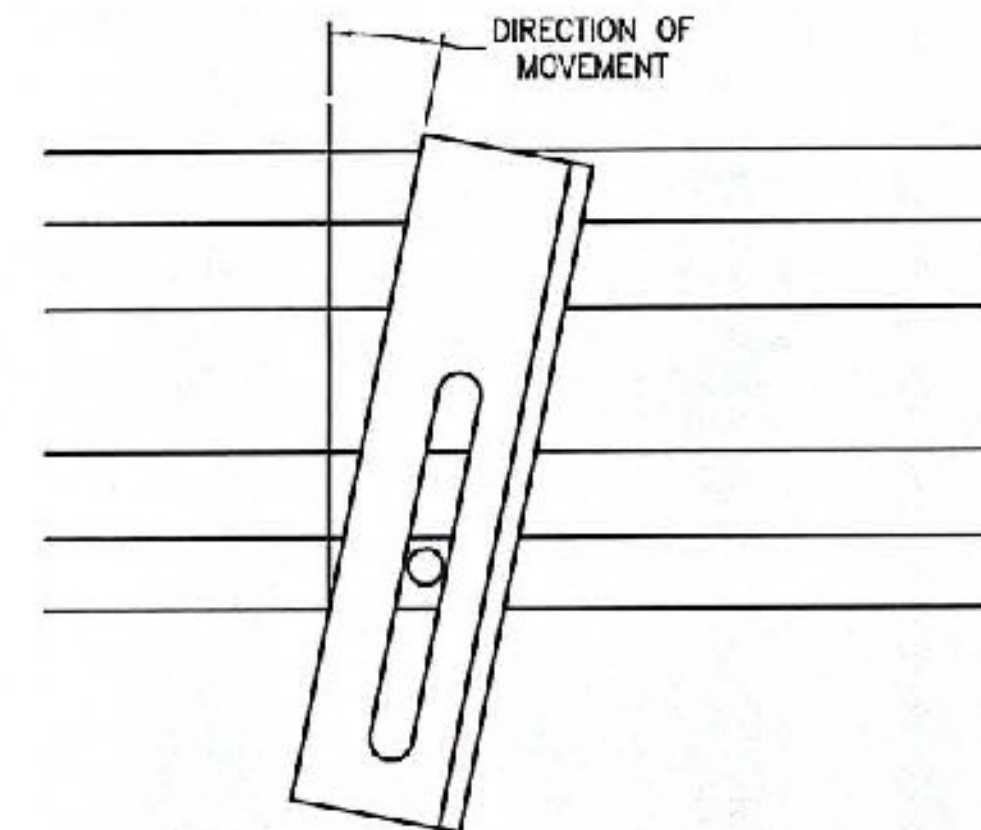

SHIPPING CLAMP ORIENTATION

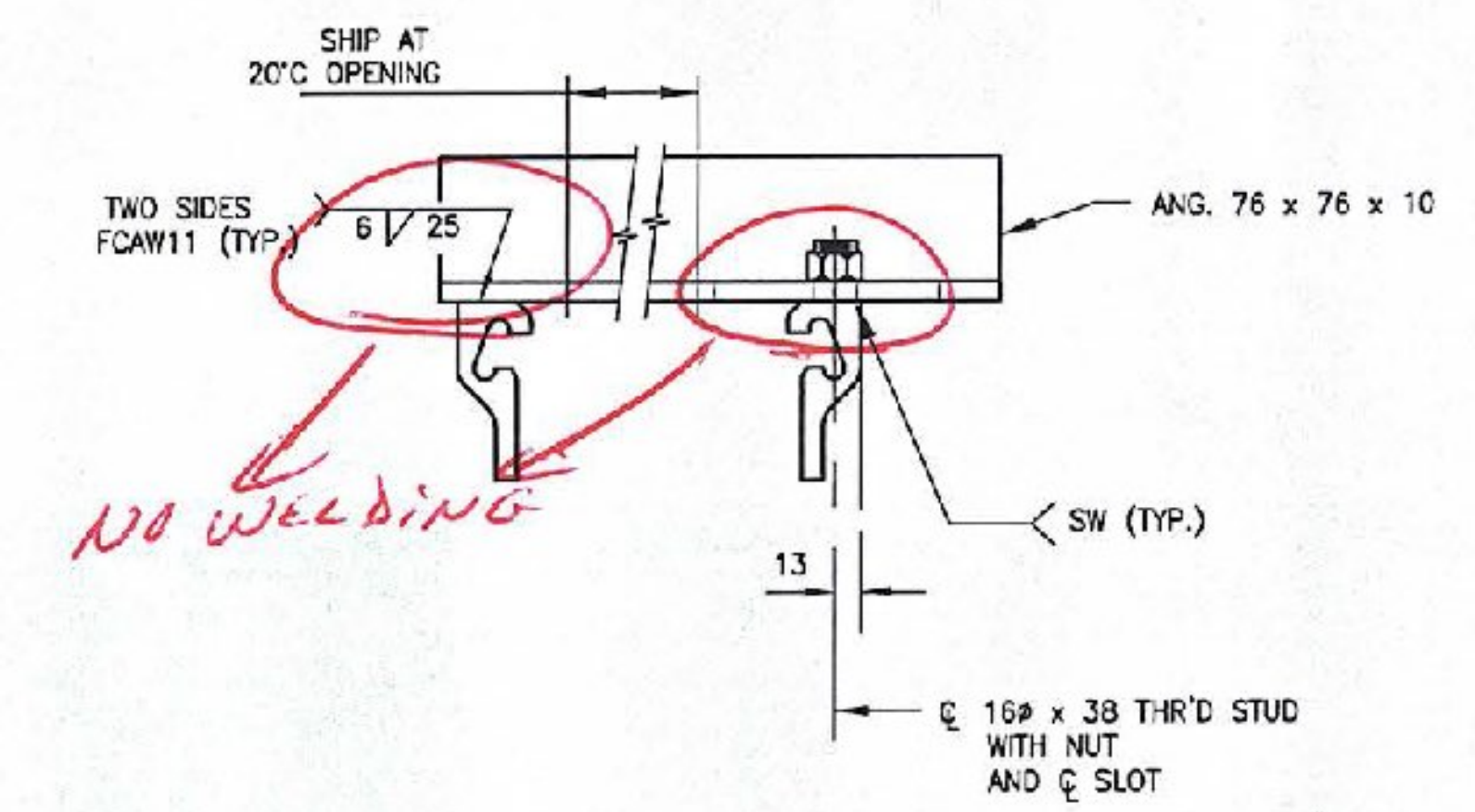

SHIPPING CLAMP ASSEMBLY
(THIS IS A TEMPORARY DEVICE)

NOTE:

- SHIPPING CLAMPS SHALL BE SPACED DIRECTLY BETWEEN SUPPORT BOXES, PARALLEL TO THE CENTERLINE OF THE SUPPORT BAR, AND BETWEEN ENDS OF JT. SEAL ASSEMBLY AND FIRST & LAST BOXES.
- EACH SHIPPING CLAMP ASSEMBLY SHALL INCLUDE:
 - (1) ANGLE - 12A2
 - (1) 16 DIA. X 38 THRD STUD
 - (1) 16 HEX NUT
 - (1) 16 STANDARD WASHER
- CONTRACTOR TO REMOVE SHIPPING CLAMPS WHEN JOINT IS SET AND GRIND WELDS SMOOTH AND REPAIR ANY DAMAGED GALVANIZED AREAS.

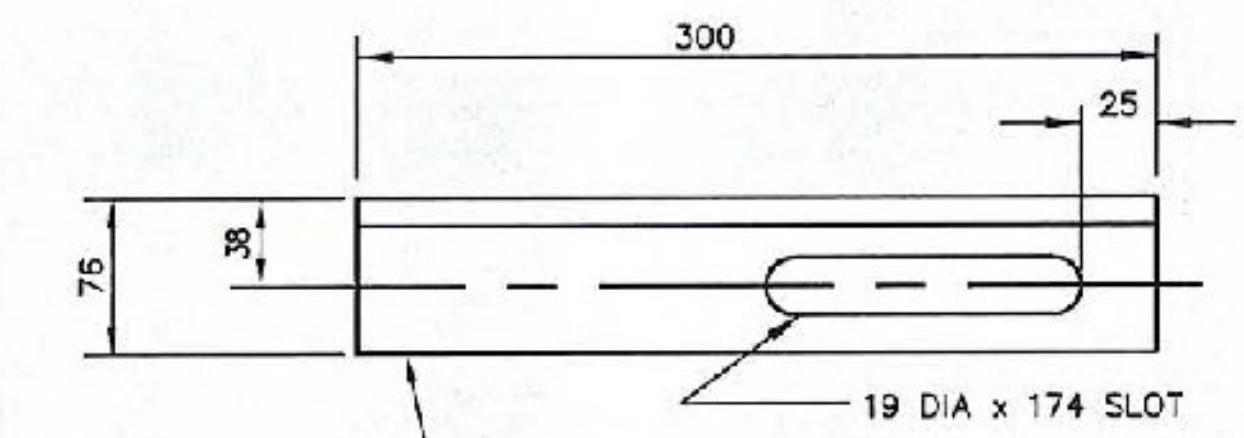

DETAIL 12A2

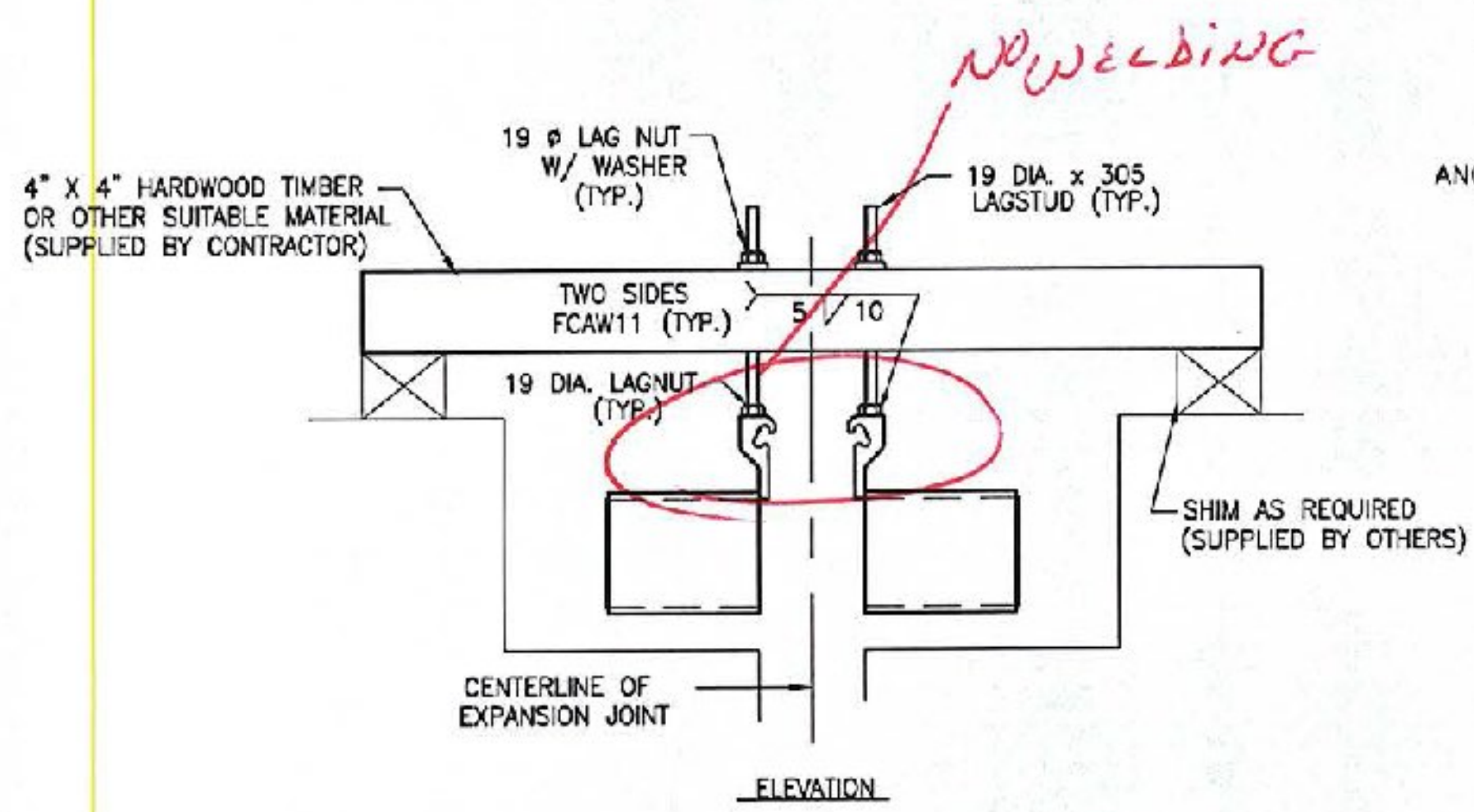

LEVELING ASSEMBLY
(THIS IS A TEMPORARY DEVICE)

NOTE:

- LEVELING LAG NUTS SHALL BE LOCATED AT EVERY OTHER SUPPORT BOX.
- LEVELING LAG NUTS SHALL BE SHOP INSTALLED PARALLEL TO THE EXPANSION JOINT SUPPORT BARS.
- CONTRACTOR SHALL REMOVE LEVELING LAG NUTS WHEN JOINT IS SET AND GRIND WELDS SMOOTH.
- CONTRACTOR SHALL MATCH DRILL THE TIMBER WITH THE 19mm LAG STUDS PRIOR TO SETTING THE JOINT SEAL ASSEMBLY IN ITS FINAL POSITION.
- CONTRACTOR SHALL REPAIR ANY DAMAGED GALVANIZED AREAS.

INSPECTION REQUIRED

NO EXCEPTIONS TAKEN REJECTED
 FURNISH AS CORRECTED
 REVISE AND RESUBMIT

ENGINEER has reviewed Shop Drawings and Samples and other data which Contractor is required to submit, only for conformance with the information given in the Contract Documents. Compatibility with the design concept of the completed Project as a functioning whole as indicated in the Contract Documents. Such reviews do not extend to means, methods, techniques, sequences or procedures of construction or to safety precautions and programs incident thereto. Such reviews do not extend to any LEED certification or accreditation. Contractor is responsible for dimensions to be confirmed and correlated at the job site; for information that pertains solely to the fabrication processes or to techniques of construction; and for coordination of the work of all trades.

BY: *Andr. Col.*
 DATE: 6/1/2016

VERMONT AGENCY OF TRANSPORTATION
 COUNTY: BENNINGTON
 PROJECT NO.: AC NH 019-1(51)
 CAPITAL PROJECT ID NO.: -
 BRIDGE NO.: B15, B15N, B15S
 WBA PRODUCT DESCRIPTION: MODULAR
 WBA PRODUCT NO.: STM126770AA

DRAWING ACTION:

SUBMITTED FOR APPROVAL

1/20/10

DESIGNER	DATE

Information provided herein, including but not limited to, any drawing, design, photograph, graphic, or attachment ("Materials") are proprietary and the property of Watson Bowman Acme Corporation ("Company"). Reproduction, translation, or reduction to any electronic medium or machine readable form, in whole or part, is strictly prohibited, except for the express purpose for which it has been furnished, without prior written consent of Company. All Materials contained herein are provided by Company for informational purposes only. Company reserves the right to amend or withdraw any information contained in the Materials without notice. All technical or other advice by Company, whether verbal or written, concerning products, or the use of products in specific situations ("Advice") is given by Company and is used at the Users own risk.

Watson Bowman Acme

Watson Bowman Acme Corp.
 85 Plowman Drive
 Arden, NY 14225
 phone: (716) 991-7500
 fax: (716) 991-6220
 www.wbcorp.com

BASF
 The Chemical Company

SCALE: NTS	DATE: 1/7/10
SHEET NO: 14 of 14	WBA JOB NO: 126770
DRAWING NO: B-27569	

PROJECT: WWII VETERAN'S MEMORIAL HIGHWAY
 VT ROUTE 279, PRINCIPAL ARTERIAL
 WBA MODULAR STM-600 EXPANSION JOINT DETAILS