

BORINGS

| |
|------------|
| B-123 (OW) |
| 0.6-Si |
| 1.8-Sa |
| 3.4-Sa |
| 4.9-Si |
| 6.1-Si |
| 7.6-Si |
| 9.0-Si |
| 10.4-Gr |

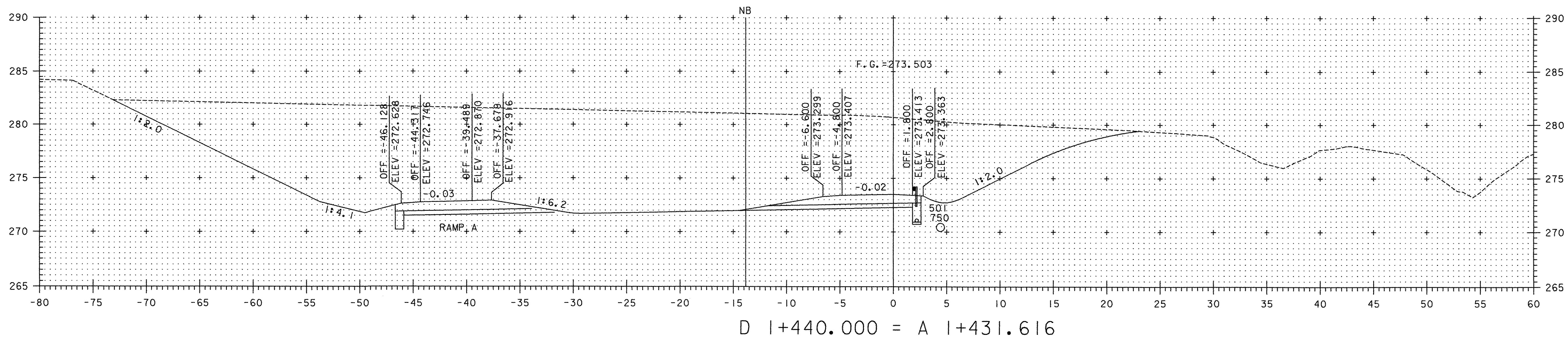

NOTE:
FOR CLARITY, RAMP A CROSS SECTIONS HAVE BEEN
COMBINED WITH RAMP D CROSS SECTIONS. BE ADVISED
RAMP A SECTIONS ARE PERPENDICULAR TO RAMP D.
ALIGNMENT. ALL OFFSETS SHOWN ARE FROM RAMP D.

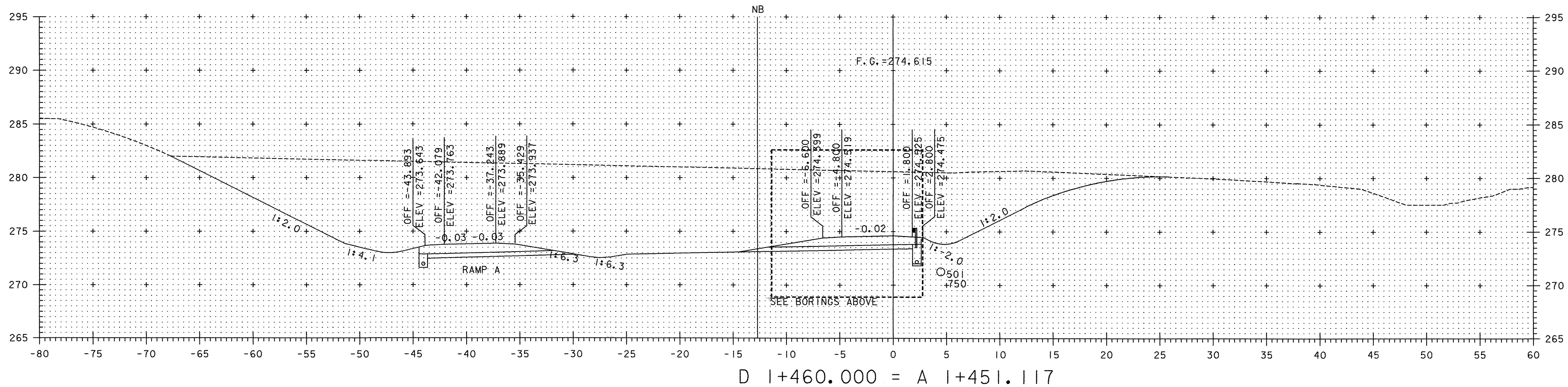
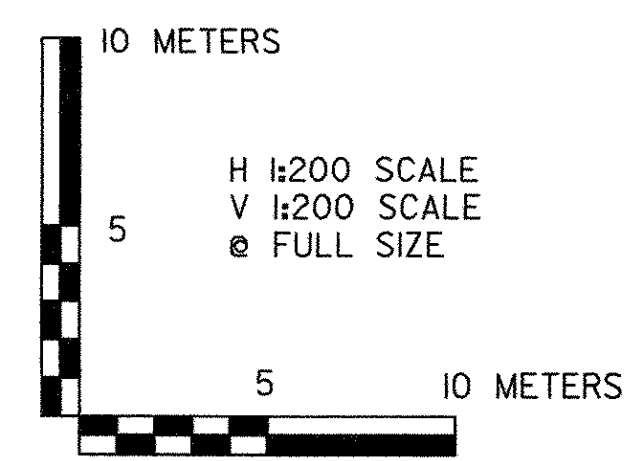

| | |
|---|------------------------|
| VERMONT AGENCY OF TRANSPORTATION | |
| | |
| PROJECT NAME: BENNINGTON | PLOT DATE: 1/29/2009 |
| PROJECT NUMBER: AC NH 019-1(51) | DRAWN BY: STANTEC |
| FILE NAME: ...z307c1xs_combined.ptf | CHECKED BY: GARY SANTY |
| DESIGN SUPERVISOR: GREG EDWARDS | SHEET 332 OF 367 |
| DESIGNED BY: MARC FOISY | |
| RAMP D CROSS SECTIONS DX-11 | |

V:\953\vt\va\953002\Transportation\Drawing\cort\rdet_1\ndot1_files\vd307c1xs_combined.dwg