

A I+060

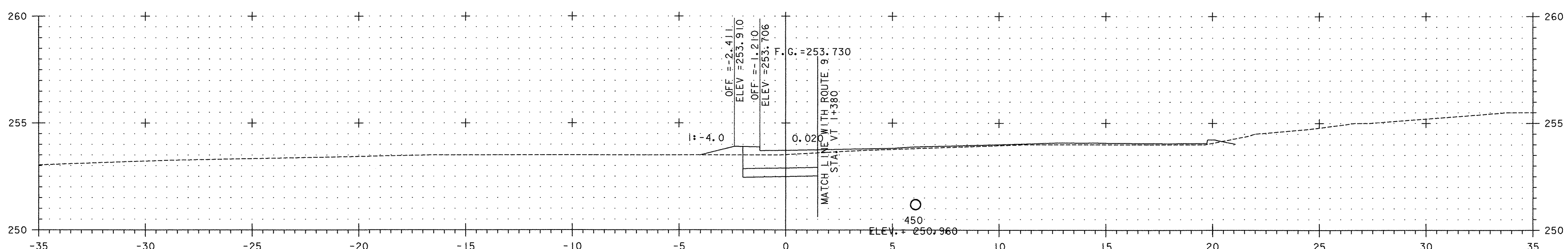

A I+045

STA. A I+000.000 = VT I+345.000, 4.95m LT.

v:\1953\active\195310002\transportation\drawing\contract_in\plot_files\z4307cxs_ramp.pxf

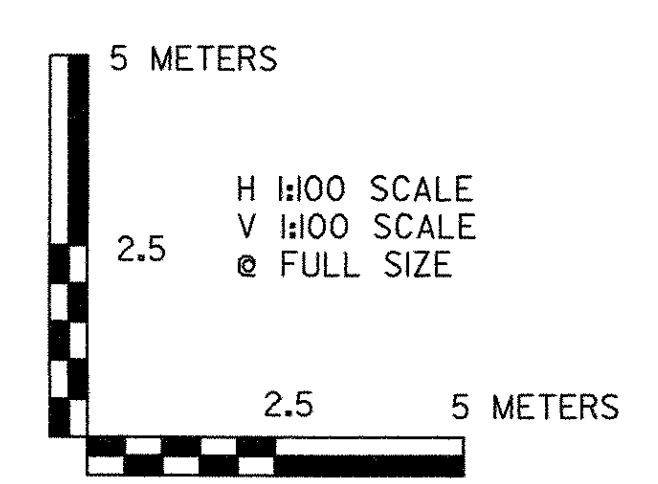

VERMONT AGENCY OF TRANSPORTATION	
	PROJECT NAME: BENNINGTON
	PROJECT NUMBER: AC NH 019-(K51)
FILE NAME: ...\plot_files\z4307cxs_ramp.pxf	PLOT DATE: 1/29/2009
DESIGN SUPERVISOR: GREG EDWARDS	DRAWN BY: STANTEC
DESIGNED BY: MARC FOISY	CHECKED BY: GARY SANTY
RAMP A CROSS SECTIONS AX-01	SHEET 319 OF 367