

SECTION A-A
(ABUTMENT 2 - RAMP D)
SCALE 1:40

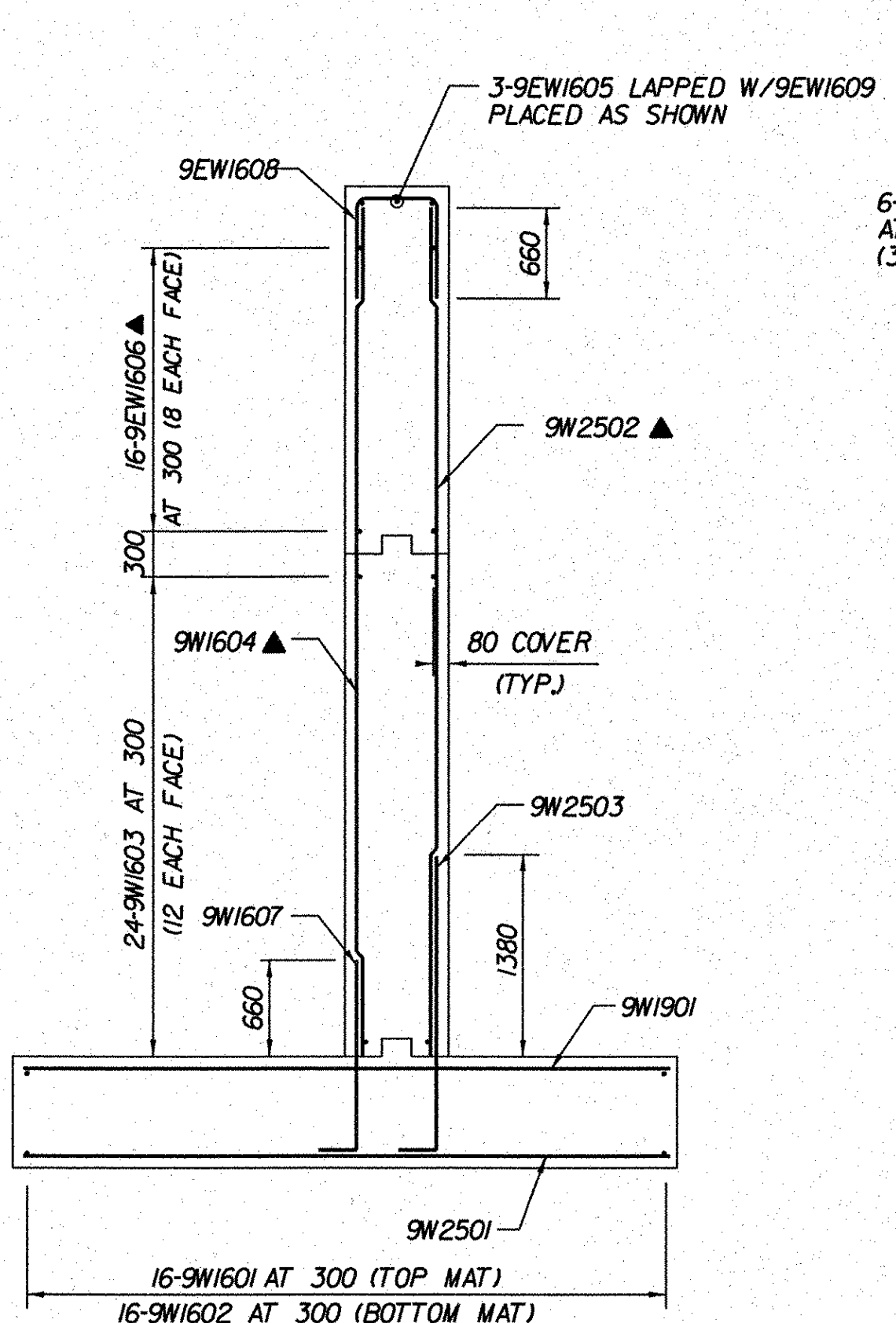

SECTION B-B
(WINGWALL NO. 9)

(SEE BRIDGE SHEET BR293 FOR SECTION LOCATION)
SCALE 1:40

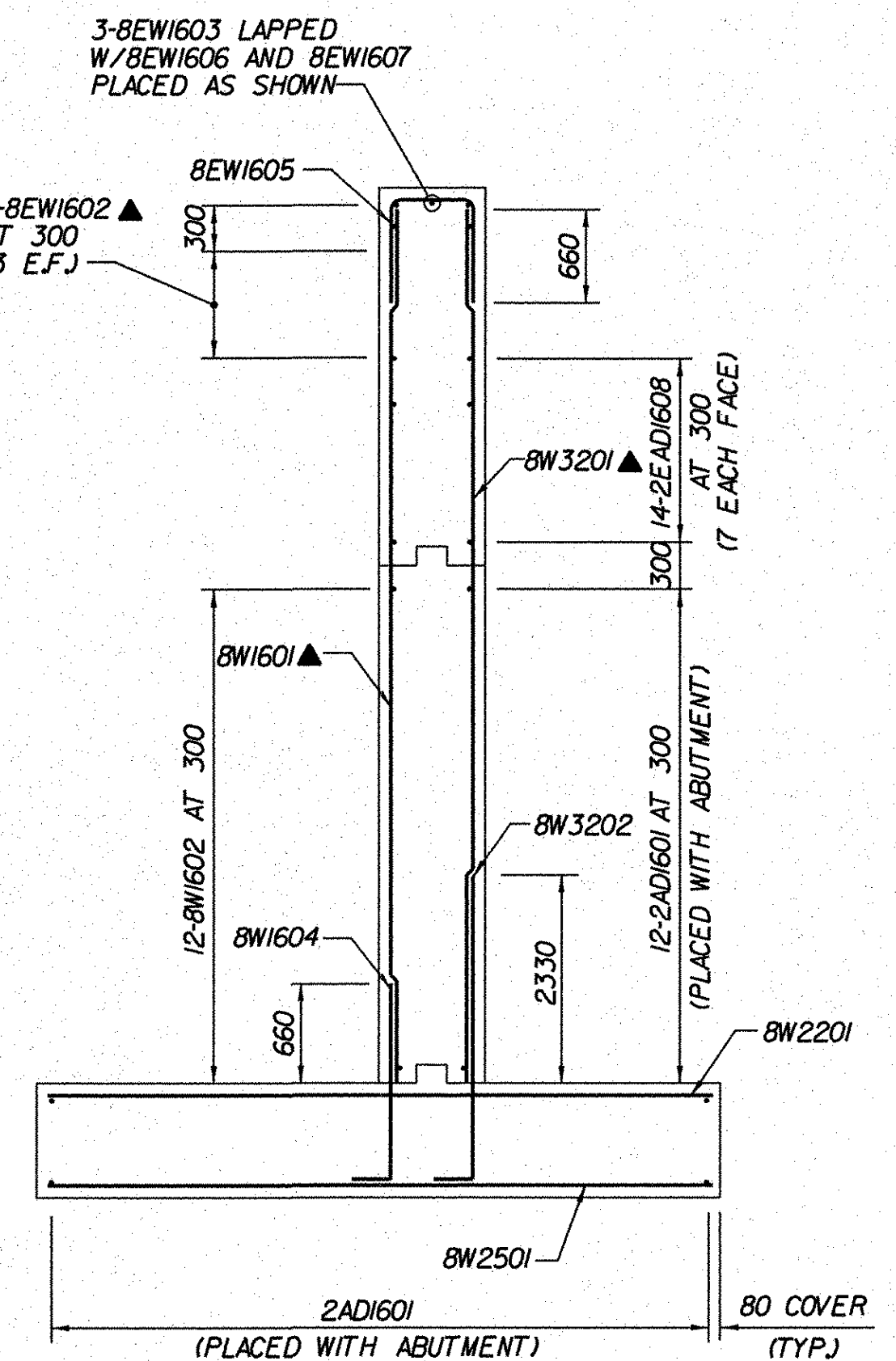

SECTION C-C
(WINGWALL NO. 8)

(SEE BRIDGE SHEET BR293 FOR SECTION LOCATION)
SCALE 1:40

VT ROUTE 279
ABUTMENT 2 REINFORCING
(SEE BRIDGE SHEET BR253)

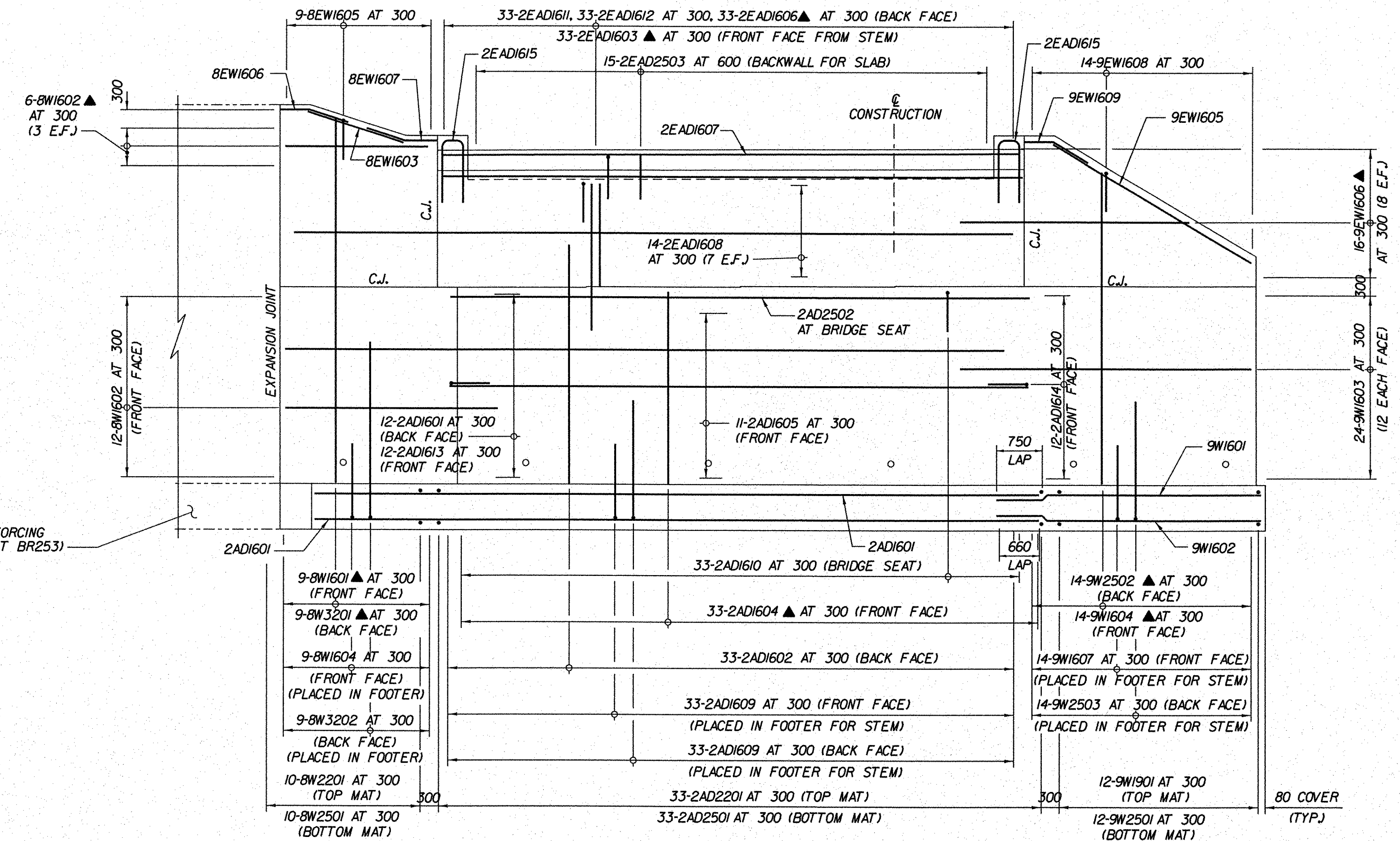

ELEVATION
(ABUTMENT 2 - RAMP D, WINGWALL NO. 8 AND WINGWALL NO. 9)
SCALE 1:50

- LEGEND:**
 F.F. - FRONT FACE
 B.F. - BACK FACE
 E.F. - EACH FACE
 C.B. - CORNER BAR
 C.J. - CONSTRUCTION JOINT
 ▲ - CUT TO FIT IN FIELD

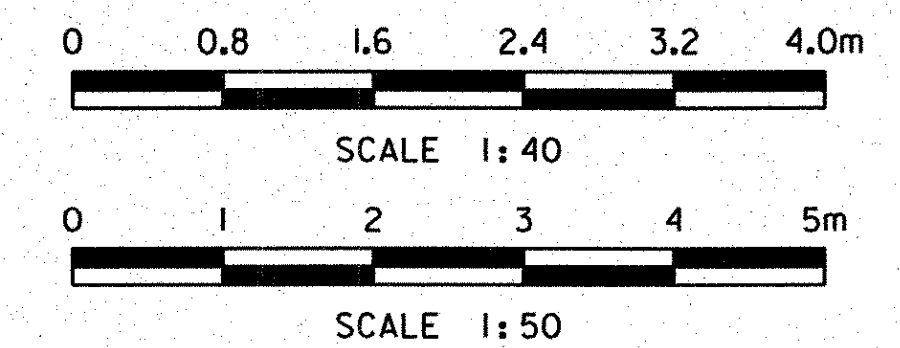

STATE OF VERMONT
AGENCY OF TRANSPORTATION

Town Of	BENNINGTON	Bridge No.	B15N
Highway No.	VT RTE 279	Log Sta.	
		Surv. Sta.	
VT ROUTE 279 & RAMPS OVER ROARING BRANCH OF WALLOOSAC RIVER			
ABUTMENT 2 REINFORCEMENT DETAILS (RAMP D)			
Designed By	B.J. CARLSON	Drawn By	R.G. COCOL
Checked By	K.M. WOJTKOWSKI	Date	06/08
		Bridge Design Supervisor	K.M. WOJTKOWSKI
		Date	06/08
PROJECT	BENNINGTON	PROJECT NO.	AC NH 019-1(51)
TVGA CAD Drawing No.	RmpDA2RebDef.dgn	Date	02/02/2009
Bridge Sheet No.	BR294	Sheet	281 of 367

