

PHASE I

A) CONSTRUCT TEMPORARY WIDENING FROM STA. I+380 - I+570 FROM EXISTING EP - 8 M LT.
 C) SWITCH TRAFFIC TO REBUILT ROUTE 9 AND CONSTRUCT STA. I+380 - I+570 2 M LT - LIMITS LT.
 B) CONSTRUCT ROUTE 9 STA. I+380 - I+570 1M LT - LIMITS RT WITH TEMPORARY TRAFFIC BARRIER AT 2 M LT.
 D) CONSTRUCT A RAMP TO STA. I+090, D RAMP TO I+090.

NOTE: CONTRACTOR SHALL CLOSE NEW RAMP TO TRAVELING PUBLIC AT COMPLETION OF PHASE I, USING METHOD AS APPROVED BY ENGINEER.

DID NOT USE PHASING PLAN

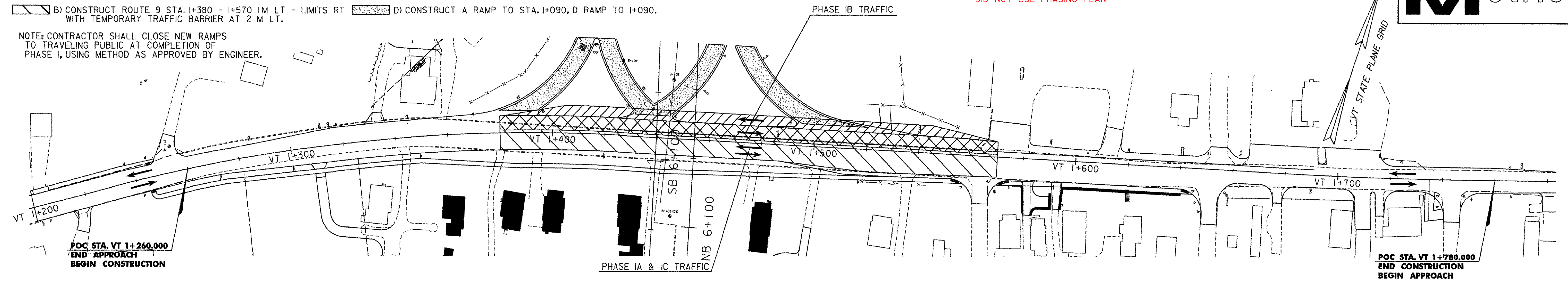

PHASE II

A) USING ONE-WAY TRAFFIC, CONSTRUCT ROUTE 9 STA. I+235 - I+380 1M LT - LIMITS RT.
 B) SWITCH TRAFFIC TO REBUILT ROUTE 9 RT AND CONSTRUCTION 1M LT - LIMITS.

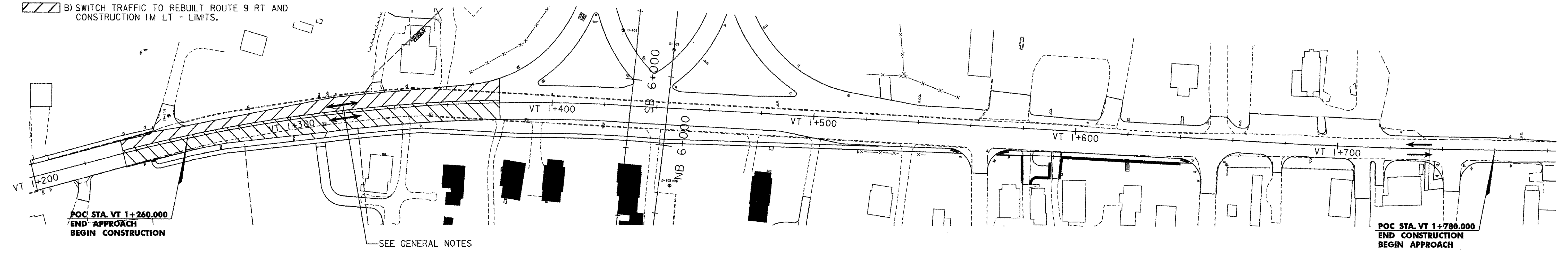

PHASE III

A) USING ONE-WAY TRAFFIC CONSTRUCT ROUTE 9 STA. I+570 - I+725 CL - LIMITS RT.
 B) SWITCH TRAFFIC TO REBUILT ROUTE 9 RT AND CONSTRUCT I+570 - I+725 LT.

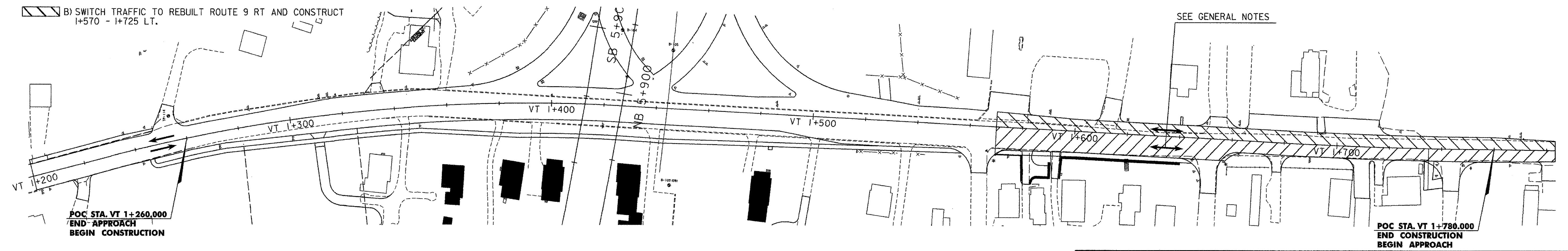

GENERAL NOTES

- ONE-WAY TRAFFIC SHALL BE MAINTAINED BY FLAGGERS, CONES, BARRELS, AND/OR UNIFORMED OFFICERS WITH VEHICLES DURING WORKING HOURS.
- TWO-WAY TRAFFIC SHALL BE MAINTAINED DURING NON-WORKING HOURS, HOLIDAYS AND WEEKENDS.
- FOR TEMPORARY TRAFFIC BARRIER DETAILS SEE THE 2002 AASHTO ROADSIDE DESIGN GUIDE.

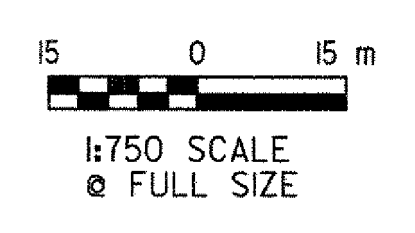

VERMONT AGENCY OF TRANSPORTATION	
	PROJECT NAME: BENNINGTON
	PROJECT NUMBER: AC NH 019-(51)
FILE NAME: ...\\plot files\vd307d\hcc2.prf	PLOT DATE: 2/3/2009
DESIGN SUPERVISOR: GREG EDWARDS	DRAWN BY: STANTEC
DESIGNED BY: MARC FOISY	CHECKED BY: GARY SANTY
TRAFFIC CONTROL TCC-02	SHEET 166 OF 367

Y:\953\active\18530002\transportation\drawing\contract\1\p101 - files\z307d\hcc2.dwg