

TRAFFIC CONTROL TYPICAL SECTIONS-VT ROUTE 9

DID NOT USE PHASING PLAN

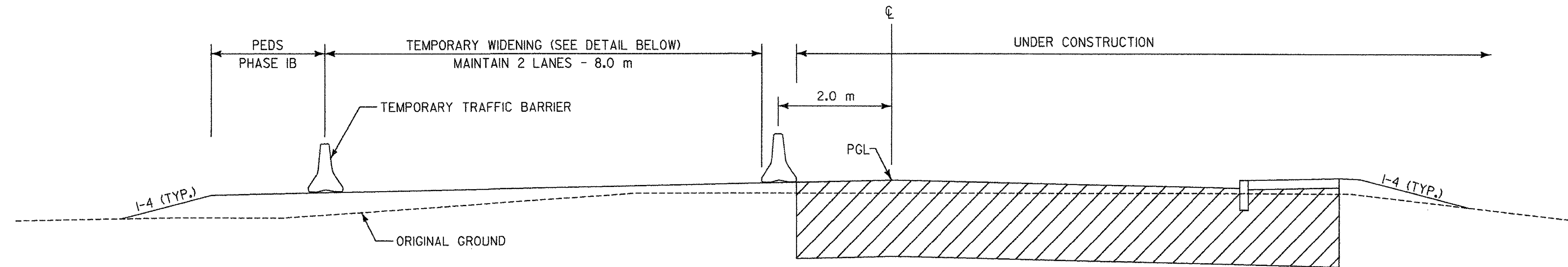

PHASE IA & IB STA. VT 1+380 - STA. VT 1+570

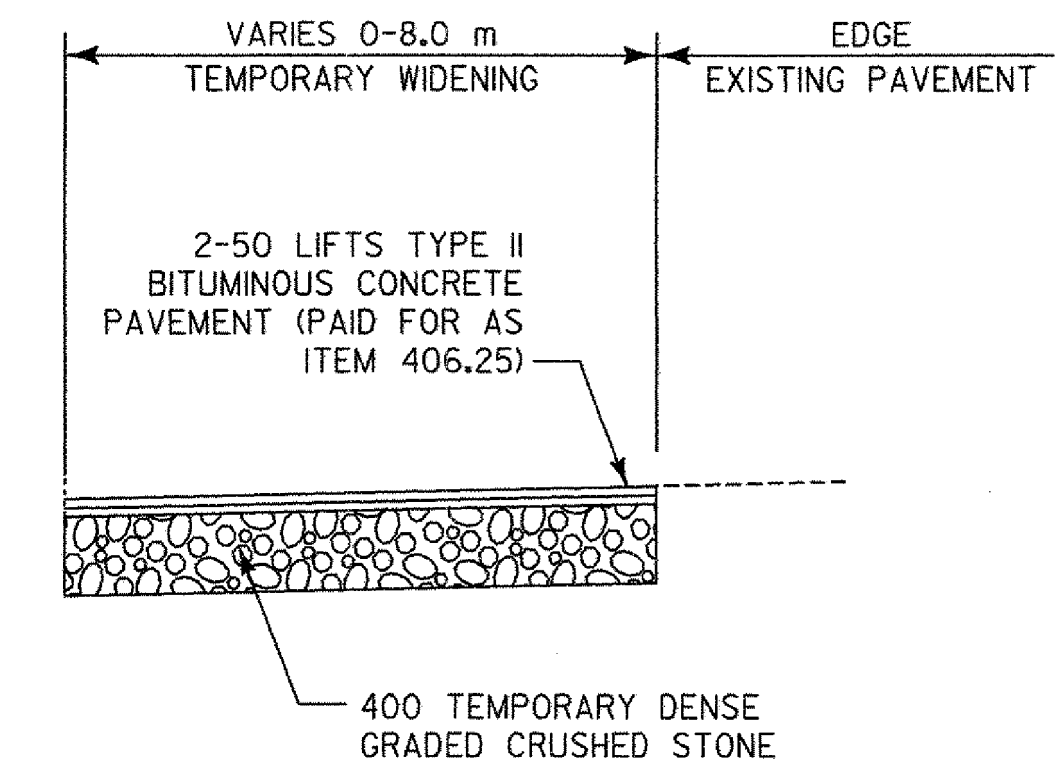

TEMPORARY WIDENING DETAIL

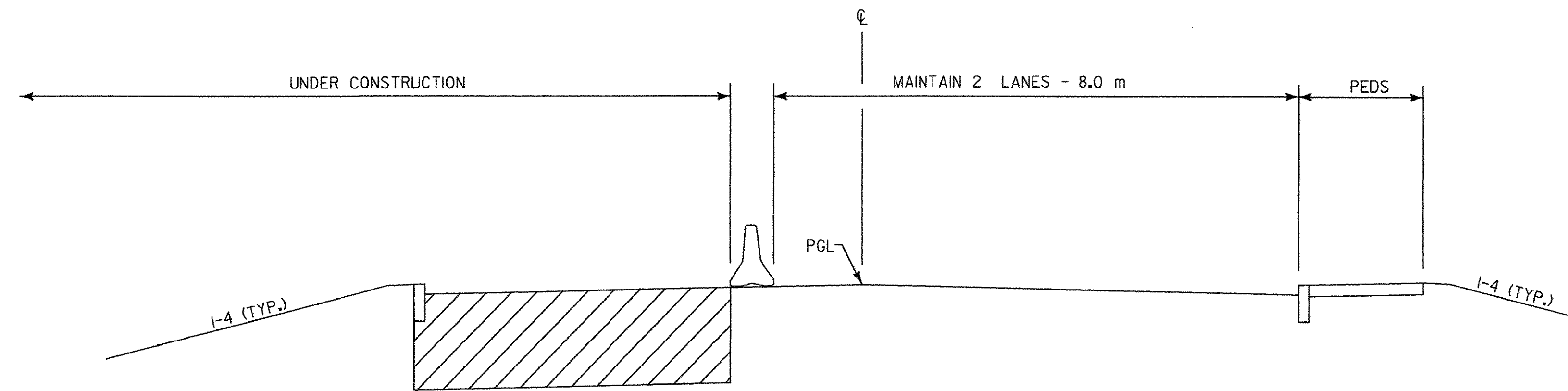

PHASE IC STA. VT 1+380 - STA. VT 1+570

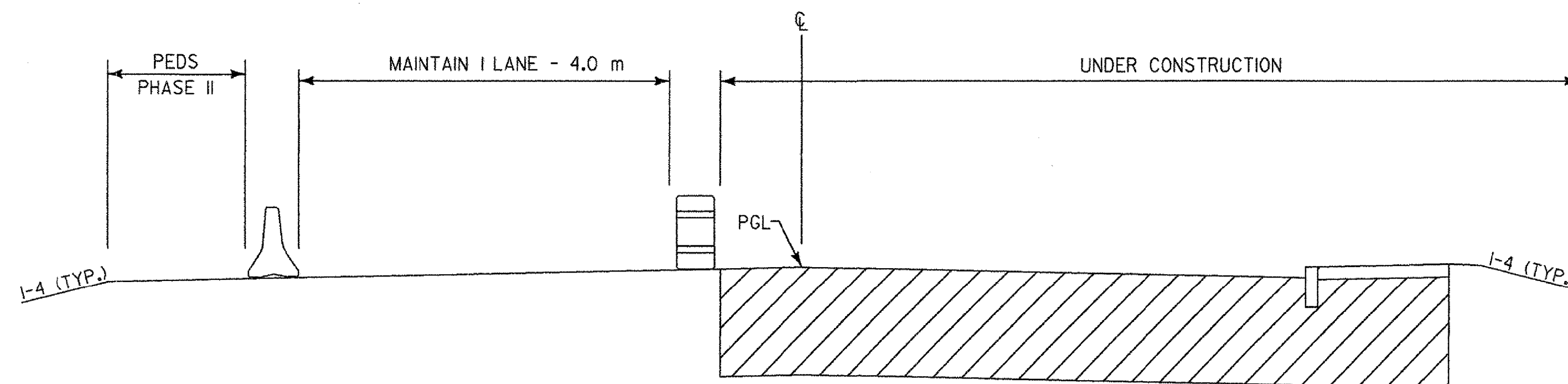

**PHASE IIA & IIIA
STA. VT 1+235 -1+380
STA. VT 1+570 - 1+725**

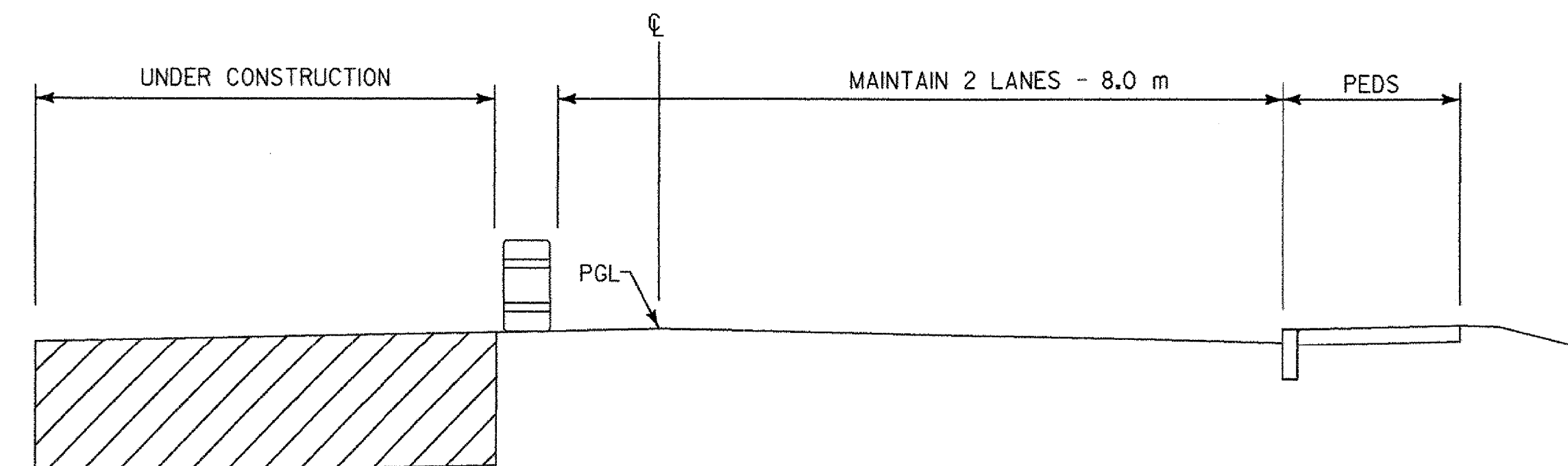

**PHASE IIB & IIIB
STA. VT 1+235 -1+380
STA. VT 1+570 - 1+725**

NOTES:

- ENERGY ABSORPTION ATTENUATORS TO BE INSTALLED AT EACH END OF TEMPORARY TRAFFIC BARRIER FOR EACH PHASE.
- FOR TEMPORARY TRAFFIC BARRIER DETAILS SEE THE 2002 AASHTO ROADSIDE DESIGN GUIDE., FIGURE 9.3 ("J"-HOOK STYLE)
- TEMPORARY TRAFFIC BARRIER TO BE PURCHASED NEW AND BECOME PROPERTY OF VTRANS DISTRICT NO.1, CONTACT NELSON BLANCHARD, 1-802-447-2790 TO COORAINATE DELIVERY AT THE END OF PROJECT.
- FOR PHASES IIA & IIIA ONE WAY ALTERNATING TRAFFIC WILL BE ACCEPTABLE DURING WORKING HOURS. TWO WAY TRAFFIC MUST BE MAINTAINED DURING NON WORKING HOURS.
- CONTRACTOR TO REMOVE TRAFFIC BARRELS AND ALLOW FOR TWO WAY TRAVEL DURING NON-WORK HOURS.

ALL DIMENSIONS IN MILLIMETERS (mm) EXCEPT WHERE NOTED

VERMONT AGENCY OF TRANSPORTATION



Stantec

PROJECT NAME: BENNINGTON
PROJECT NUMBER: AC NH 019-(K51)

FILE NAME: ...plot files\zd307c\lcol.ptf PLOT DATE: 2/2/2009
DESIGN SUPERVISOR: GREG EDWARDS DRAWN BY: STANTEC
DESIGNED BY: MARC FOISY CHECKED BY: GARY SANTY
TRAFFIC CONTROL TCC-01 SHEET 165 OF 367

PGL=PROFILE GRADE LINE

V:\N853\oct15e\N85310002\Transportation\dr\awing\contract\l\plot files\zd307c\lcol.ptf