

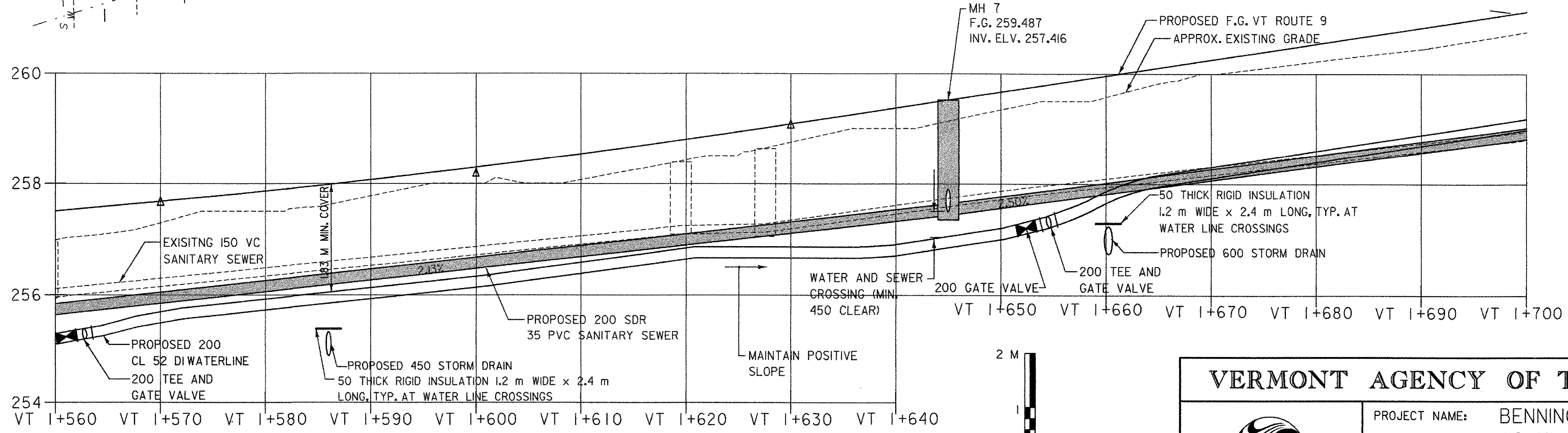

**NOTES:**

1. REMOVAL OF EXISTING WATER AND SEWER LINES SHALL BE PAID INCIDENTAL TO ITEMS "TRANSFER TO NEW SYSTEM, SANITARY SEWER SYSTEM" AND "TRANSFER TO NEW SYSTEM, WATER SYSTEM."
2. FOR PROPERTIES AT STA. 1+690 LT. & 1+670 RT. EXISTING WATER SERVICE LOCATIONS ARE UNKNOWN. CONTRACTOR SHALL PERFORM TEST PITS PER DIRECTION OF THE ENGINEER IN ORDER TO DETERMINE EXACT LOCATION AND DEPTH OF EXISTING WATER AND SEWER SERVICES. PAYMENT FOR TEST PITS SHALL BE CONSIDERED INCIDENTAL TO ITEM 628.42, TRANSFER TO NEW SYSTEM - SANITARY SEWER AND ITEM NO. 629.42, TRANSFER TO NEW SYSTEM - WATER SYSTEM.
3. FOR PROPERTY AT STA. 1+645 LT. EXISTING SEWER SERVICE IS UNKNOWN. CONTRACTOR SHALL PERFORM TEST PITS PER DIRECTION OF THE ENGINEER IN ORDER TO DETERMINE EXACT LOCATION AND DEPTH OF EXISTING WATER AND SEWER SERVICES. PAYMENT FOR TEST PITS SHALL BE CONSIDERED INCIDENTAL TO ITEM 628.42, TRANSFER TO NEW SYSTEM - SANITARY SEWER AND ITEM NO. 629.42, TRANSFER TO NEW SYSTEM - WATER SYSTEM.
4. CONNECT NEW WATER SERVICE LINE 2 M BEYOND BACK FACE OF RETAINING WALL
5. INSTALLATION OF WATER AND SEWER SERVICE LINES SHALL BE COORDINATED WITH CONSTRUCTION OF NEW PRECAST CONCRETE RETAINING WALL AND DRIVEWAY TO MAINTAIN ADEQUATE CLEARANCES AND BURIAL DEPTHS.

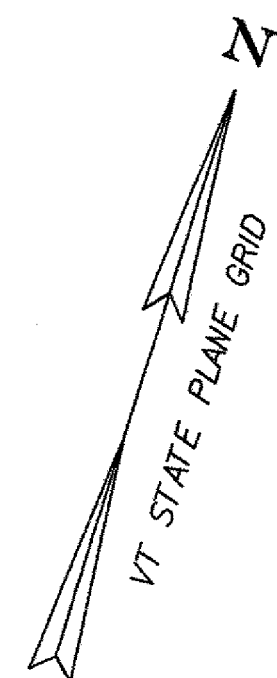
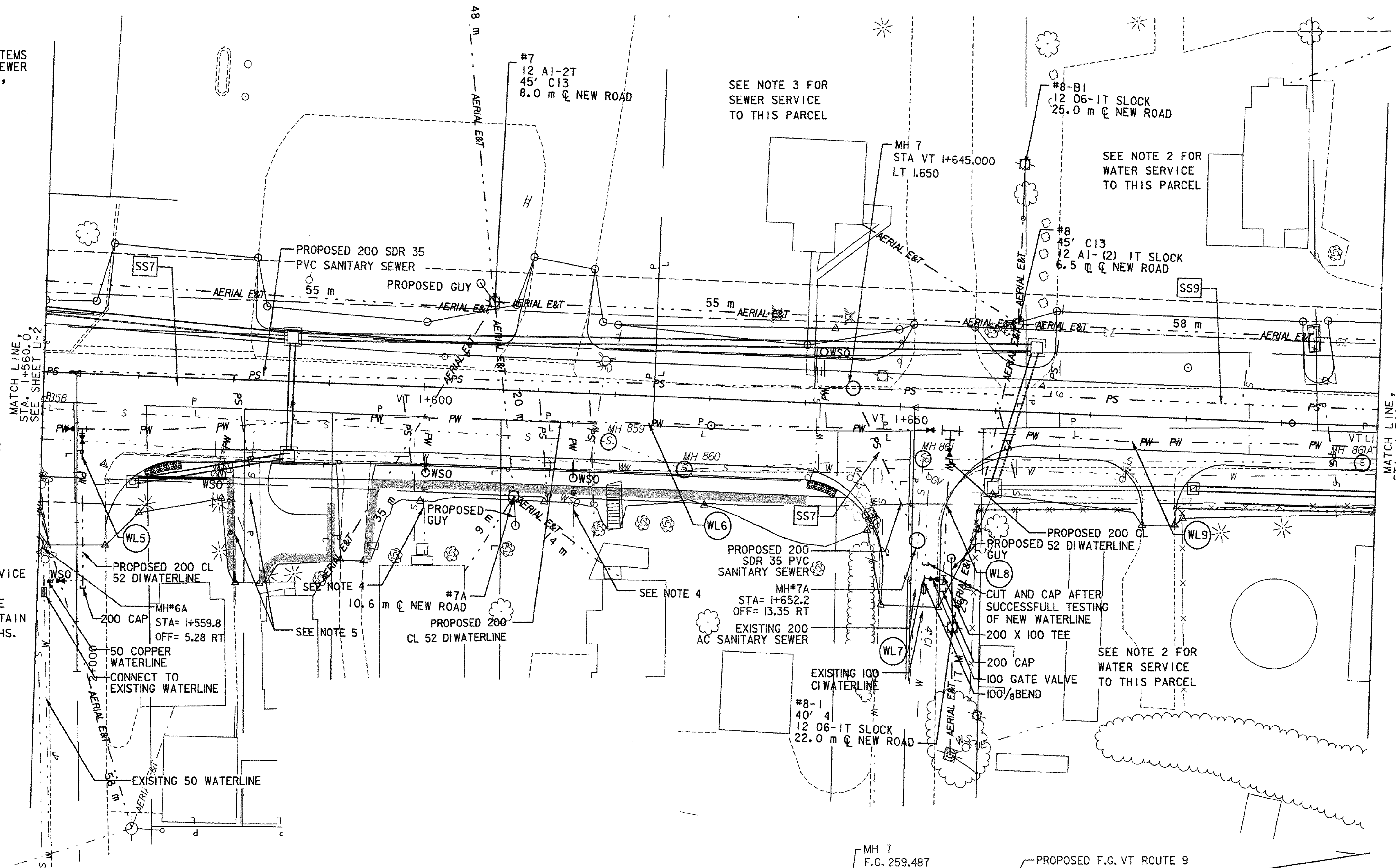
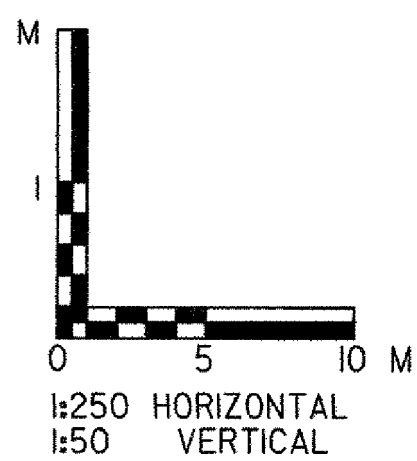

SEE AS-BUILTS



<b>VERMONT AGENCY OF TRANSPORTATION</b>	
	PROJECT NAME: BENNINGTON PROJECT NUMBER: AC NH 019-1(51)
FILE NAME: ...\\plot files\zd307clu3.ppt DESIGN SUPERVISOR: GREG EDWARDS DESIGNED BY: T. KNIGHT	PLOT DATE: 1/30/2009 DRAWN BY: STANTEC CHECKED BY: M. CHENETTE SHEET 159 OF 367
<b>UTILITY RELOCATION PLAN U-03</b>	

V:\1953\vt19530002\Transportation\drawing\contract\1\p101 - files\z307clu3.ppt