

SLEEVES FOR UTILITIES (200 MM)
 STA. VT 1+429.338, 9.1m LT. - STA. VT 1+437.802, 13.6m LT.
 STA. VT 1+439.454, 13.6m LT. - STA. VT 1+450.125, 11.9m LT.
 STA. VT 1+458.628, 7.2m LT. - STA. VT 1+458.628, 7.2m RT.

- NOTES.**
1. UNDERGROUND CONDUITS SHALL BE INSTALLED WITHIN 90 DAYS OF CONTRACT AWARD (SEE SPECIAL PROVISIONS) ONCE CONDUITS ARE INSTALLED, UTILITIES WILL NEED APPROXIMATELY 3 MONTHS TO COMPLETE THEIR WORK. ALL OTHER WORK IN THE IMMEDIATE VICINITY THAT COULD IMPACT THE UTILITY WORK SHALL STOP UNTIL THE UTILITIES HAVE RELOCATED UNDERGROUND.
 2. THE UTILITY COMPANIES SHALL BE NOTIFIED 2 WEEKS IN ADVANCE OF ANY EXCAVATION RELATED TO THE CONDUITS. THEIR INSPECTOR SHALL BE "ON-SITE" PRIOR TO COMMENCEMENT OF WORK.
 3. CONDUIT SHALL INCLUDE SWEEP AT POLES. CONDUIT MUST TERMINATE ABOVE GROUND. CONTRACTOR TO BLOW-IN PULL STRINGS IN EACH CONDUIT.
 4. REMOVAL OF EXISTING WATER AND SEWER LINES SHALL BE PAID INCIDENTAL TO ITEMS "TRANSFER TO NEW SYSTEM, SANITARY SEWER SYSTEM" AND "TRANSFER TO NEW SYSTEM, WATER SYSTEM."

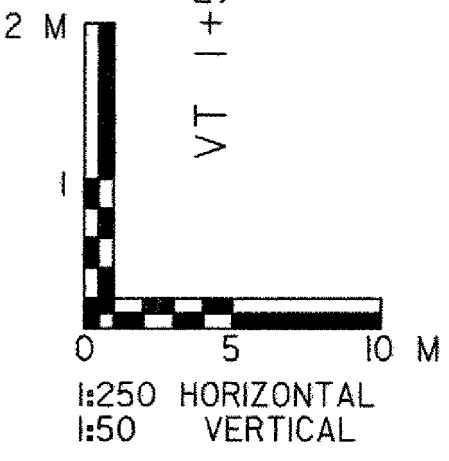
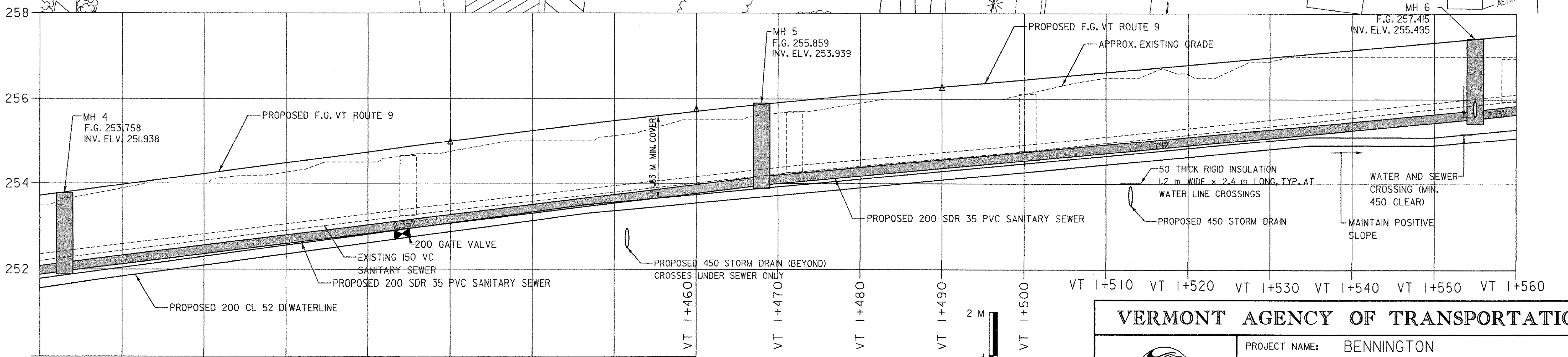

SEE AS-BUILTS

VERMONT AGENCY OF TRANSPORTATION



PROJECT NAME:	BENNINGTON	FILE NAME:	...plot files\zd307clu2.prf	PLOT DATE:	2/3/2009
PROJECT NUMBER:	AC NH 019-1(51)	DESIGN SUPERVISOR:	GREG EDWARDS	DRAWN BY:	STANTEC
		DESIGNED BY:	T. KNIGHT	CHECKED BY:	M. CHENETTE
		UTILITY RELOCATION PLAN U-02			SHEET 158 OF 367