

NEW DRAINAGE PIPES		
PIPE #	LOCATION	COMMENTS
650	VT I+572.0 - VT I+586.0 RT	450 X 16.0 m PIPE OPTION 4
649	VT I+586.0 LT - RT	450 X 11.1 m PIPE OPTION 4
654	VT I+586.0 - VT I+664.0 LT	600 X 76.8 m PIPE OPTION 4
655	VT I+660.0 LT - VT I+664.0 RT	600 X 13.5 m PIPE OPTION 4
656	VT I+660.0 - VT I+681.0 RT	450 X 20.1 m PIPE OPTION 2
656A	VT I+681.0 - VT I+722.0 RT	450 X 40.6 m PIPE OPTION 4

NEW DRAINAGE STRUCTURES		
STRUCTURE #	LOCATION	COMMENTS
CB648	VT I+586.0 LT	TYPE D GRATE
D1650	VT I+572.0 RT	TYPE D GRATE (CONNECT UNDERDRAIN FROM BLOCK WALL SEE BWD-01)
CB649	VT I+586.0 RT	TYPE D GRATE (CONNECT UNDERDRAIN FROM BLOCK WALL SEE BWD-01)
CB654	VT I+664.0 LT	TYPE D GRATE
CB655	VT I+660.0 RT	TYPE A GRATE
D1656	VT I+681.0 RT	TYPE A GRATE

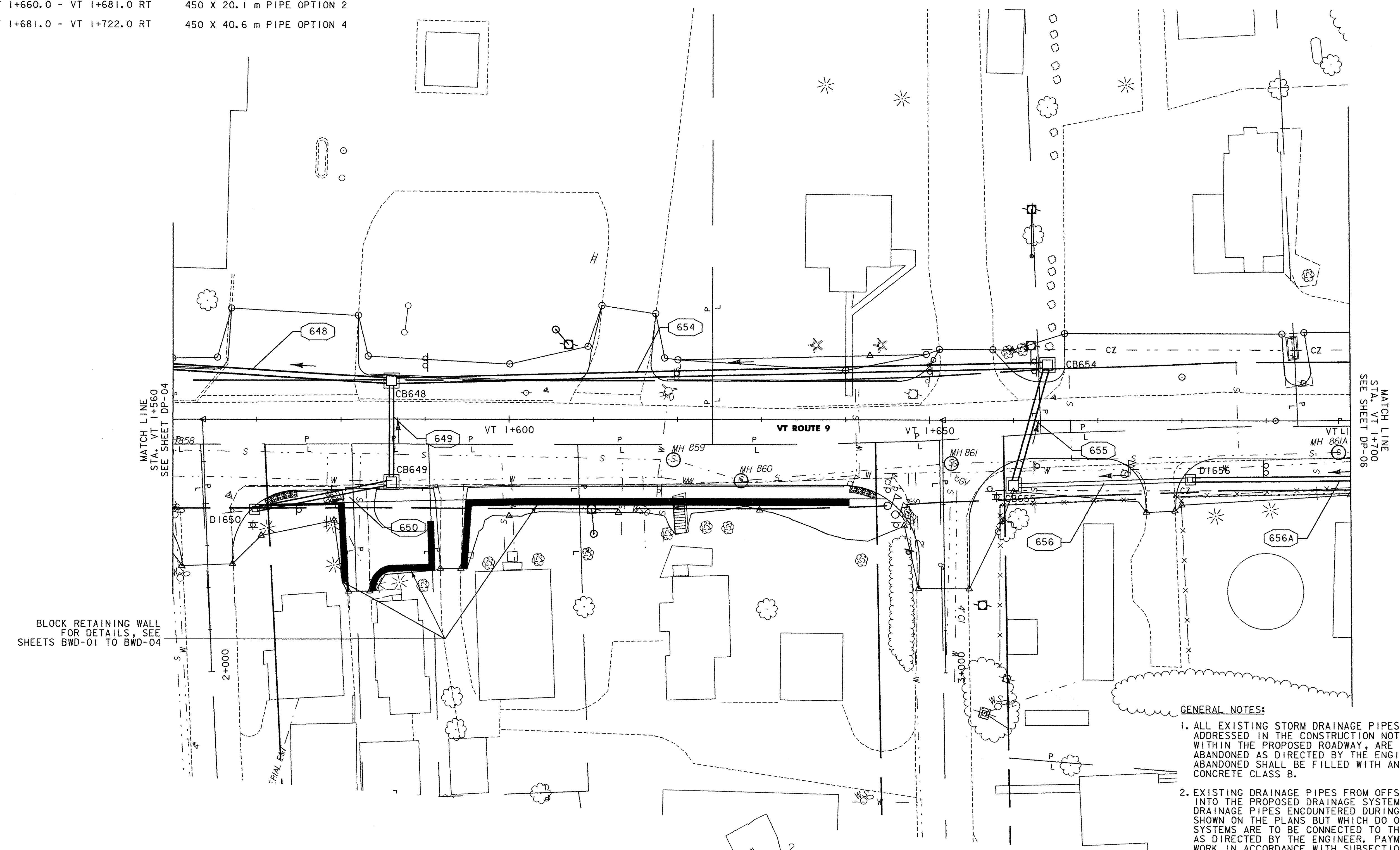

BLOCK RETAINING WALL FOR DETAILS, SEE SHEETS BWD-01 TO BWD-04

**GENERAL NOTES:**

- ALL EXISTING STORM DRAINAGE PIPES AND STRUCTURES NOT ADDRESSED IN THE CONSTRUCTION NOTES, FOUND TO BE COMPLETELY WITHIN THE PROPOSED ROADWAY, ARE TO BE REMOVED OR ABANDONED AS DIRECTED BY THE ENGINEER. ALL PIPES TO BE ABANDONED SHALL BE FILLED WITH AND PAID FOR AS CONCRETE CLASS B.
- EXISTING DRAINAGE PIPES FROM OFFSITE SYSTEMS ARE TO BE TIED INTO THE PROPOSED DRAINAGE SYSTEM AS SHOWN. ANY EXISTING DRAINAGE PIPES ENCOUNTERED DURING CONSTRUCTION WHICH ARE NOT SHOWN ON THE PLANS BUT WHICH DO ORIGINATE FROM OTHER OFFSITE SYSTEMS ARE TO BE CONNECTED TO THE PROPOSED DRAINAGE SYSTEM AS DIRECTED BY THE ENGINEER. PAYMENT WILL BE MADE AS EXTRA WORK IN ACCORDANCE WITH SUBSECTION 109.06 OF THE VTRANS SPECIFICATIONS.

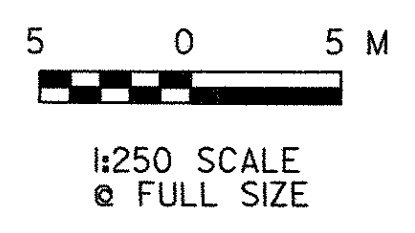
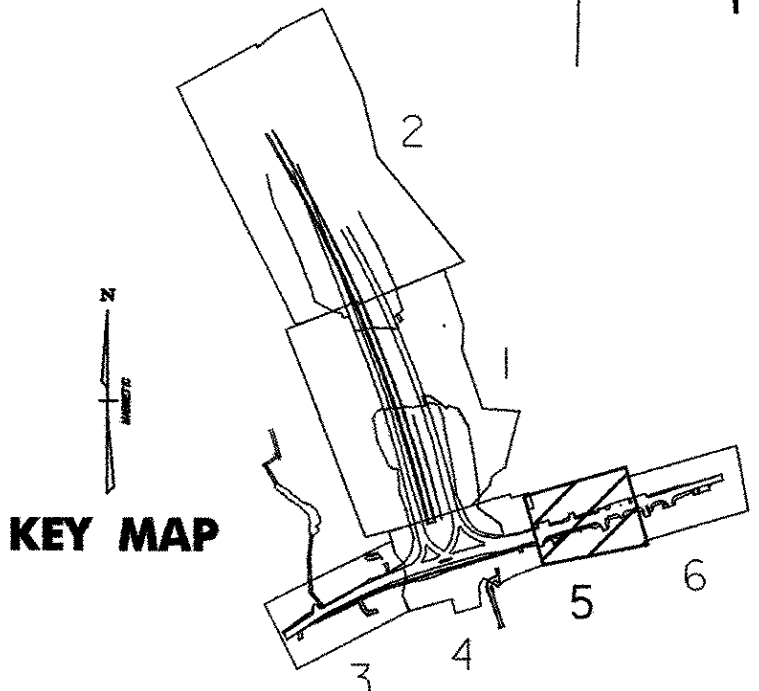

**VERMONT AGENCY OF TRANSPORTATION**



PROJECT NAME:	BENNINGTON
PROJECT NUMBER:	AC NH 019-1(51)
FILE NAME:	...z307cldrn_plans_250.pxf
DESIGN SUPERVISOR:	GREG EDWARDS
DESIGNED BY:	MARC FOISY
<b>DRAINAGE PLAN DP-05</b>	
PLOT DATE:	1/30/2009
DRAWN BY:	STANTEC
CHECKED BY:	GARY SANTY
SHEET	78 OF 367

V:\1953\active\19530002\transportation\drawing\constr\act\_n\plot\_files\z307cldrn\_plans\_250.pxf