

REMOVAL OF EXISTING FENCE
 STA. NB 7+077.1, 25.8m LT. - STA. NB 7+123.0, 65.7m LT. (PDF)
 STA. NB 7+130.4, 67.4m LT. - STA. NB 7+308.1, 75.6m LT. (PDF)

PROJECT DEMARCATION FENCE
 STA. NB 7+077.1, 7.86m LT. - STA. NB 7+090.9, 18.27m LT. (PDF)
 STA. NB 7+161.0, 22.43m LT. - STA. NB 7+199.0, 23.79m LT. (PDF)
 STA. NB 7+264.1, 24.03m LT. - STA. NB 7+308.1, 23.06m LT. (PDF)

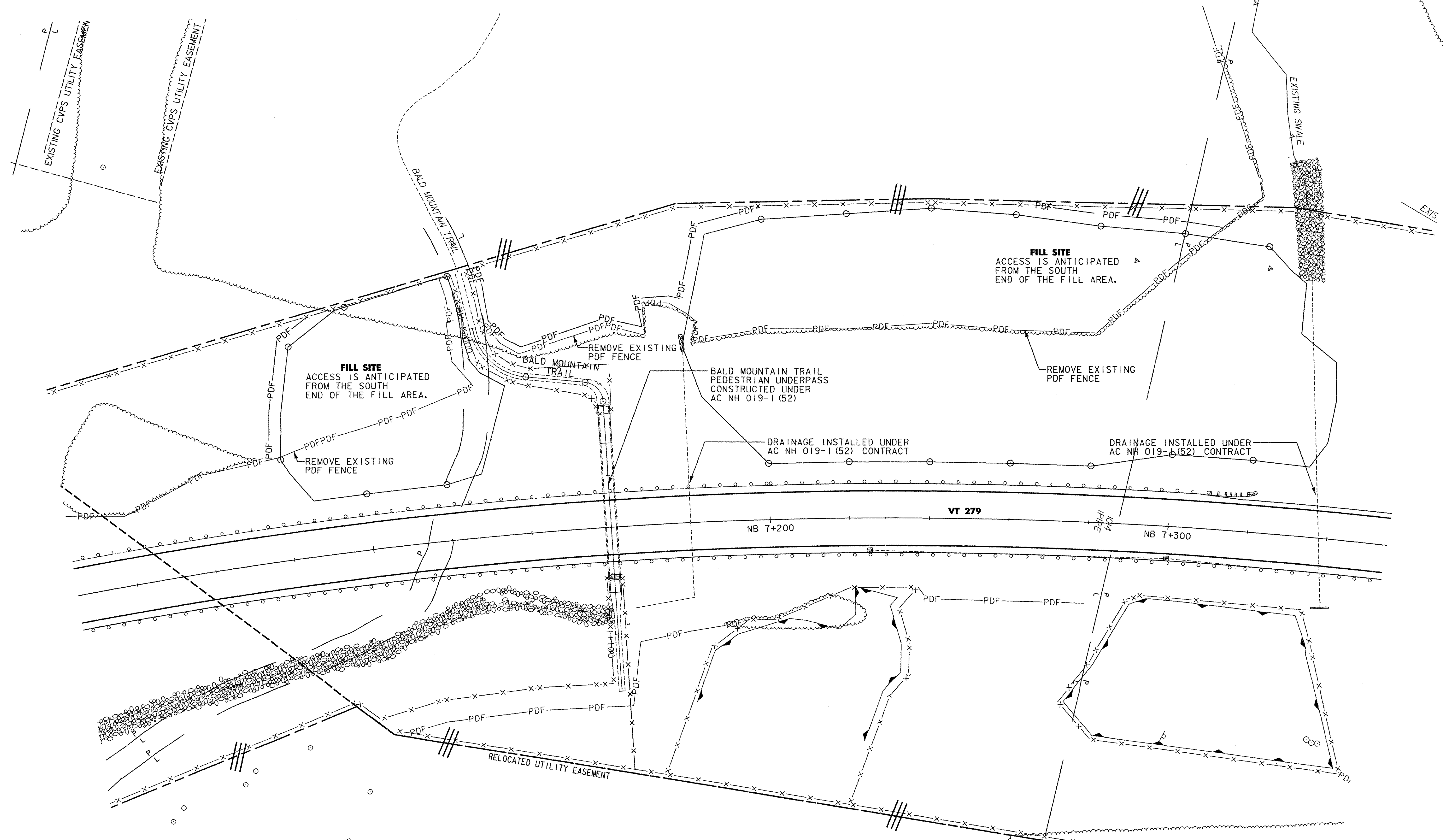

v:\1953\active\1953\002\transportation\drawing\contract\1\plot_files\z307c\gen_plans_500.prf

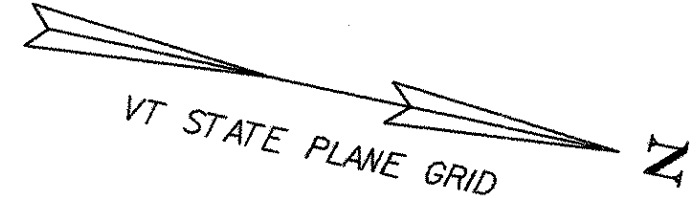
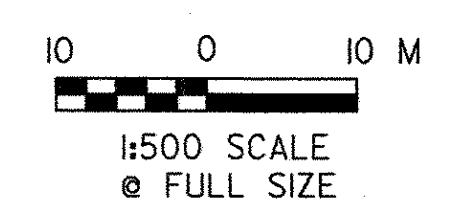

VERMONT AGENCY OF TRANSPORTATION



PROJECT NAME:	BENNINGTON
PROJECT NUMBER:	AC NH 019-1(51)
FILE NAME:	...z307c\gen_plans_500.prf
DESIGN SUPERVISOR:	GREG EDWARDS
DESIGNED BY:	MARC FOISY
GENERAL PLAN	P-08
PLOT DATE:	2/3/2009
DRAWN BY:	STANTEC
CHECKED BY:	GARY SANTY
SHEET	73 OF 367