

**INDEX OF SHEETS**

SEE SHEET 2

**INDEX OF STANDARDS**

SEE SHEET 2

STATE OF VERMONT  
AGENCY OF TRANSPORTATION

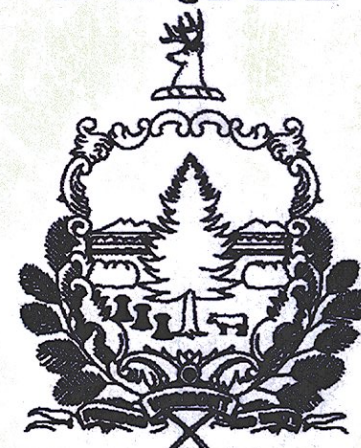

PROPOSED IMPROVEMENT  
TOWN OF BENNINGTON  
COUNTY OF BENNINGTON  
WWII VETERANS MEMORIAL HIGHWAY  
VT ROUTE 279, PRINCIPAL ARTERIAL  
BENNINGTON AC NH 019-1(51)

RECORD PLANS	
CONTRACTOR:	KUBRICKY CONSTRUCTION CORP. - GLENS FALLS, NY
RESIDENT ENGINEER:	RON LEMAIRE
CONSTRUCTION BEGAN:	JUNE 22, 2009
CONSTRUCTION COMPLETE:	DECEMBER 11, 2012
RECORD PLANS BY:	RON LEMAIRE & C. PIERCE
I HEREBY CERTIFY THAT ALL THE CONSTRUCTION REQUIRED BY THIS SET OF DRAWINGS HAS BEEN ACCOMPLISHED AS INDICATED HEREIN.	
BY	RESIDENT ENGINEER
DATE	04/10/13 <b>Ronald Lemaire</b>
NOTE: Any further information concerning final quantities, amounts or other details relative to this project may be found at Central Files in the electronic archives.	

BEGINNING AT STA. NB 6+013.726, AT VT ROUTE 9, AND EXTENDING NORTHERLY TO STA. NB 6+540.000 AT A POINT APPROXIMATELY 223 METERS NORTH OF THE ROARING BRANCH AND VT ROUTE 9 BEGINNING AT STA. VT 1+200.000 AND ENDING AT STA. VT 1+820.000. WORK TO BE PERFORMED INCLUDES GRADING, DRAINAGE, SUBBASE, PAVEMENT, LANDSCAPING AND THE CONSTRUCTION OF TWO BRIDGES OVER THE ROARING BRANCH. ADDITIONAL WORK OCCURS FROM STA. NB 6+540.000 AND EXTENDS NORTHERLY AND WESTERLY, ENDING AT STA. NB 9+672.770, TO A POINT APPROXIMATELY 400 METERS WEST OF EAST ROAD. WORK UNDER THIS PORTION OF THE PROJECT INCLUDES A PAVEMENT OVERLAY, PAVEMENT MARKINGS, SIGNING, REPAIRS TO ROUTE 7 DRAINAGE SWALE AND OTHER RELATED ITEMS.

LENGTH OF PROJECT = 4,090.509 METERS = 4.091 KILOMETERS  
LENGTH OF BRIDGE(S) = 146.813 METERS = 0.146 KILOMETERS

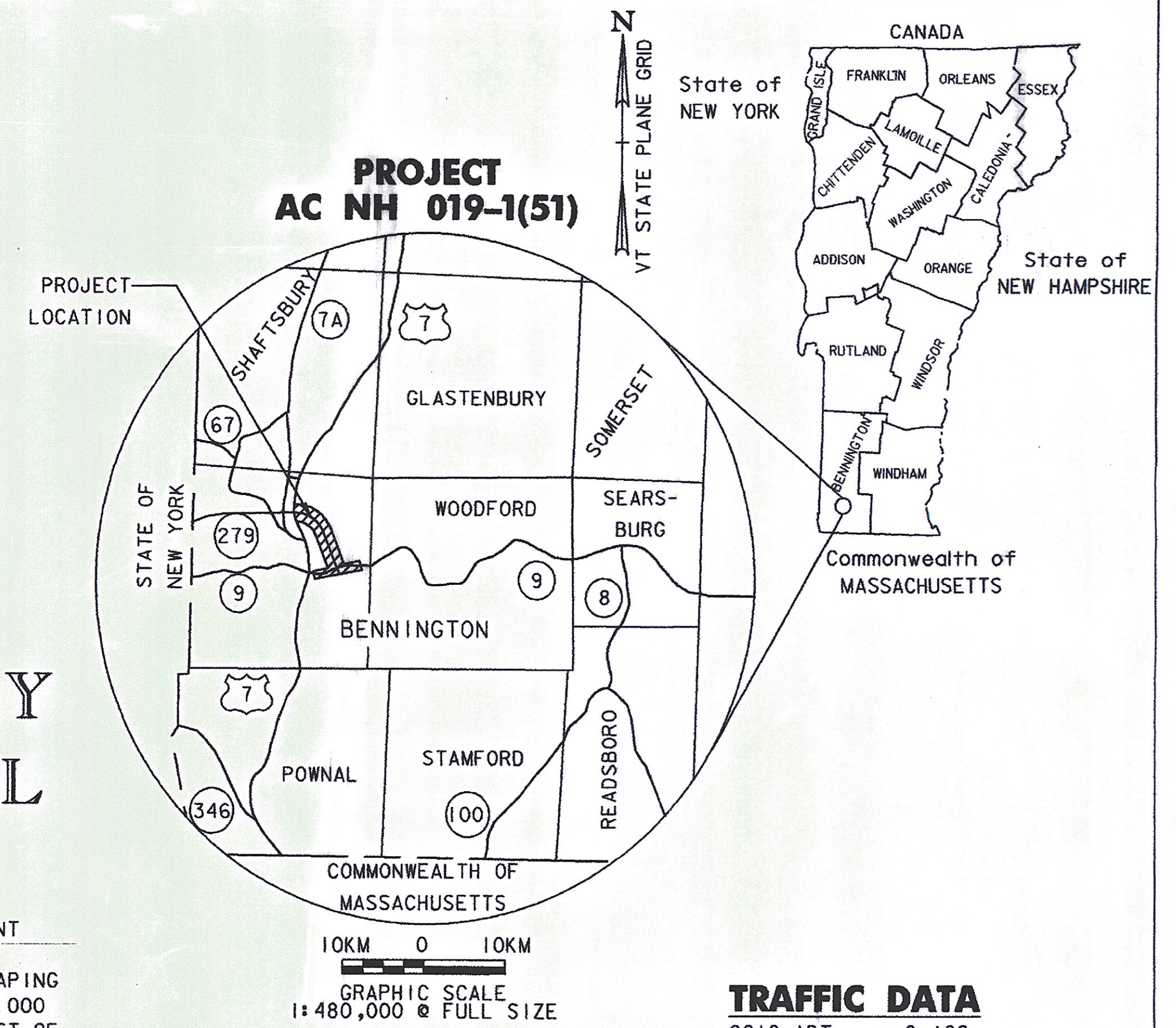

**TRAFFIC DATA**

2010 ADT	= 9,100
2030 ADT	= 11,800
2010 DHV	= 1,365
2030 DHV	= 1,770
% TRUCKS	= 6.12
DESIGN SPEED	= 100 km/h

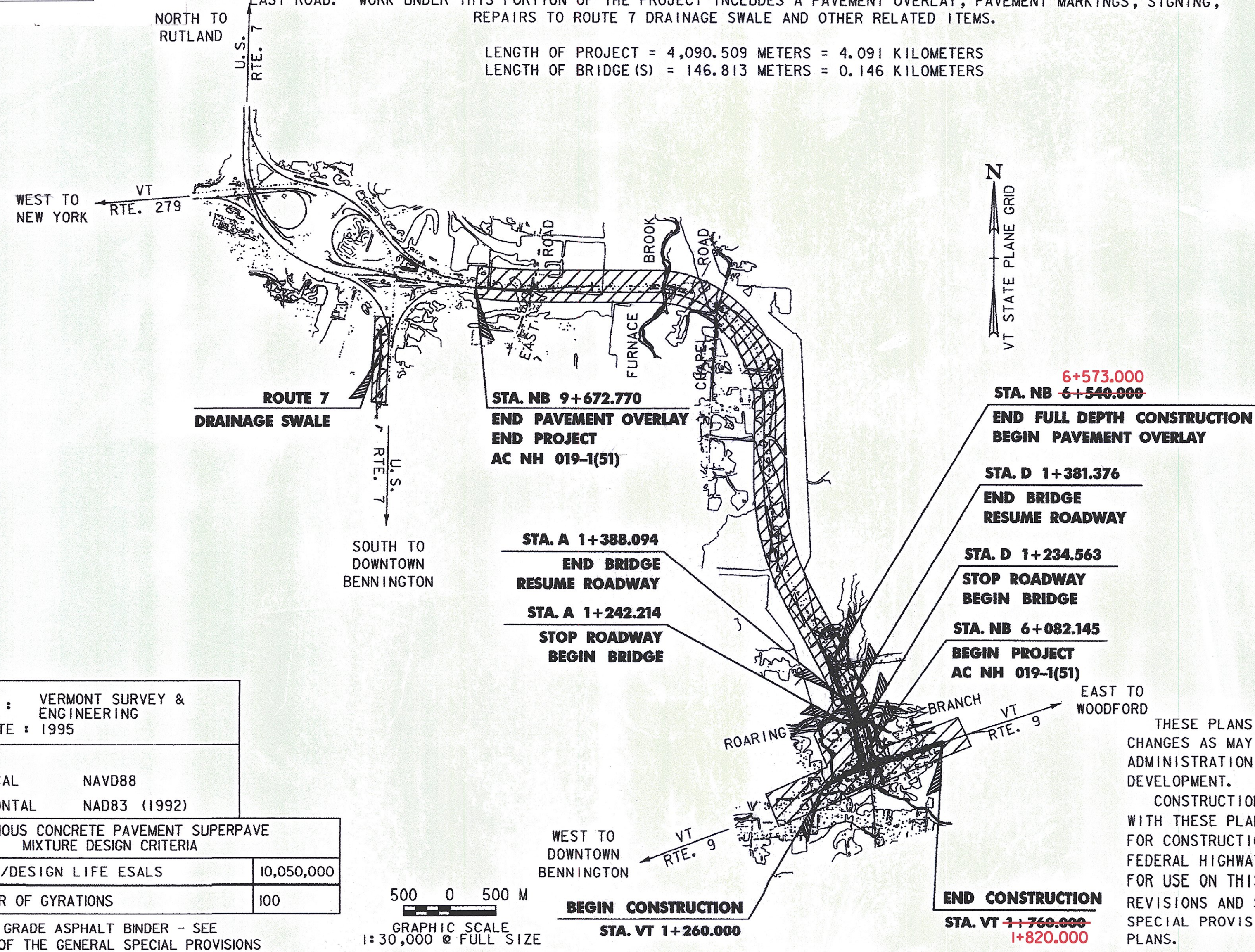

STATE OF VERMONT  
GARY A. SMITH  
NO. 7563  
LICENSED PROFESSIONAL ENGINEER  
  
03/04/2009

**Metric**  
UNLESS NOTED OTHERWISE  
STATIONS ARE IN KILOMETERS  
ELEVATIONS ARE IN METERS  
DIMENSIONS ARE IN MILLIMETERS

DEPARTMENT OF TRANSPORTATION  
FEDERAL HIGHWAY ADMINISTRATION  
APPROVED DATE 4-13-09  
DIVISION ADMINISTRATOR  
DIRECTOR OF PROGRAM DEVELOPMENT  
APPROVED DATE 3-5-09  
PROJECT MANAGER : JAMES HARRIS  
PROJECT NAME : BENNINGTON  
PROJECT NUMBER : AC NH 019-1(51)  
SHEET 1 OF 367 SHEETS

**CONVENTIONAL SYMBOLS**

COUNTY LINE	
TOWN LINE	
LIMITS OF ACCESS	
POINT OF ACCESS	
FENCE LINE	
STONE WALL	
TRAVELED WAY	
GUARDRAIL	
RAILROAD	
SURVEY LINE	
CULVERT	
POWER POLE	
TELEPHONE POLE	
TREES	
CONTROL OF ACCESS	
PROPERTY LINE	
R.O.W. TAKING LINE	
SLOPE RIGHTS	
TOP OF CUT	
TOE OF SLOPE	
ARCHAEOLOGICAL	
CLEAR ZONE	
WETLAND DELINEATION	

SURVEYED BY :	VERMONT SURVEY & ENGINEERING
SURVEYED DATE :	1995
DATUM	
VERTICAL	NAVD88
HORIZONTAL	NAD83 (1992)
BITUMINOUS CONCRETE PAVEMENT SUPERPAVE MIXTURE DESIGN CRITERIA	
DESIGN LANE/DESIGN LIFE ESALS	10,050,000
DESIGN NUMBER OF GYRATIONS	100
PERFORMANCE GRADE ASPHALT BINDER - SEE SECTION 490 OF THE GENERAL SPECIAL PROVISIONS	

500 0 500 M  
GRAPHIC SCALE  
1:30,000 @ FULL SIZE

THESE PLANS ARE SUBJECT TO SUCH ENGINEERING CHANGES AS MAY BE REQUIRED BY THE FEDERAL HIGHWAY ADMINISTRATION OR THE DIRECTOR OF PROGRAM DEVELOPMENT.  
CONSTRUCTION IS TO BE CARRIED ON IN ACCORDANCE WITH THESE PLANS AND THE STANDARD SPECIFICATIONS FOR CONSTRUCTION DATED 2006, AS APPROVED BY THE FEDERAL HIGHWAY ADMINISTRATION ON JUNE 15, 2006 FOR USE ON THIS PROJECT, INCLUDING ALL SUBSEQUENT REVISIONS AND SUCH REVISED SPECIFICATIONS AND SPECIAL PROVISIONS AS ARE INCORPORATED IN THESE PLANS.