

**CONSTRUCTION APPROACH SIGNING**

NOT TO SCALE  
SEE STD E-100, E-100A AND E-103 FOR SIGN PLACEMENT

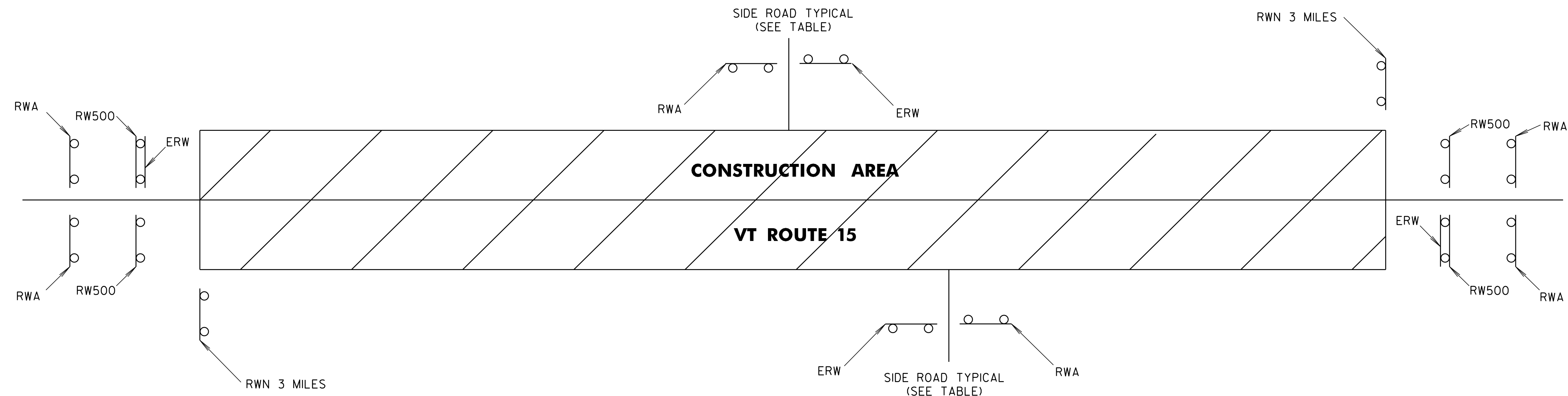

**NOTES:**

1. THE CONTRACTOR SHALL SUBMIT A TRAFFIC CONTROL PLAN FOR APPROVAL PRIOR TO THE START OF CONSTRUCTION. THE COST OF PREPARING THIS PLAN (AND MAKING CHANGES IF NECESSARY) SHALL NOT BE PAID SEPARATELY BUT SHALL BE INCIDENTAL TO ITEM 64I.10, "TRAFFIC CONTROL".
2. THE CONTRACTOR SHALL INCLUDE A CONSTRUCTION SIGN APPROACH PACKAGE FOR EXPECTED LANE CLOSURES AND WORK ZONE SPEED REDUCTIONS IN COMPLIANCE WITH THE TRAFFIC CONTROL DETAILS AND NOTES SHEET (SHEET 45 OF THIS SET), VTRANS STANDARD E-103, AND PART 6 OF THE MUTCD. PAYMENT FOR PROVIDING THIS PACKAGE SHALL BE INCIDENTAL TO ITEM 64I.10, "TRAFFIC CONTROL".
3. THE BID PRICE FOR "TRAFFIC CONTROL", ITEM 64I.10, SHALL INCLUDE ALL OF THE FOLLOWING, AS NEEDED: APPROACH AND ON-PROJECT CONSTRUCTION SIGNING, PORTABLE ARROW BOARDS, BARRIERS, BARRELS, CONES, BARRICADES, TEMPORARY REGULATORY AND WARNING SIGNS, AND POSTS AS DETAILED IN VTRANS STANDARDS. ALL ADJUSTING, RELOCATING, AND REMOVING OF THESE DEVICES AS DIRECTED BY THE RESIDENT ENGINEER SHALL ALSO BE INCLUDED. THE FOLLOWING ITEMS WILL BE PAID FOR SEPARATELY:  
646.602, 646.612, 646.642, 646.652, 646.682, 646.692, AND 646.702 - TEMPORARY PAVEMENT MARKINGS  
630.10 AND 630.15 - UNIFORMED TRAFFIC OFFICERS AND FLAGGERS
4. THREE (3) PORTABLE CHANGEABLE MESSAGE SIGNS (PCMS) WILL BE PROVIDED FOR USE ON THIS PROJECT. THE PLACEMENT OF THESE UNITS AS WELL AS THE MESSAGE WILL BE APPROVED BY THE RESIDENT ENGINEER. THESE SIGNS WILL BE PAID FOR UNDER ITEM 64I.15, "PORTABLE CHANGEABLE MESSAGE SIGN".  
  
PCMS SHOULD NOT REPLACE ANY OF THE SIGNING DETAILED IN THE MUTCD AND SHOULD NOT BE USED IF STANDARD TRAFFIC CONTROL DEVICES ADEQUATELY PROVIDE THE INFORMATION THE MOTORISTS NEED TO TRAVEL SAFELY.  
  
THE PCMS SHALL CONSIST OF EITHER ONE OR TWO PHASES. TYPICALLY, A PHASE SHALL CONSIST OF UP TO THREE LINES OF EIGHT CHARACTERS PER LINE. THE PCMS SHOULD BE USED AS A SUPPLEMENT AND NOT AS A SUBSTITUTE FOR CONVENTIONAL SIGNS AND PAVEMENT MARKINGS.  
  
THE PCMS SHOULD COMMUNICATE WHAT INFORMATION MOTORISTS NEED TO KNOW. UNNECESSARY INFORMATION SHOULD BE AVOIDED. MESSAGES SHOULD BE UPDATED PERIODICALLY TO DESCRIBE THE WORK ACTIVITY OCCURRING SO THAT THE PCMS CONTINUES TO COMMAND THE ATTENTION OF MOTORISTS.
5. THE MUTCD 2003 SHALL BE THE STANDARD FOR ALL TRAFFIC CONTROL DEVICES. EXISTING SIGNS, SIGNALS AND MARKINGS SHALL BE VALID UNTIL SUCH TIME AS THEY ARE REPLACED OR RECONSTRUCTED. WHEN NEW TRAFFIC CONTROL DEVICES ARE ERECTED OR PLACED OR EXISTING TRAFFIC CONTROL DEVICES ARE REPLACED OR REPAIRED THE EQUIPMENT, DESIGN, METHOD OF INSTALLATION, PLACEMENT OR REPAIR SHALL CONFORM WITH SUCH STANDARDS.
6. NO CONSTRUCTION SIGNS SHALL BE INSTALLED AS TO INTERFERE OR OBSTRUCT THE VIEW OF EXISTING TRAFFIC CONTROL DEVICES, STOPPING SIGHT DISTANCE, AND CORNER SIGHT DISTANCE FROM DRIVES AND TOWN HIGHWAYS.
7. SEE THE TRAFFIC CONTROL DETAILS AND NOTES SHEET FOR ADDITIONAL INFORMATION REGARDING IMPLEMENTATION OF THE TEMPORARY TRAFFIC CONTROL DEVICES.

SIDE ROAD NAME	ROAD WORK AHEAD	END ROAD WORK	ROAD WORK 500 FT	ROAD WORK NEXT 3 MILES
<b>COLCHESTER</b>				
BEGIN PROJECT (VT 15)	2	1	2	1
ST. MICHAELS WEST	1	1		
TH #4 (LIME KILN ROAD)	1	1		
ST. MICHAELS ACCESS	1	1		
ST. MICHAELS EAST	1	1		
TH #39 (JOHNSON AVE.)	2	1		
ENTRANCE TO FANNY ALLEN HOSPITAL	1	1		
ENTRANCE TO CAMP JOHNSON	1	1		
BARNES AVE.	2	2		
WOODSIDE DRIVE	1	1		
<b>ESSEX</b>				
TH #3 (ETHAN ALLEN DRIVE)	2	1		
TH #4 (SUSIE WILSON ROAD)	1	2		
TH #5 (WEST STREET EXT.)	1	1		
WARNER AVE.	1	1		
WILLEYS COURT	1	1		
END PROJECT (VT 15)	2	1	2	1
TOTALS	21	18	4	2

**LEGEND**

RWA = ROAD WORK AHEAD  
RW500 = ROAD WORK 500 FT  
ERW = END ROAD WORK  
RWN = ROAD WORK NEXT 3 MILES

<b>CONSTRUCTION APPROACH SIGNING SHEET</b>	PROJECT NAME: COLCHESTER-ESSEX
	PROJECT NUMBER: STP 2616(I)
	FILE NAME: p06b062.dgn
	PLOT DATE: 30-OCT-2012 12:00
PROJECT LEADER: CDL	DRAWN BY: SJL
DESIGNED BY: SJL	CHECKED BY: EPD
PLOT FILE: p06b062cas.i	SHEET 44 OF 45