

203.16 SOLID ROCK EXCAVATION

STA. 38+70 - STA. 38+80 LT
 STA. 39+06 - STA. 39+16 RT
 STA. 39+36 - STA. 39+51 LT

604.42 CHANGING ELEVATION OF SEWER MANHOLES

STA. 34+83 LT

618.10 PORTLAND CEMENT CONCRETE SIDEWALK, 5 INCH

STA. 38+70 - STA. 38+80 LT
 STA. 39+06 - STA. 39+16 RT
 STA. 39+36 - STA. 39+51 LT

618.30 DETECTABLE WARNING SURFACE

STA. 38+74 LT
 STA. 39+11 RT
 STA. 39+42 LT

629.20 ADJUST ELEVATION OF VALVE BOX

STA. 38+71 RT

646.492 DURABLE LETTER OR SYMBOL, THERMOPLASTIC

STA. 36+70 LT YIELD ARROWS STA. 38+62 RT ARROW
 STA. 37+82 RT ARROW STA. 38+96 LT "STOP"
 STA. 38+22 RT "ONLY"

646.692 TEMPORARY LETTER OR SYMBOL, PAINT

STA. 36+70 LT YIELD ARROWS STA. 38+62 RT ARROW
 STA. 37+82 RT ARROW STA. 38+96 LT "STOP"
 STA. 38+22 RT "ONLY"

646.502 DURABLE CROSSWALK MARKING, THERMOPLASTIC

STA. 38+77 - STA. 39+10 LT & RT
 STA. 38+79 - STA. 39+34 LT

646.702 TEMPORARY CROSSWALK MARKING, PAINT

STA. 38+77 - STA. 39+10 LT & RT
 STA. 38+79 - STA. 39+34 LT

STA. 36+64 LT

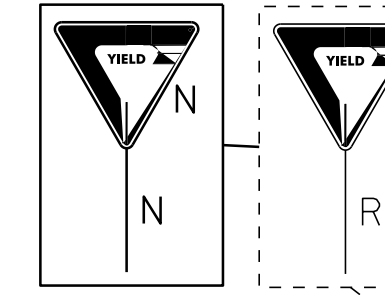

LIMITS OF COLD PLANING AND PAVING

TH# 39
 MM 0.687
 STA. 36+25

JOHNSON AVE.

REMOVE AND RECONSTRUCT SIDEWALK RAMP TYPE I, EXAMPLE 2 FROM STANDARD DRAWING C-3A

MM 0.740
 STA. 39+07

LIMITS OF COLD PLANING AND PAVING

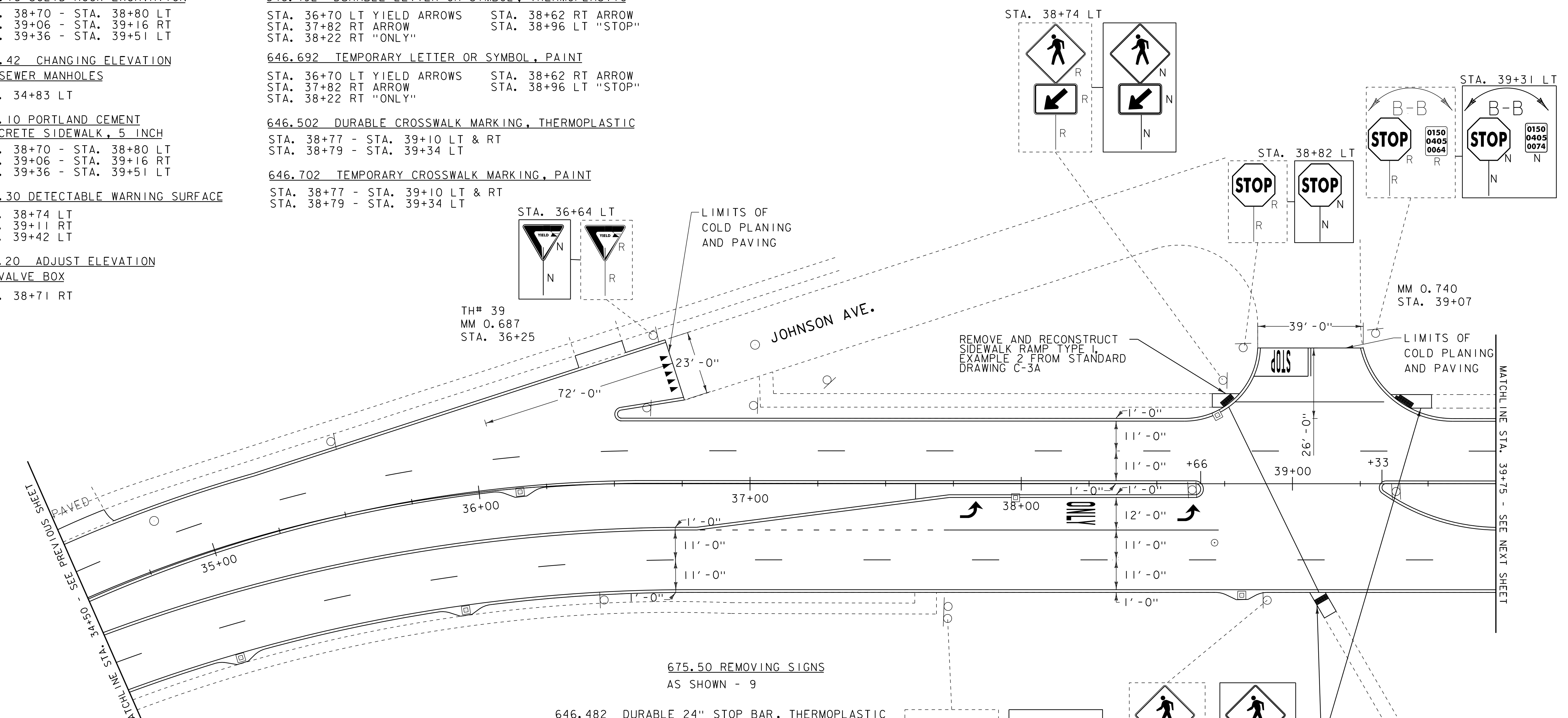

616.21 VERTICAL GRANITE CURB
 STA. 34+50 - STA. 34+70 LT

646.402 DURABLE 4" WHITE LINE, THERMOPLASTIC

STA. 34+50 - STA. 36+61 (SOLID LT)
 STA. 34+50 - STA. 39+75 (SOLID RT)
 STA. 34+50 - STA. 39+75 (DASHED LT & RT)
 STA. 36+50 - STA. 36+76 (SOLID LT)
 STA. 36+50 - STA. 39+75 (SOLID LT)
 WITH EDGELINE BREAK AT JOHNSON AVE.)
 STA. 36+80 - STA. 37+73 (DOTTED RT)
 STA. 37+73 - STA. 38+73 (SOLID RT)

646.602 TEMPORARY 4" WHITE LINE, PAINT

STA. 34+50 - STA. 36+61 (SOLID LT)
 STA. 34+50 - STA. 39+75 (SOLID RT)
 STA. 34+50 - STA. 39+75 (DASHED LT & RT)
 STA. 36+50 - STA. 36+76 (SOLID LT)
 STA. 36+50 - STA. 39+75 (SOLID LT)
 WITH EDGELINE BREAK AT JOHNSON AVE.)
 STA. 36+80 - STA. 37+73 (DOTTED RT)
 STA. 37+73 - STA. 38+73 (SOLID RT)

604.412, 604.415, 604.418 REHAB. DROP INLETS, CATCH BASINS, OR MANHOLES, CLASS I, CLASS II OR CLASS III

STA. 34+97 RT "TYPE D GRATE"
 STA. 35+89 RT "TYPE D GRATE"
 STA. 36+15 RT "TYPE D GRATE"
 STA. 37+98 RT "TYPE D GRATE"
 STA. 38+72 LT "TYPE D GRATE"
 STA. 38+81 RT "TYPE D GRATE"

646.482 DURABLE 24" STOP BAR, THERMOPLASTIC

STA. 38+86 - STA. 39+06 LT

646.682 TEMPORARY 24" STOP BAR, PAINT

STA. 38+86 - STA. 39+06 LT

646.81 PAINTED CURB

STA. 36+50 - STA. 37+10 RT
 STA. 37+43 - STA. 38+03 RT
 STA. 38+36 - STA. 38+66 RT
 (BOTH EDGES OF MEDIAN)
 STA. 39+33 - STA. 39+63 RT
 (BOTH EDGES OF MEDIAN)

646.82 PAINTED ISLAND

STA. 38+37 - STA. 38+67 RT

646.412 DURABLE 4" YELLOW LINE, THERMOPLASTIC

STA. 34+50 - STA. 38+67 (SOLID LT & RT BOTH EDGES OF MEDIAN)
 STA. 39+06 LT (CENTERLINE JOHNSON AVE.)
 STA. 39+32 - STA. 39+75 (SOLID RT BOTH EDGES OF MEDIAN)

646.612 TEMPORARY 4" YELLOW LINE, PAINT

STA. 34+50 - STA. 38+67 (SOLID LT & RT BOTH EDGES OF MEDIAN)
 STA. 39+06 LT (CENTERLINE JOHNSON AVE.)
 STA. 39+32 - STA. 39+75 (SOLID RT BOTH EDGES OF MEDIAN)

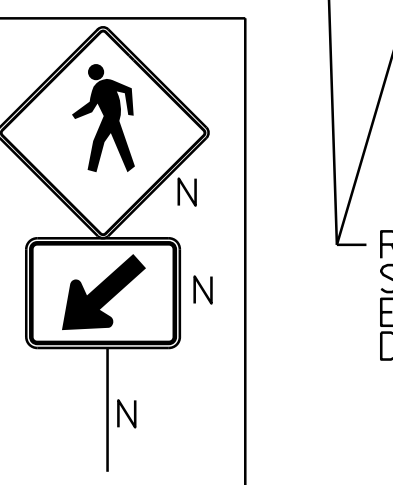
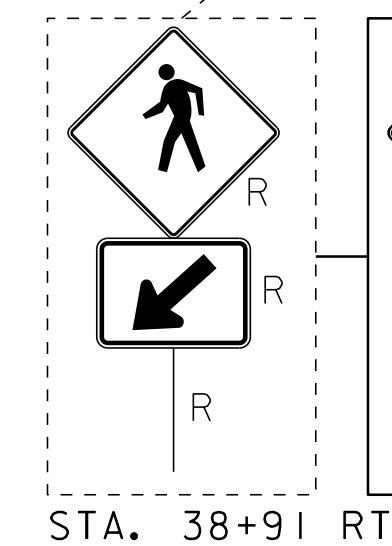
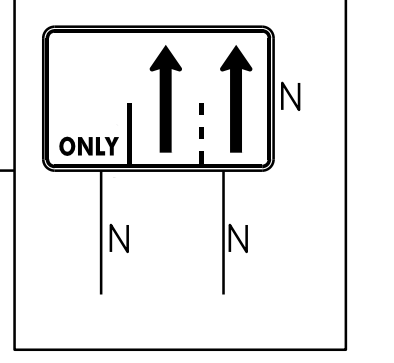
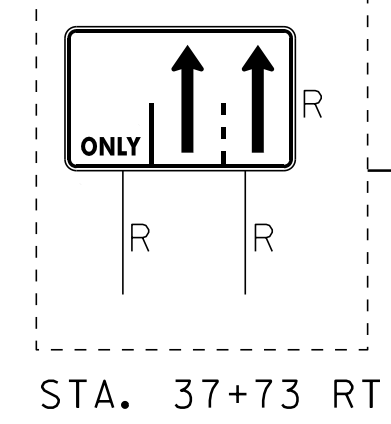

- LEGEND**
- HYDRANT
 - MANHOLE
 - WATER VALVE
 - GAS PIPELINE MARKER
 - CATCH BASIN / DROP INLET
 - CURB INLET
 - TRAFFIC CONTROL BOX
 - ⊕ RAILROAD CROSSING SIGNAL

- SIGN LEGEND**
- R = REMOVE
 - R&S = REMOVE AND SALVAGE
 - RET = RETAIN
 - S = SALVAGE
 - N = NEW
 - B-B = BACK TO BACK

DATUM	
VERTICAL	N/A
HORIZONTAL	N/A

PROJECT LAYOUT SHEET 7

PROJECT NAME:	COLCHESTER-ESSEX	PLOT DATE:	30-OCT-2012 12:00
PROJECT NUMBER:	STP 2616(I)S	DRAWN BY:	SJL
FILE NAME:	p06b062.dgn	DESIGNED BY:	CDL
PROJECT LEADER:	EPD	CHECKED BY:	EPD
PLOT FILE:	p06b062pl07.i	SHEET	15 OF \$SH\$

NOT TO SCALE