

**203.16 SOLID ROCK EXCAVATION**

STA. 0+00 - STA. 0+12 LT

**604.412, 604.415, 604.418 REHAB, DROP INLETS, CATCH BASINS, OR MANHOLES, CLASS I, CLASS II OR CLASS III**

STA. 0+29 RT "TYPE D GRATE"  
 STA. 1+78 LT "TYPE D GRATE"  
 STA. 1+80 RT "TYPE D GRATE"  
 STA. 3+30 RT "TYPE D GRATE"  
 STA. 3+40 LT "TYPE D GRATE"  
 STA. 4+61 RT & LT "TYPE D GRATE"

**604.42 CHANGING ELEVATION OF SEWER MANHOLES**  
 STA. 4+44 RT

**618.10 PORTLAND CEMENT CONCRETE SIDEWALK, 5 INCH**

STA. 0+00 - STA. 0+12 LT

**618.30 DETECTABLE WARNING SURFACE**

STA. 0+03 LT

**646.402 DURABLE 4" WHITE LINE, THERMOPLASTIC**  
 STA. 0+00 - STA. 5+25 (DASHED LT & RT)  
 STA. 0+00 - STA. 5+25 (SOLID RT & LT)

**646.412 DURABLE 4" YELLOW LINE, THERMOPLASTIC**  
 STA. 0+00 - STA. 5+25 (SOLID LT, CENTERLINE)  
 STA. 0+00 - STA. 1+42 (SOLID RT, CENTERLINE)

**646.452 DURABLE 8" YELLOW LINE, THERMOPLASTIC**  
 STA. 0+00 - STA. 1+42 (HATCHED LT & RT)

**646.492 DURABLE LETTER OR SYMBOL, THERMOPLASTIC**

STA. 2+75 LT "AHEAD"  
 STA. 2+75 LT "AHEAD"  
 STA. 3+15 LT "SIGNAL"  
 STA. 3+15 LT "SIGNAL"

**646.602 TEMPORARY 4" WHITE LINE, PAINT**

STA. 0+00 - STA. 5+25 (DASHED LT & RT)  
 STA. 0+00 - STA. 5+25 (SOLID RT & LT)

**646.612 TEMPORARY 4" YELLOW LINE, PAINT**

STA. 0+00 - STA. 5+25 (SOLID LT, CENTERLINE)  
 STA. 0+00 - STA. 1+42 (SOLID RT, CENTERLINE)

**646.652 TEMPORARY 8" YELLOW LINE, PAINT**

STA. 0+00 - STA. 1+42 (HATCHED LT & RT)

**646.692 TEMPORARY LETTER OR SYMBOL, PAINT**

STA. 2+75 LT "AHEAD"  
 STA. 2+75 LT "AHEAD"  
 STA. 3+15 LT "SIGNAL"  
 STA. 3+15 LT "SIGNAL"

**675.50 REMOVING SIGNS**

AS SHOWN - 5

**675.60 ERECTING SALVAGED SIGNS**

AS SHOWN - 1

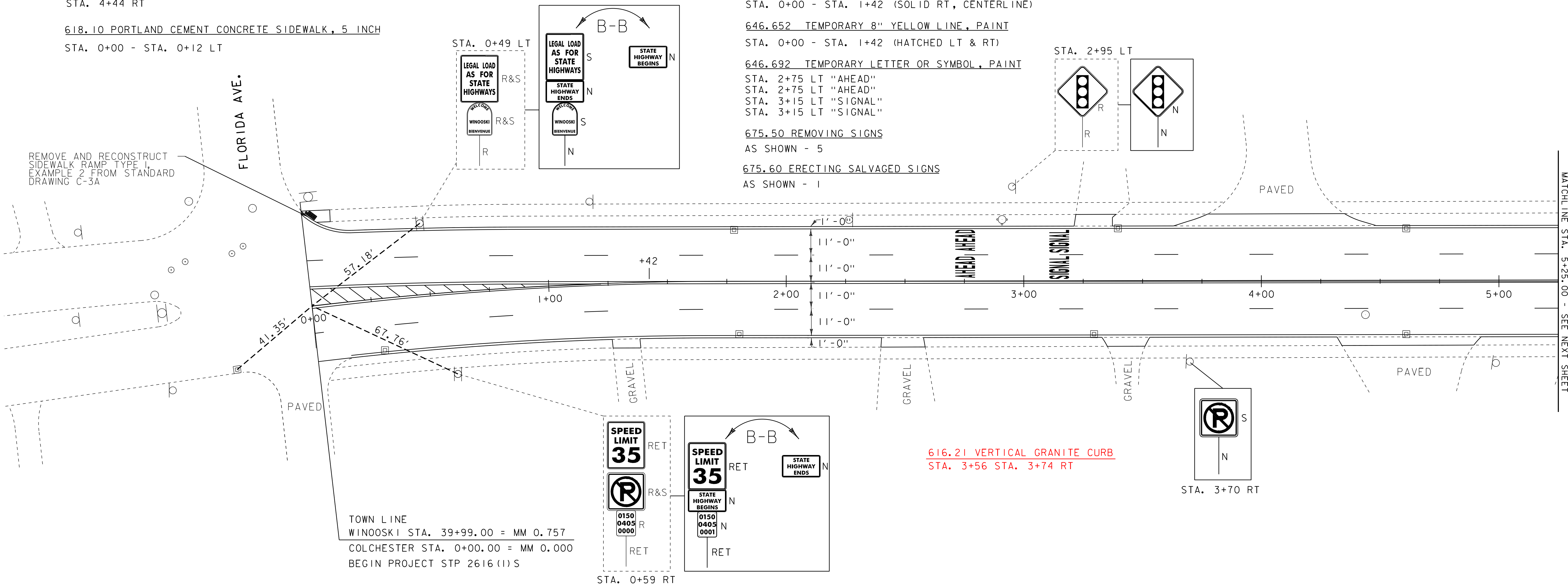

REMOVE AND RECONSTRUCT SIDEWALK RAMP TYPE 1, EXAMPLE 2 FROM STANDARD DRAWING C-3A

FLORIDA AVE.

TOWN LINE  
 WINOOSKI STA. 39+99.00 = MM 0.757  
 COLCHESTER STA. 0+00.00 = MM 0.000  
 BEGIN PROJECT STP 2616(I)S

616.21 VERTICAL GRANITE CURB  
 STA. 3+56 STA. 3+74 RT

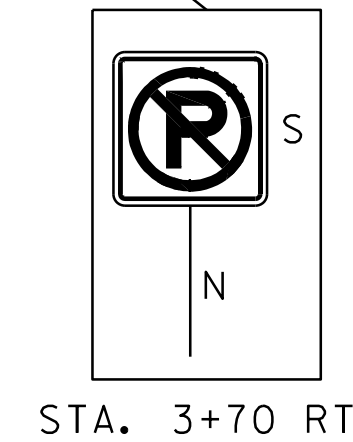

STA. 3+70 RT

**LEGEND**

- HYDRANT
- MANHOLE
- WATER VALVE
- GAS PIPELINE MARKER
- CATCH BASIN / DROP INLET
- CURB INLET
- ⊠ TRAFFIC CONTROL BOX
- ⊕ RAILROAD CROSSING SIGNAL

**SIGN LEGEND**

- R = REMOVE
- R&S = REMOVE AND SALVAGE
- S = SALVAGE
- RET = RETAIN
- N = NEW
- B-B = BACK TO BACK

DATUM	
VERTICAL	N/A
HORIZONTAL	N/A

NOT TO SCALE

**PROJECT LAYOUT SHEET 1**

PROJECT NAME: COLCHESTER-ESSEX  
 PROJECT NUMBER: STP 2616(I)S

FILE NAME: p06b062.dgn  
 PROJECT LEADER: EPD  
 DESIGNED BY: CDL  
 PLOT FILE: p06b062plot.i

PLOT DATE: 30-OCT-2012 12:00  
 DRAWN BY: SJL  
 CHECKED BY: EPD  
 SHEET 9 OF \$SH\$