

INDEX OF SHEETS
SEE SHEET 2

STATE OF VERMONT AGENCY OF TRANSPORTATION

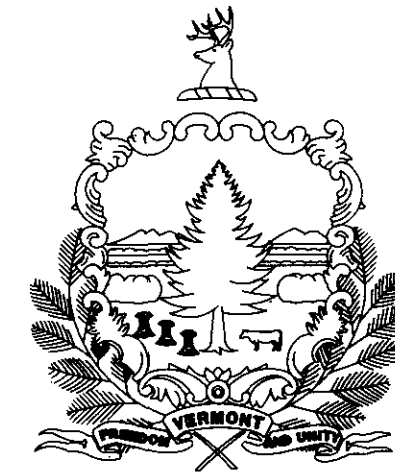

PROPOSED IMPROVEMENT TOWNS OF COLCHESTER AND ESSEX COUNTY OF CHITTENDEN VT ROUTE 15

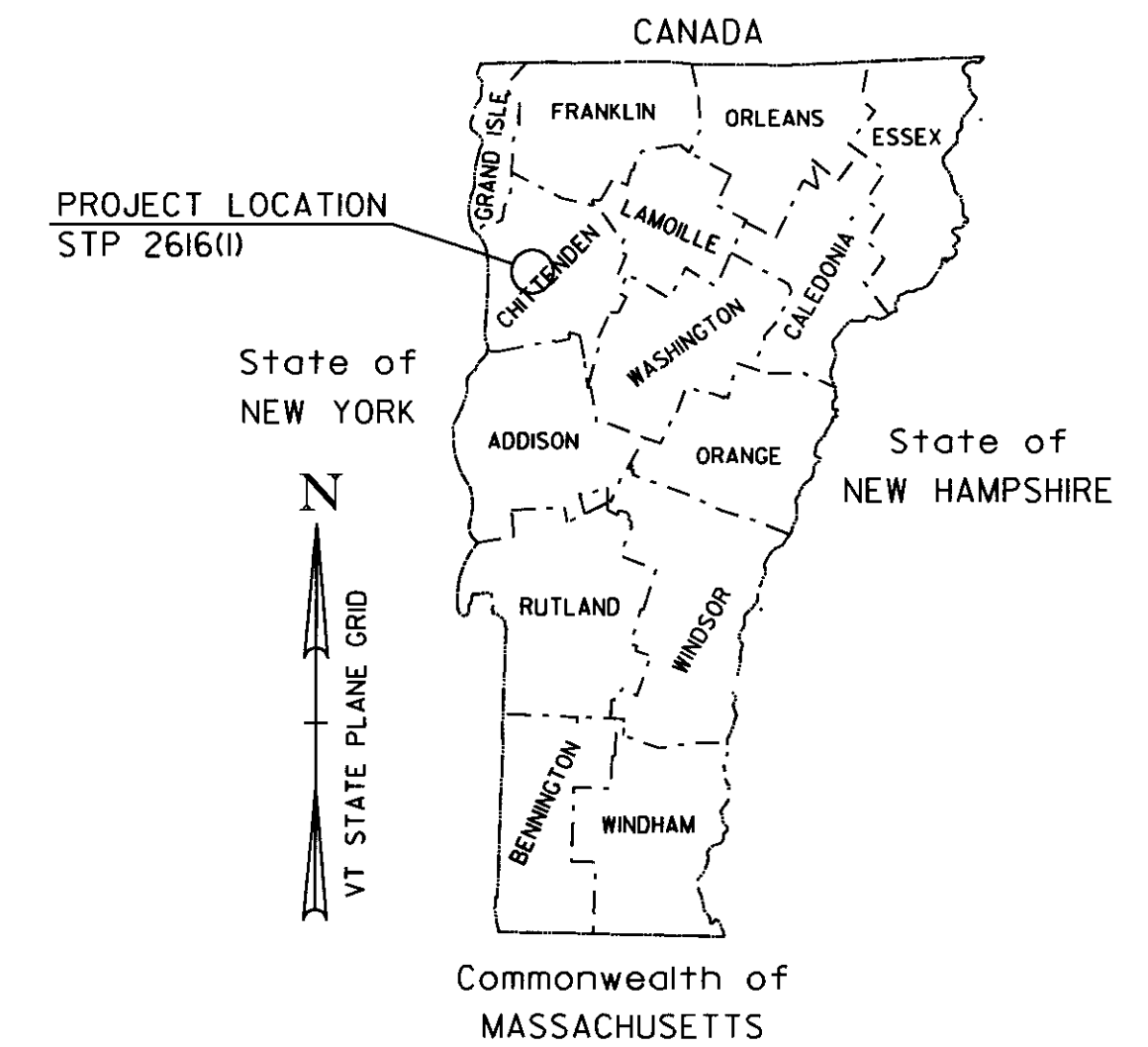

TRAFFIC DATA

| | AADT | | DHV | | CUM. ESALS (2009-2019) | CUM. ESALS (2009-2029) |
|--|--------|--------|-------|-------|---------------------------|---------------------------|
| | 2009 | 2019 | 2009 | 2019 | | |
| BEGINNING OF PROJECT TO LIME KILN RD. (MM 0.000 MM 0.382 COLCHESTER) | 25,700 | 27,000 | 2,700 | 2,800 | 2,810,000 | 7,176,000 |
| LIME KILN RD. TO CAMP JOHNSON (MM 0.382 - MM 0.927 COLCHESTER) | 29,000 | 30,400 | 3,000 | 3,200 | 2,673,000 | 6,806,000 |
| CAMP JOHNSON TO BARNES AVE (MM 0.927 COLCHESTER - MM 1.270 ESSEX) | 28,900 | 30,300 | 3,000 | 3,200 | 2,383,000 | 6,043,000 |
| BARNES AVE TO SUSIE WILSON RD (MM 1.270 - MM 0.570 ESSEX) | 25,000 | 26,200 | 2,600 | 2,700 | 2,013,000 | 5,137,000 |
| SUSIE WILSON RD TO WEST STREET (MM 0.570 - MM 1.019 ESSEX) | 20,600 | 21,600 | 2,100 | 2,200 | 2,503,000 | 5,498,000 |
| WEST STREET TO END OF PROJECT (MM 1.019 - MM 1.575 ESSEX) | 15,600 | 16,400 | 1,600 | 1,700 | 1,268,000 | 3,221,000 |

RECORD PLANS

CONTRACTOR: F.W. WHITCOMB CONSTRUCTION CORP. - WALPOLE, NH

RESIDENT ENGINEER: JON DAY

CONSTRUCTION BEGAN: MAY 5, 2009

CONSTRUCTION COMPLETE: NOV 23, 2009

RECORD PLANS BY: JON DAY & N. GARBACIK

I HEREBY CERTIFY THAT ALL THE CONSTRUCTION REQUIRED BY THIS SET OF DRAWINGS HAS BEEN ACCOMPLISHED AS INDICATED HEREIN.

BY: *[Signature]* RESIDENT ENGINEER

DATE: 01-14-11

NOTE: Any further information concerning final quantities, amounts or other details relative to this project may be found at Central Files in the electronic archives.

BEGINNING IN THE TOWN OF COLCHESTER AT THE WINOOSKI-COLCHESTER TOWN LINE AT MILE MARKER 0.000 = STA. 0+00.00 AND EXTENDING EASTERLY ALONG VT ROUTE 15 FOR A DISTANCE OF 15,504.63 FT (2.937 MILES) TO AN ENDING POINT IN THE TOWN OF ESSEX AT MILE MARKER 1.575 = STA. 83+14.00.

| STATION TO STATION DATA | LENGTH (FEET) | (MILES) |
|---|------------------|---------|
| TOWN OF COLCHESTER STA. 0+00.00 TO STA. 71+90.63 (MM 0.000 TO MM 1.362) | 7,190.63 | 1.362 |
| TOWN OF ESSEX STA. 0+00.00 TO STA. 83+14.00 (MM 0.000 TO MM 1.575) | 8,314.00 | 1.575 |
| TOTAL ROADWAY LENGTH = | 15,504.63 | 2.937 |
| TOTAL PROJECT LENGTH = | 15,504.63 | 2.937 |

WORK TO BE PERFORMED UNDER THIS PROJECT INCLUDES COLD PLANING, RESURFACING WITH A LEVELING COURSE AND WEARING COURSE, PAVEMENT MARKINGS, GUARDRAIL IMPROVEMENTS, DRAINAGE IMPROVEMENTS, AND INCIDENTAL ITEMS.

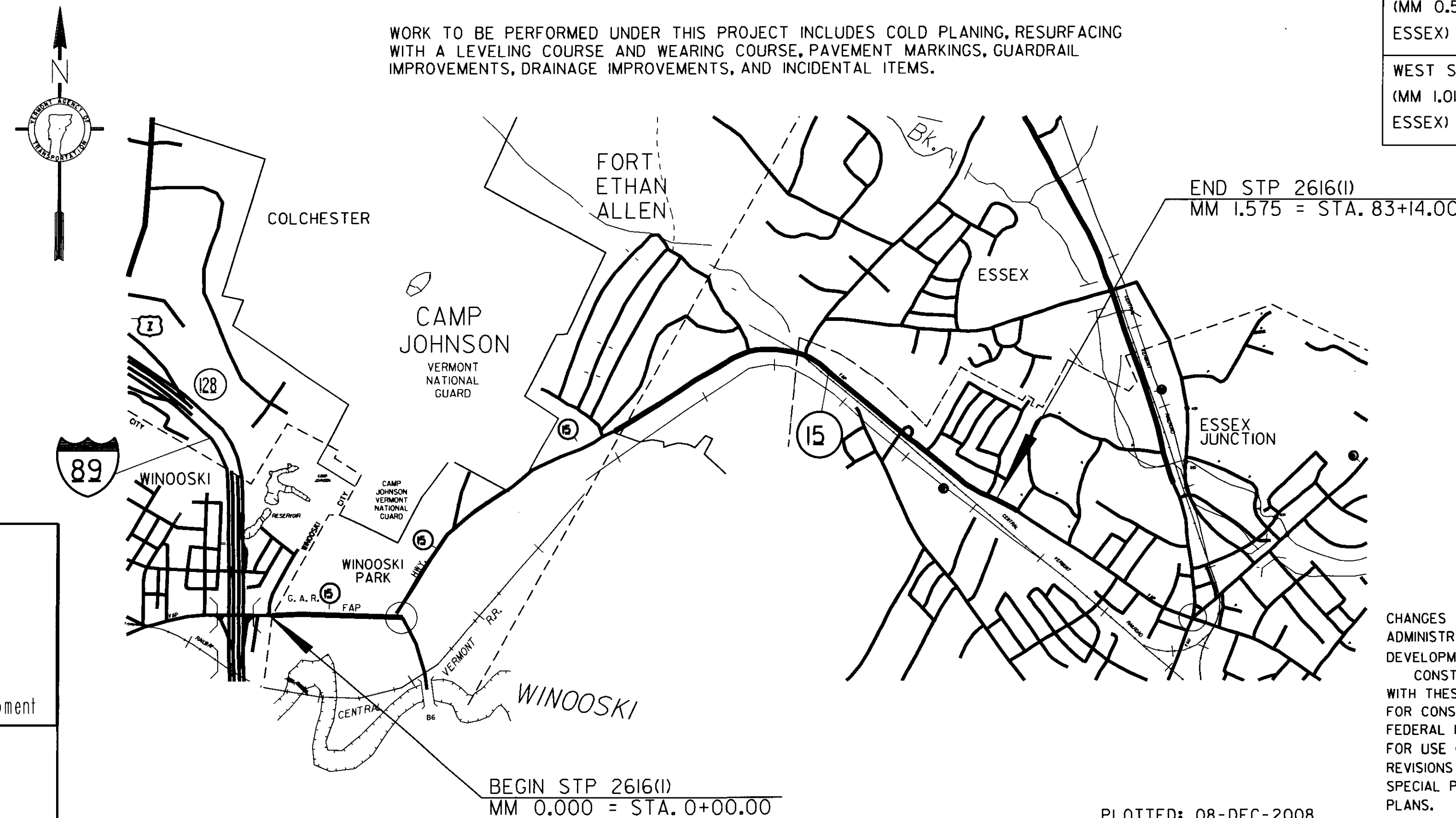

BITUMINOUS CONCRETE PAVEMENT
SUPERPAVE MIXTURE DESIGN CRITERIA

| | |
|----------------------------------|--|
| DESIGN LANE / DESIGN LIFE ESAL | 3,588,000 |
| DESIGN NUMBER OF GYRATIONS | 75 |
| PERFORMANCE GRADE ASPHALT BINDER | SEE SECTION 490 GENERAL SPECIAL PROVISIONS |

CONVENTIONAL SYMBOLS

| | |
|--------------------|-----------------|
| COUNTY LINE | — — — — — |
| TOWN LINE | — — — — — |
| LIMITS OF ACCESS | — — — — — |
| POINT OF ACCESS | X |
| FENCE LINE | X — X — X — X — |
| STONE WALL | — — — — — |
| TRAVELED WAY | — — — — — |
| GUARD RAIL | — — — — — |
| RAILROAD | — — — — — |
| SURVEY LINE | — — — — — |
| CULVERT | — — — — — |
| POWER POLE | ⊕ |
| TELEPHONE POLE | ⊕ |
| TREES | ⊕ |
| CONTROL OF ACCESS | — — — — — |
| PROPERTY LINE | — — — — — |
| R.O.W. TAKING LINE | — — — — — |
| SLOPE RIGHTS | SR |
| TOP OF CUT | — — — — — |
| TOE OF SLOPE | — — — — — |

DuBois & King inc.

engineering planning management development

DATUM

VERTICAL: N/A

HORIZONTAL: N/A

CHANGES AS MAY BE REQUIRED BY THE FEDERAL HIGHWAY ADMINISTRATION OR THE DIRECTOR OF PROGRAM DEVELOPMENT.

CONSTRUCTION IS TO BE CARRIED ON IN ACCORDANCE WITH THESE PLANS AND THE STANDARD SPECIFICATIONS FOR CONSTRUCTION DATED 2006, AS APPROVED BY THE FEDERAL HIGHWAY ADMINISTRATION ON JUNE 15, 2006 FOR USE ON THIS PROJECT, INCLUDING ALL SUBSEQUENT REVISIONS AND SUCH REVISED SPECIFICATIONS AND SPECIAL PROVISIONS AS ARE INCORPORATED IN THESE PLANS.

DIRECTOR OF PROGRAM DEVELOPMENT

APPROVED: *[Signature]* DATE: 12-10-2008

PROJECT MANAGER: TED DOMEY

PROJECT NAME: COLCHESTER-ESSEX

PROJECT NUMBER: STP 2616(I)

SHEET 1 OF 45 SHEETS

PLOTTED: 08-DEC-2008