

CONSTRUCTION APPROACH SIGNING

NOT TO SCALE
SEE STD E-100, E-100A AND E-103 FOR SIGN PLACEMENT

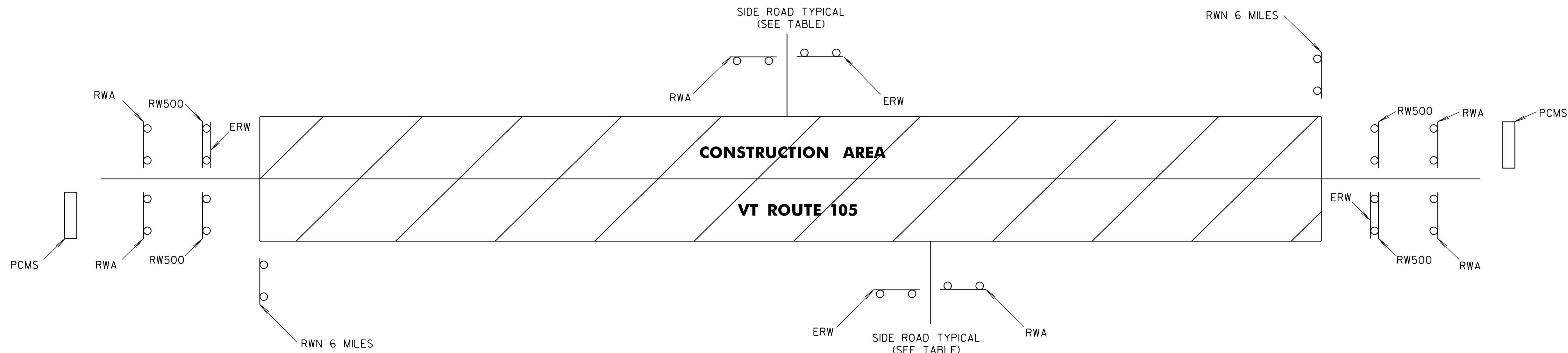

NOTES:

- THE CONTRACTOR SHALL SUBMIT A TRAFFIC CONTROL PLAN FOR APPROVAL PRIOR TO THE START OF CONSTRUCTION. THE COST OF PREPARING THIS PLAN (AND MAKING CHANGES IF NECESSARY) SHALL NOT BE PAID SEPARATELY BUT WILL BE INCLUDED IN THE UNIT PRICE BID FOR ITEM 641.10, "TRAFFIC CONTROL".
- THE CONTRACTOR SHALL INCLUDE A CONSTRUCTION SIGN APPROACH PACKAGE FOR EXPECTED LANE CLOSURES AND WORK ZONE SPEED REDUCTIONS IN COMPLIANCE WITH THE TRAFFIC CONTROL NOTES AND PART 6 OF THE MUTCD. PAYMENT FOR PROVIDING THIS PACKAGE WILL BE INCLUDED IN THE UNIT PRICE BID FOR ITEM 641.10, "TRAFFIC CONTROL".
- THE BID PRICE FOR "TRAFFIC CONTROL", ITEM 641.10, SHALL INCLUDE ALL OF THE FOLLOWING, AS NEEDED: APPROACH AND ON-PROJECT CONSTRUCTION SIGNING, PORTABLE ARROW BOARDS, BARRIERS, BARRELS, CONES, BARRICADES, TEMPORARY REGULATORY AND WARNING SIGNS, AND POSTS AS DETAILED IN VTRANS STANDARDS. ALL ADJUSTING, RELOCATING, AND REMOVING OF THESE DEVICES AS DIRECTED BY THE RESIDENT ENGINEER SHALL ALSO BE INCLUDED. THE FOLLOWING ITEMS WILL BE PAID FOR SEPARATELY:
646.602, 646.612, 646.682, 646.692, AND 646.712 - TEMPORARY PAVEMENT MARKINGS
630.10 AND 630.15 - UNIFORMED TRAFFIC OFFICERS AND FLAGGERS
- PORTABLE CHANGEABLE MESSAGE SIGNS (PCMS) WILL BE PROVIDED FOR USE ALONG THIS PROJECT. THE PLACEMENT OF THESE UNITS AS WELL AS THE MESSAGE WILL BE APPROVED BY THE RESIDENT ENGINEER. THESE SIGNS WILL BE PAID FOR UNDER ITEM 641.15, "PORTABLE CHANGEABLE MESSAGE SIGN".

PCMS SHOULD NOT REPLACE ANY OF THE SIGNING DETAILED IN THE MUTCD AND SHOULD NOT BE USED IF STANDARD TRAFFIC CONTROL DEVICES ADEQUATELY PROVIDE THE INFORMATION THE MOTORISTS NEED TO TRAVEL SAFELY.

THE PCMS SHALL CONSIST OF EITHER ONE OR TWO PHASES. TYPICALLY, A PHASE SHALL CONSIST OF UP TO THREE LINES OF EIGHT CHARACTERS PER LINE. THE PCMS SHOULD BE USED AS A SUPPLEMENT AND NOT AS A SUBSTITUTE FOR CONVENTIONAL SIGNS AND PAVEMENT MARKINGS.

THE PCMS SHOULD COMMUNICATE WHAT INFORMATION MOTORISTS NEED TO KNOW. UNNECESSARY INFORMATION SHOULD BE AVOIDED. MESSAGES SHOULD BE UPDATED PERIODICALLY TO DESCRIBE THE WORK ACTIVITY OCCURRING SO THAT THE PCMS CONTINUES TO COMMAND THE ATTENTION OF MOTORISTS.
- THE MUTCD 2003 SHALL BE THE STANDARD FOR ALL TRAFFIC CONTROL DEVICES. EXISTING SIGNS, SIGNALS AND MARKINGS SHALL BE VALID UNTIL SUCH TIME AS THEY ARE REPLACED OR RECONSTRUCTED. WHEN NEW TRAFFIC CONTROL DEVICES ARE ERECTED OR PLACED OR EXISTING TRAFFIC CONTROL DEVICES ARE REPLACED OR REPAIRED THE EQUIPMENT, DESIGN, METHOD OF INSTALLATION, PLACEMENT OR REPAIR SHALL CONFORM WITH SUCH STANDARDS.
- NO CONSTRUCTION SIGNS SHALL BE INSTALLED AS TO INTERFERE OR OBSTRUCT THE VIEW OF EXISTING TRAFFIC CONTROL DEVICES, STOPPING SIGHT DISTANCE, AND CORNER SIGHT DISTANCE FROM DRIVES AND TOWN HIGHWAYS.
- SEE THE TRAFFIC CONTROL NOTES FOR ADDITIONAL INFORMATION REGARDING IMPLEMENTATION OF THE TEMPORARY TRAFFIC CONTROL DEVICES.

INTRODUCTION

THE FOLLOWING TRAFFIC CONTROL INFORMATION IS INTENDED TO BE A GENERAL OUTLINE FOR HOW THE WORK SHOULD PROCEED. IT IS THE CONTRACTOR'S RESPONSIBILITY TO PROVIDE SPECIFIC DETAILS TO ADDRESS SPECIFIC SITUATIONS. THIS RESPONSIBILITY INCLUDES PROVIDING A PLAN DETAILING THE USE AND PLACEMENT OF SIGNS, CHANNELING DEVICES, ARROW PANELS, FLAGGERS AND UNIFORMED TRAFFIC OFFICERS (UTO'S) DURING LANE CLOSURES. IF THE CONTRACTOR DOES NOT WISH TO FOLLOW THIS OUTLINE, THE CONTRACTOR MAY SUBMIT AN ALTERNATE PROPOSAL TO THE PAVEMENT MANAGEMENT SECTION VIA THE ENGINEER. THE CONTRACTOR MUST ALLOW AT LEAST 4 WEEKS FOR REVIEW AND APPROVAL OF THE COMPREHENSIVE PLAN AND 2 WEEKS FOR REVIEW AND APPROVAL OF MINOR CHANGES/DETAILS. ALL TRAFFIC CONTROL DETAILS MUST BE DESIGNED AND IMPLEMENTED IN ACCORDANCE WITH THE MUTCD AND VTRANS STANDARDS E-100, E-100A, E-101, E-102, E-102A, E-106, E-107, E-107A, E-108A, E-103, E-110, E-111 AND E-112.

TRAFFIC CONTROL NOTES

ALL WORK SHALL BE DONE BETWEEN THE HOURS OF 7:00 AM AND 7:00 PM.

THE CONTRACTOR SHALL BE OUT OF THE ROAD BY 3:00 PM EACH AND EVERY FRIDAY UNLESS GIVEN PERMISSION BY THE RESIDENT ENGINEER.

A MINIMUM LANE WIDTH OF 10 FT. SHALL BE MAINTAINED.

WHEN COLD PLANED BITUMINOUS PAVEMENT IS OPEN TO TRAFFIC, A "MOTORCYCLES USE CAUTION" SIGN, AS PER VTRANS STANDARD E-102A, SHALL BE PROVIDED.

IT IS INTENDED TO HAVE NO LONGITUDINAL DROP-OFFS DURING THE OVERNIGHT HOURS. THEREFORE, THE FULL ROADWAY WIDTH SHOULD BE COLD PLANED OR PAVED DURING THE DAILY WORK PERIOD. WHEN NECESSARY, DROP-OFF PROTECTION IN THESE AREAS SHALL CONFORM TO VTRANS STANDARD E-108A.

MAINTAIN ACCESS TO ALL PROPERTIES AT ALL TIMES FOR EMERGENCY VEHICLES. MAINTAIN ACCESS TO ALL COMMERCIAL AND MUNICIPAL PROPERTIES DURING BUSINESS HOURS. ACCESS TO RESIDENTIAL PROPERTIES MAY BE RESTRICTED FOR A SHORT DURATION (A FEW HOURS) WITH PERMISSION OF THE OWNER. COORDINATE MAJOR WORK ON COMMERCIAL OR MUNICIPAL ACCESSES WITH THE OWNER AT LEAST ONE WEEK PRIOR TO STARTING THE WORK. ALL ACCESSES SHALL ALSO BE KEPT FREE OF WORK AND TRAFFIC CONTROLLED BY UNIFORMED TRAFFIC OFFICERS WHEN REQUIRED.

DRUMS SHOULD BE USED TO CHANNELIZE OR DELINEATE TRAFFIC FLOW WHILE REFLECTORIZED CONES ARE BETTER SUITED TO DELINEATE DRIVES WITHIN THE WORKZONE.

SIDE ROAD NAME	ROAD WORK AHEAD	END ROAD WORK	ROAD WORK 500 FT	ROAD WORK NEXT 6 MILES	PCMS
TROY					
BEGIN PROJECT (VT 105)	2	1	2	1	1
RIVER RD	1	1			
CEMETARY RD	1	1			
EAST HILL	1	1			
BLAIS RD	1	1			
NEWPORT					
BEAR MTN RD	1	1			
BUZZLE RD	1	1			
LAWSON RD	1	1			
END PROJECT (VT 105)	2	1	2	1	1
TOTALS	11	9	4	2	2

LEGEND

- RWA = ROAD WORK AHEAD
- RW500 = ROAD WORK 500 FT
- ERW = END ROAD WORK
- RWN = ROAD WORK NEXT 6 MILES

**CONSTRUCTION
APPROACH
SIGNING
SHEET**

PROJECT NAME: TROY-NEWPORT
PROJECT NUMBER: STP 2613(1)

FILE NAME: 06B056.dgn	PLOT DATE: 25-OCT-2011 12:19
PROJECT LEADER: CDL	DRAWN BY: SJL
DESIGNED BY: SJL	CHECKED BY: EPD
PLOT FILE: 06b056*31.i	SHEET 31 OF 31