

* MANCHESTER
 STA. 271+64.0 LT
 LEFT POST = 17.3'
 RIGHT POST = 14.9'
 3.5" DIAMETER TUBULAR STEEL

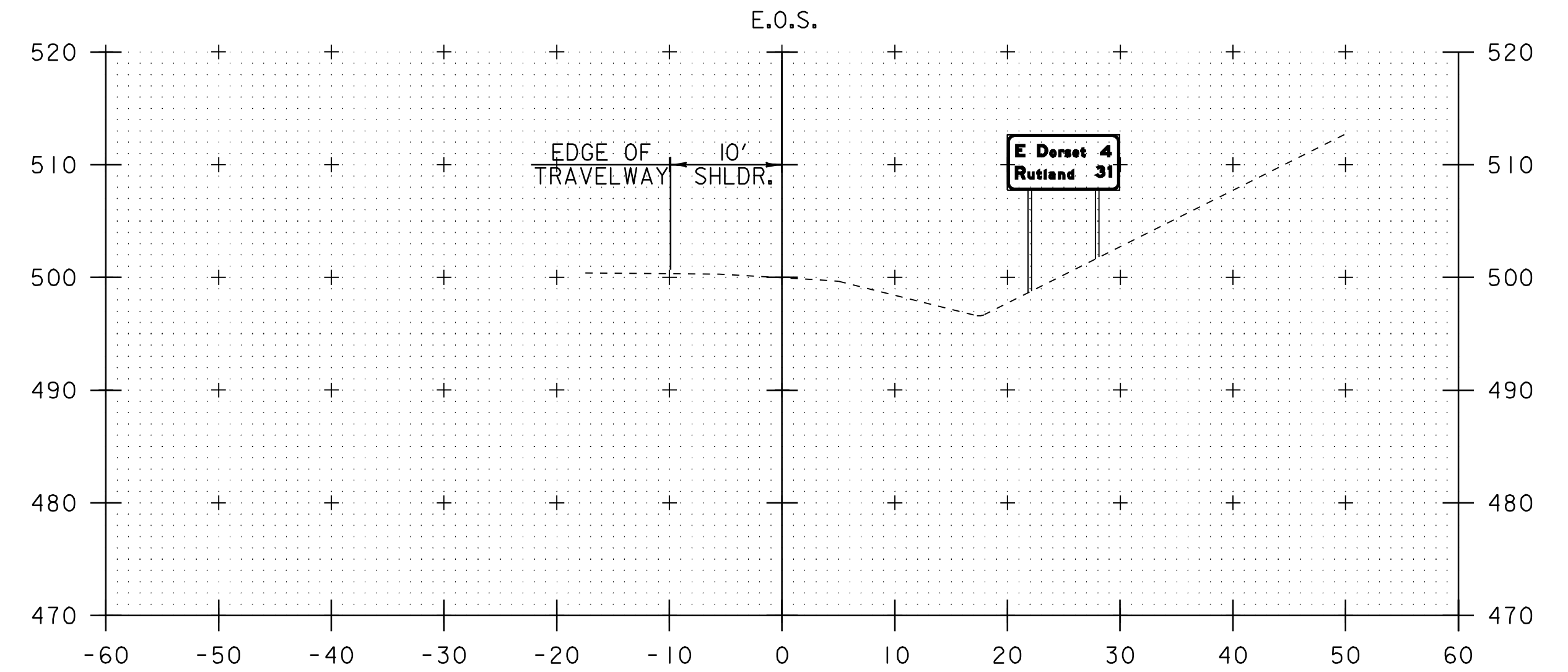

MANCHESTER
 STA. 291+39.0 RT
 LEFT POST = 14.0'
 RIGHT POST = 11.0'
 3" DIAMETER TUBULAR STEEL

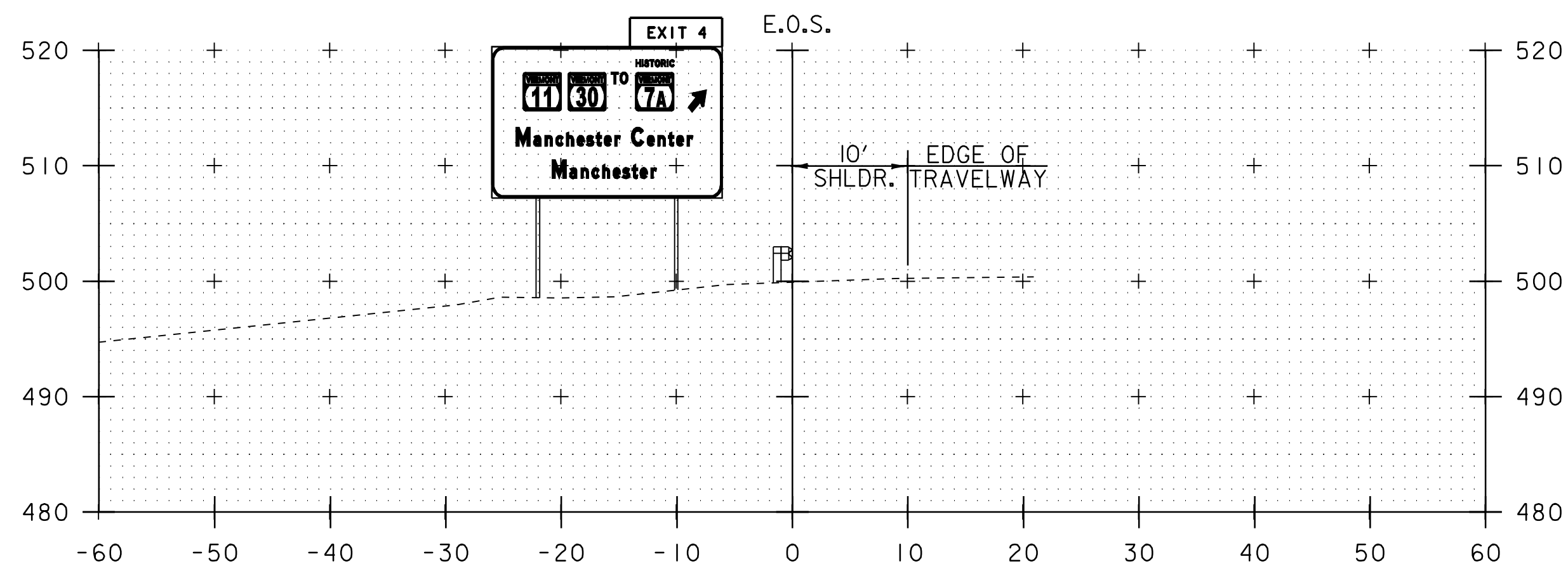

* MANCHESTER
 STA. 263+64.0 LT
 LEFT POST = 21.8'
 RIGHT POST = 21.1'
 W 8x21

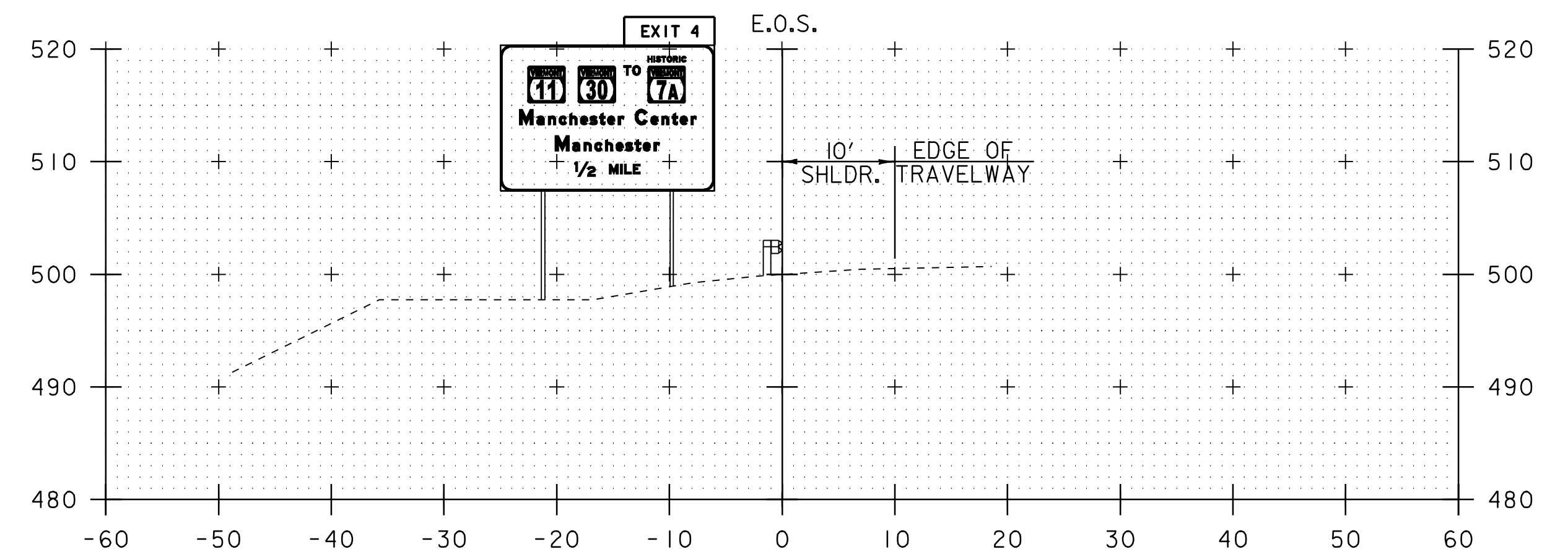

* MANCHESTER
 STA. 282+76.0 LT
 LEFT POST = 22.6'
 RIGHT POST = 21.4'
 W 12x30

* THIS SIGN FACE HAS BEEN SHOWN ON THE CROSS SECTION AT THE PROPER STATION AND OFFSET. DUE TO THE ORIENTATION OF THE STATION LINE, THE TEXT AND SYMBOLS HAVE BEEN SHOWN ON THE BACK OF THE PROPOSED GUIDE SIGN FOR ALL SIGNS TO BE INSTALLED ON THE SOUTHBOUND SIDE OF U.S. ROUTE 7.

SCALE: 1" = 20'
 @ FULL SIZE

NOT TO SCALE

**TRAFFIC SIGN
 CROSS SECTION
 SHEET #1**

PROJECT NAME: MANCHESTER - DORSET
 PROJECT NUMBER: NH 2608(1)S

FILE NAME: p06b040.dgn
 PROJECT LEADER: D.E.G.
 DESIGNED BY: M.J.M.
 IPARM FILE: p06b040xsc01.dgn

PLOT DATE: 07-JUN-2010 11:00
 DRAWN BY: C.A.K.
 CHECKED BY: D.W.E.
 SHEET 64 OF 78