

TOWN/STATE HIGHWAY NAME	ROAD WORK AHEAD	END ROAD WORK	ROAD WORK 500 FT	SIDE ROAD WORK AHEAD	SIDE ROAD WORK 500 FT	OTHER
US ROUTE 4						
ROSE HILL RD	1	1				
EATON PL	1	1				
MOUNTAIN AVE	1	1				
RIVER RD	1	1				
CHURCH ST EXT.	0	0				
COLLEGE HILL RD	1	1				
PROSPECT ST	1	1				
VT RTE 106		1		2	2	
COURT ST	1	1				
MOUNTAIN AVE	1	1				
MECHANIC ST	1	1				
HIGH ST	1	1				
BOND ST	0	0				
LINCOLN ST	1	1				
PLEASANT ST	0	0				
FORD ST	1	1				
STANTON ST	1	1				
CHARLES AVE	1	1				
HARTLAND HILL	1	1				
VT RTE 12						
PLEASANT ST	0	0				
RIVER ST	1	1				
RIVER RD	1	1				
BEGINNING OF PROJECT	2	1	2			
END OF PROJECT	4	2	4	2	2	
TOTALS	23	21	6	4	4	

NOTES:

1. THE CONTRACTOR SHALL SUBMIT A TRAFFIC CONTROL PLAN FOR APPROVAL PRIOR TO THE START OF CONSTRUCTION. THE COST OF PREPARING THIS PLAN (AND MAKING CHANGES IF NECESSARY) SHALL BE CONSIDERED INCIDENTAL TO ITEM 641.10, TRAFFIC CONTROL.
2. THE CONTRACTOR SHALL POSITION PORTABLE CHANGEABLE MESSAGE BOARDS WARNING MOTORISTS OF THE EXPECTED ROADWAY CONDITIONS AHEAD. THE MESSAGE TO BE DISPLAYED SHALL BE SUBMITTED TO THE RESIDENT ENGINEER IN ADVANCE FOR APPROVAL. THE COST OF PROVIDING THESE MESSAGE BOARDS SHALL BE PAID UNDER 641.15, PORTABLE CHANGEABLE MESSAGE SIGN.
3. THE BID PRICE FOR TRAFFIC CONTROL, ITEM 641.10, SHALL INCLUDE ALL OF THE FOLLOWING, AS NEEDED: APPROACH AND ON-PROJECT CONSTRUCTION SIGNING, BARRIERS, BARRELS, CONES, BARRICADES, TEMPORARY REGULATORY AND WARNING SIGNS, AND POSTS AS DETAILED IN VTRANS STANDARDS. ALL ADJUSTING, RELOCATING AND REMOVING OF THESE DEVICES AS DIRECTED BY THE RESIDENT ENGINEER SHALL ALSO BE INCLUDED.
4. THE MUTCD 2003 SHALL BE THE STANDARD FOR ALL TRAFFIC CONTROL DEVICES. EXISTING SIGNS AND MARKINGS SHALL BE VALID UNTIL SUCH TIME AS THEY ARE REPLACED OR RECONSTRUCTED. WHEN NEW TRAFFIC DEVICES ARE ERECTED OR PLACED, OR EXISTING TRAFFIC CONTROL DEVICES ARE REPLACED OR REPAIRED, THE EQUIPMENT, DESIGN, METHOD OF INSTALLATION, PLACEMENT OR REPAIR SHALL CONFORM WITH SUCH STANDARDS.
5. NO CONSTRUCTION SIGNS SHALL BE INSTALLED AS TO INTERFERE OR OBSTRUCT THE VIEW OF EXISTING TRAFFIC CONTROL DEVICES, STOPPING SIGHT DISTANCE, AND CORNER SIGHT DISTANCE FROM DRIVES AND TOWN HIGHWAYS.
6. THE CONTRACTOR SHALL INCLUDE A CONSTRUCTION SIGN PACKAGE FOR EXPECTED LANE CLOSURES AND WORK ZONE SPEED REDUCTIONS IN COMPLIANCE WITH STANDARD E-103. PAYMENT FOR PROVIDING THIS PACKAGE SHALL BE INCIDENTAL TO ITEM 641.10, TRAFFIC CONTROL.
7. ON VTRANS STANDARD E-103, SIGN W4-2 MAY BE REPLACED WITH W9-2:



W4-2

W9-2

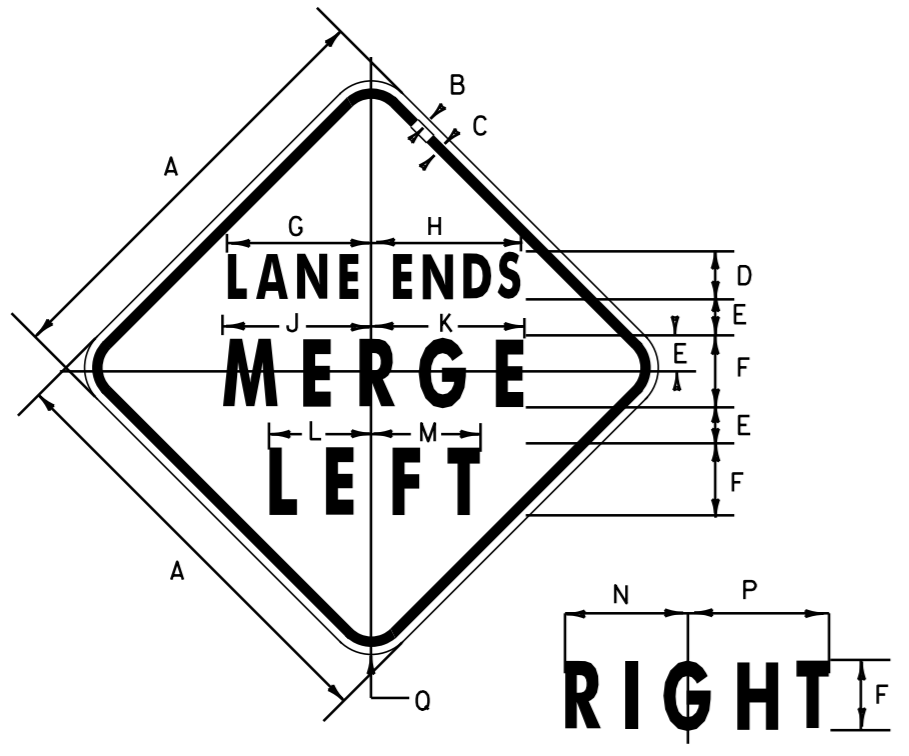

W9-2

SIGN	DIMENSIONS (INCHES)														
	A	B	C	D	E	F	G	H	J	K	L	M	N	P	Q
MIN.	30	1/2	3/4	3C	2 1/2	5D	9 5/16	9 5/16	10 3/8	10 5/16	7 1/8	7 9/16	8 9/16	9 7/8	1 7/8
STD.	36	5/8	7/8	4C	3	6D	12	12 1/2	12 3/8	12 3/4	8 1/2	9 1/8	10 1/4	11 3/4	2 1/4
EXPWY.	48	3/4	1 1/4	6C	4	8D	16 1/2	17	16 3/8	17 1/8	11 1/4	12 1/4	13 3/4	15 3/4	3

CONSTRUCTION APPROACH SIGNING

SEE STD E-100, E-100A AND E-103 FOR SIGN PLACEMENT

NOTE:

1. WHEN DIRECTED BY THE RESIDENT ENGINEER, "NO OUTLET" SIDE ROADS WILL NOT REQUIRE CONSTRUCTION SIGNING.
2. PAYMENT FOR CONSTRUCTION APPROACH SIGNING WILL BE MADE UNDER ITEM 641.10, TRAFFIC CONTROL.

LEGEND

- RWA = ROAD WORK AHEAD
- RW500 = ROAD WORK 500 FT
- RWN = ROAD WORK NEXT 1 MILE
- ERW = END ROAD WORK
- SRWA = SIDE ROAD WORK AHEAD
- SRW500 = SIDE ROAD WORK 500 FT

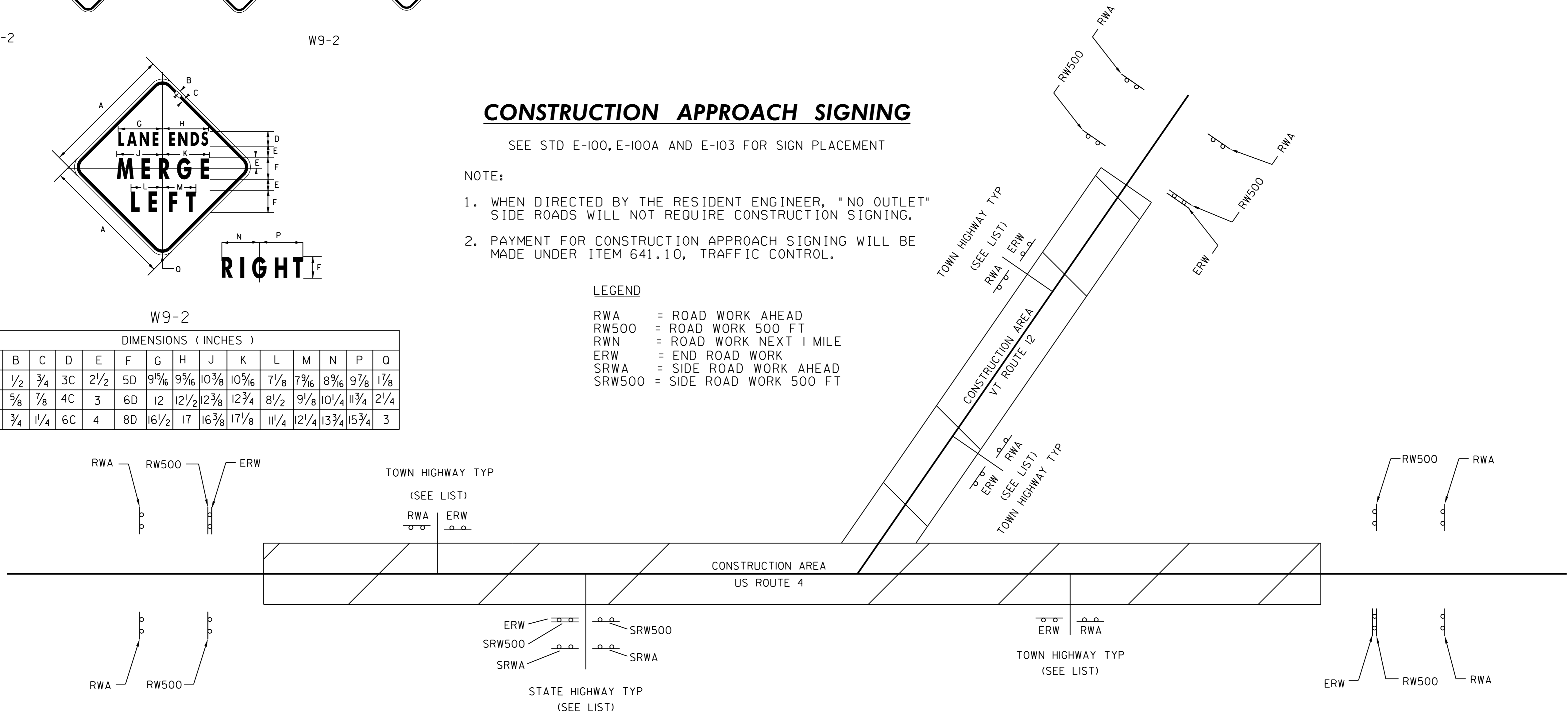

NOT TO SCALE

COMPOSITE CONSTR. APPROACH SIGNING

PROJECT NAME: WOODSTOCK
 PROJECT NUMBER: NH 2606(I)S / STP 2509(I)S
 DESIGN FILE NAME: /pave/06b036/pb036.dgn PLOT DATE: 11-JUN-2012 16:15
 IPARM FILE NAME: pb036ccs.i DRAWN BY: MRS
 PROJECT LEADER: PTS CHECKED BY: NULL
 DESIGNED BY: NULL SHEET 16 OF 73