

YIELD LINE DETAILS

TO BE INSTALLED ONLY AT THE DIRECTION OF THE RESIDENT ENGINEER TO BE PAID AS ONE LETTER OR SYMBOL PER TRIANGLE

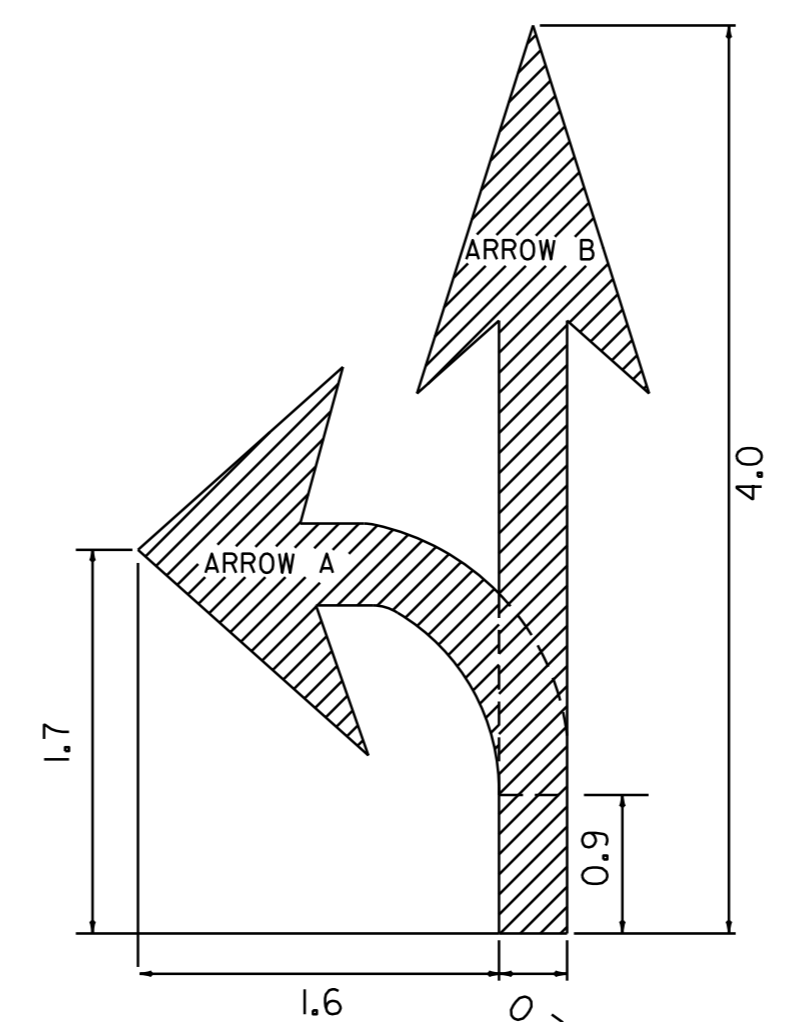
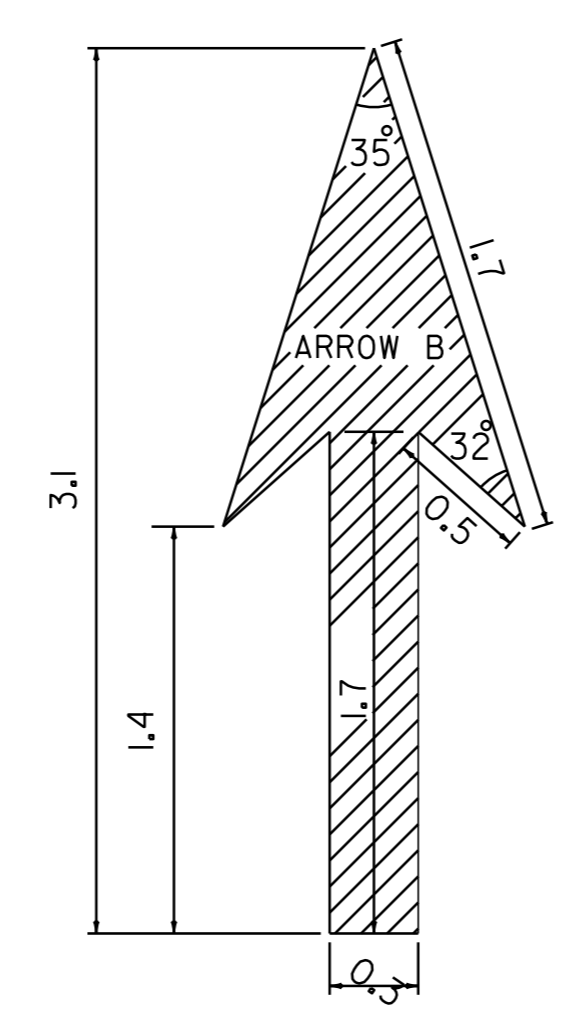
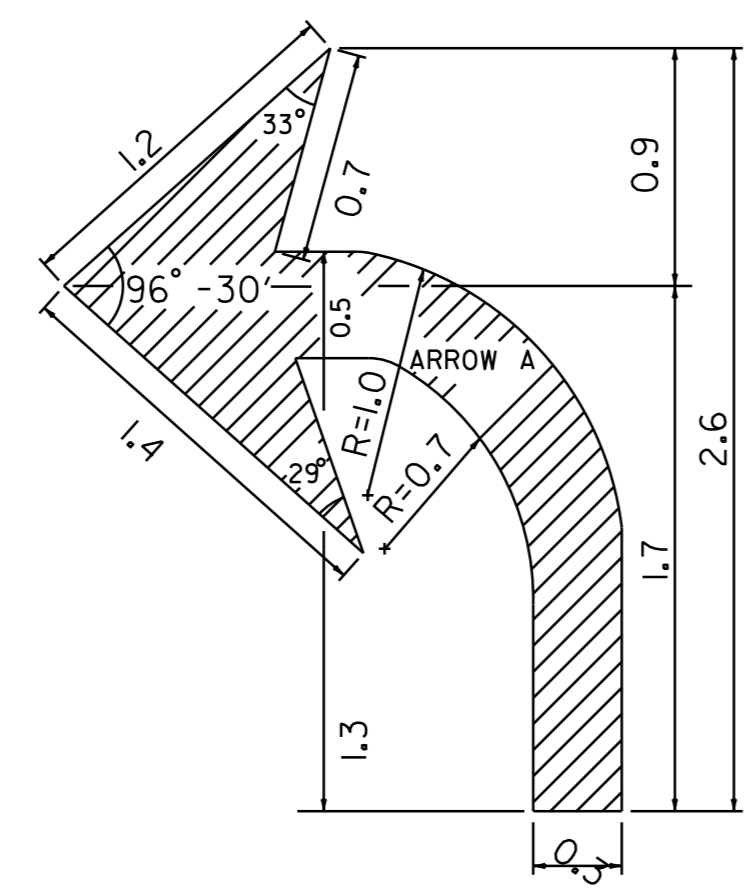
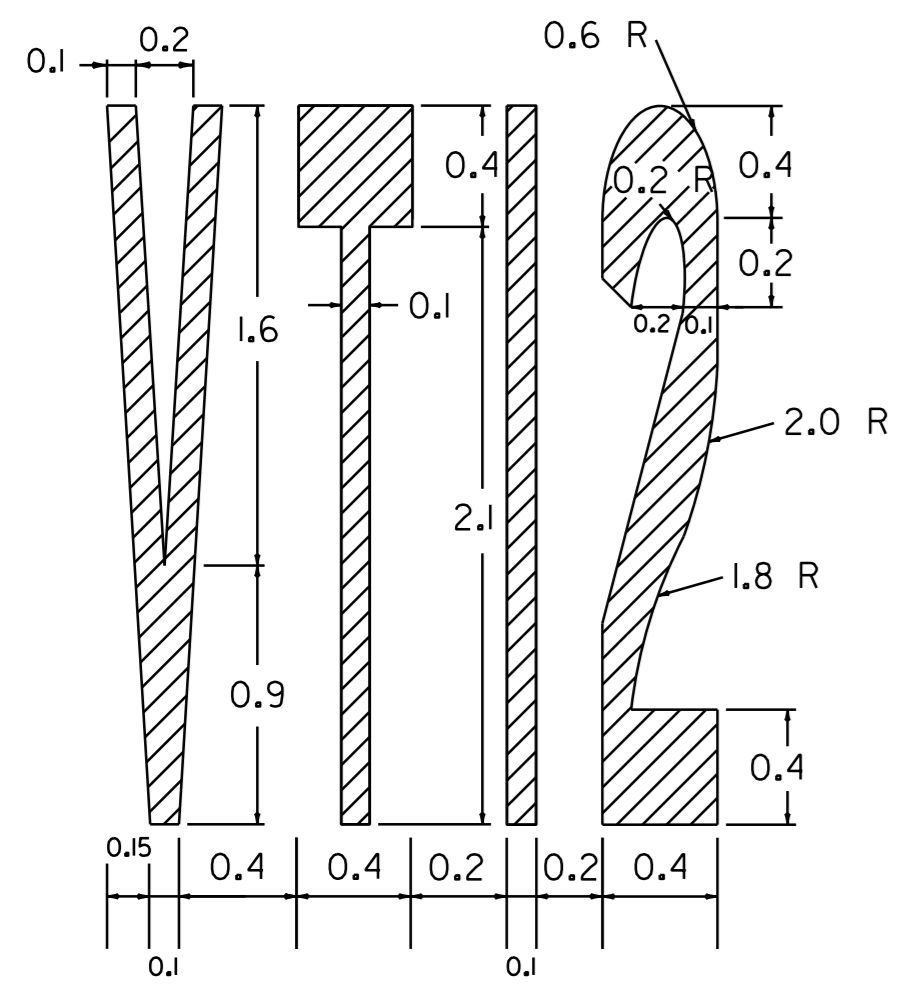
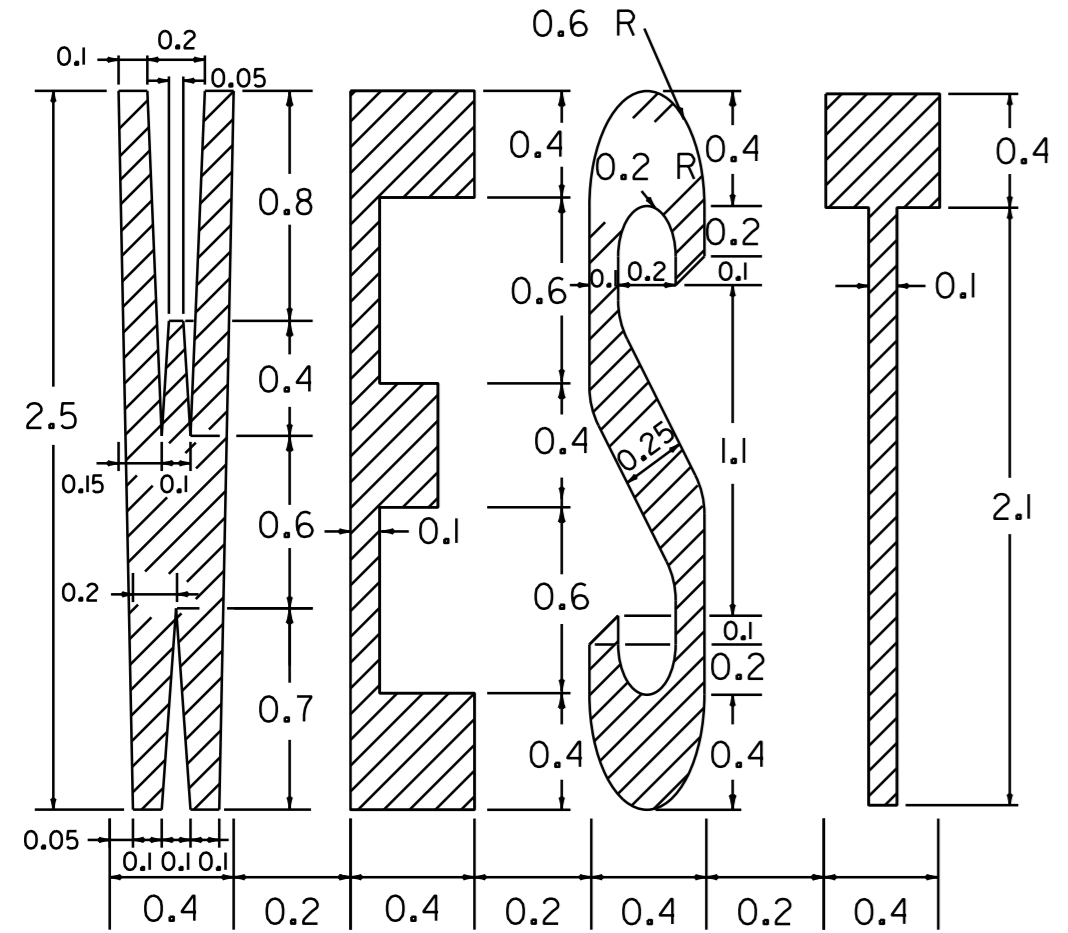

TO BE PAID AS TWO SYMBOLS

ARROW DETAILS

DIMENSIONS ARE FOR 2.5m LETTER HEIGHTS. A LESSER HEIGHT OF 2.4m IS ACCEPTABLE AS LONG AS THE DIMENSIONS ARE PROPORTIONAL TO THE DETAILS SHOWN. ARROWS AND WORD MARKINGS THAT CONFORM TO THE DIMENSIONS SHOWN ON THIS SHEET OR AS DETAILED IN THE BOOKLET ENTITLED "STANDARD ALPHABETS FOR HIGHWAY SIGNS AND PAVEMENT MARKINGS" AND THE "MANUAL ON UNIFORM TRAFFIC CONTROL DEVICES" (CURRENT EDITION) PREPARED BY THE FEDERAL HIGHWAY ADMINISTRATION WILL BE ACCEPTABLE.

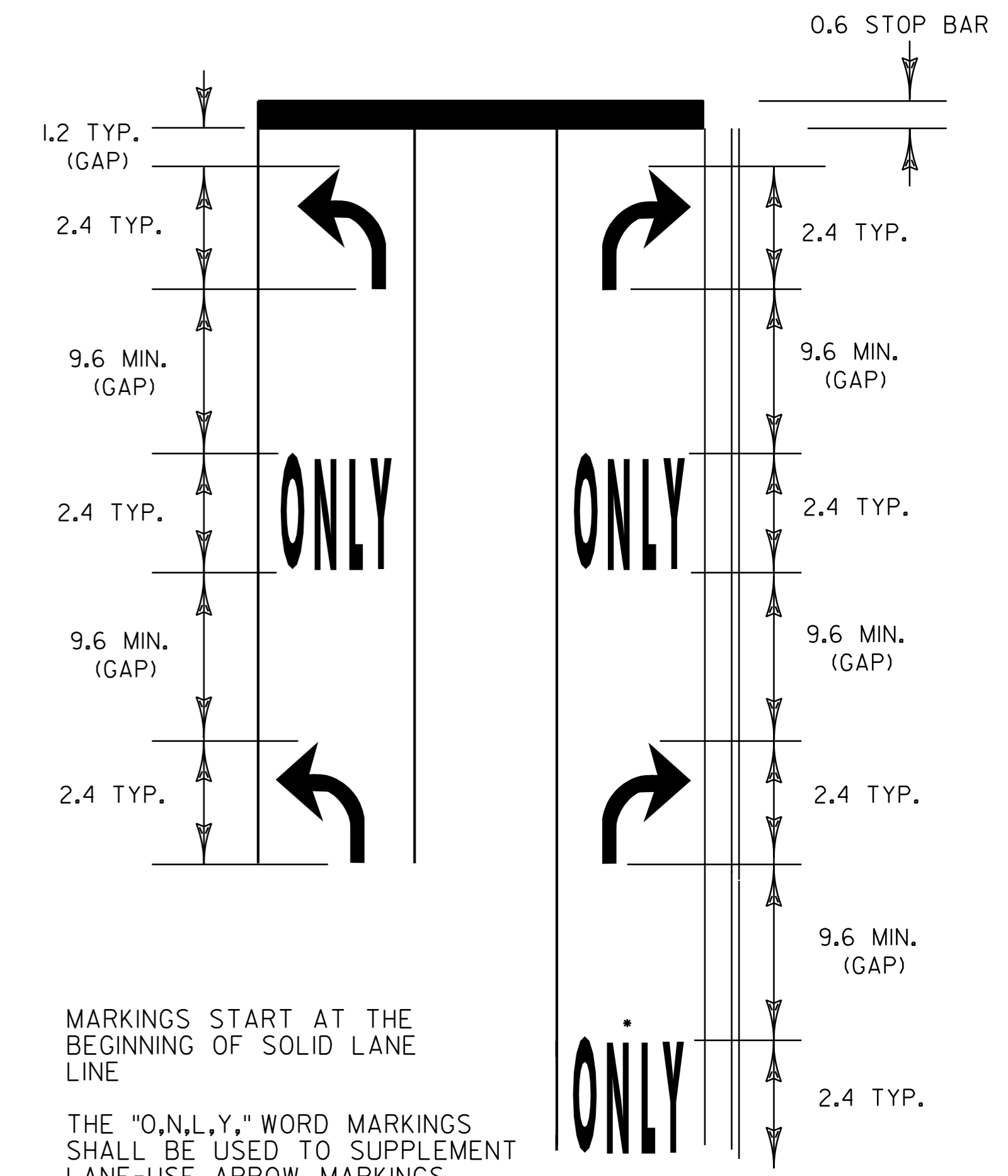
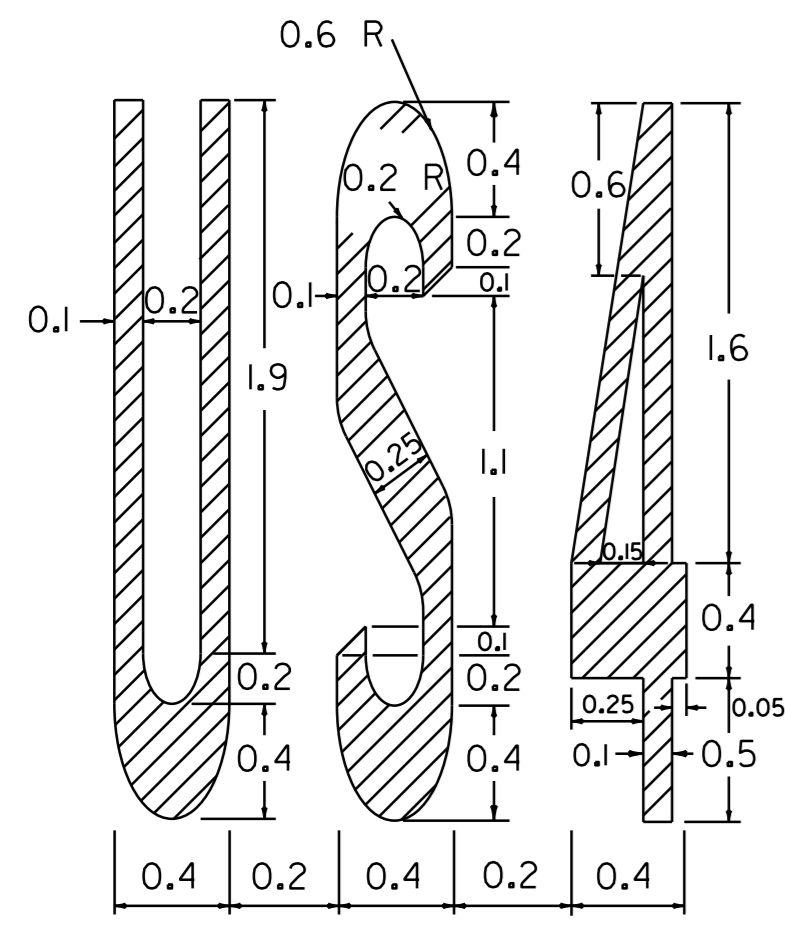

MARKINGS START AT THE BEGINNING OF SOLID LANE LINE

THE "O,N,L,Y," WORD MARKINGS SHALL BE USED TO SUPPLEMENT LANE-USE ARROW MARKINGS

IF LANE LENGTH IS LESS THAN 15.2 METERS, ONLY ONE TURN ARROW PLACED AT THE BEGINNING OF THE SOLID LANE LINE, IS REQUIRED.

* A SECOND "O,N,L,Y," IS OPTIONAL WHEN SPACE PERMITS. MARKINGS START AT THE BEGINNING OF THE SOLID LANE LINE.

THE LONGITUDINAL SPACE BETWEEN WORD OR SYMBOL MESSAGE MARKINGS, SHOULD BE AT LEAST FOUR TIMES THE HEIGHT OF THE CHARACTERS FOR LOW SPEED ROADS, BUT NOT MORE THAN TEN TIMES THE HEIGHT OF THE CHARACTERS UNDER ANY CONDITIONS.

EXCLUSIVE TURN LANES (LEFT OR RIGHT) LANE LINES SHALL BE SOLID AND EXTEND BACK FROM THE STOP LINE TO THE POINT OF FULL LANE WIDTH OF THE TURN LANE.

TYPICAL MARKINGS FOR TURN LANES

NOTE: ALL DIMENSIONS IN METERS EXCEPT AS INDICATED

COMPOSITE TYPICAL PAVEMENT MARKINGS

PROJECT NAME:	WOODSTOCK
PROJECT NUMBER:	NH 2606(I)S / STP 2509(I)S
DESIGN FILE NAME:	pave/06b036/pb036.dgn
IPARM FILE NAME:	pb036c+pm04.i
PROJECT LEADER:	PTS
DESIGNED BY:	NLL
PLOT DATE:	11-JUN-2012 16:15
DRAWN BY:	MRS
CHECKED BY:	NLL
SHEET	6 OF 73