

604.412, 604.415 OR 604.418 REHAB.  
Dis. CBS OR MHS, CLASS I, II OR III  
STA. 19+61, LT

604.42 CHANGING ELEVATION OF SEWER MANHOLES  
STA. 20+96, LT

621.80 REMOVAL AND DISPOSAL OF GUARDRAIL  
STA. 17+00.0 TO 17+03.0, LT

646.402 DURABLE 4 INCH WHITE LINE, THERMOPLASTIC  
STA. 17+00 TO 23+00, SOLID LT & RT

646.412 DURABLE 4 INCH YELLOW LINE, THERMOPLASTIC  
STA. 17+00 TO 23+00, SOLID LT & RT

646.602 TEMPORARY 4 INCH WHITE LINE, PAINT  
STA. 17+00 TO 23+00, SOLID LT & RT

646.612 TEMPORARY 4 INCH YELLOW LINE, PAINT  
STA. 17+00 TO 23+00, SOLID LT & RT

675.50 REMOVING SIGNS (TYPE A)  
AS SHOWN - 3

675.60 ERECTING SALVAGED SIGNS  
AS SHOWN - 3

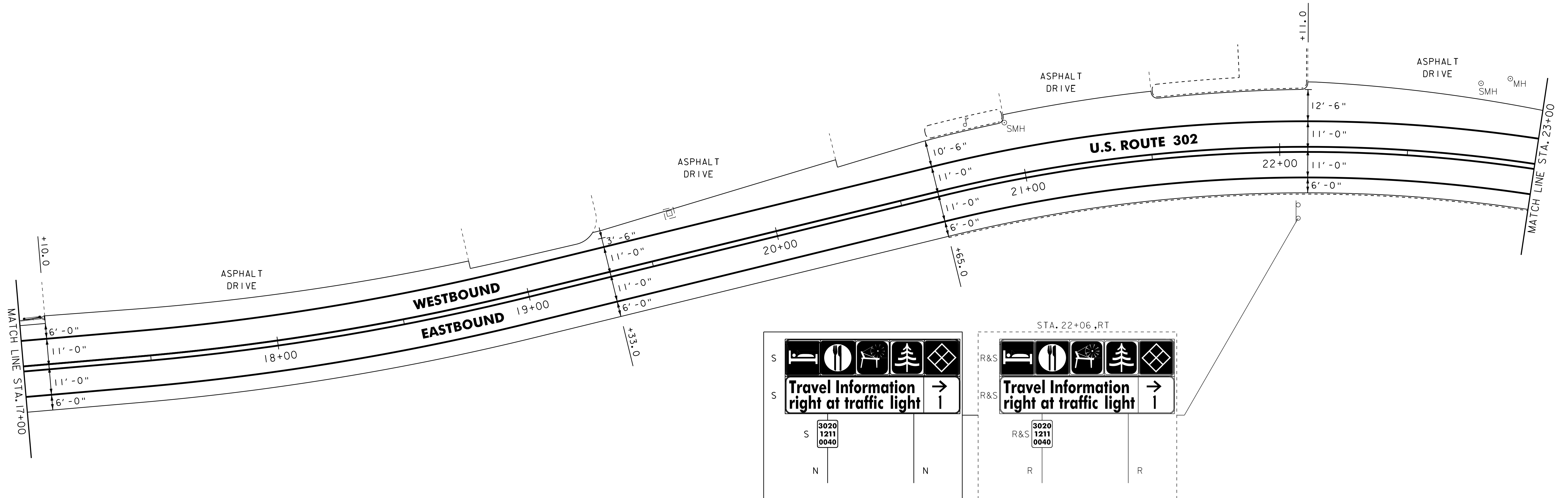

NOTE:  
EXISTING T.I.S. SIGN TO BE REMOVED AND BROUGHT TO THE VAOT TRAFFIC SHOP. A NEW SIGN WILL BE SUPPLIED FROM THE TRAFFIC SHOP. NEW SIGN TO BE INSTALLED ON TWO NEW POSTS ABOVE MILE MARKER PLAQUE AS SHOWN. PLEASE CONTACT BERNADETTE PAPINEAU AT 828-2680 TO MAKE ARRANGEMENTS.

- NOTES:
1. ALL EXISTING SIGNS NOT SHOWN SHALL BE RETAINED AS DIRECTED BY THE RESIDENT ENGINEER.
  2. FOR LEGEND, SEE LAYOUT #1.

NOT TO SCALE



**PROJECT LAYOUT SHEET #3**

PROJECT NAME: MONTPELIER	
PROJECT NUMBER: STP 2618(I)	
FILE NAME: p06d114.dgn	PLOT DATE: 03-AUG-2011 14:11
PROJECT LEADER: JLL	DRAWN BY: STANTEC
DESIGNED BY: MCF	CHECKED BY: JLL
IPARM FILE: p06D114I03.i	SHEET 76 OF 84