

REDUCED STEEL BEAM GUARDRAIL POST SPACING DETAIL

OBJECTS WITHIN 4 FT OF GUARDRAIL (N.T.S.)

STA. 10+95, LT - UTILITY POLE
 STA. 12+11, LT - UTILITY POLE
 STA. 38+81, LT - UTILITY POLE

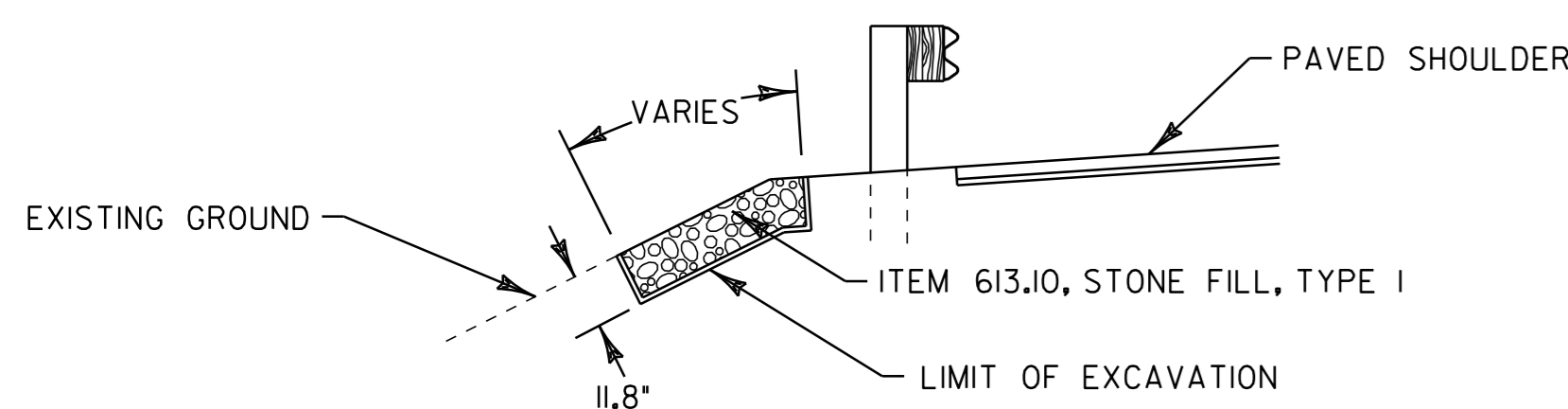

SLOPE EROSION REPAIR DETAIL

(ASSUME A 6' WIDTH)

STA. 12+61, LT.

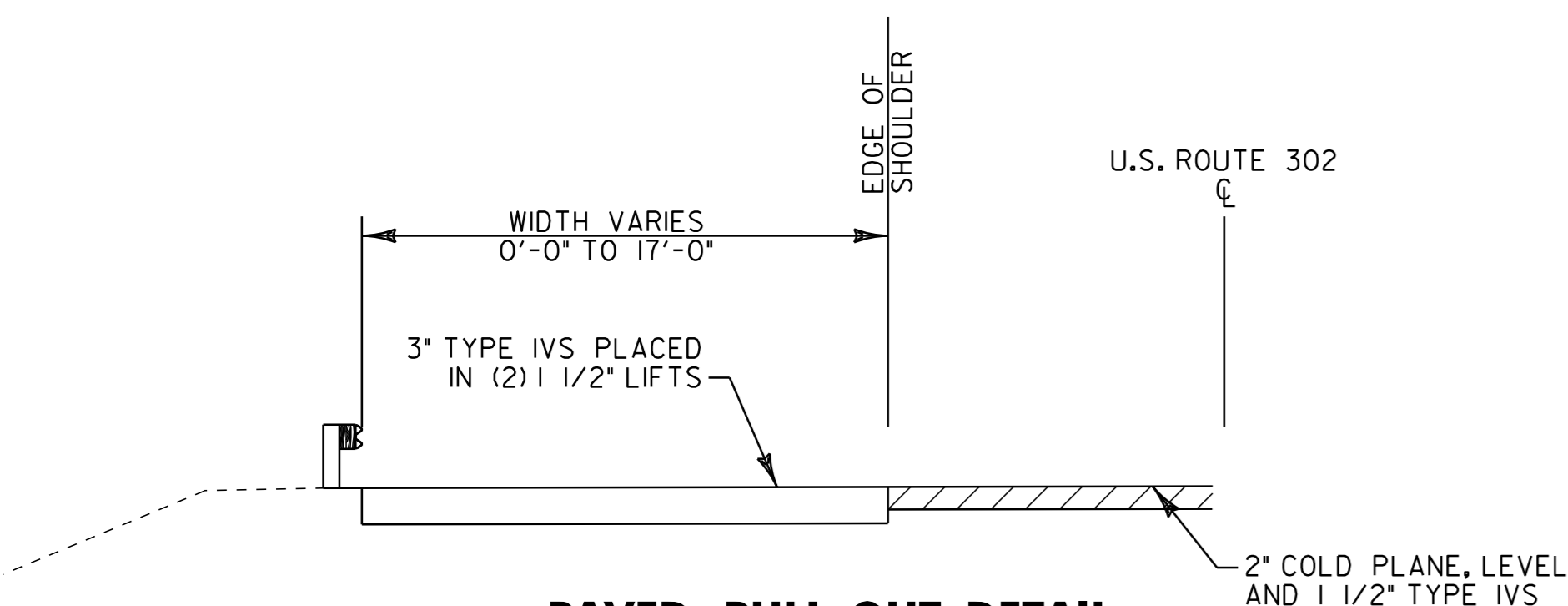

PAVED PULL-OUT DETAIL

STA. 13+95 TO STA. 15+16 LT

NOTES:

1. GRADE EXISTING GRAVEL PULL-OUT AS NECESSARY TO PROVIDE A SMOOTH SURFACE OR AS DIRECTED BY RESIDENT ENGINEER. PAYMENT SHALL BE COVERED BY ITEM 608.15 POWER GRADER RENTAL.
2. AN ESTIMATED QUANTITY OF ITEM 900.675 SPECIAL PROVISION (HAND-PLACED BITUMINOUS CONCRETE MATERIAL, DRIVES) FOR WORK AT BOTH ENDS OF THE PULL-OUT AS DIRECTED BY THE RESIDENT ENGINEER.

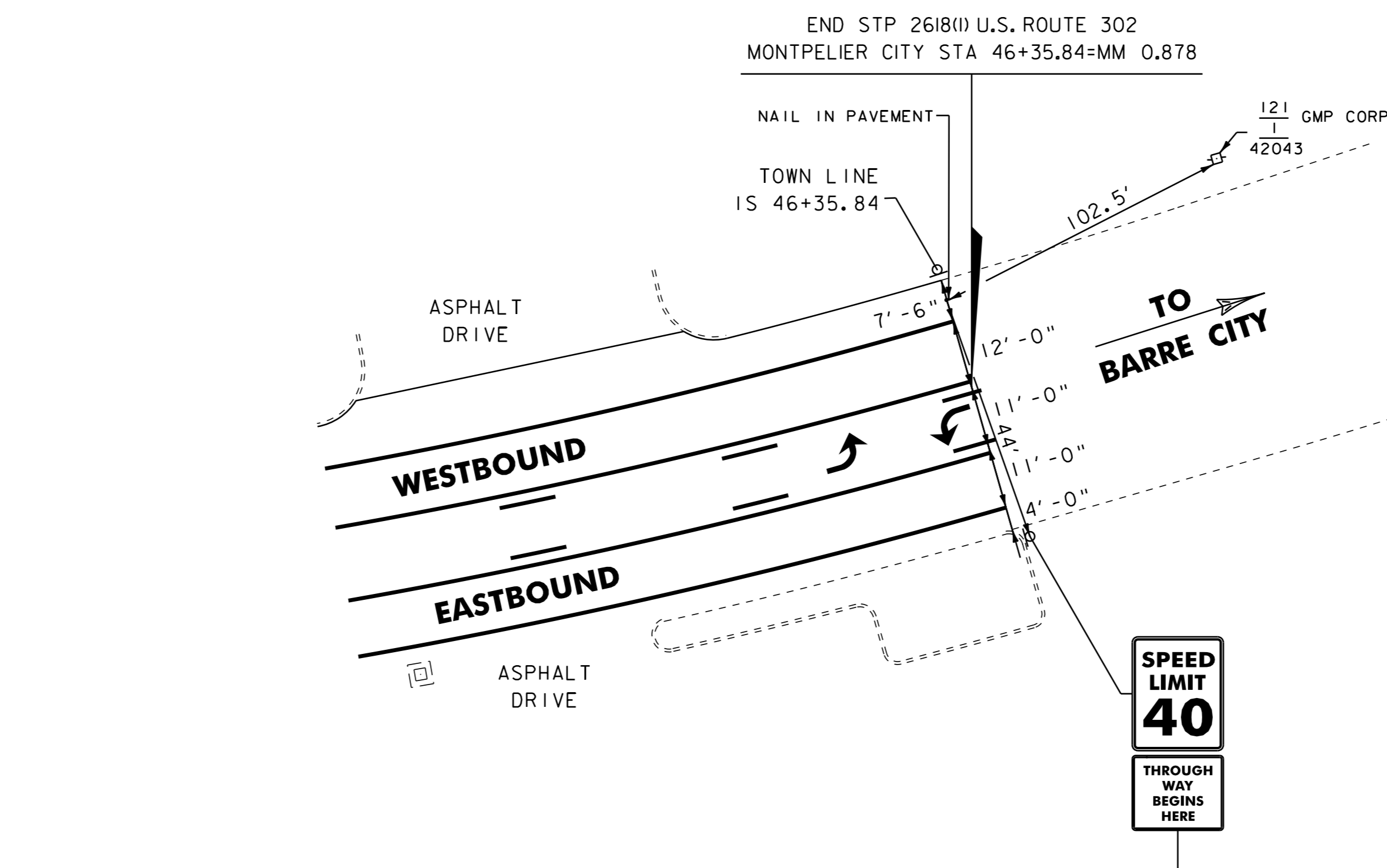
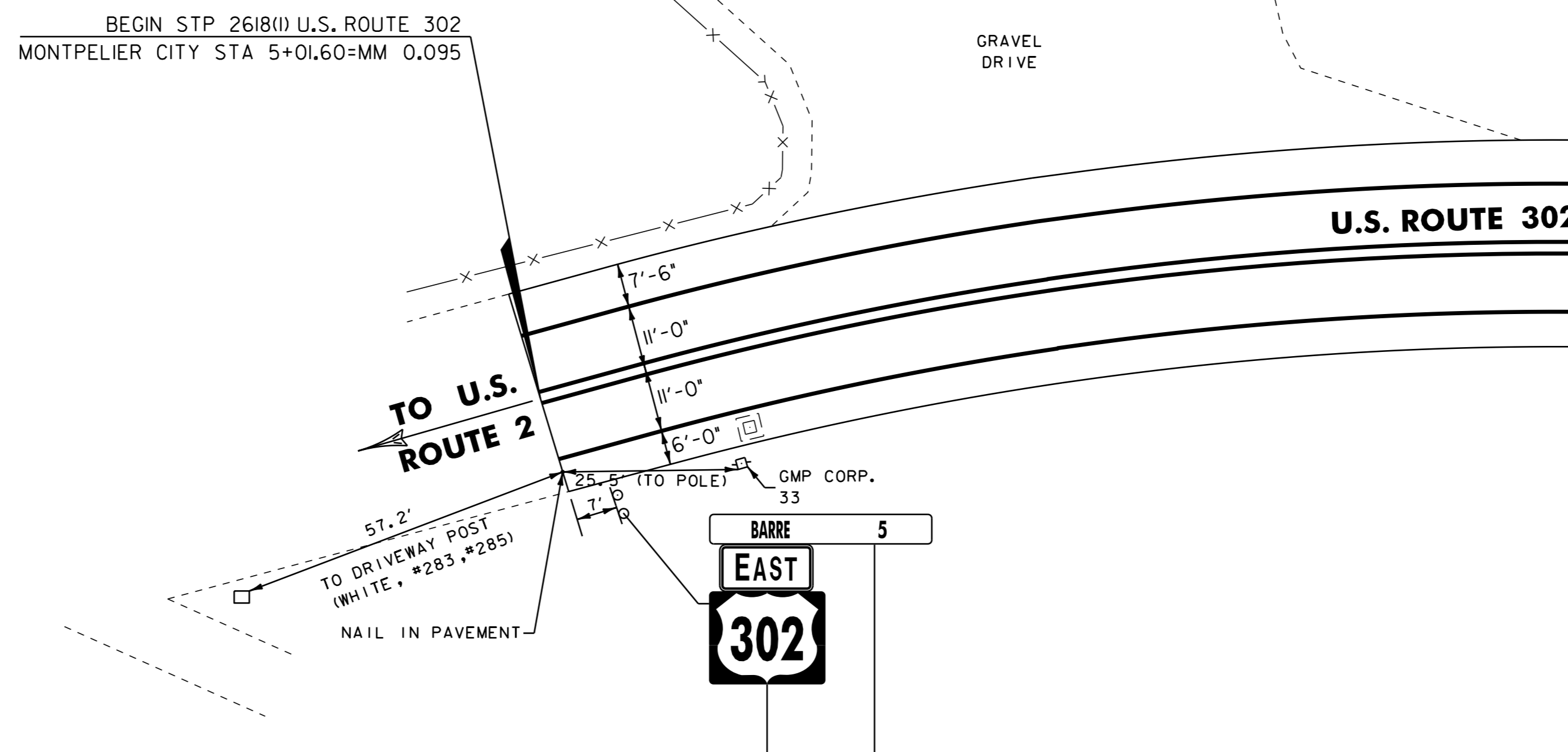

NOT TO SCALE



MISC. DETAILS & UTILITY LOCATIONS

ADJUST ELEVATION OF VALVE BOX

(ITEM 629.20)

U.S. ROUTE 302

STATION	POSITION	DESCRIPTION
23+32	C/L	WSO

REHAB. DI'S, CB'S, OR MH'S, CLASS I, II, OR III

(ITEM 604.412, 604.415 OR 604.418)

U.S. ROUTE 302

STATION	POSITION	DESCRIPTION
5+36	RT	D1
8+10	RT	D1
19+61	LT	D1
23+09	RT	D1
32+43	RT	D1
37+83	RT	D1
38+12	RT	D1
38+23	RT	D1
43+23	LT	D1
45+31	RT	D1

CHANGING ELEVATION OF SEWER MANHOLES

(ITEM 604.42)

U.S. ROUTE 302

STATION	POSITION	DESCRIPTION
10+57	LT	SMH
20+96	LT	SMH
23+77	LT	SMH
24+11	LT	SMH
28+86	LT	SMH
31+17	LT	SMH
32+56	RT	SMH
32+59	LT	SMH
34+60	LT	SMH
37+66	LT	SMH
41+72	RT	SMH

PROJECT NAME: MONTPELIER
 PROJECT NUMBER: STP 2618(I)

FILE NAME: p06d114.dgn
 PROJECT LEADER: JLL
 DESIGNED BY: MCF
 IPARM FILE: p06d114us.i

PLOT DATE: 03-AUG-2011 14:11
 DRAWN BY: STANTEC
 CHECKED BY: JLL
 SHEET 68 OF 84