

# STATE OF VERMONT AGENCY OF TRANSPORTATION

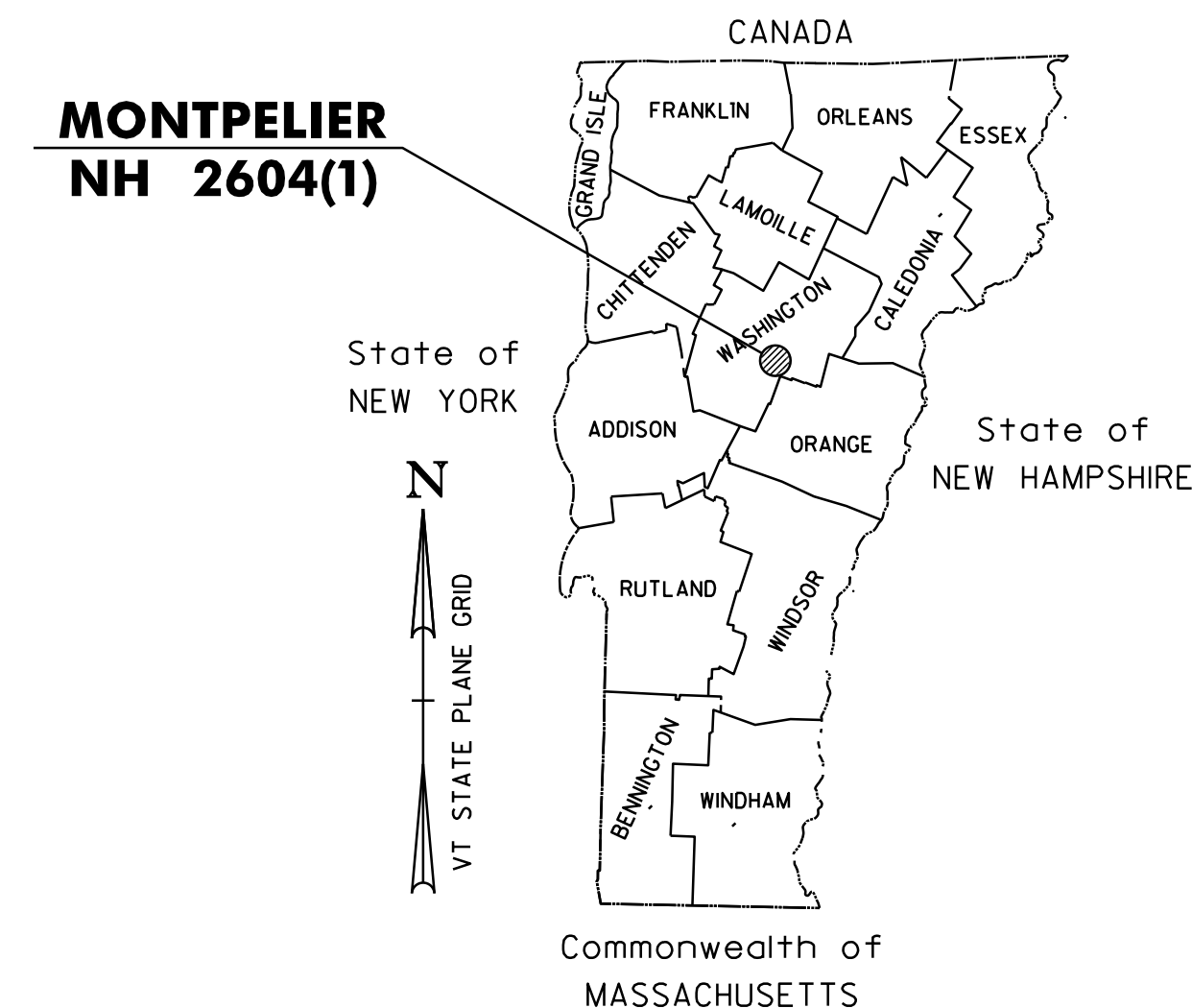

## PROPOSED IMPROVEMENT CLASS I TOWN HIGHWAY CITY OF MONTPELIER COUNTY OF WASHINGTON U.S. ROUTE 2

BEGINNING IN THE CITY OF MONTPELIER ON U.S. ROUTE 2 AT STA. 86+80.32 (MM 1.644) AND EXTENDING EASTERLY ALONG U.S. ROUTE 2 FOR A DISTANCE OF 9,282.24 FEET (1.758 MILES) TO STA. 179+62.56 (MM 3.402), AND THEN CONTINUING ON U.S. ROUTE 2 FROM STA. 221+12.64 (MM 4.188) FOR A DISTANCE OF 1,325.28 FEET (0.251 MILE) TO STA. 234+37.92 (MM 4.439).



BITUMINOUS CONCRETE PAVEMENT SUPERPAVE MIXTURE DESIGN CRITERIA	
DESIGN LANE/DESIGN LIFE ESALS	3,822,500
DESIGN NUMBER OF GYRATIONS	75
PERFORMANCE GRADED ASPHALT BINDER	70-28

### TRAFFIC DATA U.S. ROUTE 2

LOCATION	AADT		DHV		ESALS	
	2009	2019	2009	2019	2009-2019	2009-2019
<b>US ROUTE 2</b>						
BEGIN PROJECT TO MONTPELIER STATE HIGHWAY	9,900	10,400	1,100	1,200	895,000	2,163,000
MONTPELIER STATE HIGHWAY TO MAIN/NORTHFIELD ST.	12,300	12,900	1,400	1,400	2,267,000	5,678,000
MAIN/NORTHFIELD ST. TO BERLIN ST.	17,100	18,000	1,900	2,000	2,756,000	6,990,000
BERLIN ST. TO PIONEER ST.	11,900	12,500	1,300	1,400	2,180,000	5,081,000
PIONEER ST. TO US 302	16,100	16,900	1,800	1,800	3,048,000	7,703,000
US 302 TO GALLISON HILL RD.	10,800	11,300	1,200	1,300	3,059,000	7,645,000
GALLISON HILL RD. TO END PROJECT	9,500	10,000	1,100	1,100	2,468,000	5,681,000
<b>MONTPELIER STATE HIGHWAY</b>						
BEGIN PROJECT TO BAILEY AVE.	12,600	13,300	1,900	2,000	1,558,000	3,344,000

PROJECT DATA:	LENGTH (FEET)	LENGTH (MILES)
CITY OF MONTPELIER		
U.S. ROUTE 2		
STA. 86+80.32 TO 179+62.56	9,282.24	
MM 1.644 TO 3.402		1.758
STA 221+12.64 TO 234+37.92	1,325.28	
MM 4.188 TO 4.439		0.251

TOTAL LENGTH OF PROJECT: 10,607.52 FEET = 2.009 MILES  
TOTAL LENGTH OF ROADWAY: 14,757.60 FEET = 2.795 MILES

WORK TO BE PERFORMED UNDER THIS PROJECT INCLUDES COLD PLANING AND RESURFACING OF THE EXISTING HIGHWAY WITH A LEVELING AND WEARING COURSE, NEW PAVEMENT MARKINGS, GUARD RAIL, SIGNS AND OTHER INCIDENTAL ITEMS

### CONVENTIONAL SYMBOLS

COUNTY LINE	
TOWN LINE	
LIMITS OF ACCESS	
POINT OF ACCESS	
FENCE LINE	
STONE WALL	
TRAVELED WAY	
GUARD RAIL	
RAILROAD	
SURVEY LINE	
CULVERT	
POWER POLE	
TELEPHONE POLE	
TREES	
CONTROL OF ACCESS	
PROPERTY LINE	
R.O.W. TAKING LINE	
SLOPE RIGHTS	
TOP OF CUT	
TOE OF SLOPE	

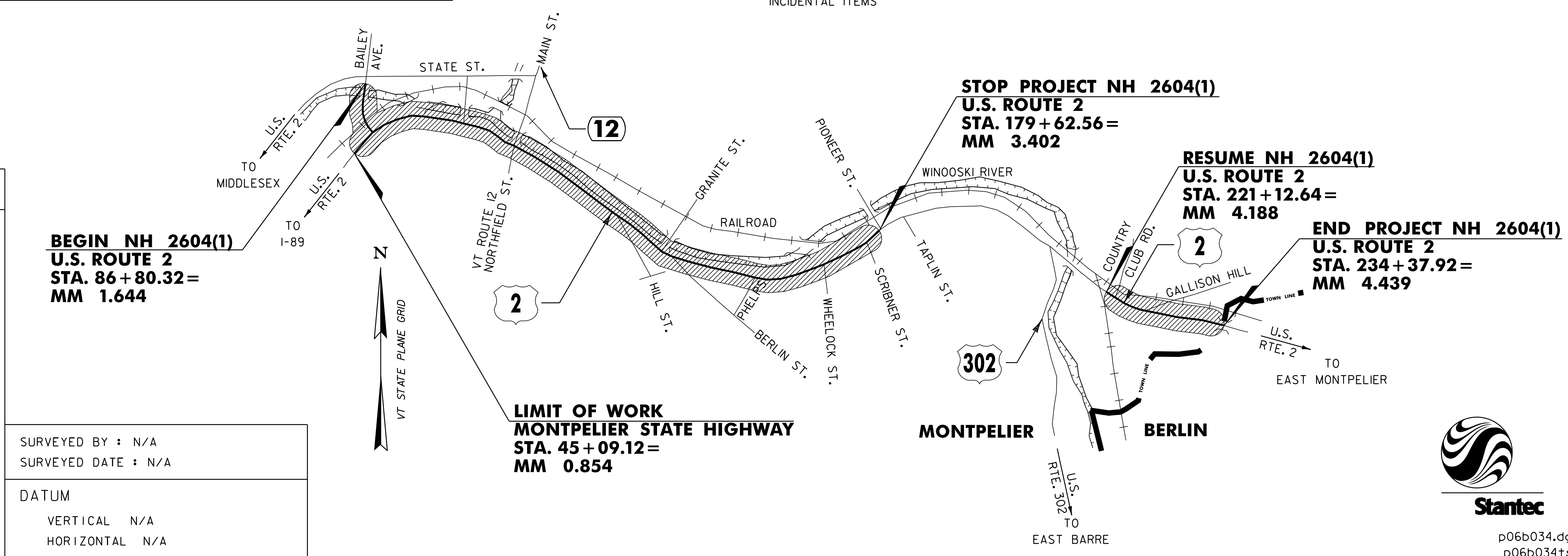

RIGHT-OF-WAY LIMITS, IF APPLICABLE, ARE PROVIDED SOLELY FOR THE CONVENIENCE OF THE STATE AND ITS CONTRACTOR DURING THE COURSE OF THIS PAVING PROJECT. ANY REFERENCES TO OFFSETS ON THESE PLANS ARE APPROXIMATE AND SHOULD NOT BE RELIED UPON FOR ANY PURPOSES.

THESE PLANS ARE SUBJECT TO SUCH ENGINEERING CHANGES AS MAY BE REQUIRED BY THE FEDERAL HIGHWAY ADMINISTRATION OR THE DIRECTOR OF PROGRAM DEVELOPMENT.

CONSTRUCTION IS TO BE CARRIED ON IN ACCORDANCE WITH THESE PLANS AND THE STANDARD SPECIFICATIONS FOR CONSTRUCTION DATED 2006, AS APPROVED BY THE FEDERAL HIGHWAY ADMINISTRATION ON JUNE 15, 2006 FOR USE ON THIS PROJECT, INCLUDING ALL SUBSEQUENT REVISIONS AND SUCH REVISED SPECIFICATIONS AND SPECIAL PROVISIONS AS ARE INCORPORATED IN THESE PLANS.

UNLESS OTHERWISE NOTED, ALL DRAWINGS AND DETAILS ON THESE PLANS ARE DRAWN "NOT TO SCALE".

p06b034.dgn  
p06b034ts.i

PROJECT NAME :	MONTPELIER
PROJECT NUMBER :	NH 2604(1)
SHEET	7 OF 84 SHEETS