

STATE OF VERMONT AGENCY OF TRANSPORTATION



PROPOSED IMPROVEMENT BRIDGE PROJECT TOWN OF RANDOLPH COUNTY OF ORANGE

ROUTE NO: TH 66, CL.3 BRIDGE NO: 34

PROJECT LOCATION: ON TH 66 BEGINNING APPROXIMATELY 0.042 MILES EAST FROM ITS INTERSECTION WITH VT 14 AND EXTENDING EASTERLY APPROXIMATELY 0.009 MILES.

PROJECT DESCRIPTION: REHABILITATION OF THE GIFFORD COVERED BRIDGE, INCLUDING TIMBER SUPERSTRUCTURE, SUBSTRUCTURE, AND PERMANENT SHEETING WORK.

LENGTH OF STRUCTURE: 50.0 ± FEET
LENGTH OF PROJECT: 50.0 ± FEET

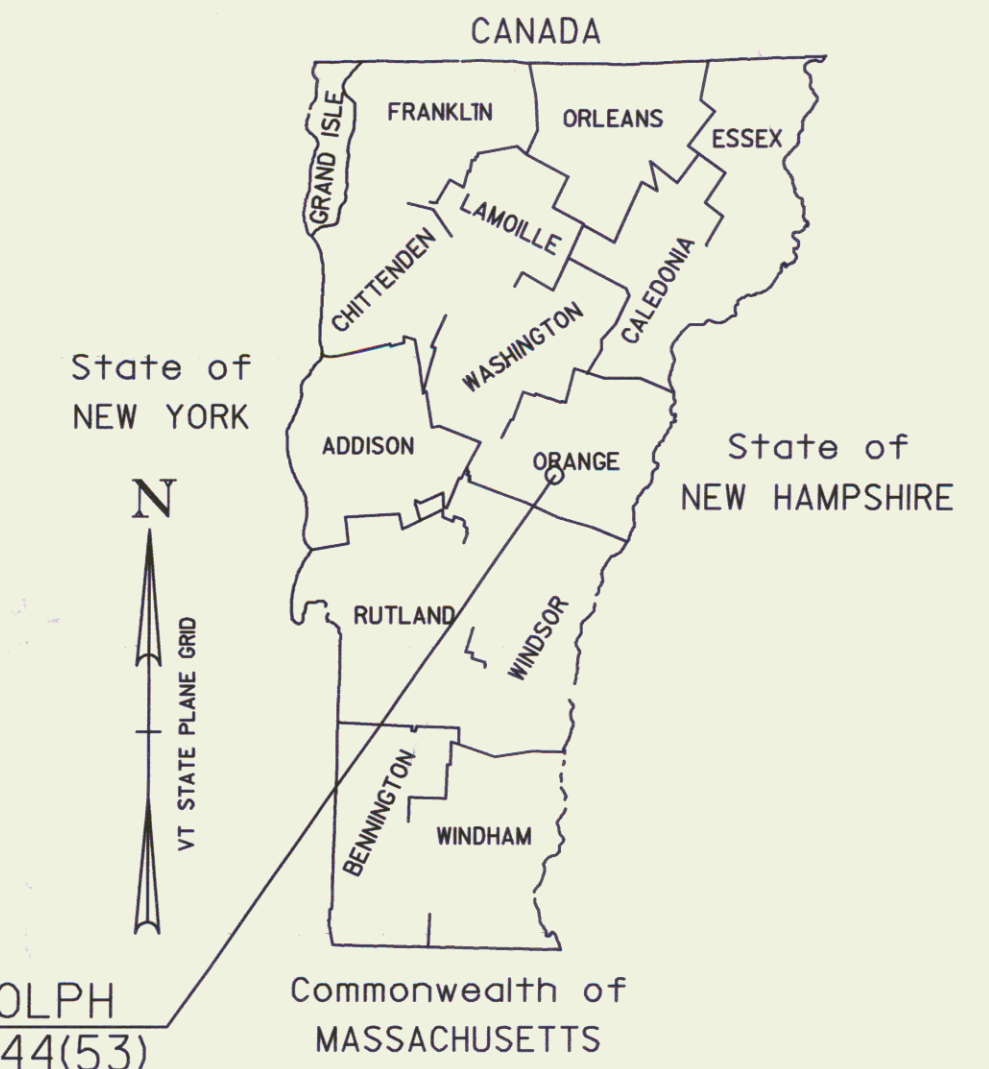
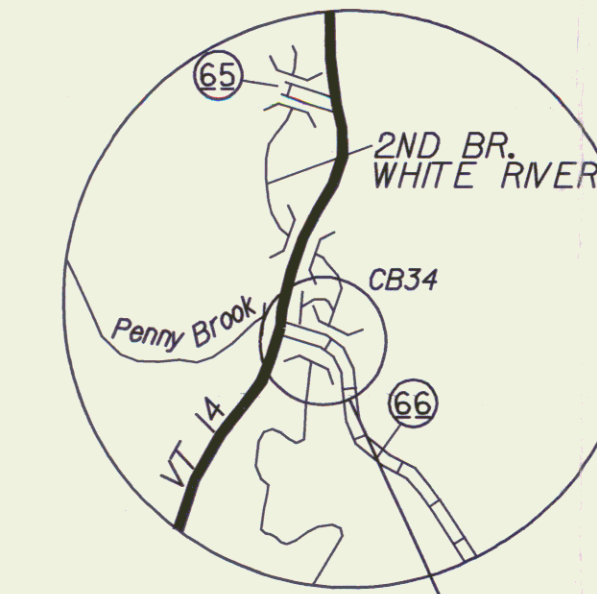
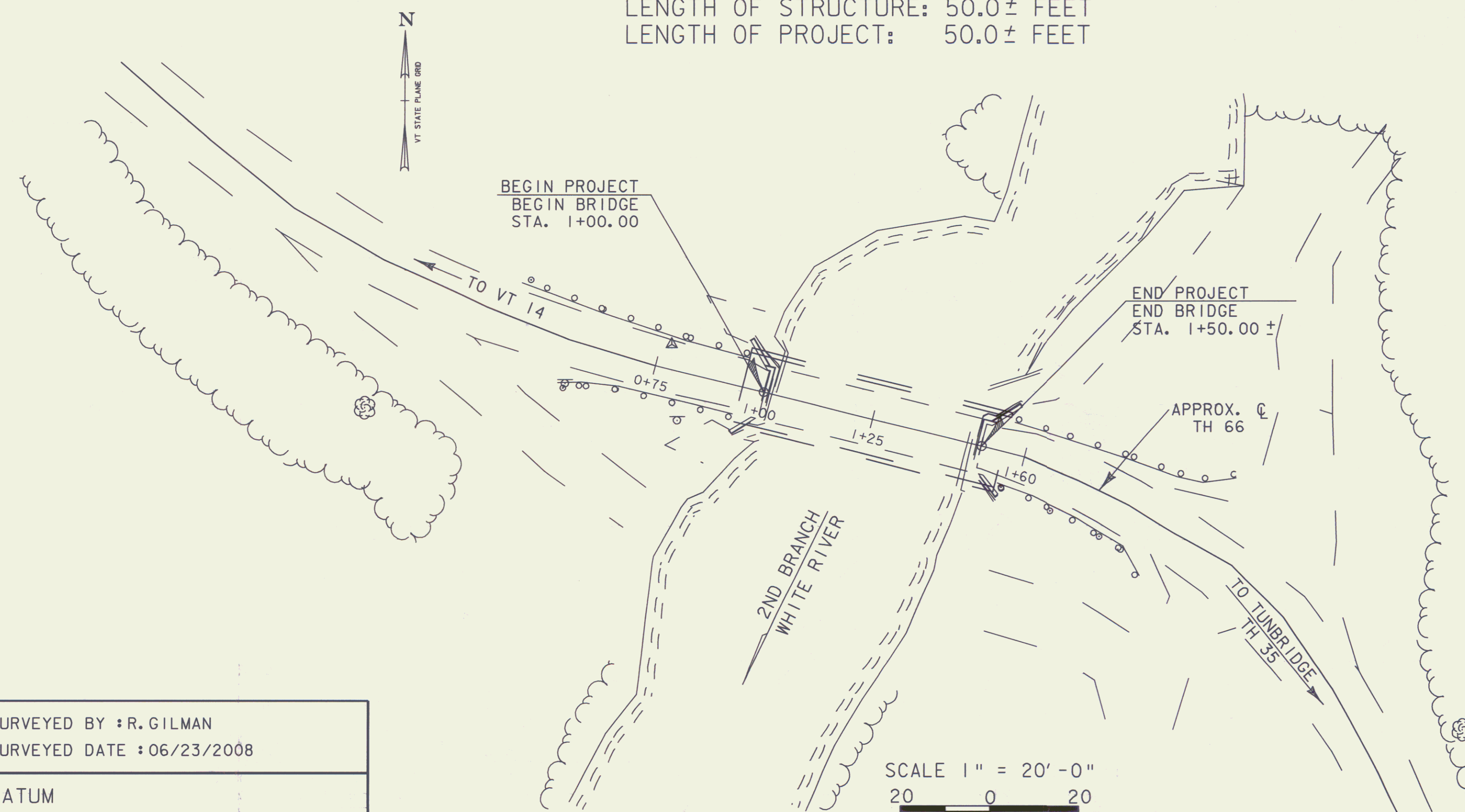

RECORD PLANS	
CONTRACTOR:	WRIGHT CONSTRUCTION, INC.
RESIDENT ENGINEER:	CHARLIE HARDING
CONSTRUCTION BEGAN:	MAY 16, 2011
CONSTRUCTION COMPLETE:	SEPTEMBER 21, 2012
RECORD PLANS BY:	CHARLIE HARDING & STEPHEN KENT
I HEREBY CERTIFY THAT ALL THE CONSTRUCTION REQUIRED BY THIS SET OF DRAWINGS HAS BEEN ACCOMPLISHED AS INDICATED HEREIN.	
BY: <i>Charlie Harding</i>	RESIDENT ENGINEER
DATE: <i>5/23/13</i>	
NOTE: Any further information concerning final quantities, amounts or other details relative to this project may be found at Central Files in the electronic archives.	

INDEX OF SHEETS

1. TITLE SHEET
2. TYPICAL SECTIONS AND PROJECT DATA
- 3-4. QUANTITY SHEETS
5. PROJECT NOTES
6. TIE SHEET
7. LAYOUT SHEET
8. PROFILE AND ELEVATION SHEET
9. RESOURCE SHEET
10. EPSC NARRATIVE
11. EPSC LAYOUT SHEET
- 12-13. EPSC DETAIL SHEETS
14. PLAN SHEET
15. DECK & FLOOR FRAMING DETAILS
16. TRUSS DETAILS
17. GLULAM BEAM DETAILS
18. MISCELLANEOUS DETAILS
19. UPPER BRACING DETAILS
20. ROOF DETAILS
21. EAST ABUTMENT DETAILS
22. WEST ABUTMENT DETAILS
23. REINFORCING STEEL SCHEDULE
- 24-25. BORINGS SHEETS
26. SIGN SUMMARY SHEET
27. ROADWAY CROSS SECTIONS

VAOT STANDARD SHEETS

E-100A	01/02/04
E-102	06/30/03
E-102A	05/01/04
E-107	06/30/03
E-107A	06/08/09
E-121	08/08/95
E-141	09/20/95
E-146	09/20/95
E-155	05/01/04
E-164	05/20/99

CONVENTIONAL SYMBOLS

COUNTY LINE	
TOWN LINE	
LIMITS OF ACCESS	
POINT OF ACCESS	
FENCE LINE	
STONE WALL	
TRAVELED WAY	
GUARD RAIL	
RAILROAD	
SURVEY LINE	
CULVERT	
POWER POLE	
TELEPHONE POLE	
TREES	
CONTROL OF ACCESS	
PROPERTY LINE	
R.O.W. TAKING LINE	
SLOPE RIGHTS	
TOP OF CUT	
TOE OF SLOPE	

SURVEYED BY: R. GILMAN
SURVEYED DATE: 06/23/2008

DATUM
VERTICAL NAVD 88
HORIZONTAL NAD 83 (96)

SCALE 1" = 20'-0"
20 0 20

THESE PLANS ARE SUBJECT TO SUCH ENGINEERING CHANGES AS MAY BE REQUIRED BY THE FEDERAL HIGHWAY ADMINISTRATION OR THE DIRECTOR OF PROGRAM DEVELOPMENT.
CONSTRUCTION IS TO BE CARRIED ON IN ACCORDANCE WITH THESE PLANS AND THE STANDARD SPECIFICATIONS FOR CONSTRUCTION DATED 2006, AS APPROVED BY THE FEDERAL HIGHWAY ADMINISTRATION ON JUNE 15, 2006 FOR USE ON THIS PROJECT, INCLUDING ALL SUBSEQUENT REVISIONS AND SUCH REVISED SPECIFICATIONS AND SPECIAL PROVISIONS AS ARE INCORPORATED IN THESE PLANS.

DIRECTOR OF PROGRAM DEVELOPMENT	
APPROVED: <i>John D. Stewart</i>	DATE: 9-17-10
PROJECT MANAGER: M. SARGENT	
PROJECT NAME: RANDOLPH	
PROJECT NUMBER: BHO 1444 (53)	
SHEET 1 OF 27 SHEETS	