

10 EQUAL SPACES @ 9'-9 5/8 (ABT) = BL
CAMBER DIAGRAM FOR 1G1A THRU 7G7A

MARK	TL	BL	RE	WL2	WX2	SP1	TBR	BBR	C1	C2	C3	C4	C5	C6	C7	C8	C9
1G1A	97'-11 11/16	97'-11 7/8	3/16	43'-9 7/8	43'-9 15/16	7/8	19'-11 1/2	20'-0 1/16	7/8	1 1/2	1 13/16	1 11/16	1 1/4	1 1/2	3/8	1 1/8	9/16
2G2A	97'-11 3/4	97'-11 13/16	1/16	43'-9 13/16	43'-9 7/8	7/8	19'-11 1/16	20'-0	7/8	1 1/2	1 13/16	1 11/16	1 1/4	1 1/2	3/8	1 1/8	5/8
3G3A	97'-11 3/4	97'-11 7/8	1/8	43'-9 7/8	43'-9 15/16	13/16	19'-11 9/16	20'-0 1/16	7/8	1 1/2	1 3/4	1 11/16	1 3/16	1 1/2	7/16	1 1/8	5/8
4G4A	97'-11 3/4	97'-11 7/8	1/8	43'-9 7/8	43'-9 15/16	13/16	19'-11 9/16	20'-0 1/16	7/8	1 1/2	1 3/4	1 11/16	1 3/16	1 1/2	7/16	1 1/8	5/8
5G5A	97'-11 3/4	97'-11 7/8	1/8	43'-9 7/8	43'-9 15/16	7/8	19'-11 9/16	20'-0 1/16	7/8	1 1/2	1 3/4	1 11/16	1 1/4	1 1/2	7/16	1 1/8	5/8
6G6A	97'-11 11/16	97'-11 7/8	3/16	43'-9 7/8	43'-9 15/16	7/8	19'-11 1/2	20'-0 1/16	7/8	1 1/2	1 13/16	1 11/16	1 1/4	1 1/2	3/8	1 1/8	9/16
7G7A	97'-11 11/16	97'-11 7/8	3/16	43'-9 7/8	43'-9 15/16	7/8	19'-11 1/2	20'-0 1/16	7/8	1 1/2	1 13/16	1 11/16	1 1/4	1 1/2	3/8	1 1/8	9/16

1G1A	PL 1/8 x 16 x 58'-8 - ta (M270-50WT2 H2-3) 1/R	PL 1/8 x 16 x 39'-9 11/16 - tb (M270-50WT2 H2-3) 1/C
2G2A	PL 1/8 x 16 x 58'-8 - ta (M270-50WT2 H2-3) 1/R	PL 1/8 x 16 x 39'-9 3/4 - tb (M270-50WT2 H2-3) 1/C
3G3A	PL 1/8 x 16 x 58'-8 - ta (M270-50WT2 H2-3) 1/R	PL 1/8 x 16 x 39'-9 3/4 - tb (M270-50WT2 H2-3) 1/C
4G4A	PL 1/8 x 16 x 58'-8 - ta (M270-50WT2 H2-3) 1/R	PL 1/8 x 16 x 39'-9 3/4 - tb (M270-50WT2 H2-3) 1/C
5G5A	PL 1/8 x 16 x 58'-8 - ta (M270-50WT2 H2-3) 1/R	PL 1/8 x 16 x 39'-9 3/4 - tb (M270-50WT2 H2-3) 1/C
6G6A	PL 1/8 x 16 x 58'-8 - ta (M270-50WT2 H2-3) 1/R	PL 1/8 x 16 x 39'-9 11/16 - tb (M270-50WT2 H2-3) 1/C
7G7A	PL 1/8 x 16 x 58'-8 - ta (M270-50WT2 H2-3) 1/R	PL 1/8 x 16 x 39'-9 11/16 - tb (M270-50WT2 H2-3) 1/C

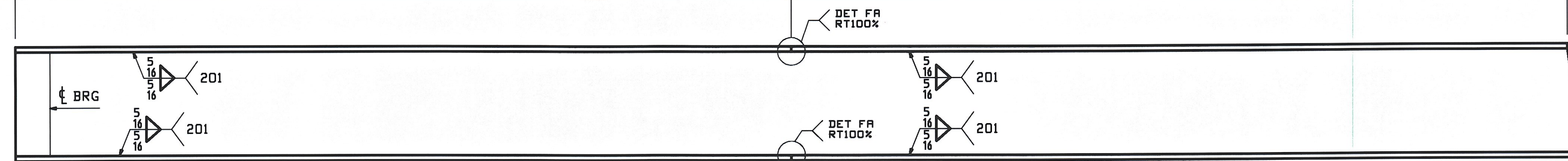

1G1A	PL 1/8 x 16 x 58'-8 - ba (M270-50WT2 H2-3) 1/R	PL 1/8 x 16 x 39'-9 7/8 - bb (M270-50WT2 H2-3) 1/C
2G2A	PL 1/8 x 16 x 58'-8 - ba (M270-50WT2 H2-3) 1/R	PL 1/8 x 16 x 39'-9 13/16 - bb (M270-50WT2 H2-3) 1/C
3G3A	PL 1/8 x 16 x 58'-8 - ba (M270-50WT2 H2-3) 1/R	PL 1/8 x 16 x 39'-9 7/8 - bb (M270-50WT2 H2-3) 1/C
4G4A	PL 1/8 x 16 x 58'-8 - ba (M270-50WT2 H2-3) 1/R	PL 1/8 x 16 x 39'-9 7/8 - bb (M270-50WT2 H2-3) 1/C
5G5A	PL 1/8 x 16 x 58'-8 - ba (M270-50WT2 H2-3) 1/R	PL 1/8 x 16 x 39'-9 7/8 - bb (M270-50WT2 H2-3) 1/C
6G6A	PL 1/8 x 16 x 58'-8 - ba (M270-50WT2 H2-3) 1/R	PL 1/8 x 16 x 39'-9 7/8 - bb (M270-50WT2 H2-3) 1/C
7G7A	PL 1/8 x 16 x 58'-8 - ba (M270-50WT2 H2-3) 1/R	PL 1/8 x 16 x 39'-9 7/8 - bb (M270-50WT2 H2-3) 1/C

FLANGE DIAGRAM FOR 1G1A THRU 7G7A

RECEIVED
 CND BY DRP OK'D BY [Signature]
 JUN 24 2009
 RESUBMIT APPROVED
 BY CWC DATE 7-13-09

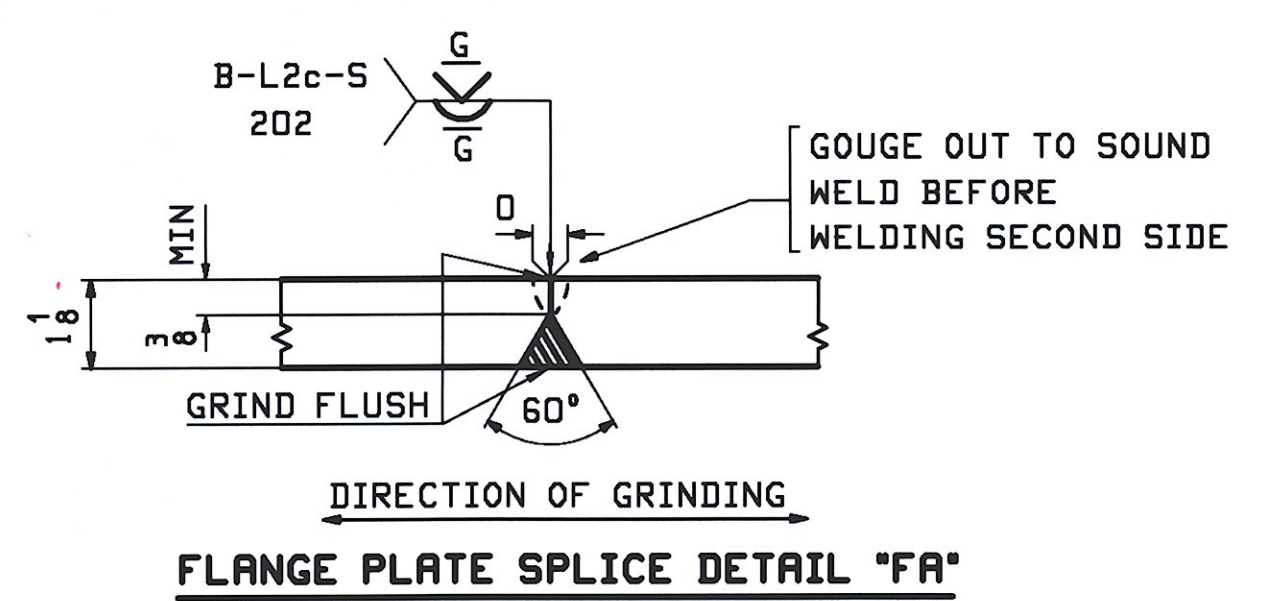
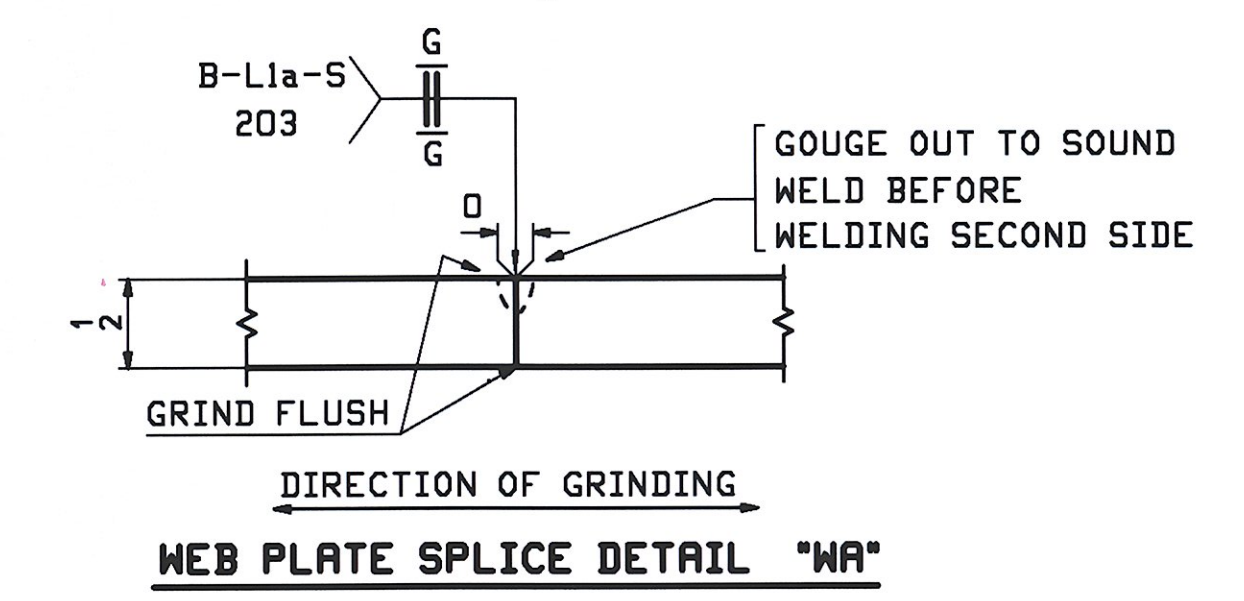

- NOTES:**
- FOR GENERAL NOTES SEE DWG GNI.
 - H2-3 DENOTES MATERIAL SUBJECT TO CHARPY V-NOTCH TEST AT H FREQ. FOR ZONE 2

REV.	DATE	REMARKS	DWN	CHK	APVL	SHOP
0						
MATERIAL:		SURFACE PREP. & PAINT:		HOLES:		SHOP BOLTS:
AS NOTED		SEE GNI		NONE		NONE
DESCRIPTION: CAMBER & FLANGE DIAGRAMS						
CASCO BAY STEEL STRUCTURES, INC.						
75 SPRING HILL ROAD			SACO, MAINE 04072		[Logo]	
PHONE (207) 282-7360			FAX (207) 282-1179		TENSOR 2879	
STRUCTURE: VT 11 OVER BLACK RIVER BRIDGE NO. 64 SPRINGFIELD, VERMONT COUNTY OF WINDSOR					DRAWN: WJF	DATE: 06/08
					CHKD: RLA	DATE: 06/16
LOCATION: TOWN OF SPRINGFIELD					JOB NO. 406-1	DWG NO. C1
PROJ NO. BHF 016-2(14)						
CUSTOMER: COLD RIVER BRIDGES, LLC						REV. [Signature]

File: Job 16_2009 0228262.dwg /cassio/2009/0228262/C1.dwg