

NEW SIDEWALK RAMP TYPE 1
 257+49.25 RT
 259+66.04 LT
 259+77.35 RT

NEW SIDEWALK RAMP TYPE 6
 257+86.15 LT
 257+86.90 RT

ADJUST ELEVATION OF VALVE BOX
 256+85.88 LT
 257+09.30 LT
 257+30.66 LT
 259+81.07 LT
 259+99.52 RT

M CURVE DATA NO. 1
 DELTA = 64°46'09" RT.
 D = 57°17'45"
 R = 100.00'
 T = 63.42'
 L = 113.04' Δ
 E = 18.42'

CHANGING ELEVATION OF DROP INLETS, CATCH BASINS, OR MANHOLES
 256+99 RT 260+34 RT
 257+19 LT 260+58 RT
 259+75 RT 260+85 LT

CAST IRON GRATE WITH FRAME, TYPE D
 259+51.25 RT
 259+57.29 LT
TRENCH DRAIN
 260+10 - 260+22 LT
 260+25 - 260+34 RT

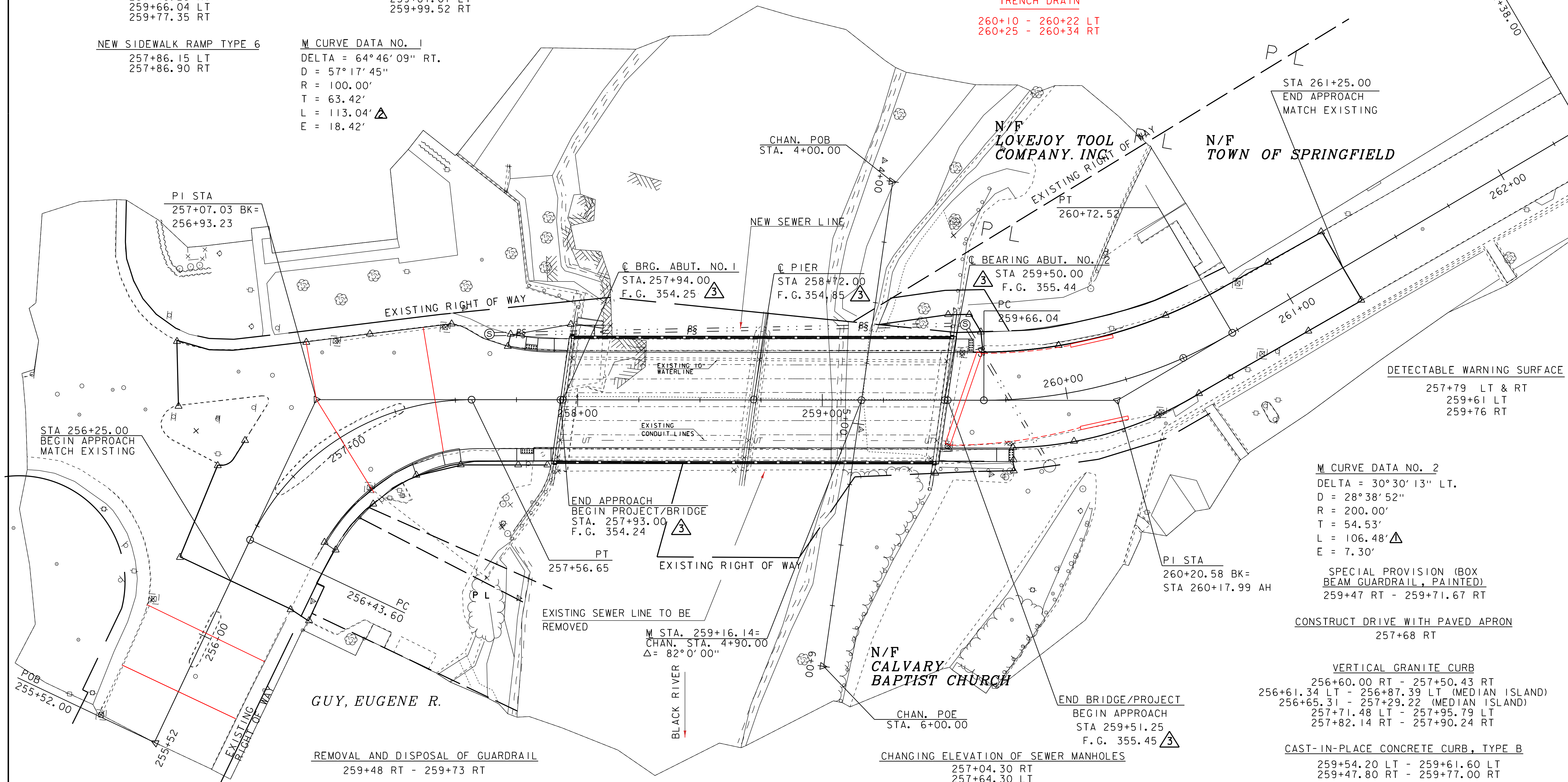
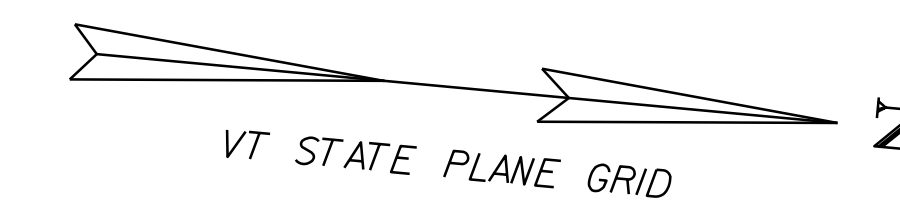

STA 256+25.00
 BEGIN APPROACH
 MATCH EXISTING

PI STA
 257+07.03 BK=
 256+93.23

BRG. ABUT. NO. 1
 STA. 257+94.00
 F.G. 354.25

PIER
 STA 258+72.00
 F.G. 354.85

BEARING ABUT. NO. 2
 STA 259+50.00
 F.G. 355.44

STA 261+25.00
 END APPROACH
 MATCH EXISTING

DETECTABLE WARNING SURFACE
 257+79 LT & RT
 259+61 LT
 259+76 RT

M CURVE DATA NO. 2
 DELTA = 30°30'13" LT.
 D = 28°38'52"
 R = 200.00'
 T = 54.53'
 L = 106.48' Δ
 E = 7.30'

SPECIAL PROVISION (BOX BEAM GUARDRAIL, PAINTED)
 259+47 RT - 259+71.67 RT

CONSTRUCT DRIVE WITH PAVED APRON
 257+68 RT

VERTICAL GRANITE CURB
 256+60.00 RT - 257+50.43 RT
 256+61.34 LT - 256+87.39 LT (MEDIAN ISLAND)
 256+65.31 - 257+29.22 (MEDIAN ISLAND)
 257+71.48 LT - 257+95.79 LT
 257+82.14 RT - 257+90.24 RT

CAST-IN-PLACE CONCRETE CURB, TYPE B
 259+54.20 LT - 259+61.60 LT
 259+47.80 RT - 259+77.00 RT

REMOVAL AND DISPOSAL OF GUARDRAIL
 259+48 RT - 259+73 RT

BITUMINOUS CONCRETE GUTTERS AND TRAFFIC ISLANDS
 256+73 LT - 256+87.50 LT

SPECIAL PROVISION, (BRIDGE RAILING REPAIR, PIPE AND SPINDLE)
 257+97 LT - 259+54 LT
 257+90 RT - 259+47 RT

PORTLAND CEMENT CONCRETE SIDEWALK, 5 INCH
 256+60 RT - 257+89.80 RT
 257+71.50 LT - 257+96 LT
 259+47.80 RT - 259+77.00 RT
 259+54.20 LT - 259+61.60 LT

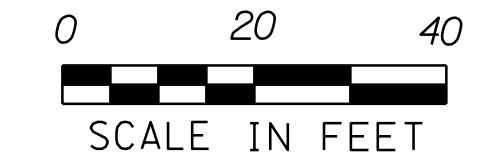

REV.	BY	DATE	DESCRIPTION
Δ	DRP	4/24/09	REVISED LENGTH (L) OF CURVE NO. 2
Δ	DRP	4/27/09	REVISED LENGTH (L) OF CURVE NO. 1
Δ	LBB	5/26/09	REVISED ELEVATIONS

PROJECT NAME:	SPRINGFIELD
PROJECT NUMBER:	BHF 016-2 (14)
FILE NAME:	006j004/str/s06j004bdr.dgn
PLOT DATE:	03-APR-2012 11:20
PROJECT LEADER:	R. WHITCOMB
DRAWN BY:	D. PETERSON
DESIGNED BY:	D. PETERSON
CHECKED BY:	C. CARLSON
LAYOUT SHEET	SHEET 10 OF 72