

CURVE AR-1	CURVE AR-2	CURVE AR-3	CURVE A-8	CURVE MP-3	CURVE MP-4
P.C. = STA. ARI+012.283 P.R.C. = STA. ARI+080.051	P.R.C. = STA. ARI+080.051 P.R.C. = STA. ARI+07.877	P.R.C. = STA. ARI+07.877 P.R.C. = STA. ARI+81.542	P.C. = STA. 3+108.049 P.T. = STA. 3+400.000	P.C. = STA. MPI+570.642 P.C.C. = STA. MPI+615.155	P.C.C. = STA. MPI+615.155 P.T. = STA. MPI+688.695
$\Delta = 15^\circ 31' 52.4''$ RT. R=250.000 m T=34.093 m L=67.768 m E=2.314 m	$\Delta = 15^\circ 56' 36.0''$ LT. R=100.000 m T=14.004 m L=27.826 m E=0.976 m	$\Delta = 16^\circ 52' 57.6''$ RT. R=250.000 m T=37.101 m L=73.665 m E=2.738 m	$\Delta = 8^\circ 20' 55.5''$ LT. R=2003.600 m T=146.234 m L=291.951 m E=5.329 m	$\Delta = 25^\circ 30' 15.5''$ RT. R=100.000 m T=22.632 m L=44.513 m E=2.529 m	$\Delta = 63^\circ 50' 30.2''$ RT. R=66.000 m T=41.115 m L=73.540 m E=11.759 m
$\ominus_{max} = N/A$	$\ominus_{max} = N/A$	$\ominus_{max} = N/A$	$\ominus_{max} = N/A$	$\ominus_{max} = N/A$	$\ominus_{max} = N/A$

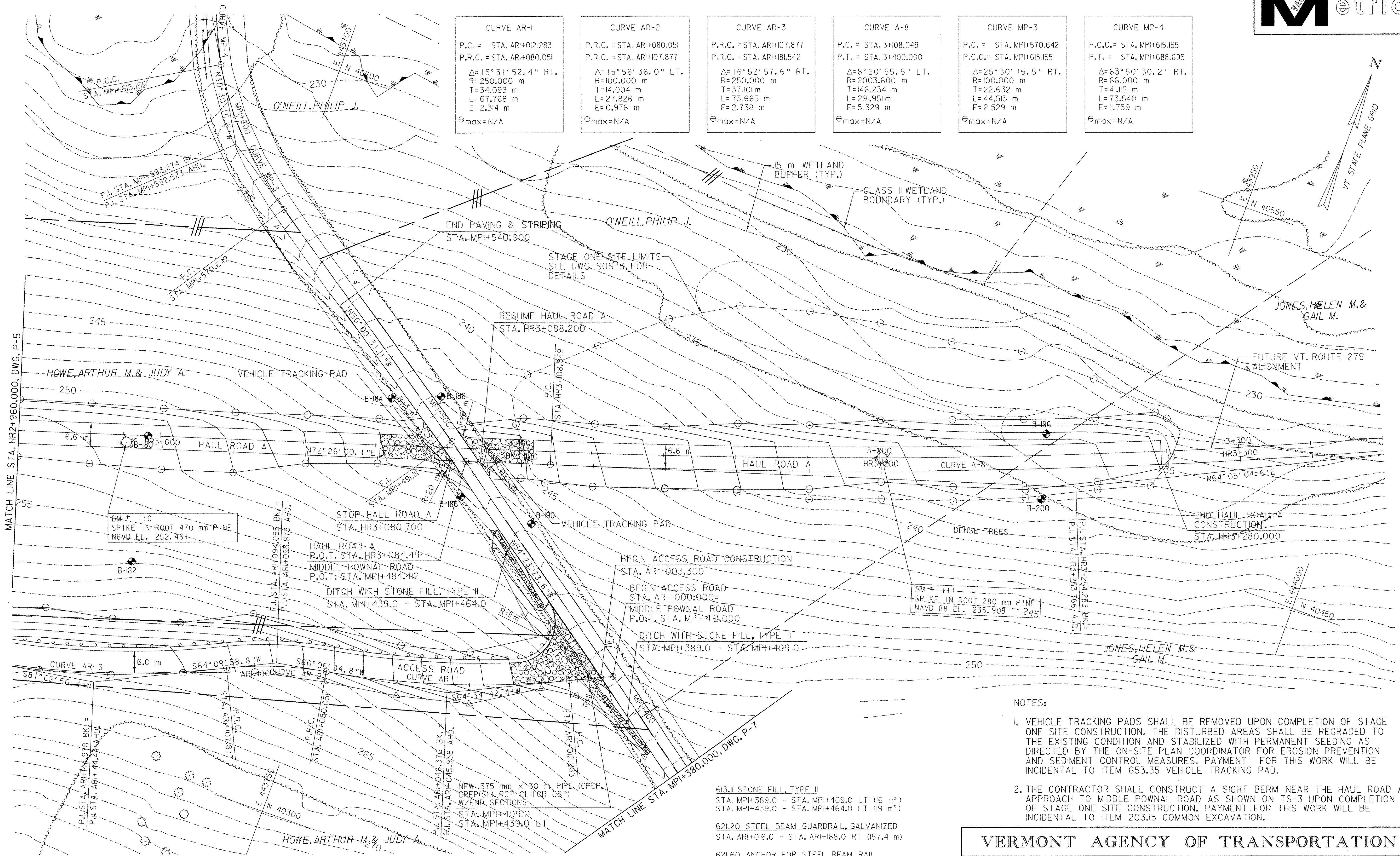

- NOTES:
- VEHICLE TRACKING PADS SHALL BE REMOVED UPON COMPLETION OF STAGE ONE SITE CONSTRUCTION. THE DISTURBED AREAS SHALL BE REGRADED TO THE EXISTING CONDITION AND STABILIZED WITH PERMANENT SEEDING AS DIRECTED BY THE ON-SITE PLAN COORDINATOR FOR EROSION PREVENTION AND SEDIMENT CONTROL MEASURES. PAYMENT FOR THIS WORK WILL BE INCIDENTAL TO ITEM 653.35 VEHICLE TRACKING PAD.
 - THE CONTRACTOR SHALL CONSTRUCT A SIGHT BERM NEAR THE HAUL ROAD A APPROACH TO MIDDLE POWNAL ROAD AS SHOWN ON TS-3 UPON COMPLETION OF STAGE ONE SITE CONSTRUCTION. PAYMENT FOR THIS WORK WILL BE INCIDENTAL TO ITEM 203.15 COMMON EXCAVATION.

- 613.11 STONE FILL, TYPE II
STA. MPI+389.0 - STA. MPI+409.0 LT (16 m³)
STA. MPI+439.0 - STA. MPI+464.0 LT (19 m³)
- 621.20 STEEL BEAM GUARDRAIL, GALVANIZED
STA. ARI+016.0 - STA. ARI+168.0 RT (157.4 m)
- 621.60 ANCHOR FOR STEEL BEAM RAIL
STA. ARI+016.0 RT (1 EA)
- 646.412 DURABLE 100 mm YELLOW LINE, THERMOPLASTIC
STA. MPI+380.0 - STA. MPI+540.0 DOUBLE SOLID C/L
- 649.31 GEOTEXTILE UNDER STONE FILL
STA. MPI+389.0 - STA. MPI+409.0 LT (50 m²)
STA. MPI+439.0 - STA. MPI+464.0 LT (60 m²)

DATUM

VERTICAL	NAVD 88
HORIZONTAL	NAD 83 (1992)

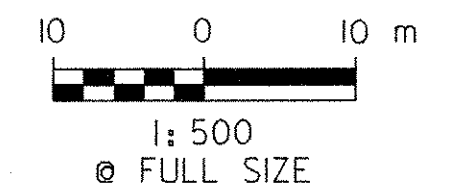

FILE NAME = H:\9819\mstn\03\clough\Stage One Sites\zd048p106.dgn
 DATE / TIME = 5/21/2007
 USER = JLS

VERMONT AGENCY OF TRANSPORTATION	
 <small>CLOUGH HARBOUR & ASSOCIATES LLP 11 Wireless Circle, PO Box 5269, Albany, NY 12205 www.cloughharbour.com</small>	PROJECT NAME: BENNINGTON
	PROJECT NUMBER: AC NH 019-(153)
	FILE NAME: ZD048PL06.DGN
	PLOT DATE: 5/21/2007
	PROJECT LEADER: D.E.G.
	DESIGNED BY: J.S.P.
	CHECKED BY: D.E.G.
	SHEET 436 OF 577