

PLAN VIEW - APPROACH RAIL

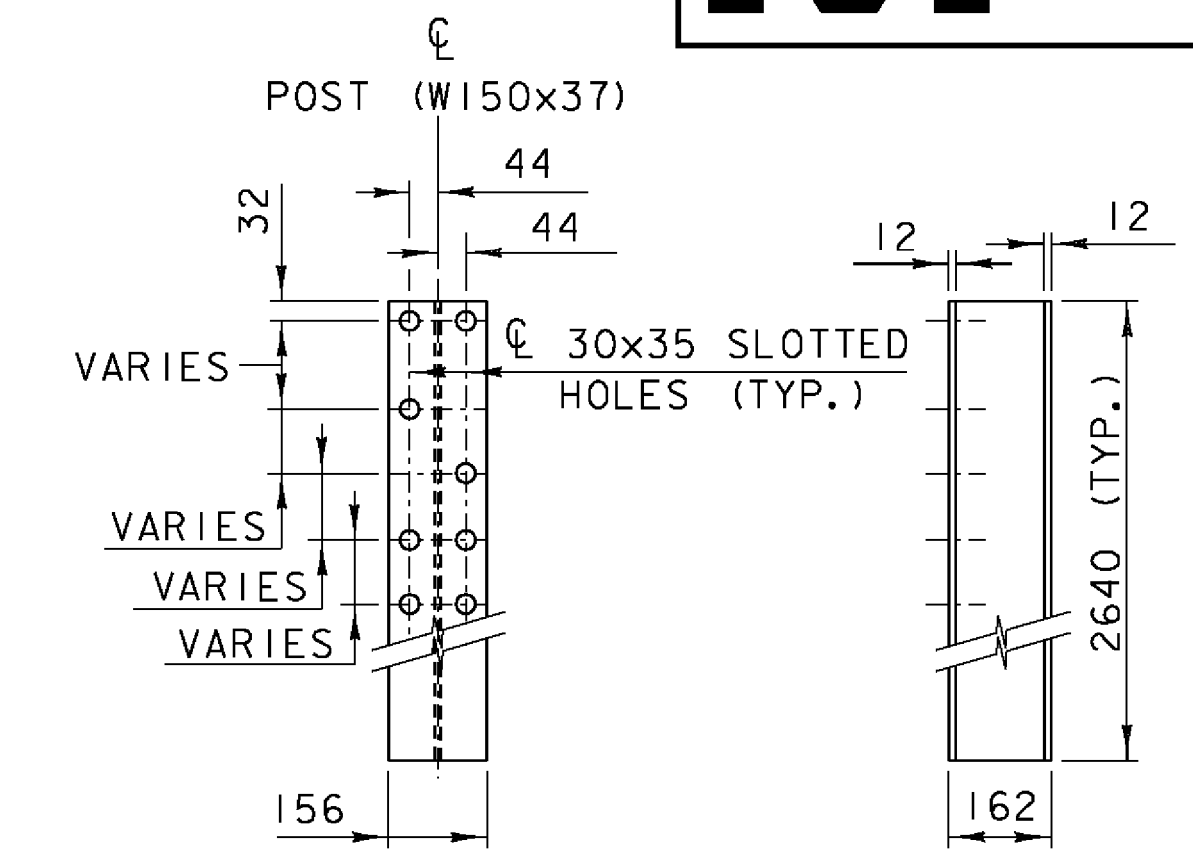

RAIL POST

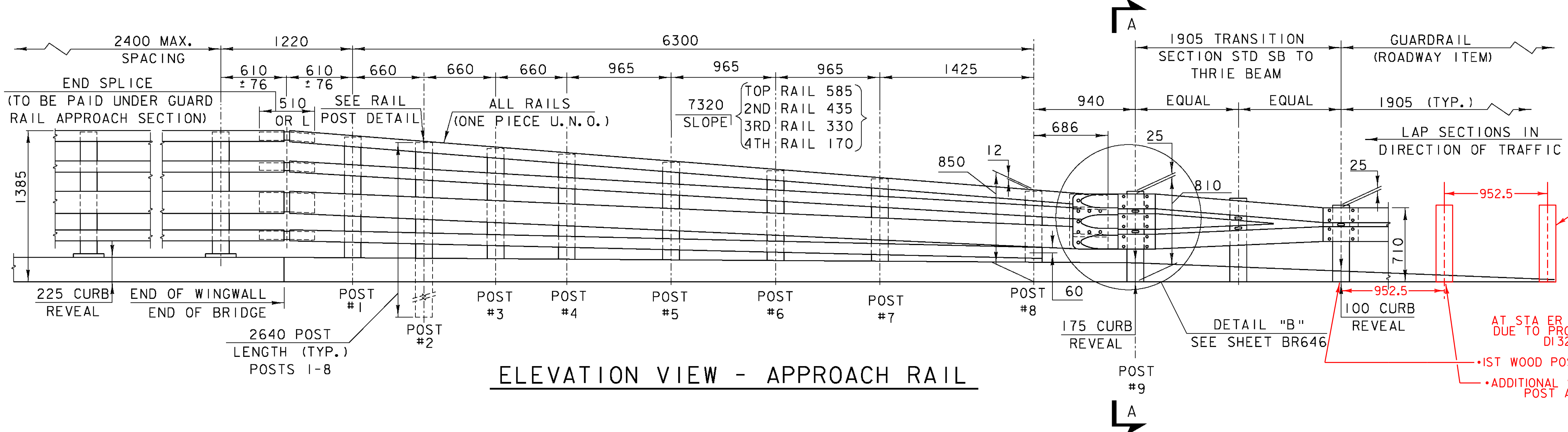

ELEVATION VIEW - APPROACH RAIL

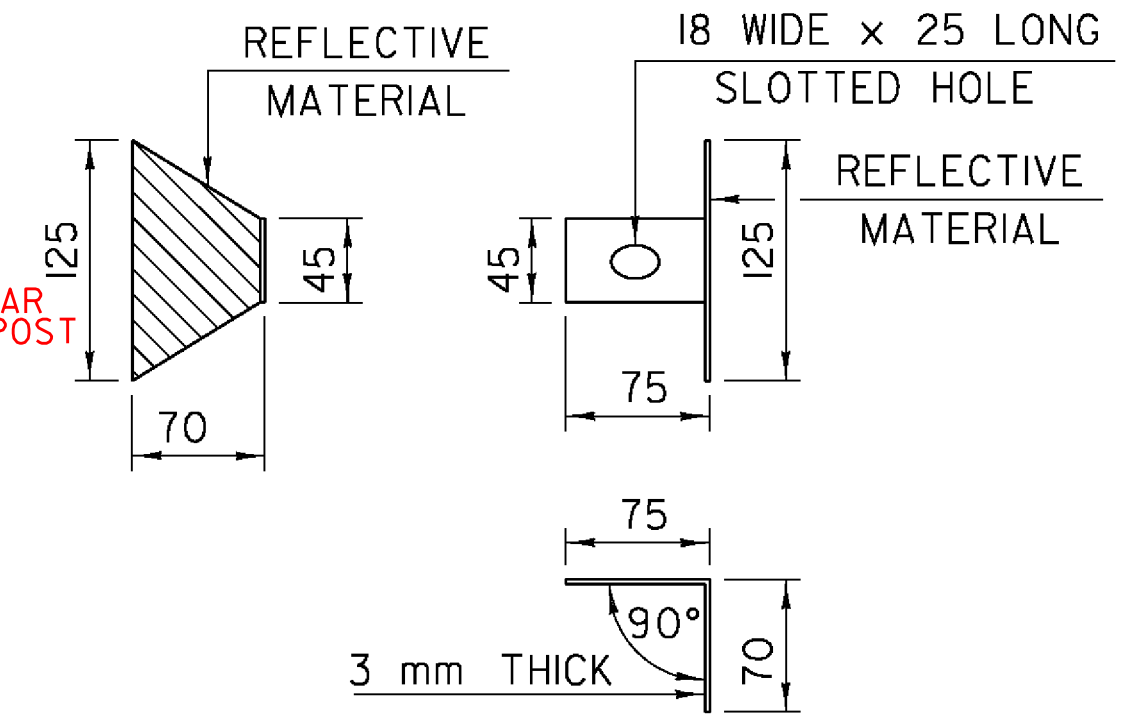

DELINEATION DEVICE DETAILS

NOTES

1. REFER TO BRIDGE SHEET BR644 FOR ADDITIONAL DETAILS, NOTES AND MATERIAL SPECIFICATIONS.
2. PAYMENT FOR GUARD RAIL APPROACH SECTION, NETC 4 RAIL SHALL INCLUDE THE TERMINAL CONNECTOR, THE CONNECTION PLATE, RAIL, POSTS, BLOCKS AND ATTACHMENT HARDWARE.
3. THE REFLECTORIZED ALUMINUM DELINEATION IS TO BE ERRECTED EVERY 9100 (OR CLOSEST POST) WITH A 16 DIAMETER BOLT. DELINEATORS SHALL MEET SPECIFICATION REQUIREMENTS FOR ASTM B209 ALLOY 5052-H32.
4. REFLECTIVE MATERIAL SHALL MEET REQUIREMENTS OF SUBSECTION 750.08 AND SHALL BE OF ENCAPSULATED LENS SILVER. SILVER IS TO BE INSTALLED ON THE DRIVER'S RIGHT.
5. ALL APPROACH RAIL SPLICES SHALL BE LAPPED IN THE DIRECTION OF TRAFFIC FLOW.
6. ALL BRIDGE APPROACH RAIL MATERIALS, DIMENSION SIZES AND NOTES SHALL BE THE SAME AS THOSE OF THE BRIDGE RAIL, UNLESS OTHERWISE NOTED.
7. CARRIAGE BOLTS SHALL BE AASHTO M 164M AND NUTS SHALL BE AASHTO M291M (ASTM A 563M) OR BETTER (GALVANIZED).
8. WELD SPLICE BARS TO FIT BEND. USE COMPLETE PENETRATION WELD (B-U2).
9. THE CONCRETE CURB WILL BE PAID FOR AS ITEM 616.28, CAST-IN-PLACE CONCRETE CURB, TYPE B".
10. SEE BRIDGE SHEET BR646 FOR SECTION A-A.

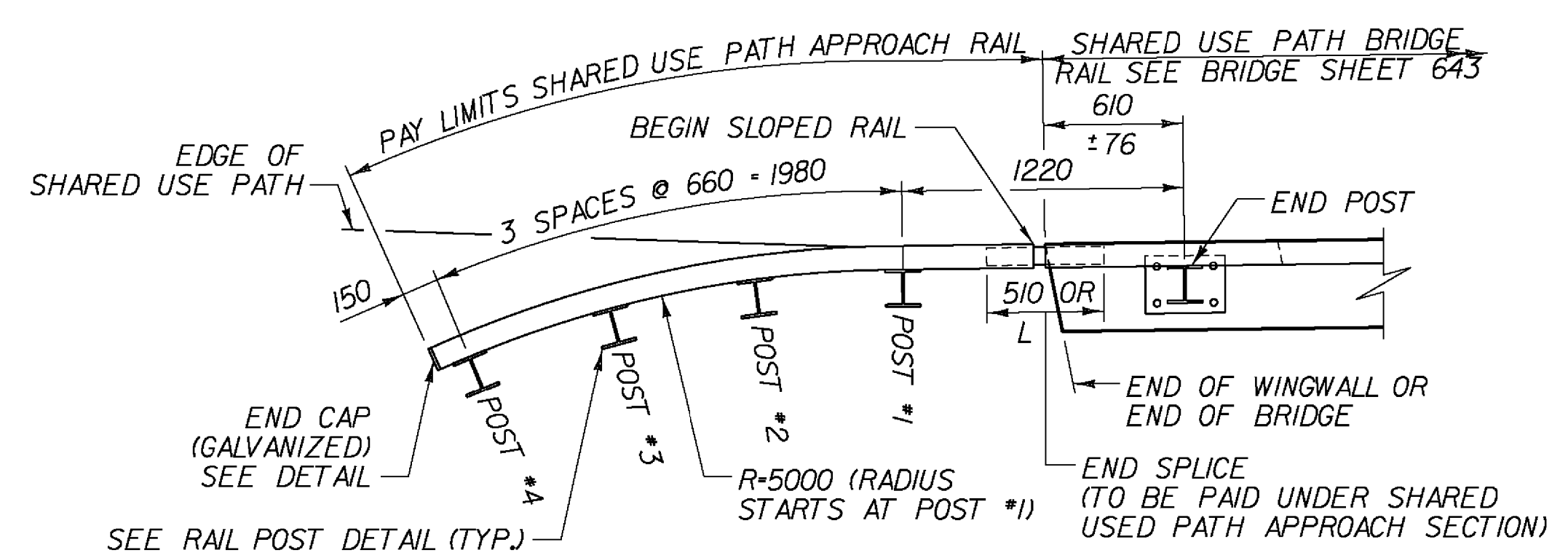

PLAN VIEW - SHARED USE PATH APPROACH RAIL

SLOPE RAILS, SAME AS VEHICULAR BRIDGE APPROACH RAIL
 TOP RAIL: 585 VERT. TO 7320 HORZ.
 2ND RAIL: 383 VERT. TO 7320 HORZ.
 3RD RAIL: 170 VERT. TO 7320 HORZ.

PAYMENT FOR SHARED USE PATH APPROACH RAIL SHALL BE MADE UNDER ITEM 900.620, SPECIAL PROVISION (GUARD RAIL APPROACH SECTION, GALVANIZED 3 RAIL) AND SHALL INCLUDE ALL RAILS, POSTS, ATTACHMENT HARDWARE AND END SPLICES.

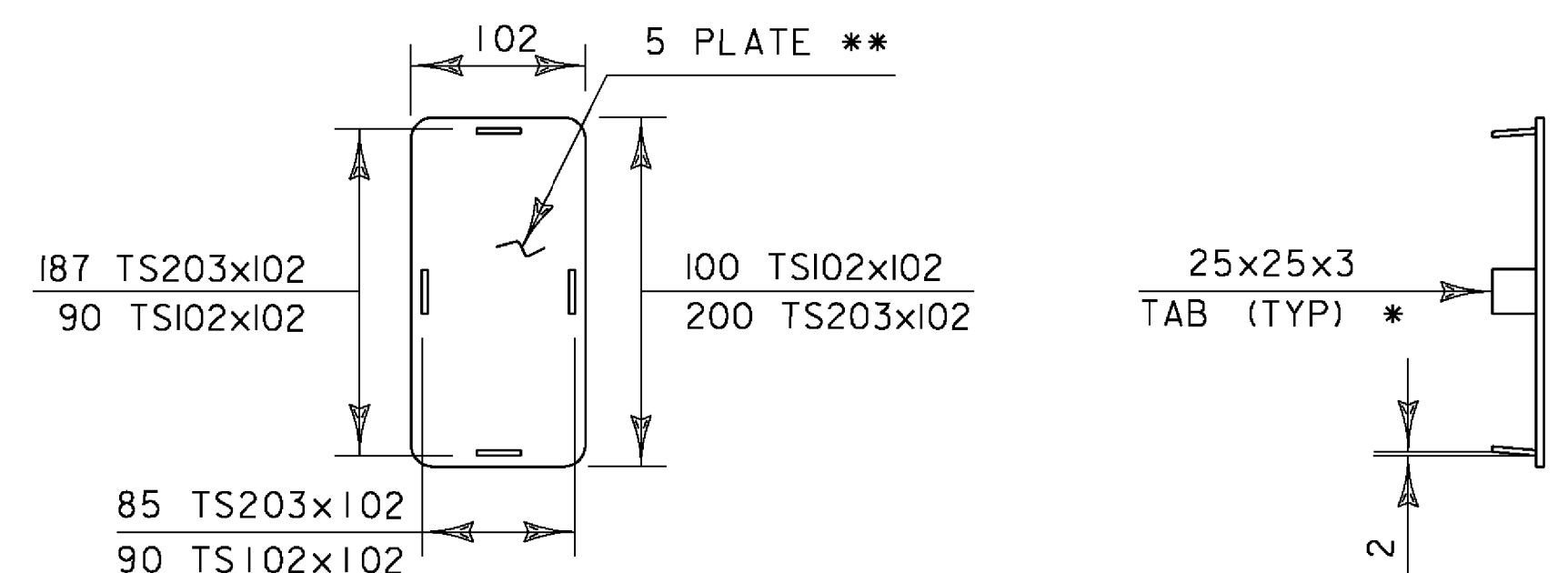

END CAP DETAIL

- * WELD TABS TO END CAP PLATE IN TAPERED POSITION SO CAP CAN BE JAMMED INTO END OF RAIL TUBE.
- ** ROUND CORNERS 12 mm RADIUS (TYP)

STATE OF VERMONT AGENCY OF TRANSPORTATION

Town Of	BENNINGTON	Bridge No.	Bill
Highway No.	TH 5	Log Sta.	
		Surv. Sta.	
EAST ROAD OVER VT ROUTE 279			
APPROACH RAILING			
Designed By	VTrans/DH	Drawn By	VTrans/DH
Checked By	S. BURBANK	Bridge Design Supervisor	G. BOGUE
Date	03/06	Date	03/07
PROJECT	BENNINGTON	PROJECT NO.	AC NH 019-1(53)
Dgn.:	...Design\VER\ER-BRAppr.dgn	Plot Date:	5/25/2011
Bridge Sheet No.	BR645	Sheet	292 of 577

