

RECORD PLANS

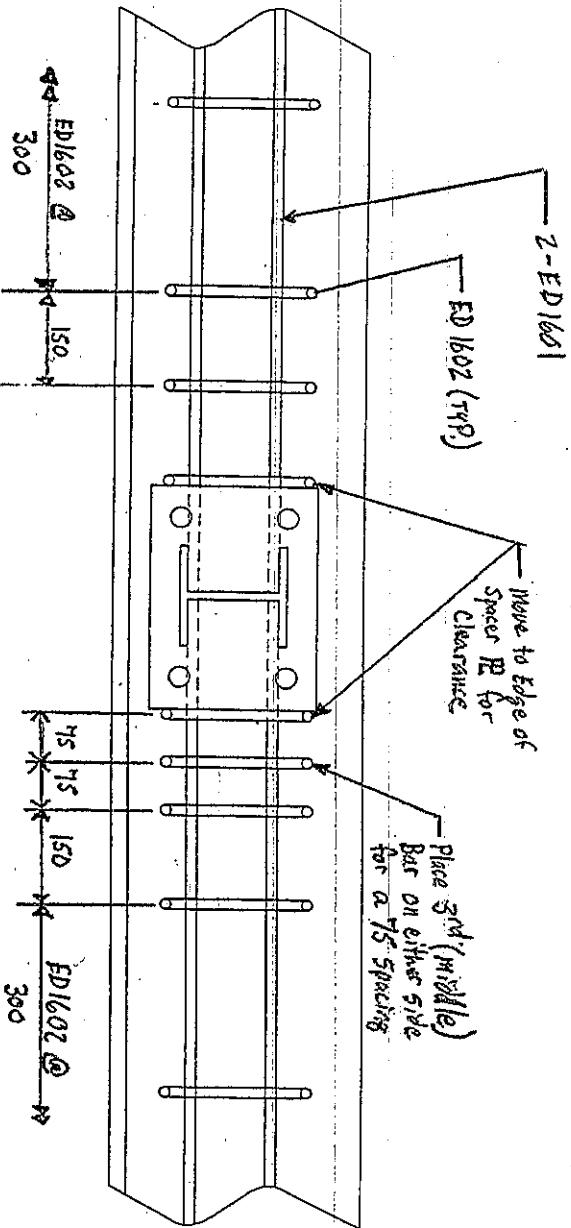

PLAN VIEW

NTS

Revised Curb
Rebar Detail
@ S.U.P. Bridge

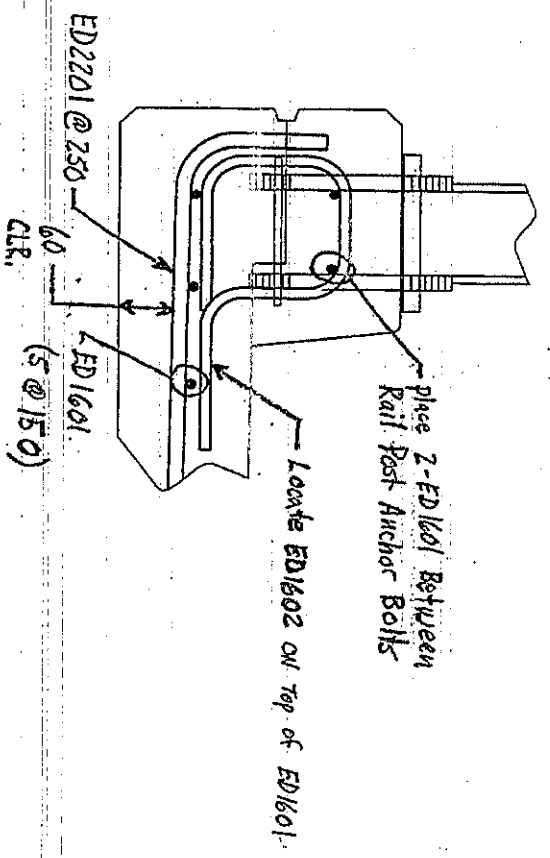

SECTION

NTS

We have located the ED1602 bar on top of the ED1601 bar which is in the deck. This reduces our top clear distance from 76 mm to 66 mm (See the Section). Because this is a pedestrian bridge we feel that this 10 mm difference is acceptable. We have also moved the two ED1601 bars that are in the curb so they are located between the rail post anchor bolts (See the Section). Finally, we have moved the three ED1602 bars that are in conflict with the rail post spacer plate. Two bars have been moved to the edge of the spacer plate and the third bar has been located between the next ED1602 spaced at 150 mm to create three bars with a 75 mm spacing (See the Plan View).