

PIPE #	LOCATION	COMMENTS
CV308	ER 1+080.0 RT - LT	450 X 26.5 m PIPE OPTION 2 REINFORCED CONCRETE HEADWALL AT INLET CONST STONE FILL TYPE 1 AT OUTLET (0.9 M X 1.8 M)

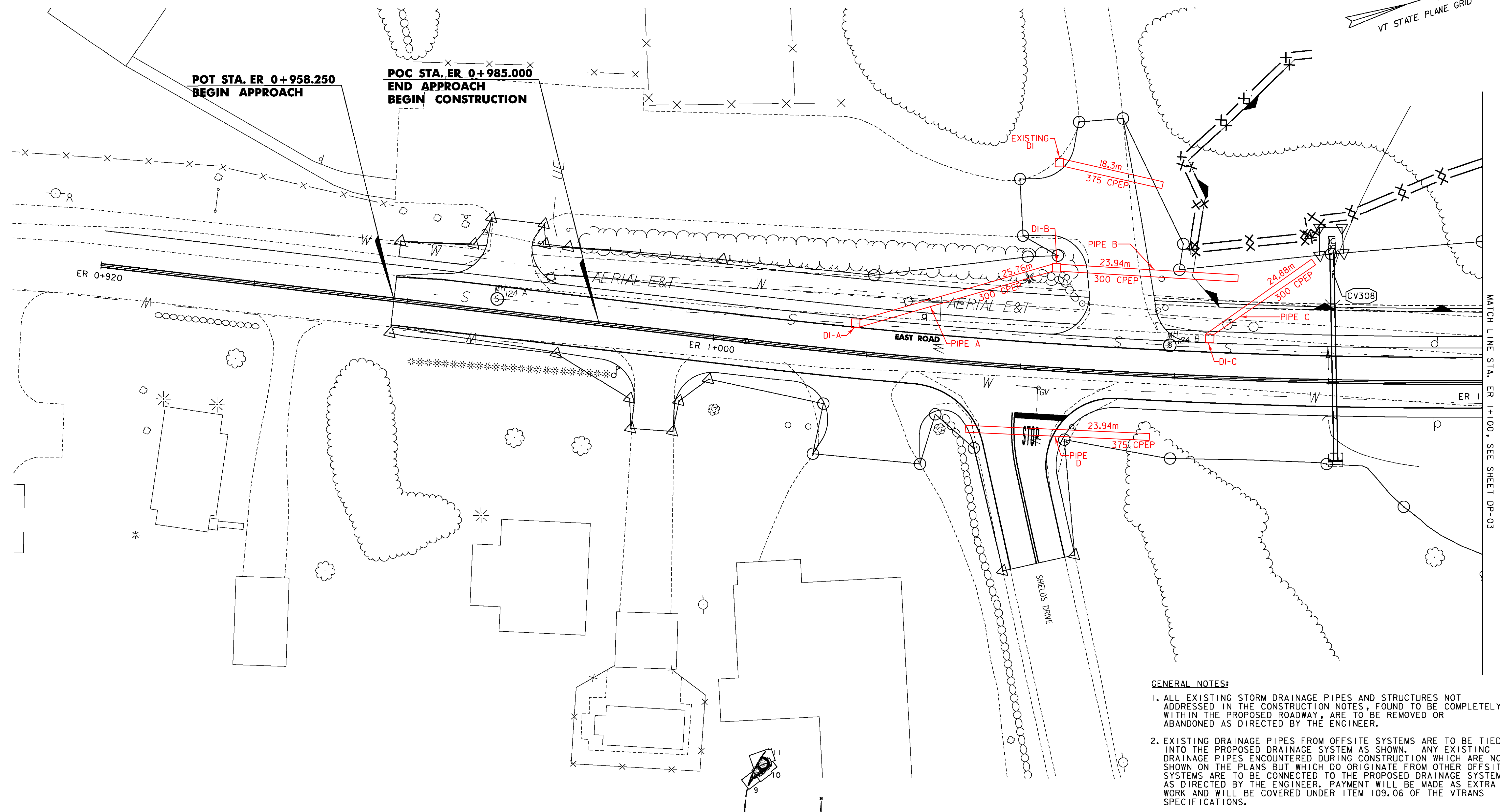

POT STA. ER 0+958.250
BEGIN APPROACH

POC STA. ER 0+985.000
END APPROACH
BEGIN CONSTRUCTION

- GENERAL NOTES:**
1. ALL EXISTING STORM DRAINAGE PIPES AND STRUCTURES NOT ADDRESSED IN THE CONSTRUCTION NOTES, FOUND TO BE COMPLETELY WITHIN THE PROPOSED ROADWAY, ARE TO BE REMOVED OR ABANDONED AS DIRECTED BY THE ENGINEER.
 2. EXISTING DRAINAGE PIPES FROM OFFSITE SYSTEMS ARE TO BE TIED INTO THE PROPOSED DRAINAGE SYSTEM AS SHOWN. ANY EXISTING DRAINAGE PIPES ENCOUNTERED DURING CONSTRUCTION WHICH ARE NOT SHOWN ON THE PLANS BUT WHICH DO ORIGINATE FROM OTHER OFFSITE SYSTEMS ARE TO BE CONNECTED TO THE PROPOSED DRAINAGE SYSTEM AS DIRECTED BY THE ENGINEER. PAYMENT WILL BE MADE AS EXTRA WORK AND WILL BE COVERED UNDER ITEM 109.06 OF THE VTRANS SPECIFICATIONS.

THE REMAINDER OF THE EXISTING AND PROPOSED DRAINAGE PIPES AND STRUCTURES ASSOCIATED WITH EAST ROAD ARE SHOWN ON DP-3.

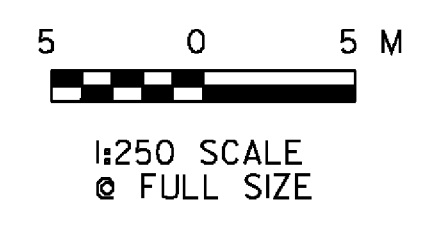
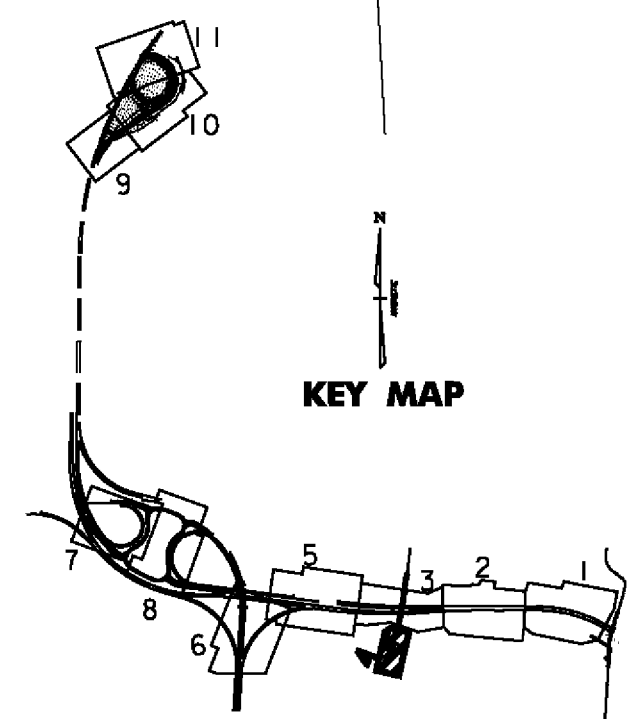

VERMONT AGENCY OF TRANSPORTATION



PROJECT NAME:	BENNINGTON
PROJECT NUMBER:	AC NH 019-1(53)
FILE NAME:	...z307c3drn_plans.pptf
DESIGN SUPERVISOR:	GREG EDWARDS
DESIGNED BY:	MARC FOISY
DRAINAGE PLAN DP-04	
PLOT DATE:	5/16/2011
DRAWN BY:	STANTEC
CHECKED BY:	GARY SANTY
SHEET	95 OF 577

v:\1953\active\19530002\transportation\drawing\contr\act_3\pot_files\z307c3drn_plans.pptf