

PIPE #	LOCATION	COMMENTS
313	NB 8+780 - NB 8+875.0 LT	450 X 99.5 m PIPE OPTION 3
314	NB 8+875.0 LT-RT	450 X 25.4 m PIPE OPTION 1
315	NB 8+875.0 - NB 8+955.0 LT	450 X 79.2 m PIPE OPTION 1
316	NB 8+955.0 LT-RT	450 X 29.1 m PIPE OPTION 1
317	NB 8+955.0 - NB 9+045.0 LT	600 X 88.8 m PIPE OPTION 2
318	NB 9+045.0 LT-RT	450 X 30.4 m PIPE OPTION 1
319	NB 9+045.0 - NB 9+130.0 LT	600 X 84.2 m PIPE OPTION 2
320	NB 9+130.0 LT-RT	450 X 31.0 m PIPE OPTION 1
321	XO 1+400.0 RT - XO 1+406.0 RT	750 X 94.0 m PIPE OPTION 2

STRUCTURE #	LOCATION	COMMENTS
D1314	NB 8+875.0 RT	TYPE A GRATE
D1315	NB 8+875.0 LT	TYPE A GRATE
D1316	NB 8+955.0 RT	TYPE A GRATE
CB317	NB 8+955.0 LT	TYPE A GRATE
D1318	NB 9+045.0 RT	TYPE A GRATE
CB319	NB 9+045.0 LT	TYPE B GRATE
D1320	NB 9+130.0 RT	TYPE B GRATE
CB321	NB 9+130.0 LT	TYPE B GRATE

STRUCTURE #	LOCATION	COMMENTS
300	NB 9+100.0, 13.0 m- 42 m RT	CONST. SLOPE DITCH W/ STONE FILL, TYPE II (SEE NOTE 1)

- U 310 CONST. € NB 8+780.0 - NB 8+875.0, RT. NEW 150 x 103.5 m UND.
- U 313 CONST. € NB 8+780.0 - NB 8+875.0, LT. NEW 150 x 103.5 m UND.
- U 314 CONST. € NB 8+875.0 - NB 8+955.0, RT. NEW 150 x 83.0 m UND. W/CLEANOUT @ NB 8+875.0, RT.
- U 315 CONST. € NB 8+888.9 - NB 8+955.0, LT. NEW 150 x 74.0 m UND. W/FLUSHING BASIN @ NB 8+888.9, LT.

- U 316 CONST. € NB 8+955.0 - NB 9+045.0, RT. NEW 150 x 93.0 m UND. W/CLEANOUT @ NB 8+955.0, RT.
- U 317 CONST. € NB 8+955.0 - NB 9+045.0, LT. NEW 150 x 93.0 m UND. W/CLEANOUT @ NB 8+955.0, LT.
- U 318 CONST. € NB 9+045.0 - NB 9+130.0, RT. NEW 150 x 88.0 m UND. W/CLEANOUT @ NB 9+045.0, RT.
- U 319 CONST. € NB 9+045.0 - NB 9+130.0, LT. NEW 150 x 88.5 m UND. W/CLEANOUT @ NB 9+045.0, LT.

- U 320 CONST. € NB 9+130.0 - NB 9+140.0, RT. NEW 150 x 98.0 m UND. W/CLEANOUT @ NB 9+130.0, RT.
- U 321 CONST. € NB 9+136.0 - NB 9+137.0, LT. NEW 150 x 93.0 m UND. W/FLUSHING BASIN @ NB 9+136.0, 3.5 m, LT.
- U 321A CONST. € NB 9+130.0 - NB 9+137.0, LT. NEW 150 x 97.0 m UND. W/CLEANOUT @ NB 9+130.0, LT.

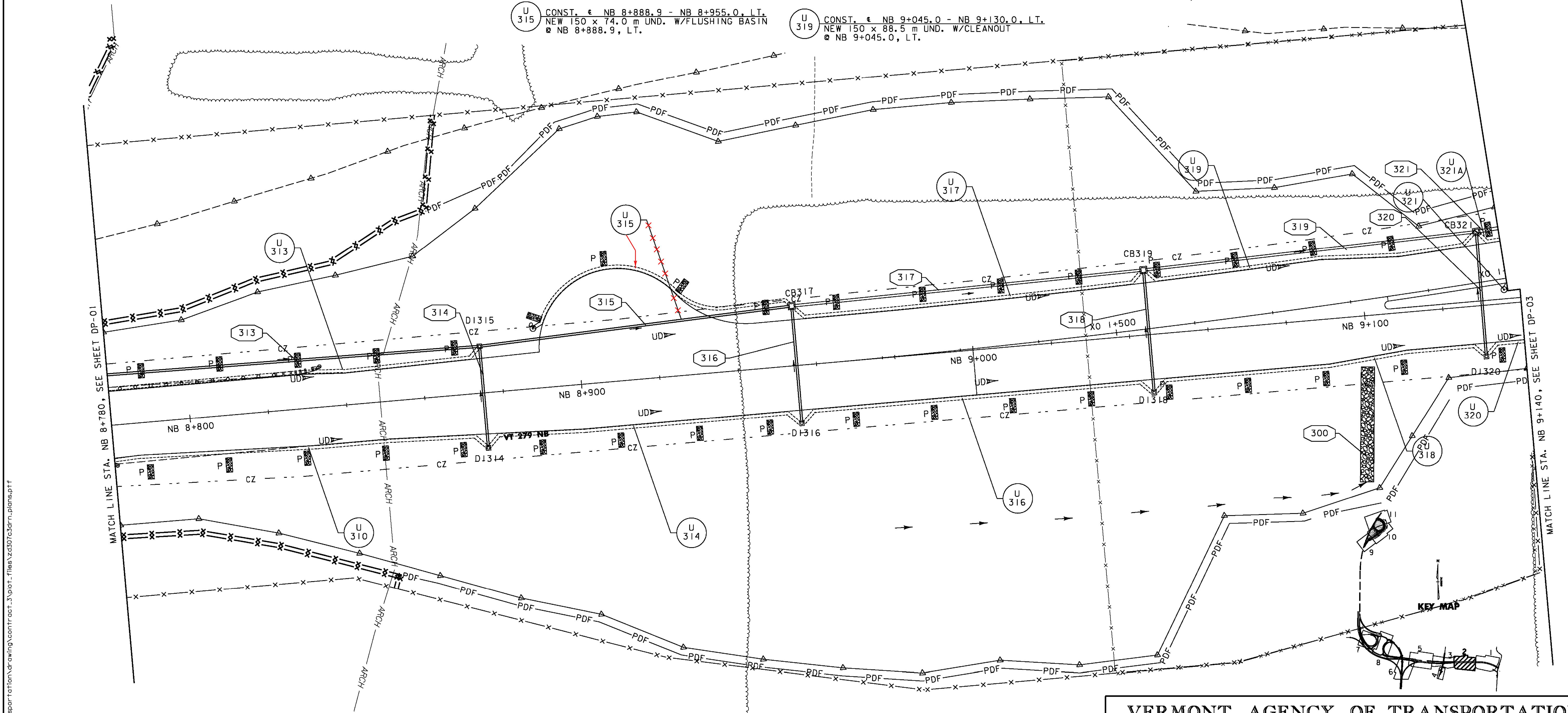

MATCH LINE STA. NB 8+780, SEE SHEET DP-01

MATCH LINE STA. NB 9+140, SEE SHEET DP-03

- NOTES:**
- SEE SHEET DD-2 FOR DIMENSIONS AND CONSTRUCTION DETAILS OF SLOPE DITCH. EARTHWORK FOR SLOPE DITCH SHALL BE PAID FOR UNDER ITEM 204.20 (TRENCH EXCAVATION).
  - PIPE STATIONING REFLECTS BREAKS AT SHEET MATCHLINES. PIPE LENGTHS REFLECT ACTUAL PIPE SEGMENTS & MATCH THE SUMMARY SHEETS.

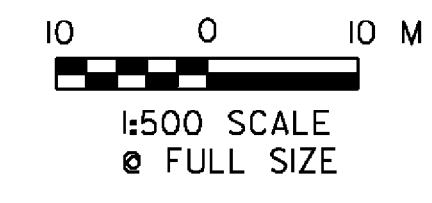

<b>VERMONT AGENCY OF TRANSPORTATION</b>	
	PROJECT NAME: BENNINGTON
	PROJECT NUMBER: AC NH 019-1(53)
FILE NAME: ...\\zd307c3drn_plans.pptf	PLOT DATE: 5/16/2011
DESIGN SUPERVISOR: GREG EDWARDS	DRAWN BY: STANTEC
DESIGNED BY: MARC FOISY	CHECKED BY: GARY SANTY
<b>DRAINAGE PLAN DP-02</b>	

V:\1953\active\19530002\transportation\drawing\contr\act\_3\plot\_files\zd307c3drn\_plans.pptf